

LINN OPERATING INC. BRATTIN #6 ATU-271

270' FSL
270' FEL

SE/4 OF SE/4 OF SE/4 OF SE/4 OF SECTION 10, T-27-S, R-39-W
LATITUDE: 37°42'29.62670" N
LONGITUDE: 101°33'49.63595" W
GROUND ELEVATION: 3188.2'



Keller
Surveying &
Mapping

2030 B LAKEVIEW DRIVE
AMARILLO, TEXAS 79109
PH (806)118-6253

DRAWN BY DWH
APPROVED BY JEA
SCALE 1" = 200'
DATE 1/24/14

LINN
Energy

2225 W. OKLAHOMA AVE
LAWYSES, KANSAS 67860
PH: (620)356-0340
FAX: (620)356-6950

DRIVING DIRECTIONS:

- BEGINNING AT INTERSECTION OF US HWY 160 & HWY 25
- 1) 11 MILES WEST ON HWY 160
- 2) 9 MILES NORTH ON BIG BOW GRADE ROAD
- 3) WELL AT INTERSECTION OF ROAD 3 & BIG BOW GRADE



SE/4
SEC 10

LINN OPERATING INC.
BRATTIN #6 ATU-271
LAT. 37°42'29.62670"
LON. 101°33'49.63595"

SW/4
SEC 11

SPRINKLER WHEEL TRACK

LINN PIPELINE
UNG. PIONEER TELEPHONE LINE

UNG. PIONEER TELEPHONE LINE

PAD ACCESS

PROPOSED PA-PA PIPELINE

PAD

BIG BOW GRADE (GRADED)

FOUND #5 REBAR @ SE CORNER OF SECTION 10

SECTION LINE

ROAD 3 (NO ROAD WEST)

SECTION LINE

NE/4
SEC 15

NW/4
SEC 14

- NOTES:
- 1) THIS PLAN DOES NOT REPRESENT A TRUE BOUNDARY SURVEY. THE FOOTINGS AND HES SHOWN ARE FROM LOTS OF OCCUPATION WHICH MAY NOT BE ACTUAL PROPERTY LINES.
 - 2) CONTRACTOR TO CONTACT G&E ORL FOR FURTHER SURVEY LOCATIONS PRIOR TO ANY EXCAVATION OR CONSTRUCTION.
 - 3) MAP 27 LAT. ONLY.



JOHN DAVID KELLER, L.S. NO. 1518

T-27-S, R-39-W
STANTON COUNTY, KANSAS

Sheet 1 of 2

LINN OPERATING INC.
BRATTIN #6 ATU-271
SECTIONS 10, 11, 14 & 15
T-27-S, R-39-W,
STANTON COUNTY, KANSAS

PLAT AND CERTIFICATION OF ACREAGE ATTRIBUTABLE TO A GAS WELL

Kansas Corporation Commission, Conservation Division
 Finney State Office Building, 130 South Market, Room 2078
 Wichita, Kansas 67202

API NUMBER 15- _____

LOCATION OF WELL: COUNTY Stanton

OPERATOR LINN Operating, Inc.

270 S feet from south/north line of section

LEASE Brattin

270 E feet from east / west line of section

WELL NUMBER 6 ATU-271

FIELD Hugoton-Panoma

SECTION 10 TWP 27 (S) RG 39W E/W

NUMBER OF ACRES ATTRIBUTABLE TO WELL 640

IS SECTION X REGULAR or _____ IRREGULAR

QTR/QTR/QTR OF ACREAGE SE - SE - SE

IF SECTION IS IRREGULAR, LOCATE WELL FROM
 NEAREST CORNER BOUNDARY. (check line below)

Section corner used: NE NW SE SW

(Show the location of the well and shade attributable acreage for prorated or spaced wells).
 (Show the footage to the nearest lease or unit boundary line; and show footage to the nearest
 common source supply well).

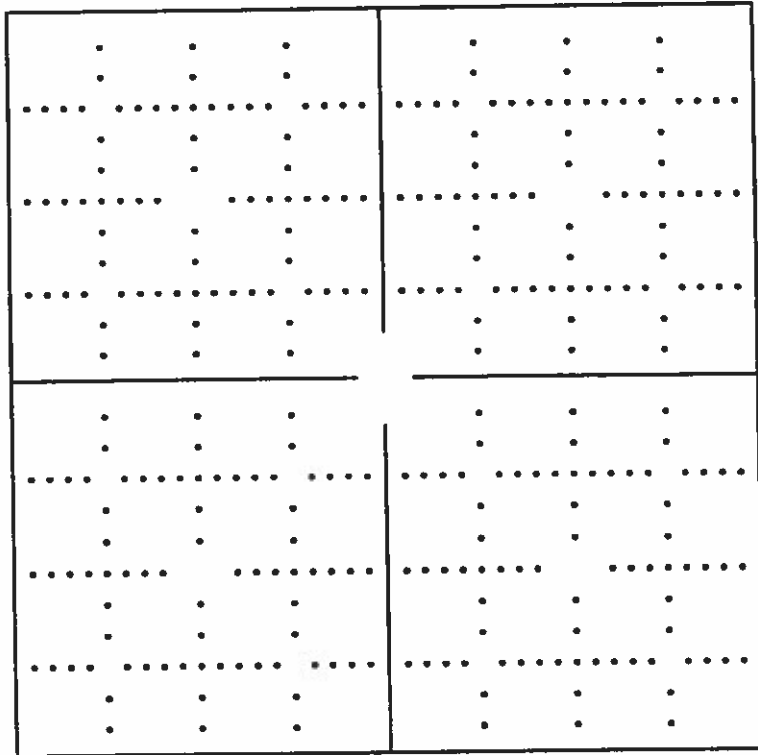

See attached map

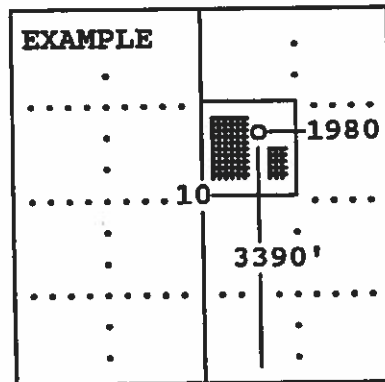

SEWARD CO.

The undersigned hereby certifies as Regulatory Compliance Advisor (title) for
LINN Operating, Inc. (Co.), a duly authorized agent, that all

information shown hereon is true and correct to the best of my knowledge and belief, that all
 acreage claimed attributable to the well named herein is held by production from that well
 and hereby make application for an allowable to be assigned to the well upon the filing of
 this form and the State test, whichever is later.

Signature *Shawn Hickey*

Subscribed and sworn to before me on this 16th day of June, 19 2014

Mindy Poter

Notary Public

My Commission expires

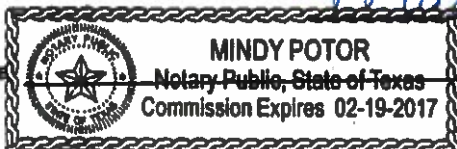

MINDY POTER
 Notary Public, State of Texas
 Commission Expires 02-19-2017

FORM CG-8 (12/94)

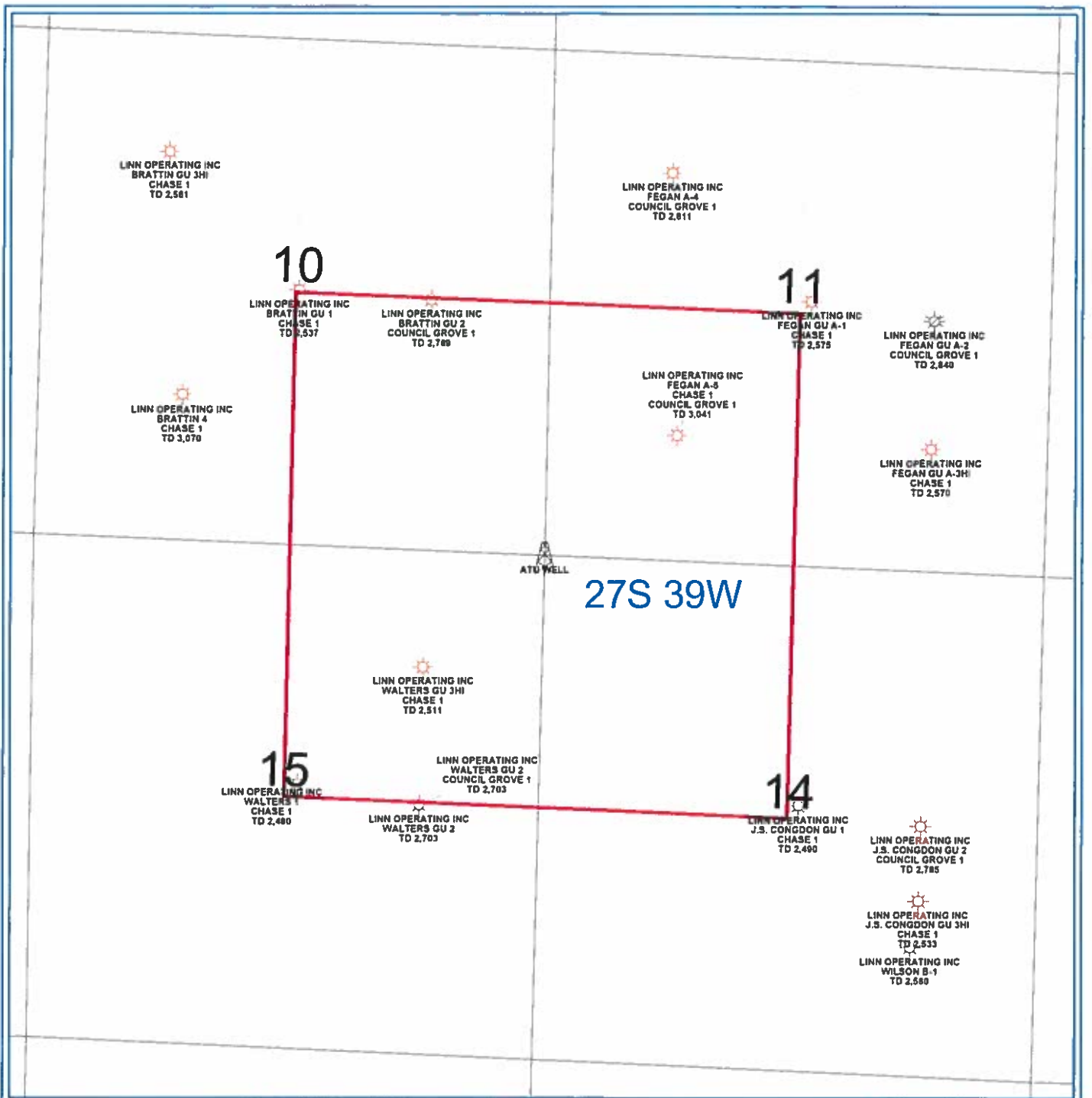

PETRA 4/28/2013 12:29:10 PM

LINN Operating Inc	
Hugoton Kansas	
ATU Location	
Stanton Co. 27S - 39W	
<p>0 1,477 FEET</p>	
WELL SYMBOLS ATU Well Location Gas Well Plugged & Abandoned Gas Well	