



LASSO ENERGY LLC
 1125 SOUTH MAIN
 P.O. BOX 465
 CHASE, KANSAS 67524

LASSO ENERGY LLC
 OPERATOR

BEARDEN TRUST
 LEASE

1-7H
 WELL NO.

06/10/2014
 DATE

COMANCHE
 COUNTY

KANSAS
 STATE

07
 S

33S
 T

17W
 R

1881' GL
 ELEVATION

200' FSL, 660' FEL OF SEC
 SURFACE LOCATION

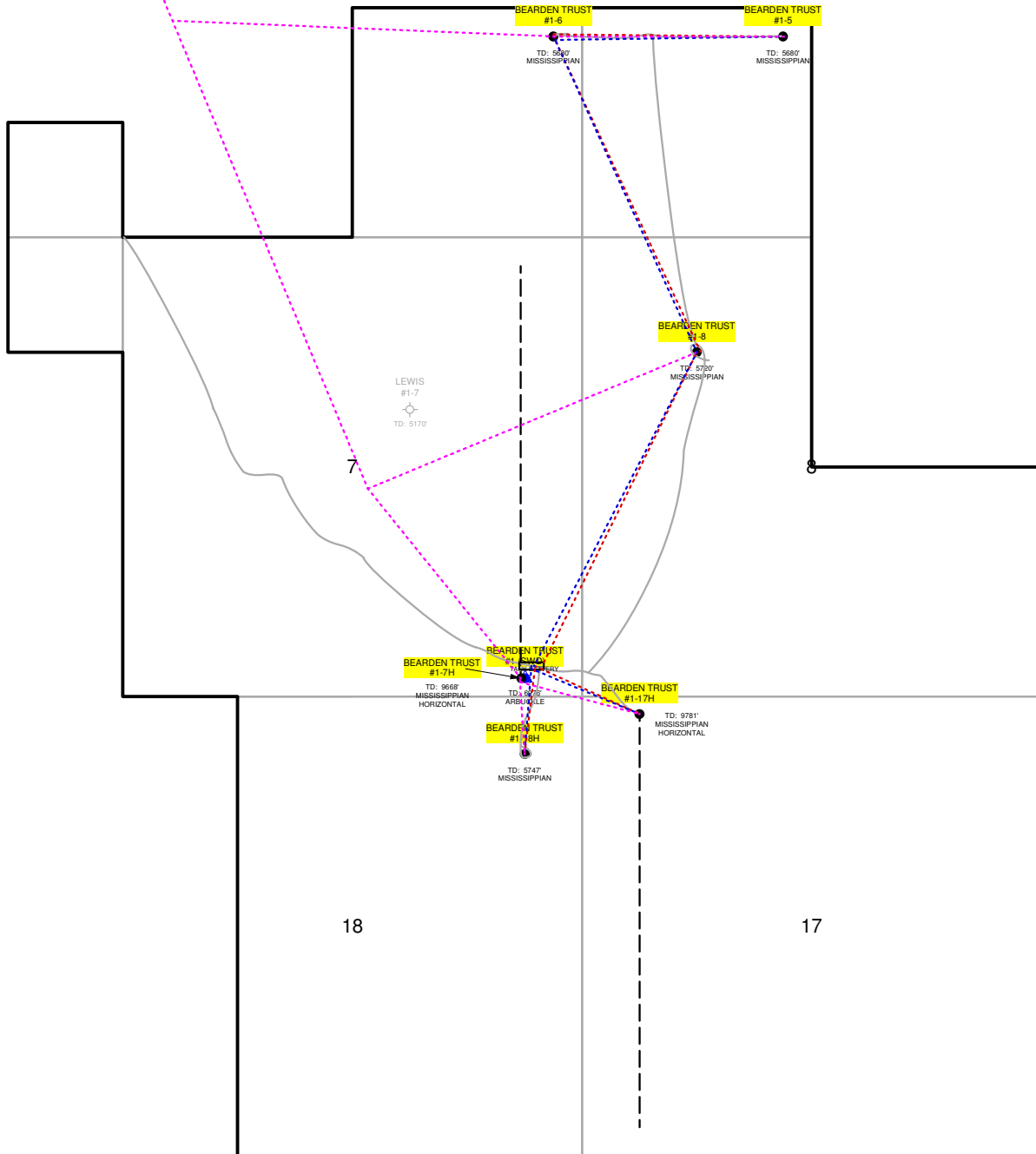

LASSO BEARDEN TRUST LEASE
 COMANCHE COUNTY, KANSAS
 2640 GROSS ACRES
 80.5% NRI

- 2" POLY GAS LINE
- 3" PVC WATER DISPOSAL LINE
- 3" PVC LEAD (OIL & WATER) LINE
- LEASE ROAD
- ELECTRIC (480 VAC 1 PH)

05/28/2014
 SURVEYED