

**OPERATOR:** Samuel Gary Jr. & Associates, Inc. 1515 Wynkoop Street, Suite 700  
Denver, Colorado 80202 office: 303-831-4673 ; fax: 303-863-7285

**WELL NAME:** DON ET AL 1-6

**LOCATION:** 2230 FSL / 105 FEL Sec. 6-5S-23W NORTON COUNTY

**SURFACE OWNERS:** Donald L. Hazlett Trust No. 1  
Donald L. Hazlett, Trustee  
P.O. Box 947  
Colby, KS 67701

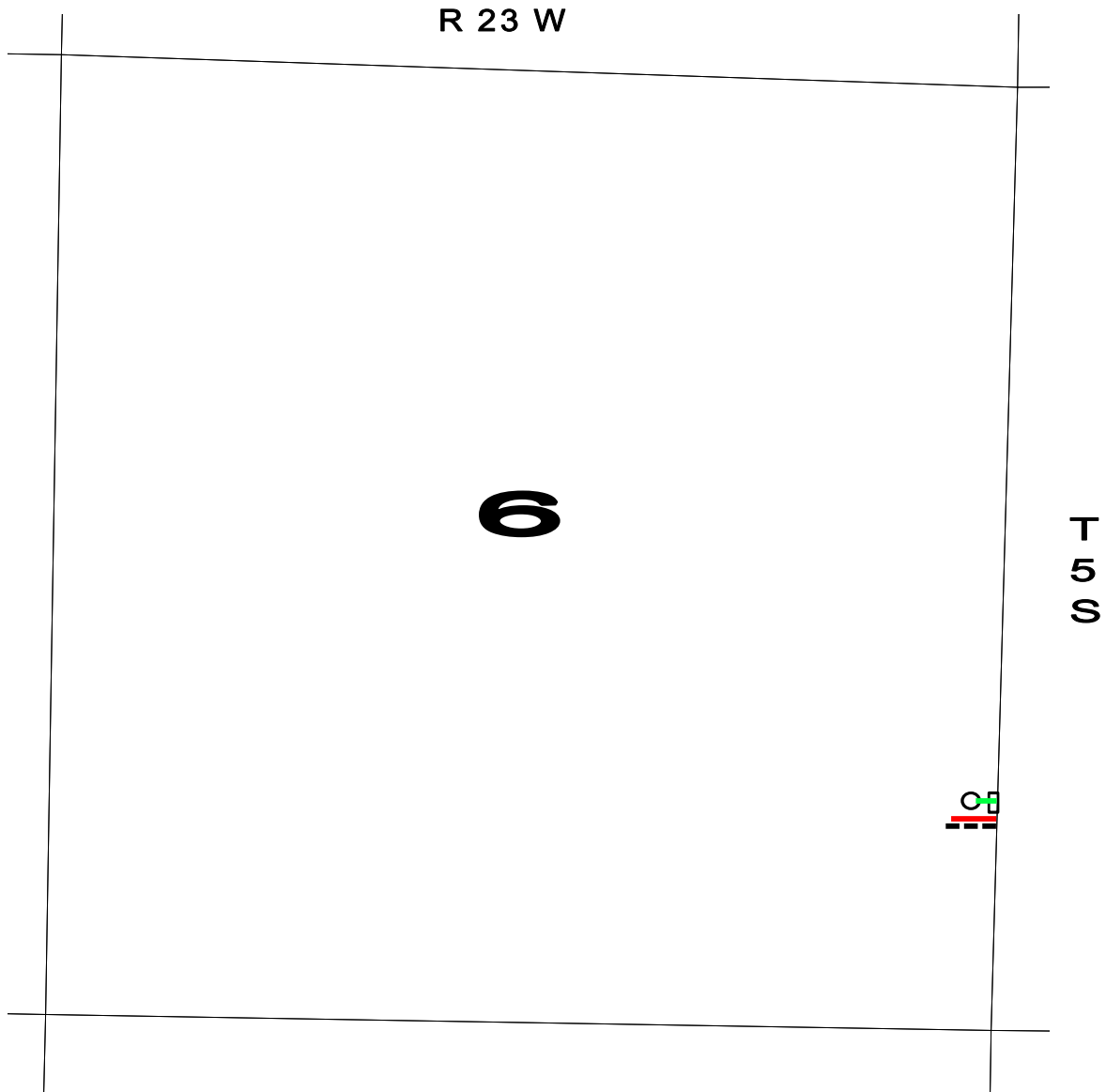

○ PROPOSED WELL LOCATION

□ ESTIMATED LOCATION OF TANK BATTERY

----- ESTIMATED LEASE ROAD

— ESTIMATED LOCATION OF FLOWLINES

— ESTIMATED LOCATION OF ELECTRICAL LINES