

API No. 15 - \_\_\_\_\_  
 Operator: F.G. Holl Company, L.L.C.  
 Lease: SCHMIDT TRUST "A"  
 Well Number: 1-11  
 Field: \_\_\_\_\_

Location of Well: County: Barton  
 2400 \_\_\_\_\_ feet from  N /  S Line of Section  
 2000 \_\_\_\_\_ feet from  E /  W Line of Section  
 Sec. 11 Twp. 20 S. R. 15  East  West

Number of Acres attributable to well: 10  
 QTR / QTR / QTR of acreage: S/2 - SE - NW

Is Section:  Regular or  Irregular

If Section is Irregular, locate well from nearest corner boundary.  
 Section corner used:  NE  NW  SE  SW

**PLAT**

(Show location of the well and shade attributable acreage for prorated or spaced wells.)  
 (Show footage to the nearest lease or unit boundary line.)

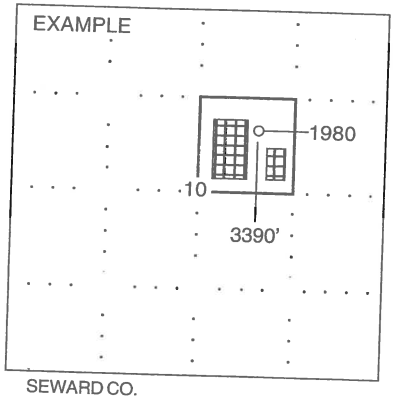
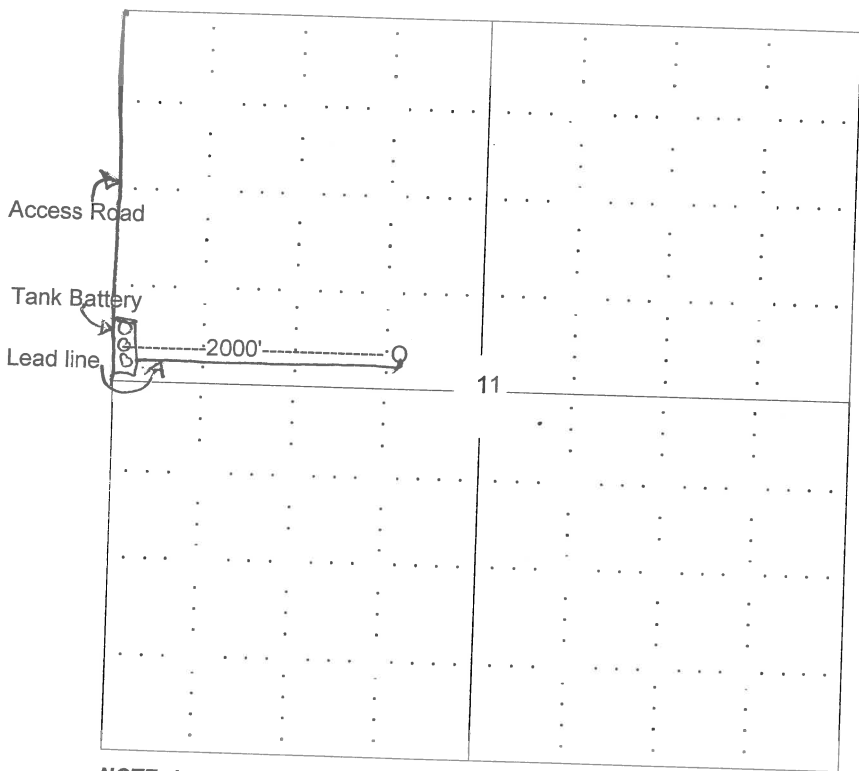

**NOTE: In all cases locate the spot of the proposed drilling location.**

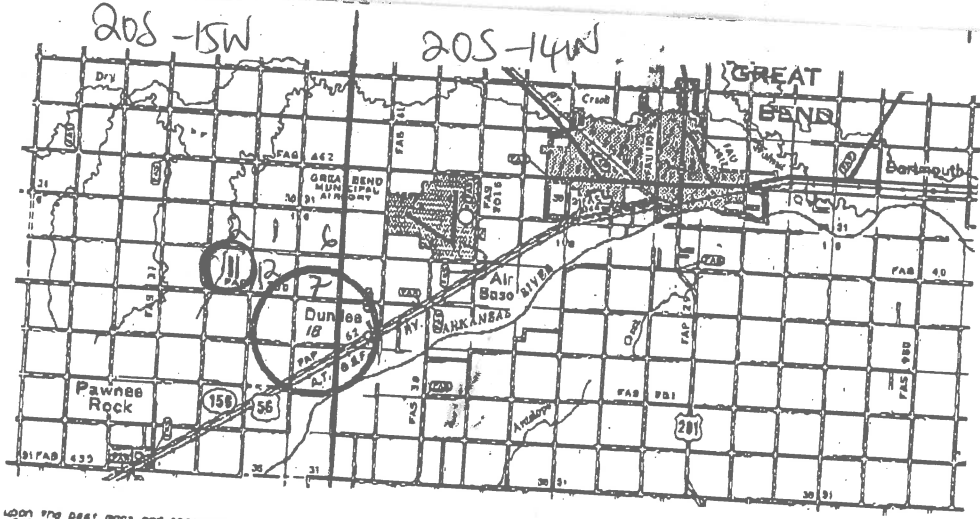

• Controlling data is based upon the best maps and photographs available to us and upon a regular section of land containing 640 acres.  
 • Appropriate section lines were determined using the normal standards of care of oilfield surveyors practicing in the state of Kansas. The section corners, which establish the precise section lines, were not necessarily located, and the exact location of the drilled location in the section is not guaranteed. Therefore, the operator, assuming this service and accepting this plat and all other parties relying thereon agree to hold Central Kansas Oilfield Services, Inc., its officers and employees harmless from all losses, costs and expenses and said entities released from any liability from negligence or consequential damages.  
 • Elevations derived from National Geodetic Vertical Datum.