

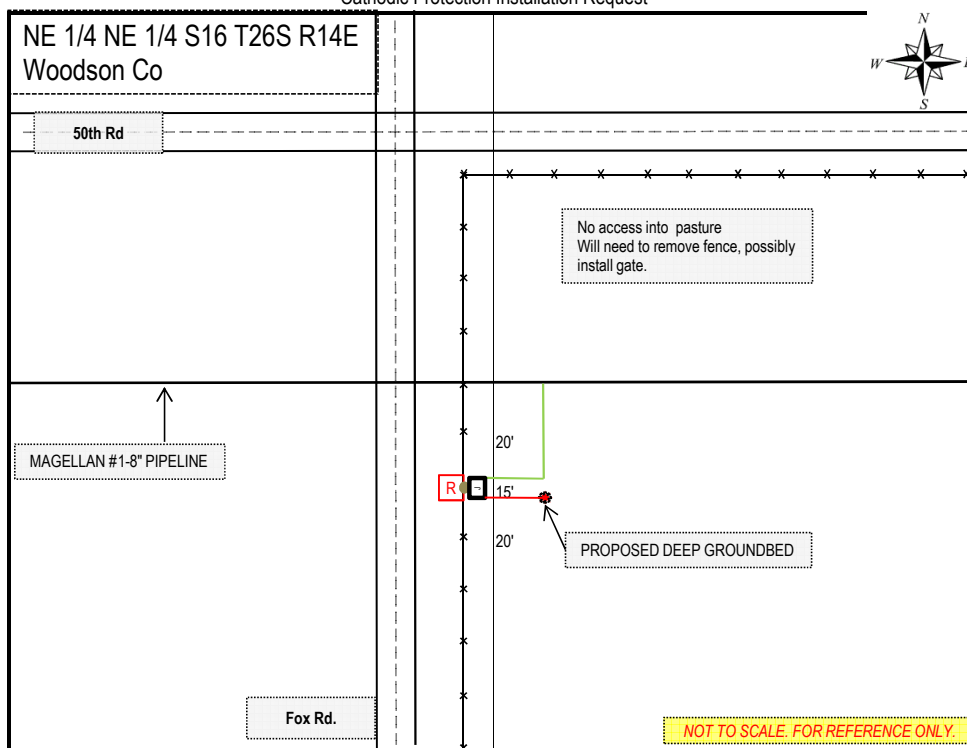

# Cathodic Protection Installation Request



District: Midwest Area: Dennis Whitfield Supv. Pipeline Name/ID: El Dorado to Humboldt #1 - 8"  
 Strip Map: NA Alignment Sheet: EHA-021-11 Tract: 4046 Survey Station: 2918+94  
 Decimal Milepost: N/A Mile Post Plus: 55+15 GPS Coordinates: 37.79181 -95.87088  
 Legal Description: NE 1/4 NE 1/4 S16 T26S R14E County: Woodson State: KS

Driving Directions: .04 miles (232') south on Fox Rd. from 50th Rd. intersection. Located on east side of Fox Rd.

Property Owner: J.K. States Contact Phone #1: Contact Phone #2:  
 Access Contact: Contact Phone #1: Contact Phone #2:  
 Power Company: Lyon Coffey Office Contact Name: Brian Hanson Office Contact Phone #: 620-364-5709  
 N/A Field Contact Name: N/A Field Contact Phone#: N/A  
 Groundbed Type: Deep Current Required: 50A Soil Resistance: 5000  
 Anode Type: Enviranode Number of Anodes: 10 Backfill Type: Conducrete  
 Backfill Amount: Anode Lead Specs: Dual extrusion Halar® or equiv. #8 - 350 ft. Bed to rectifier/J-Box 20'  
 Bottom Anode Depth: 290' Anode Hole Specs: 10" x 300' Anode Spacing: 12'  
 Rectifier: YES Rectifier Specs: Universal 60V/60A 5C 6F with secondary breaker and AC outlet.

Req'd Installation Date: August 4, 2014 Construction: Contract Design Life: 20 yrs.

Additional Materials: New meter loop and disconnect, new 25' pole. Positive cable from j. box to rectifier HMWPE #2 red. 20' of casing required. Top plug material will be concrete from top of Conducrete to top of hole.

Additional Details: Lyon -Coffey CO-OP will hang a meter loop/can and 8 circuit disconnect on their pole. Magellan would trench cables to our rectifier. Magellan can use their diconnect as our main. \$925.00 upfront cost after providing service agreement. Contractor is responsible for obtaining all local, county, & state permits required including One-Call tickets

Requested By: Mark Lepich Date: 05/12/14 Company No. 280  
 Signature: Operating Unit 0135  
 Approved By: Date: Cost Center 5002  
 Signature: District Midwest