

Confidentiality Requested:

☐ Yes ☐ No

KANSAS CORPORATION COMMISSION
OIL & GAS CONSERVATION DIVISION

1218048

Form ACO-1

August 2013

Form must be Typed
Form must be Signed
All blanks must be Filled

WELL COMPLETION FORM
WELL HISTORY - DESCRIPTION OF WELL & LEASE

OPERATOR: License # _____

Name: _____

Address 1: _____

Address 2: _____

City: _____ State: _____ Zip: _____ + _____

Contact Person: _____

Phone: (_____) _____

CONTRACTOR: License # _____

Name: _____

Wellsite Geologist: _____

Purchaser: _____

Designate Type of Completion:

- ☐ New Well ☐ Re-Entry ☐ Workover
- ☐ Oil ☐ WSW ☐ SWD ☐ SIOW
- ☐ Gas ☐ D&A ☐ ENHR ☐ SIGW
- ☐ OG ☐ GSW ☐ Temp. Abd.
- ☐ CM (Coal Bed Methane)
- ☐ Cathodic ☐ Other (Core, Expl., etc.): _____

If Workover/Re-entry: Old Well Info as follows:

Operator: _____

Well Name: _____

Original Comp. Date: _____ Original Total Depth: _____

- ☐ Deepening ☐ Re-perf. ☐ Conv. to ENHR ☐ Conv. to SWD
- ☐ Plug Back ☐ Conv. to GSW ☐ Conv. to Producer
- ☐ Commingled Permit #: _____
- ☐ Dual Completion Permit #: _____
- ☐ SWD Permit #: _____
- ☐ ENHR Permit #: _____
- ☐ GSW Permit #: _____

Spud Date or
Recompletion Date

Date Reached TD

Completion Date or
Recompletion Date

API No. 15 - _____

Spot Description: _____

_____ - _____ - _____ Sec. _____ Twp. _____ S. R. _____ ☐ East ☐ West

_____ Feet from ☐ North / ☐ South Line of Section

_____ Feet from ☐ East / ☐ West Line of Section

Footages Calculated from Nearest Outside Section Corner:

☐ NE ☐ NW ☐ SE ☐ SW

GPS Location: Lat: _____, Long: _____
(e.g. xx.xxxxx) (e.g. -xxx.xxxxx)

Datum: ☐ NAD27 ☐ NAD83 ☐ WGS84

County: _____

Lease Name: _____ Well #: _____

Field Name: _____

Producing Formation: _____

Elevation: Ground: _____ Kelly Bushing: _____

Total Vertical Depth: _____ Plug Back Total Depth: _____

Amount of Surface Pipe Set and Cemented at: _____ Feet

Multiple Stage Cementing Collar Used? ☐ Yes ☐ No

If yes, show depth set: _____ Feet

If Alternate II completion, cement circulated from: _____

feet depth to: _____ w/ _____ sx cmt.

Drilling Fluid Management Plan

(Data must be collected from the Reserve Pit)

Chloride content: _____ ppm Fluid volume: _____ bbls

Dewatering method used: _____

Location of fluid disposal if hauled offsite: _____

Operator Name: _____

Lease Name: _____ License #: _____

Quarter _____ Sec. _____ Twp. _____ S. R. _____ ☐ East ☐ West

County: _____ Permit #: _____

AFFIDAVIT

I am the affiant and I hereby certify that all requirements of the statutes, rules and regulations promulgated to regulate the oil and gas industry have been fully complied with and the statements herein are complete and correct to the best of my knowledge.

Submitted Electronically

KCC Office Use ONLY

☐ Confidentiality Requested

Date: _____

☐ Confidential Release Date: _____

☐ Wireline Log Received

☐ Geologist Report Received

☐ UIC Distribution

ALT ☐ I ☐ II ☐ III Approved by: _____ Date: _____

Sec. _____ Twp. _____ S. R. _____ ☐ East ☐ West County: _____

Final Radioactivity Log, Final Logs run to obtain Geophysical Data and Final Electric Logs must be emailed to kcc-well-logs@kcc.ks.gov. Digital electronic log files must be submitted in LAS version 2.0 or newer AND an image file (TIFF or PDF).

Drill Stem Tests Taken <i>(Attach Additional Sheets)</i>	<input type="checkbox"/> Yes	<input type="checkbox"/> No	<input type="checkbox"/> Log	Formation (Top), Depth and Datum	<input type="checkbox"/> Sample
Samples Sent to Geological Survey	<input type="checkbox"/> Yes	<input type="checkbox"/> No	Name	Top	Datum
Cores Taken	<input type="checkbox"/> Yes	<input type="checkbox"/> No			
Electric Log Run	<input type="checkbox"/> Yes	<input type="checkbox"/> No			
List All E. Logs Run:					

<div style="text-align: center;"> CASING RECORD <input type="checkbox"/> New <input type="checkbox"/> Used </div> <div style="text-align: center;">Report all strings set-conductor, surface, intermediate, production, etc.</div>							
Purpose of String	Size Hole Drilled	Size Casing Set (In O.D.)	Weight Lbs. / Ft.	Setting Depth	Type of Cement	# Sacks Used	Type and Percent Additives

ADDITIONAL CEMENTING / SQUEEZE RECORD				
Purpose:	Depth Top Bottom	Type of Cement	# Sacks Used	Type and Percent Additives
<input type="checkbox"/> Perforate				
<input type="checkbox"/> Protect Casing				
<input type="checkbox"/> Plug Back TD				
<input type="checkbox"/> Plug Off Zone				

Did you perform a hydraulic fracturing treatment on this well? ☐ Yes ☐ No (If No, skip questions 2 and 3)

Does the volume of the total base fluid of the hydraulic fracturing treatment exceed 350,000 gallons? ☐ Yes ☐ No (If No, skip question 3)

Was the hydraulic fracturing treatment information submitted to the chemical disclosure registry? ☐ Yes ☐ No (If No, fill out Page Three of the ACO-1)

Shots Per Foot	PERFORATION RECORD - Bridge Plugs Set/Type Specify Footage of Each Interval Perforated		Acid, Fracture, Shot, Cement Squeeze Record (Amount and Kind of Material Used)		Depth
TUBING RECORD: Size: Set At: Packer At:			Liner Run: <input type="checkbox"/> Yes <input type="checkbox"/> No		
Date of First, Resumed Production, SWD or ENHR.		Producing Method: <input type="checkbox"/> Flowing <input type="checkbox"/> Pumping <input type="checkbox"/> Gas Lift <input type="checkbox"/> Other (Explain) _____			
Estimated Production Per 24 Hours	Oil Bbls.	Gas Mcf	Water Bbls.	Gas-Oil Ratio	Gravity

<p>DISPOSITION OF GAS:</p> <p><input type="checkbox"/> Vented <input type="checkbox"/> Sold <input type="checkbox"/> Used on Lease</p> <p><i>(If vented, Submit ACO-18.)</i></p>		<p>METHOD OF COMPLETION:</p> <p><input type="checkbox"/> Open Hole <input type="checkbox"/> Perf. <input type="checkbox"/> Dually Comp. <input type="checkbox"/> Commingled</p> <p><i>(Submit ACO-5)</i></p> <p><input type="checkbox"/> Other <i>(Specify)</i> _____</p>	<p>PRODUCTION INTERVAL:</p> <p>_____</p> <p>_____</p>
--	--	--	---

Form	ACO1 - Well Completion
Operator	Bach, Jason dba Bach Oil Production
Well Name	Lela 2
Doc ID	1218048

Tops

Name	Top	Datum
Stone Corral	1721	+407
Base SC	1752	+376
Topeka	3122	-994
Heebner	3322	-1194
Toronto	3344	-1216
Lansing	3358	-1230
Muncie	3473	-1345
Stark	3533	-1405
Arbuckle	3600	-1472

Form	ACO1 - Well Completion
Operator	Bach, Jason dba Bach Oil Production
Well Name	Lela 2
Doc ID	1218048

Casing

Purpose Of String	Size Hole Drilled	Size Casing Set	Weight	Setting Depth	Type Of Cement	Number of Sacks Used	Type and Percent Additives
Surface	12.25	8.625	23	220	Class A Common	175	3% CC/2% Gel
Production	7.875	5.50	16	3669	AMD	600	2% CC/2% Gel/10% Salt

GEOLOGIST'S REPORT

DRILLING TIME AND SAMPLE LOG

BACH OIL PRODUCTION

WELL: LELA #2

LOC.:1485' FNL & 1680' FEL
SEC. 27-6-20W
ROOKS COUNTY, KANSAS
API: 15-163-24206-00-00

DRILLING CONTR.: MURFIN RIG #24
SPUD: 4-28-14 COMP: 05-02-14
MUD UP: 2786' TYPE MUD: CHEM.
DRILL TIME: 3000 to' RTD
RTD: 3670' LTD: 3664'
SAMPLES SAVED: 3000'-RTD
GEOLOGIST: ROBERT J. PETERSEN

ELEVATION

KB: 2128
GL: 2123
LOG MEASURED
FROM: KB

SURFACE CASING

20# 8 5/8 "
Casing set @ 220'
w/175 SX

PRODUCTION CASING

5 1/2" Casing set

WELL LOG SURVEYS

DIL/CDL

ELECTRIC LOG TOPS

FORMATION	DEPTH	DATUM	POS. A	POS. B
STONE CORRAL	1721	+407	+1	-2
BASE SC	1752	+376	FLAT	-2
TOPEKA	3122	-994	+2	FLAT
HEEBNER	3322	-1194	-5	-1
TORONTO	3344	-1216	+4	+1
LANSING	3358	-1230	+2	FLAT
MUNCIE	3473	-1345	+2	+3
STARK	3533	-1405	FLAT	+3
ARBUCKLE	3600	-1472	-4	+11

REMARKS AND RECOMMENDATIONS

Prodcution casing was set to further test this well.

Respectfully submitted,

Robert J. Petersen
Robert J. Petersen

DAILY REPORT

@7:00 A.M.

4-28-14 MIRU/SPUD
4-29-14 210' (Drilling out surface)
4-30-14 1780'
5-1-14 2830'
5-2-14 3420'
5-3-14 3670' (conditioning hole for casing)

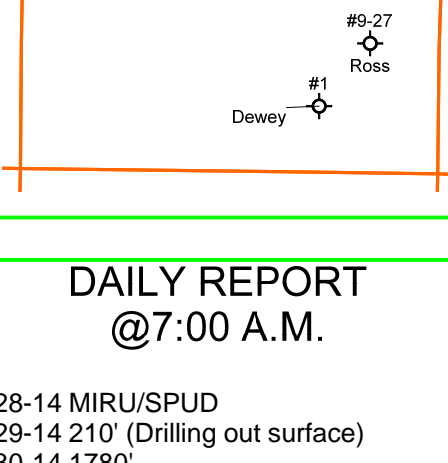

SAMPLE DESCRIPTION

LS; Cream/gray, fine crystalline to dense, foss (3010)

LS; Tan, fine crystalline, foss w/fair moldic por (barren) + SH; Gray (3020)

LS; Cream, fine crystalline, foss, chalky + SH; Red/black (3030)

LS; Cream/gray, fine crystalline to dense, foss, chalky (3040)

SH; Gray, silty-sandy, calc (3050)

SD; Gray, fine grained, micaceous (3060)

LS; Gray, dense, foss (3070)

LS; Cream/gray, fine crystalline, fossil mottled (3080)

SD; Gray, fine grained, micaceous, friable, gsfo (dark brown) (3090)

LS; Gray, dense, foss, cherty, trace stain (3100)

LS; Cream, fine crystalline, foss (3110)

LS; Gray w/cream mottle, very foss, chalky (3120)

SD; Gray, fine to med, friable, micaceous, trace dead stain + SH; Red/gray (3130)

SH; Dark gray (3140)

LS; Cream, fine crystalline, foss, granular w/poor ppt por, trace stain + LS; Gray, dense (3140)

LS; Gray/tan, dense, foss, arg + SH; Dark gray (3150)

LS; Gray, dense, foss, cherty + SH; Gray (3160)

SH; Dark gray (3170)

LS; Tan/cream, fine crystalline, foss, chalky (3170)

SH; Dark gray (3180)

SH; Gray (3190)

LS; Cream/tan, fine crystalline to dense, chalky (3200)

LS; Cream, fine crystalline, trace ool, chalky (3220)

LS; Gray, fine crystalline, foss, cherty, trace ppt por, trace stain (3230)

LS; Cream/tan, fine crystalline, foss, chalky (3240)

SH; Black (3240)

SH; Red/gray, silty, sandy (3250)

LS; Cream/tan, fine crystalline, foss, chalky, cherty, trace stain (3250)

LS; Cream, fine crystalline to dense, chalky (3260)

SH; Gray, silty-sandy (3270)

LS; Cream/gray, fine crystalline to dense, ool w/trace gray stain (3280)

SH; Black (3280)

LS; Tan/cream, fine crystalline, foss, sl dolo, chalky, trace poor ppt por, ssfo (3290)

LS; Cream/tan, fine crystalline to dense, foss chalky, trace edge stain (3300)

LS; Tan/gray, dense, very chalky foss, dol, poor vug por, ssfo (3310)

LS; Cream, fine crystalline to dense, ool, chalky, cherty (3313/30")

LS; Cream/white, fine crystalline, chalky (3320)

LS; Cream/gray, fine crystalline, sl foss, trace ppt moldic por, trace dark tarry oil stain (3340)

SH; Black (3340)

LS; Gray, hard, dense (3350)

SH; Gray/red, silty-sandy (3350-3360)

LS; Cream/white, fine crystalline, foss, chalky, cherty, trace poor moldic por, sfo (3370)

SH; Gray (3380)

LS; Cream, fine crystalline, foss/ool, granular w/fair to good, moldic por, sfo, good odor (3380)

LS; Cream, fine crystalline to dense, sl foss, dolo w/sharp chert (3390)

LS; Cream, fine crystalline to dense, chalky (3400) with black chert (3410)

SH; Black (3410)

SH; Red/gray, silty-sandy (3410)

LS; Cream, fine crystalline, ool/foss w/trace poor moldic/inter-gran por, sfo, faint odor (3410/20")

SH; Red, silty (3420)

LS; Cream, fine crystalline, foss, granular in part w/fair moldic por, sfo, odor (3430)

SH; Dark gray (3450)

LS; Cream, fine crystalline, foss, granular in part, cherty w/fair moldic /vug por, sfo, odor (3450)

SH; Red (3460)

LS; Cream, fine crystalline, foss, w/fair to good moldic por, sfo, odor (3460)

LS; Cream/tan, fine crystalline w/coarse crystalline calcite regrowth, foss, chalky, cherty (3470)

LS; Gray/tan, fine crystalline w/trace ppt por, trace stain (3480)

SH; Black (3490)

SH; Red, silty (3490)

LS; Cream, fine crystalline, cherty (cream/orange mottle) chalky, trace moldic por, ssfo (3500)

LS; Cream, fine crystalline to dense, foss, cherty (3510)

SH; Red/gray (3520)

LS; Tan, fine crystalline, sl foss, granular in part w/fair moldic por, gsfo, odor (3520)

LS; Cream, fine crystalline to dense, foss, ppt moldic por, deep saturation, gsfo, odor (3530)

LS; Cream/tan, fine crystalline, w/good oomoldic por, saturation, sfo, odor (3540)

LS; Tan/gray, dense, foss, moldic por, ssfo (3550)

SH; Gray (3550)

LS; Cream, fine crystalline, sl foss, chalky, trace fair moldic por, sfo, fair odor (3560)

LS; Tan, fine crystalline, sl foss, sl dolo (3570)

SH; Black (3580)

LS; Cream/tan (mottled in part), fine crystalline to dense, foss, trace moldic por, sfo (black) (3580)

SH; Red, sandy, calcareous (3590)

LS; Cream/tan, fine crystalline to dense, foss, trace stain (3600)

SH; Red/gray, sandy (3610)

LS; Cream/white, fine crystalline, chalky + Trace SD; Clear, fine to coarse, well-rounded, calc, ssdo (3620)

Dolo; Tan, fine to med crystalline, sl ool, w/fair to good moldic/vug por, gsfo, odor, dark sat dry (3630)

Dolo; Gray, fine to coarse crystalline, increase ool, moldic por, sfo, odor, dark sat dry + Dolo; Cream, fine to med crystalline, chalky (3640)

Dolo; Cream, fine crystalline, sucrosic, sl foss w/fair moldic por, sfo (black) odor (3650)

Dolo; Cream, fine to med crystalline, sucrosic, chalky (3660)

trace pink coarse crystalline dolo (3670)

Dolo; Cream/tan, med to coarse crystalline, chalky, barren vug por (3670/45")

Drill Time in Minutes

0 5 10

Top Stone Corral

Base Stone Corral

Lower Tarkio SD

Howard

Severy

Topeka

Oread

Heebner

Toronto

Lansing

C Zone

D Zone

F Zone

G Zone

Muncie

H Zone

I Zone

J Zone

Stark

K Zone

BKC

Arbuckle

RTD 3670

SURVEY:

1/4 Degree @220'

1/4 Degree @3313'

1/2 Degree @3670'



PO Box 93999
Southlake, TX 76092

Voice: (817) 546-7282
Fax: (817) 246-3361

INVOICE

Invoice Number: 142895
Invoice Date: Apr 28, 2014
Page: 1

Bill To:

Bach Oil Production
82 W. 500 Ln.
Phillipsburg, KS 67661

Customer ID	Field Ticket #	Payment Terms	
Bach	55199	Net 30 Days	
Job Location	Camp Location	Service Date	Due Date
KS2-01	Russell	Apr 28, 2014	5/28/14

Quantity	Item	Description	Unit Price	Amount
1.00	WELL NAME	Lela #2		
175.00	CEMENT MATERIALS	Class A Common	17.90	3,132.50
330.00	CEMENT MATERIALS	Gel	0.24	79.20
495.00	CEMENT MATERIALS	Chloride	0.80	396.00
175.00	CEMENT SERVICE	Cubic Feet Charge	2.48	434.00
412.50	CEMENT SERVICE	Ton Mileage Charge	2.60	1,072.50
1.00	CEMENT SERVICE	Surface	1,512.25	1,512.25
50.00	CEMENT SERVICE	Heavy Vehicle Mileage	7.70	385.00
50.00	CEMENT SERVICE	Light Vehicle Mileage	4.40	220.00
1.00	CEMENT SUPERVISOR	Tony Pfannenstiel		
1.00	OPERATOR ASSISTANT	Danny Sinner		
1.00	OPERATOR ASSISTANT	Joe Goodson		

ALL PRICES ARE NET, PAYABLE
30 DAYS FOLLOWING DATE OF
INVOICE. 1 1/2% CHARGED
THEREAFTER. IF ACCOUNT IS
CURRENT, TAKE DISCOUNT OF

\$ 1,735.54

ONLY IF PAID ON OR BEFORE
May 23, 2014

Subtotal	7,231.45
Sales Tax	221.87
Total Invoice Amount	7,453.32
Payment/Credit Applied	
TOTAL	7,453.32

ALLIED OIL & GAS SERVICES, LLC 005199

Federal Tax I.D.# 20-5975804

REMIT TO P.O. BOX 31
RUSSELL, KANSAS 67665

SERVICE POINT: Russell, KS

DATE <u>4-28-14</u>	SEC <u>27</u>	TWP <u>6</u>	RANGE <u>20</u>	CALLED OUT	ON LOCATION	JOB START <u>800</u>	JOB FINISH <u>530</u>
LEASE <u>Lela</u>	WELL # <u>2</u>	LOCATION <u>Stockton KS</u>			COUNTY <u>Rooks</u>	STATE <u>KS</u>	
OLD OR NEW (Circle one)		<u>N to rd E W 13 1/2 m S 140</u>					

CONTRACTOR <u>MURFIN #24</u>	OWNER
TYPE OF JOB <u>SW 1/4</u>	CEMENT
HOLE SIZE <u>12 1/4 8 5/8</u>	AMOUNT ORDERED <u>175 SN con</u>
CASING SIZE <u>8 5/8</u>	<u>31.00 + 21.00</u>
TUBING SIZE	
DRILL PIPE	
TOOL	
PRES. MAX	COMMON <u>175 SN</u> @ <u>17.9</u> \$ <u>3,132.50</u>
MEAS. LINE	POZMIX @
CEMENT LEFT IN CSG. <u>15'</u>	GEL <u>330 lb</u> @ <u>.24</u> \$ <u>79.20</u>
PERFS.	CHLORIDE <u>495 lb</u> @ <u>.80</u> \$ <u>396.00</u>
DISPLACEMENT <u>13.05 bbl/100</u>	ASC @

EQUIPMENT	
PUMP TRUCK	CEMENTER <u>Anthony Plummer</u>
# <u>417</u>	HELPER <u>Danny S.</u>
BULK TRUCK	
# <u>410</u>	DRIVER <u>Joe B.</u>
BULK TRUCK	
#	DRIVER

REMARKS:

<u>Material</u>	@	<u>3609.70</u>
<u>Disc.</u>	@	<u>865.84</u>
	@	
	@	
	@	
	@	
HANDLING <u>175 SN</u>	@ <u>2.48</u>	\$ <u>434.00</u>
MILEAGE <u>41.20</u>	@ <u>2.50</u>	\$ <u>1,030.00</u>
		TOTAL <u>5,114.20</u>

SERVICE

DEPTH OF JOB	<u>220'</u>
PUMP TRUCK CHARGE	<u>\$1,512.25</u>
EXTRA FOOTAGE	@
MILEAGE <u>Heavy 50</u>	@ <u>7.7</u> \$ <u>385.00</u>
MANIFOLD <u>Light 50</u>	@ <u>4.4</u> \$ <u>220.00</u>
	@
	@

CHARGE TO: Back Oil

STREET

CITY STATE ZIP

Added 869.70 TOTAL 3,623.25

PLUG & FLOAT EQUIPMENT

	@	
	@	
	@	
	@	
	@	
		TOTAL <u>0</u>

To: Allied Oil & Gas Services, LLC.
You are hereby requested to rent cementing equipment and furnish cementer and helper(s) to assist owner or contractor to do work as is listed. The above work was done to satisfaction and supervision of owner agent or contractor. I have read and understand the "GENERAL TERMS AND CONDITIONS" listed on the reverse side.

PRINTED NAME Anthony Martin

SIGNATURE Anthony Martin

SALES TAX (If Any)

TOTAL CHARGES \$7,231.45

DISCOUNT \$1,735.54 (PAID IN 30 DAYS)

Net 5495.91



PO Box 93999
Southlake, TX 76092

Voice: (817) 546-7282
Fax: (817) 246-3361

INVOICE

Invoice Number: 143042

Invoice Date: May 3, 2014

Page: 1

Bill To:

Bach Oil Production
82 W. 500 Ln.
Phillipsburg, KS 67661

Customer ID	Field Ticket #	Payment Terms	
Bach	55233	Net 30 Days	
Job Location	Camp Location	Service Date	Due Date
KS2-02	Russell	May 3, 2014	6/2/14

Quantity	Item	Description	Unit Price	Amount
1.00	WELL NAME	Lela #2		
258.00	CEMENT MATERIALS	Chloride	0.80	206.40
450.00	CEMENT MATERIALS	AMD	25.90	11,655.00
150.00	CEMENT MATERIALS	60/40 Mix	14.93	2,239.50
2,250.00	CEMENT MATERIALS	Gilsonite	0.98	2,205.00
1,787.00	CEMENT MATERIALS	Salt	0.53	947.11
600.00	CEMENT SERVICE	Cubic Feet Charge	2.48	1,488.00
1,380.00	CEMENT SERVICE	Ton Mileage Charge	2.60	3,588.00
1.00	CEMENT SERVICE	Long String	2,558.75	2,558.75
50.00	CEMENT SERVICE	Light Vehicle Mileage	4.40	220.00
1.00	CEMENT SERVICE	Manifold Rental	275.00	275.00
150.00	CEMENT SERVICE	Heavy Vehicle Mileage	7.70	1,155.00
1.00	EQUIPMENT SALES	5-1/2 AFU Float Shoe	545.00	545.00
1.00	EQUIPMENT SALES	5-1/2 Latch Down	660.00	660.00
5.00	EQUIPMENT SALES	5-1/2 Basket	395.00	1,975.00
10.00	EQUIPMENT SALES	5-1/2 Centralizer	57.00	570.00
1.00	CEMENT SUPERVISOR	Robert Yakubovich		
1.00	EQUIPMENT OPERATOR	Nathan Donner		
1.00	OPERATOR ASSISTANT	Tracy Jordan		
1.00	EQUIPMENT OPERATOR	Kevin Rupp		

ALL PRICES ARE NET, PAYABLE
30 DAYS FOLLOWING DATE OF
INVOICE. 1 1/2% CHARGED
THEREAFTER. IF ACCOUNT IS
CURRENT, TAKE DISCOUNT OF

\$ 6,057.55

ONLY IF PAID ON OR BEFORE
May 28, 2014

Subtotal	30,287.76
Sales Tax	1,291.69
Total Invoice Amount	31,579.45
Payment/Credit Applied	
TOTAL	31,579.45

ALLIED OIL & GAS SERVICES, LLC 055233

Federal Tax I.D.# 20-5975804

REMIT TO P.O. BOX 31
RUSSELL, KANSAS 67665

SERVICE POINT:

Russell KS

DATE <u>5-3-14</u>	SEC. <u>27</u>	TWP. <u>6</u>	RANGE <u>20</u>	CALLED OUT	ON LOCATION	JOB START <u>7:00 PM</u>	JOB FINISH <u>7:30 PM</u>
LEASE <u>Le 19</u>	WELL # <u>2</u>	LOCATION <u>Stockton KS 5N 13 1/2 W</u>			COUNTY <u>Rooks</u>	STATE <u>KS</u>	
OLD OR <u>NEW</u> (Circle one)		Sinto					

CONTRACTOR Martin 24
TYPE OF JOB long string
HOLE SIZE 7 7/8 T.D. 3670
CASING SIZE 5 1/2 15.5 DEPTH 3669.29
TUBING SIZE DEPTH
DRILL PIPE DEPTH
TOOL DEPTH
PRES. MAX MINIMUM
MEAS. LINE SHOE JOINT 13.75
CEMENT LEFT IN CSG. 13.75
PERFS.
DISPLACEMENT 8.1661

EQUIPMENT

PUMP TRUCK CEMENTER Robert V
409 HELPER Nathan D
BULK TRUCK
481 DRIVER Tracy J
BULK TRUCK
378 DRIVER Kevin R

REMARKS:

see log

Cement did circulate to surface
pump 40 strokes to pit

Thank you !!!

CHARGE TO: Bach Oil Productions
STREET
CITY STATE ZIP

OWNER

CEMENT
AMOUNT ORDERED 450 AND 5th Gilsonite/st
150 60 40 270 gal 10% salt 270cc

COMMON	@		
POZMIX	@		
GEL	@		
CHLORIDE <u>258th</u>	@	<u>0.80</u>	<u>206.40</u>
ASC	@		
<u>AND 450</u>	@	<u>25.90</u>	<u>11655.00</u>
<u>60 40 mix 150</u>	@	<u>19.93</u>	<u>2239.50</u>
<u>Gilsonite 2250th</u>	@	<u>0.98</u>	<u>2205.00</u>
<u>Salt 1787th</u>	@	<u>0.53</u>	<u>947.11</u>
	@		
<u>Material</u>	@		<u>17,253.01</u>
<u>Discount</u>	@		<u>8450.60</u>
	@		
HANDLING <u>600 stks</u>	@	<u>2.48</u>	<u>1488.00</u>
MILEAGE <u>1380 1/2 mi</u>	@	<u>2.60</u>	<u>3588.00</u>

TOTAL 17,253.01
27,591.01

SERVICE

DEPTH OF JOB		<u>3669</u>
PUMP TRUCK CHARGE		<u>2,558.75</u>
EXTRA FOOTAGE	@	
MILEAGE <u>50 LVAI</u>	@	<u>4.40 220.00</u>
MANIFOLD	@	<u>28.00 275.00</u>
<u>150 HVAI</u>	@	<u>7.70 1155.00</u>
	@	

4284.75

Less 1856.95

TOTAL 4208.75

PLUG & FLOAT EQUIPMENT

WF 5 1/2 AFU E bal shoe	@	<u>595.00</u>	<u>595.00</u>
WF 1 1/2 gal down	@	<u>660.00</u>	<u>660.00</u>
WF baskets 5	@	<u>375.00</u>	<u>1875.00</u>
WF centralizers 10	@	<u>57.00</u>	<u>570.00</u>
	@		

Less 750.00

TOTAL 3750.00

SALES TAX (If Any)

TOTAL CHARGES 30,287.76

DISCOUNT 6057.55 (20%) IF PAID IN 30 DAYS

Net \$

24,230.21

To: Allied Oil & Gas Services, LLC.
You are hereby requested to rent cementing equipment and furnish cementer and helper(s) to assist owner or contractor to do work as is listed. The above work was done to satisfaction and supervision of owner agent or contractor. I have read and understand the "GENERAL TERMS AND CONDITIONS" listed on the reverse side.

PRINTED NAME

SIGNATURE Paul [Signature]

