

**WOOLSEY OPERATING COMPANY, LLC  
CUNNINGHAM LEASE  
SE.1/4, SECTION 10, T32S, R12W  
BARBER COUNTY, KANSAS**

NO

ROAD

**Notes:**

1. Set iron rod at location site.
2. All flagging Red & Yellow.
3. Overhead power available along Highway 160.
4. Kansas One Call System Inc. should be notified before excavation (1-800-344-7233).
5. CAUTION; Various pipelines in Sec.10.
6. Contact landowner for best access.
7. Original location (330'FSL 660'FEL) fell among pipelines, set new location footages per representative.

ROAD

(WOODWARD RD.) NO ROAD

10

**HIGHWAY 160**

Lease road  
PRODUCER

Tank battery  
for #6 & #7

**Drillsite Location  
Cunningham #7  
405'FSL 810'FEL**

**Ground Elevation = 1512  
Y = 219573 X = 1968767**

State Plane-NAD 27-Kansas South  
(Mapping Grade GPS Used)

**Latitude 37°16'11.0"  
Longitude -98°36'27.7"**

WGS 84-NAD 83

(WALSTEAD RD.)

PASTURE

Access road  
to location

SW line to  
Jacobs SWD

NO ROAD

DIRT ROAD

SAND ROAD

\*Ingress and egress to location as shown on this plat is per usage only and may not be legally opened for public use. Contact landowner, tenant and county road department for access.

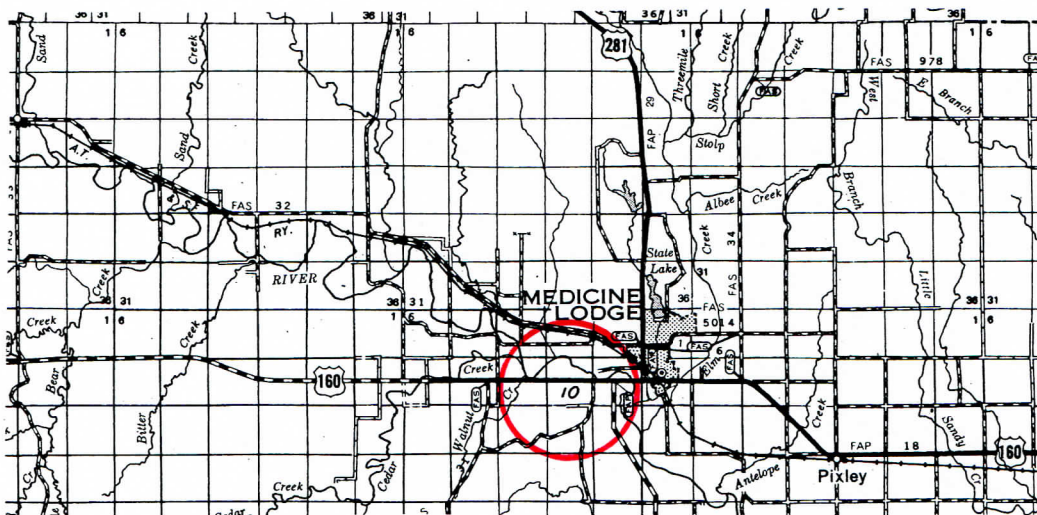

\* Controlling data is based upon the best maps and photographs available to us and upon a regular section of land containing 640 acres.

\* Approximate section lines were determined using the normal standard of care of oilfield surveyors practicing in the state of Kansas. The section corners, which establish the precise section lines, were not necessarily located, and the exact location of the drillsite location in the section is not guaranteed. Therefore, the operator securing this service and accepting this plat and all other parties relying thereon agree to hold Central Kansas Oilfield Services, Inc., its officers and employees harmless from all losses, costs and expenses and said entities released from any liability from incidental or consequential damages.

\* Elevations derived from National Geodetic Vertical Datum.

Date August 28, 2014

**CENTRAL KANSAS OILFIELD SERVICES, INC. (620)792-1977**