

**For KCC Use:**

Effective Date: _____

District # _____

SGA? ☐ Yes ☐ No**KANSAS CORPORATION COMMISSION
OIL & GAS CONSERVATION DIVISION****1223427****Form CB-1**

March 2010

Form must be Typed**Form must be Signed****All blanks must be Filled****CATHODIC PROTECTION BOREHOLE INTENT***Must be approved by the KCC sixty (60) days prior to commencing well.***Form KSONA-1, Certification of Compliance with the Kansas Surface Owner Notification Act, MUST be submitted with this form.**Expected Spud Date: _____
month day year

OPERATOR: License# _____

Name: _____

Address 1: _____

Address 2: _____

City: _____ State: _____ Zip: _____ + _____

Contact Person: _____

Phone: _____

CONTRACTOR: License# _____

Name: _____

Type Drilling Equipment: ☐ Mud Rotary ☐ Cable☐ Air Rotary ☐ Other**Construction Features**

Length of Cathodic Surface (Non-Metallic) Casing

Planned to be set: _____ feet

Length of Conductor pipe (if any): _____ feet

Surface casing borehole size: _____ inches

Cathodic surface casing size: _____ inches

Cathodic surface casing centralizers set at depths of: _____ ; _____ ;

_____ ; _____ ; _____ ; _____ ; _____ ; _____ ; _____ ;

Cathodic surface casing will terminate at:

☐ Above surface ☐ Surface Vault ☐ Below Surface VaultPitless casing adaptor will be used: ☐ Yes ☐ No Depth _____ feet

Anode installation depths are: _____ ; _____ ; _____ ; _____ ; _____ ;

_____ ; _____ ; _____ ; _____ ; _____ ; _____ ; _____ ;

AFFIDAVIT

The undersigned hereby affirms that the drilling, completion and eventual plugging of this well will comply with K.S.A. 55-101 et. seq.

It is agreed that the following minimum requirements will be met:

1. Notify the appropriate District office prior to spudding and again before plugging the well. An agreement between the operator and the District Office on plugs and placement is necessary prior to plugging. In all cases, notify District Office prior to any grouting.
2. Notify appropriate District Office 48 hours prior to workover or re-entry.
3. A copy of the approved notice of intent to drill shall be posted on each drilling rig.
4. The minimum amount of cathodic surface casing as specified below shall be set by grouting to the top when the cathodic surface casing is set.
5. File all required forms: a. File Drill Pit Application (form CDP-1) with Intent to Drill (form CB-1). b. File Certification of Compliance with Kansas Surface Owner Notification Act (form KSONA-1) with Cathodic Protection Borehole Intent (CB-1) c. File Completion Form (ACO-1) within 30 days from spud date. d. Submit plugging report (CP-4) within 30 days after final plugging is completed.

Submitted Electronically**For KCC Use ONLY**

API # 15 - _____

Conductor pipe required _____ feet

Minimum Cathodic Surface Casing Required: _____ feet

Approved by: _____

This authorization expires: _____

(This authorization void if drilling not started within 12 months of approval date.)

Spud date: _____ Agent: _____

Spot Description: _____

_____ - _____ - _____ - _____ Sec. _____ Twp. _____ S. R. _____ ☐ E ☐ W
(Q/Q/Q/Q) _____ feet from ☐ N / ☐ S Line of Section_____ feet from ☐ E / ☐ W Line of SectionIs SECTION: ☐ Regular ☐ Irregular?

(Check directions from nearest outside corner boundaries)

County: _____

Facility Name: _____

Borehole Number: _____

Ground Surface Elevation: _____ MSL

Cathodic Borehole Total Depth: _____ feet

Depth to Bedrock: _____ feet

Water InformationAquifer Penetration: ☐ None ☐ Single ☐ Multiple

Depth to bottom of fresh water: _____

Depth to bottom of usable water: _____

Water well within one-quarter mile: ☐ Yes ☐ NoPublic water supply well within one mile: ☐ Yes ☐ No

Water Source for Drilling Operations:

☐ Well ☐ Farm Pond ☐ Stream ☐ Other

Water Well Location: _____

DWR Permit # _____

Standard Dimension Ratio (SDR) is = _____

(Cathodic surface csg. O.D. in inches / MWT in inches = SDR)

Annular space between borehole and casing will be grouted with:

☐ Concrete ☐ Neat Cement ☐ Bentonite Cement ☐ Bentonite Clay

Anode vent pipe will be set at: _____ feet above surface

Anode conductor (backfill) material TYPE: _____

Depth of BASE of Backfill installation material: _____

Depth of TOP of Backfill installation material: _____

Borehole will be Pre-Plugged? ☐ Yes ☐ No

If this permit has expired or will not be drilled, check a box below, sign, date and return to the address below.

☐ Permit Expired ☐ Well Not Drilled

Date

Signature of Operator or Agent

1223427

For KCC Use ONLY

API # 15 - _____

IN ALL CASES, PLEASE FULLY COMPLETE THIS SIDE OF THE FORM.

In all cases, please fully complete this side of the form. Include items 1 through 3 at the bottom of this page.

Operator: _____

Facility Name: _____

Borehole Number: _____

Location of Well: County: _____

_____ feet from ☐ N / ☐ S Line of Section
_____ feet from ☐ E / ☐ W Line of SectionSec. _____ Twp. _____ S. R. _____ ☐ E ☐ WIs Section: ☐ Regular or ☐ Irregular**If Section is Irregular, locate well from nearest corner boundary.**Section corner used: ☐ NE ☐ NW ☐ SE ☐ SW**PLAT**

Show location of the Cathodic Borehole. Show footage to the nearest lease or unit boundary line. Show the predicted locations of lease roads, tank batteries, pipelines and electrical lines, as required by the Kansas Surface Owner Notice Act (House Bill 2032).
You may attach a separate plat if desired.

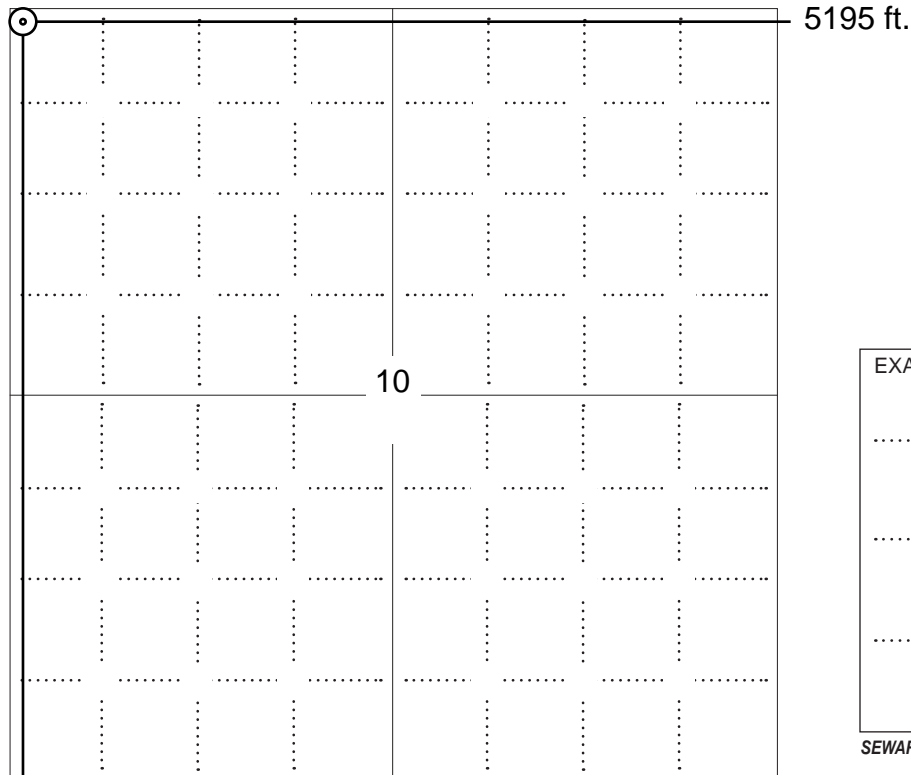
**LEGEND**

- ☐ Well Location
- ☐ Tank Battery Location
- ☐ Pipeline Location
- ☐ Electric Line Location
- ☐ Lease Road Location

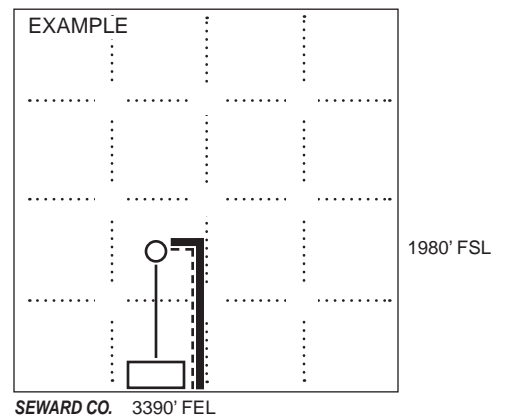
**NOTE: In all cases locate the spot of the proposed drilling location.**

5173 ft.

In plotting the proposed location of the well, you must show:

1. The manner in which you are using the depicted plat by identifying section lines, i.e. 1 section, 1 section with 8 surrounding sections, 4 sections, etc.;
2. The distance of the proposed drilling location from the section's south / north and east / west; line.
3. The predicted locations of lease roads, tank batteries, pipelines, and electrical lines.

KANSAS CORPORATION COMMISSION
OIL & GAS CONSERVATION DIVISION

1223427

Form CDP-1
May 2010
Form must be Typed

APPLICATION FOR SURFACE PIT

Submit in Duplicate

Operator Name:		License Number:	
Operator Address:			
Contact Person:		Phone Number:	
Lease Name & Well No.:		Pit Location (QQQQ): ____ - ____ - ____ - ____ Sec. ____ Twp. ____ R. ____ <input type="checkbox"/> East <input type="checkbox"/> West ____ Feet from <input type="checkbox"/> North / <input type="checkbox"/> South Line of Section ____ Feet from <input type="checkbox"/> East / <input type="checkbox"/> West Line of Section ____ County	
Type of Pit: <input type="checkbox"/> Emergency Pit <input type="checkbox"/> Burn Pit <input type="checkbox"/> Settling Pit <input type="checkbox"/> Drilling Pit <input type="checkbox"/> Workover Pit <input type="checkbox"/> Haul-Off Pit <i>(If WP Supply API No. or Year Drilled)</i>	Pit is: <input type="checkbox"/> Proposed <input type="checkbox"/> Existing If Existing, date constructed: _____ Pit capacity: _____ (bbls)		
Is the pit located in a Sensitive Ground Water Area? <input type="checkbox"/> Yes <input type="checkbox"/> No		Chloride concentration: _____ mg/l <i>(For Emergency Pits and Settling Pits only)</i>	
Is the bottom below ground level? <input type="checkbox"/> Yes <input type="checkbox"/> No	Artificial Liner? <input type="checkbox"/> Yes <input type="checkbox"/> No	How is the pit lined if a plastic liner is not used?	
Pit dimensions (all but working pits): _____ Length (feet) _____ Width (feet) <input type="checkbox"/> N/A: Steel Pits Depth from ground level to deepest point: _____ (feet) <input type="checkbox"/> No Pit			
If the pit is lined give a brief description of the liner material, thickness and installation procedure.		Describe procedures for periodic maintenance and determining liner integrity, including any special monitoring.	
Distance to nearest water well within one-mile of pit: _____ feet Depth of water well _____ feet		Depth to shallowest fresh water _____ feet. Source of information: <input type="checkbox"/> measured <input type="checkbox"/> well owner <input type="checkbox"/> electric log <input type="checkbox"/> KDWR	
Emergency, Settling and Burn Pits ONLY: Producing Formation: _____ Number of producing wells on lease: _____ Barrels of fluid produced daily: _____ Does the slope from the tank battery allow all spilled fluids to flow into the pit? <input type="checkbox"/> Yes <input type="checkbox"/> No		Drilling, Workover and Haul-Off Pits ONLY: Type of material utilized in drilling/workover: _____ Number of working pits to be utilized: _____ Abandonment procedure: _____ Drill pits must be closed within 365 days of spud date.	
Submitted Electronically			

KCC OFFICE USE ONLY

☐ Liner ☐ Steel Pit ☐ RFAC ☐ RFAS

Date Received: _____ Permit Number: _____ Permit Date: _____ Lease Inspection: ☐ Yes ☐ No

Mail to: KCC - Conservation Division, 130 S. Market - Room 2078, Wichita, Kansas 67202



CERTIFICATION OF COMPLIANCE WITH THE KANSAS SURFACE OWNER NOTIFICATION ACT

This form must be submitted with all Forms C-1 (Notice of Intent to Drill); CB-1 (Cathodic Protection Borehole Intent); T-1 (Request for Change of Operator Transfer of Injection or Surface Pit Permit); and CP-1 (Well Plugging Application). Any such form submitted without an accompanying Form KSONA-1 will be returned.

Select the corresponding form being filed: ☐ C-1 (Intent) ☐ CB-1 (Cathodic Protection Borehole Intent) ☐ T-1 (Transfer) ☐ CP-1 (Plugging Application)

OPERATOR: License # _____

Name: _____

Address 1: _____

Address 2: _____

City: _____ State: _____ Zip: _____ + _____

Contact Person: _____

Phone: (_____) _____ Fax: (_____) _____

Email Address: _____

Well Location:

____ - ____ - ____ Sec. ____ Twp. ____ S. R. ____ ☐ East ☐ West

County: _____

Lease Name: _____ Well #: _____

If filing a Form T-1 for multiple wells on a lease, enter the legal description of the lease below:

Surface Owner Information:

Name: _____

Address 1: _____

Address 2: _____

City: _____ State: _____ Zip: _____ + _____

When filing a Form T-1 involving multiple surface owners, attach an additional sheet listing all of the information to the left for each surface owner. Surface owner information can be found in the records of the register of deeds for the county, and in the real estate property tax records of the county treasurer.

If this form is being submitted with a Form C-1 (Intent) or CB-1 (Cathodic Protection Borehole Intent), you must supply the surface owners and the KCC with a plat showing the predicted locations of lease roads, tank batteries, pipelines, and electrical lines. The locations shown on the plat are preliminary non-binding estimates. The locations may be entered on the Form C-1 plat, Form CB-1 plat, or a separate plat may be submitted.

Select one of the following:

- ☐ I certify that, pursuant to the Kansas Surface Owner Notice Act (House Bill 2032), I have provided the following to the surface owner(s) of the land upon which the subject well is or will be located: 1) a copy of the Form C-1, Form CB-1, Form T-1, or Form CP-1 that I am filing in connection with this form; 2) if the form being filed is a Form C-1 or Form CB-1, the plat(s) required by this form; and 3) my operator name, address, phone number, fax, and email address.
- ☐ I have not provided this information to the surface owner(s). I acknowledge that, because I have not provided this information, the KCC will be required to send this information to the surface owner(s). To mitigate the additional cost of the KCC performing this task, I acknowledge that I must provide the name and address of the surface owner by filling out the top section of this form and that I am being charged a \$30.00 handling fee, payable to the KCC, which is enclosed with this form.

If choosing the second option, submit payment of the \$30.00 handling fee with this form. If the fee is not received with this form, the KSONA-1 form and the associated Form C-1, Form CB-1, Form T-1, or Form CP-1 will be returned.

I Submitted Electronically

I

Sept. 19, 2014

KCC
Conservation Division
266 N. Main St. Suite 220
Wichita KS 67202-1513

Ref. Surface Casing Exception KAR 82-3-702(b)(4) Vilas 14 10-17-28E, Wilson County

Dear Sirs:

Enclosed is a cathodic protection intent for an exception to the minimum surface pipe requirement for a multiple Aquifer cathodic well bore completion, as set out in K.A.R. 82-3-702(b)(4). Southern Star Central Gas Pipeline is requesting to set 20 feet of 10" PVC at 280 feet. Conducrete backfill from 280 feet total depth to surface. The Contractor will be using a mud rotary system to drill the well and steel pits will be utilized. The past Director, Doug Louis, approved conducrete use on July 20, 2007.

Thank you for your consideration of this matter.

Sincerely,

David Wertz
Agent

For KCC Use ONLY

API # 15 - _____

IN ALL CASES, PLEASE FULLY COMPLETE THIS SIDE OF THE FORM.

In all cases, please fully complete this side of the form. Include items 1 through 3 at the bottom of this page.

Operator: SOUTHERN STAR CENTRAL GAS P/L
 Facility Name: VILAS
 Borehole Number: 14

Location of Well: County: WILSON
5173 feet from ☐ N / ☒ S Line of Section
5195 feet from ☒ E / ☐ W Line of Section
 Sec. 10 Twp. 17 S. R. 28 ☒ E ☐ W

Is Section: ☐ Regular or ☒ Irregular

If Section is Irregular, locate well from nearest corner boundary.

Section corner used: ☐ NE ☒ NW ☐ SE ☐ SW**PLAT**

Show location of the Cathodic Borehole. Show footage to the nearest lease or unit boundary line. Show the predicted locations of lease roads, tank batteries, pipelines and electrical lines, as required by the Kansas Surface Owner Notice Act (House Bill 2032).

You may attach a separate plat if desired.

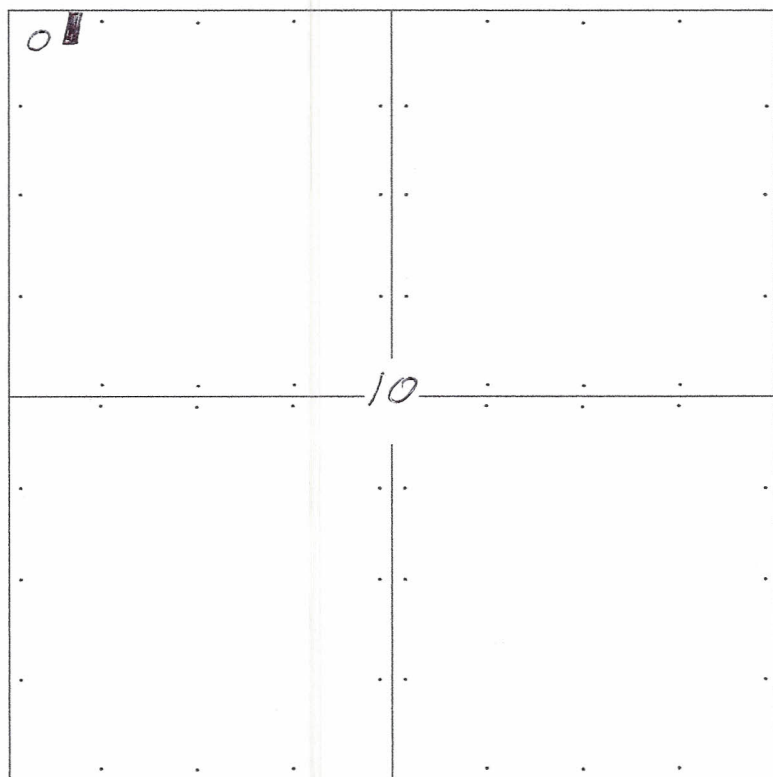
**LEGEND**

- ☐ Well Location
- ☐ Tank Battery Location
- ☐ Pipeline Location
- ☐ Electric Line Location
- ☐ Lease Road Location

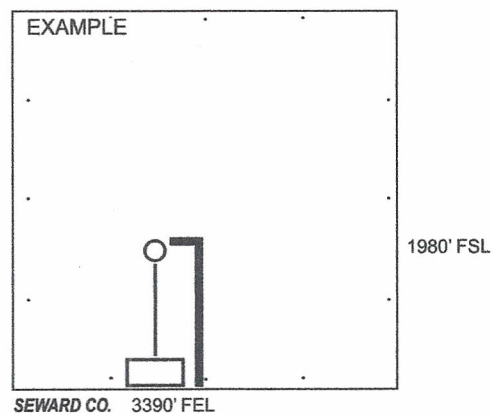
**NOTE:** In all cases locate the spot of the proposed drilling location.**In plotting the proposed location of the well, you must show:**

1. The manner in which you are using the depicted plat by identifying section lines, i.e. 1 section, 1 section with 8 surrounding sections, 4 sections, etc.;
2. The distance of the proposed drilling location from the section's south / north and east / west; line.
3. The predicted locations of lease roads, tank batteries, pipelines, and electrical lines.

Conservation Division
266 N. Main St., Ste. 220
Wichita, KS 67202-1513



Phone: 316-337-6200
Fax: 316-337-6211
<http://kcc.ks.gov/>

Shari Feist Albrecht, Chair
Jay Scott Emler, Commissioner
Pat Apple, Commissioner

Sam Brownback, Governor

September 23, 2014

David Wertz
Southern Star Central Gas Pipeline, Inc.
4700 HWY 56
Owensboro, KY 42301-9303

RE: Request for Cathodic Wellbore Variance
K. A. R. 82-3-702 (b) (4)
Vilas 14
Section 10-T28S-R17E, Wilson County

Dear Mr. Wertz:

The Kansas Corporation Commission has received your request, dated September 19, 2014, for an exception to the minimum surface pipe requirement for a multiple aquifer cathodic well bore completion as set out in K.A.R. 82-3-702(b)(4). From your request, the KCC understands that you are requesting to set 20 feet of 10" PVC casing cemented to surface and utilize Conducrete backfill from 280 feet total depth to 3 feet below surface.

After review of this matter by technical staff it was determined that the proposed construction method will adequately protect fresh and usable water in this area.

Notify the KCC District #3 office prior to spudding the well so they may have the opportunity to witness the well construction procedure.

Sincerely,

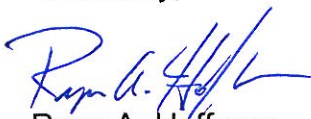

Ryan A. Hoffman
Director

cc: Rene Stucky, Production Supervisor *AS 9-19-14*
Steve Korf - District #3 Supervisor *9-19-14 via e-mail*