

For KCC Use ONLY

API # 15 - _____

IN ALL CASES PLOT THE INTENDED WELL ON THE PLAT BELOW

In all cases, please fully complete this side of the form. Include items 1 through 5 at the bottom of this page.

Operator: _____

Lease: _____

Well Number: _____

Field: _____

Number of Acres attributable to well: _____

QTR/QTR/QTR/QTR of acreage: _____ - _____ - _____ - _____

Location of Well: County: _____

_____ feet from N / S Line of Section

_____ feet from E / W Line of Section

Sec. _____ Twp. _____ S. R. _____ E W

Is Section: Regular or Irregular

If Section is Irregular, locate well from nearest corner boundary.

Section corner used: NE NW SE SW

PLAT

Show location of the well. Show footage to the nearest lease or unit boundary line. Show the predicted locations of lease roads, tank batteries, pipelines and electrical lines, as required by the Kansas Surface Owner Notice Act (House Bill 2032). You may attach a separate plat if desired.

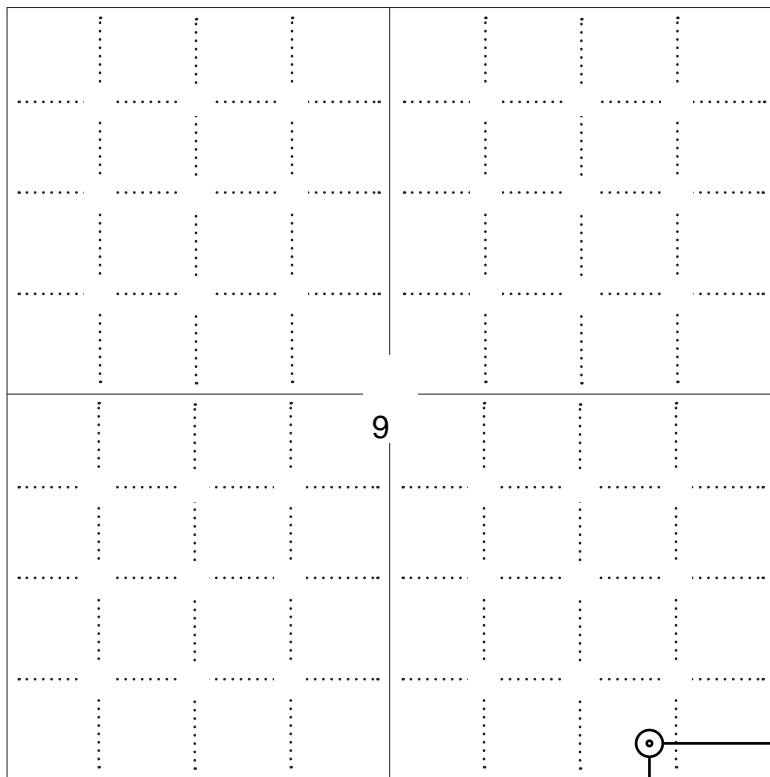

LEGEND

- Well Location
- Tank Battery Location
- Pipeline Location
- Electric Line Location
- Lease Road Location

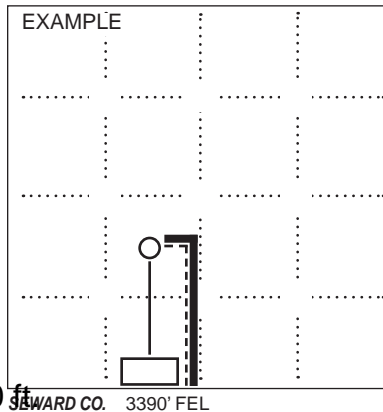

NOTE: In all cases locate the spot of the proposed drilling location.

860 ft.
250 ft.

In plotting the proposed location of the well, you must show:

1. The manner in which you are using the depicted plat by identifying section lines, i.e. 1 section, 1 section with 8 surrounding sections, 4 sections, etc.
2. The distance of the proposed drilling location from the south / north and east / west outside section lines.
3. The distance to the nearest lease or unit boundary line (in footage).
4. If proposed location is located within a prorated or spaced field a certificate of acreage attribution plat must be attached: (C0-7 for oil wells; CG-8 for gas wells).
5. The predicted locations of lease roads, tank batteries, pipelines, and electrical lines.

APPLICATION FOR SURFACE PIT

Submit in Duplicate

Operator Name: _____		License Number: _____	
Operator Address: _____			
Contact Person: _____		Phone Number: _____	
Lease Name & Well No.: _____		Pit Location (QQQQ): _____-_____-_____-_____	
Type of Pit: <input type="checkbox"/> Emergency Pit <input type="checkbox"/> Burn Pit <input type="checkbox"/> Settling Pit <input type="checkbox"/> Drilling Pit <input type="checkbox"/> Workover Pit <input type="checkbox"/> Haul-Off Pit <i>(If WP Supply API No. or Year Drilled)</i>		Pit is: <input type="checkbox"/> Proposed <input type="checkbox"/> Existing If Existing, date constructed: _____ Pit capacity: _____ (bbls)	
Is the pit located in a Sensitive Ground Water Area? <input type="checkbox"/> Yes <input type="checkbox"/> No		Chloride concentration: _____ mg/l <i>(For Emergency Pits and Settling Pits only)</i>	
Is the bottom below ground level? <input type="checkbox"/> Yes <input type="checkbox"/> No		Artificial Liner? <input type="checkbox"/> Yes <input type="checkbox"/> No	
How is the pit lined if a plastic liner is not used?		_____	
Pit dimensions (all but working pits): _____ Length (feet) _____ Width (feet) <input type="checkbox"/> N/A: Steel Pits Depth from ground level to deepest point: _____ (feet) <input type="checkbox"/> No Pit			
If the pit is lined give a brief description of the liner material, thickness and installation procedure.		Describe procedures for periodic maintenance and determining liner integrity, including any special monitoring.	
Distance to nearest water well within one-mile of pit: _____ feet Depth of water well _____ feet		Depth to shallowest fresh water _____ feet. Source of information: <input type="checkbox"/> measured <input type="checkbox"/> well owner <input type="checkbox"/> electric log <input type="checkbox"/> KDWR	
Emergency, Settling and Burn Pits ONLY: Producing Formation: _____ Number of producing wells on lease: _____ Barrels of fluid produced daily: _____ Does the slope from the tank battery allow all spilled fluids to flow into the pit? <input type="checkbox"/> Yes <input type="checkbox"/> No		Drilling, Workover and Haul-Off Pits ONLY: Type of material utilized in drilling/workover: _____ Number of working pits to be utilized: _____ Abandonment procedure: _____ _____ Drill pits must be closed within 365 days of spud date.	
<p>Submitted Electronically</p>			

KCC OFFICE USE ONLY			
		<input type="checkbox"/> Liner <input type="checkbox"/> Steel Pit <input type="checkbox"/> RFAC <input type="checkbox"/> RFAS	
Date Received: _____		Permit Number: _____	
Permit Date: _____		Lease Inspection: <input type="checkbox"/> Yes <input type="checkbox"/> No	



CERTIFICATION OF COMPLIANCE WITH THE KANSAS SURFACE OWNER NOTIFICATION ACT

This form must be submitted with all Forms C-1 (Notice of Intent to Drill); CB-1 (Cathodic Protection Borehole Intent); T-1 (Request for Change of Operator Transfer of Injection or Surface Pit Permit); and CP-1 (Well Plugging Application). Any such form submitted without an accompanying Form KSONA-1 will be returned.

Select the corresponding form being filed: C-1 (Intent) CB-1 (Cathodic Protection Borehole Intent) T-1 (Transfer) CP-1 (Plugging Application)

OPERATOR: License # _____
Name: _____
Address 1: _____
Address 2: _____
City: _____ State: _____ Zip: _____ + _____
Contact Person: _____
Phone: (_____) _____ Fax: (_____) _____
Email Address: _____

Well Location:
____ - ____ - ____ - ____ Sec. ____ Twp. ____ S. R. ____ East West
County: _____
Lease Name: _____ Well #: _____

If filing a Form T-1 for multiple wells on a lease, enter the legal description of the lease below:

Surface Owner Information:

Name: _____
Address 1: _____
Address 2: _____
City: _____ State: _____ Zip: _____ + _____

When filing a Form T-1 involving multiple surface owners, attach an additional sheet listing all of the information to the left for each surface owner. Surface owner information can be found in the records of the register of deeds for the county, and in the real estate property tax records of the county treasurer.

If this form is being submitted with a Form C-1 (Intent) or CB-1 (Cathodic Protection Borehole Intent), you must supply the surface owners and the KCC with a plat showing the predicted locations of lease roads, tank batteries, pipelines, and electrical lines. The locations shown on the plat are preliminary non-binding estimates. The locations may be entered on the Form C-1 plat, Form CB-1 plat, or a separate plat may be submitted.

Select one of the following:

- I certify that, pursuant to the Kansas Surface Owner Notice Act (House Bill 2032), I have provided the following to the surface owner(s) of the land upon which the subject well is or will be located: 1) a copy of the Form C-1, Form CB-1, Form T-1, or Form CP-1 that I am filing in connection with this form; 2) if the form being filed is a Form C-1 or Form CB-1, the plat(s) required by this form; and 3) my operator name, address, phone number, fax, and email address.
- I have not provided this information to the surface owner(s). I acknowledge that, because I have not provided this information, the KCC will be required to send this information to the surface owner(s). To mitigate the additional cost of the KCC performing this task, I acknowledge that I must provide the name and address of the surface owner by filling out the top section of this form and that I am being charged a \$30.00 handling fee, payable to the KCC, which is enclosed with this form.

If choosing the second option, submit payment of the \$30.00 handling fee with this form. If the fee is not received with this form, the KSONA-1 form and the associated Form C-1, Form CB-1, Form T-1, or Form CP-1 will be returned.

I Submitted Electronically

For KCC Use ONLY

API # 15 - _____

IN ALL CASES PLOT THE INTENDED WELL ON THE PLAT BELOW

In all cases, please fully complete this side of the form. Include items 1 through 5 at the bottom of this page.

Operator: Black Dog Deelopment
 Lease: Phillips
 Well Number: 1
 Field: Iola

Number of Acres attributable to well: _____
 QTR/QTR/QTR/QTR of acreage: SE - SW - SE - SE

Location of Well: County: Allen
250 feet from N / S Line of Section
860 feet from E / W Line of Section
 Sec. 9 Twp. 25 S. R. 18 E W

Is Section: Regular or Irregular

If Section is Irregular, locate well from nearest corner boundary.

Section corner used: NE NW SE SW

PLAT

Show location of the well. Show footage to the nearest lease or unit boundary line. Show the predicted locations of lease roads, tank batteries, pipelines and electrical lines, as required by the Kansas Surface Owner Notice Act (House Bill 2032). You may attach a separate plat if desired.

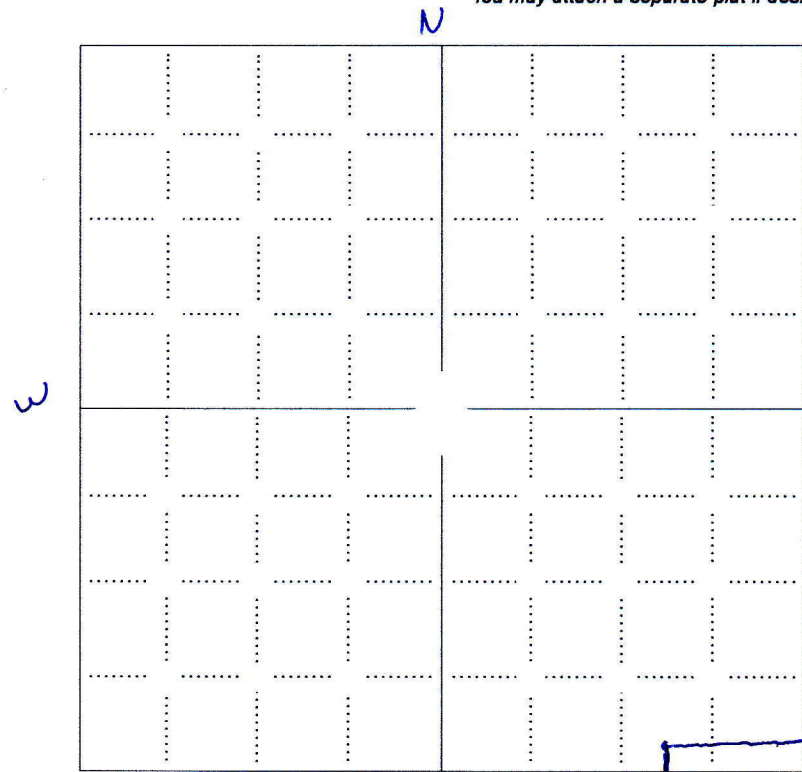

LEGEND

- Well Location
- Tank Battery Location
- Pipeline Location
- Electric Line Location
- Lease Road Location

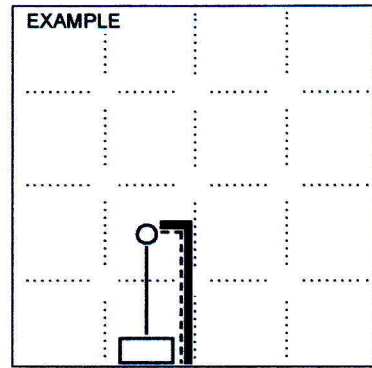

NOTE: In all cases locate the spot of the proposed drilling locaton.

S

In plotting the proposed location of the well, you must show:

1. The manner in which you are using the depicted plat by identifying section lines, i.e. 1 section, 1 section with 8 surrounding sections, 4 sections, etc.
2. The distance of the proposed drilling location from the south / north and east / west outside section lines.
3. The distance to the nearest lease or unit boundary line (in footage).
4. If proposed location is located within a prorated or spaced field a certificate of acreage attribution plat must be attached: (CO-7 for oil wells; CG-8 for gas wells).
5. The predicted locations of lease roads, tank batteries, pipelines, and electrical lines.

1 LOCATION OF WATER WELL: County: ALLEN Fraction: SE 1/4 SE 1/4 SE 1/4 Section Number: 9 Township Number: T 25 S Range Number: R 18 EW

Distance and direction from nearest town or city street address of well if located within city?
5 Miles North of Humbolt on old Kithway E. 200ft. west on section line on west side of Hwy

2 WATER WELL OWNER: Tom Mueller
 RR#, St. Address, Box #: RR-3
 City, State, ZIP Code: Topeka, Mo. 66749
 Board of Agriculture, Division of Water Resources
 Application Number:

3 LOCATE WELL'S LOCATION WITH AN "X" IN SECTION BOX:

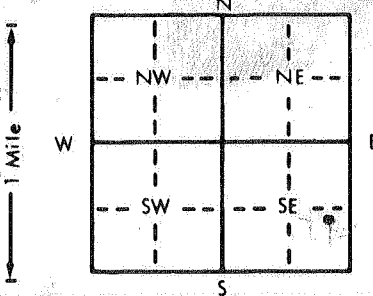

4 DEPTH OF COMPLETED WELL: 80 ft. ELEVATION:

Depth(s) Groundwater Encountered 1. 22 ft. 2. 22 ft. 3. 22 ft.
 WELL'S STATIC WATER LEVEL: 22 ft. below land surface measured on mo/day/yr Aug 7, 89
 Pump test data: Well water was _____ ft. after _____ hours pumping _____ gpm
 Est. Yield _____ gpm: Well water was _____ ft. after _____ hours pumping _____ gpm
 Bore Hole Diameter: 15 in. to 24 in. to _____ in. to _____ in. to _____ ft.
 WELL WATER TO BE USED AS:
 1 Domestic 3 Feedlot 6 Oil field water supply 9 Dewatering 12 Other (Specify below)
 2 Irrigation 4 Industrial 7 Lawn and garden only 10 Observation well
 Was a chemical/bacteriological sample submitted to Department? Yes _____ No If yes, mo/day/yr sample was submitted _____
 Water Well Disinfected? Yes No

5 TYPE OF BLANK CASING USED:

1 Steel 3 RMP (SR) 6 Asbestos-Cement 9 Other (specify below)
 2 PVC 4 ABS 7 Fiberglass
 Blank casing diameter: 7 in. to 24 in. Dia 4 in. to 80 in. Dia _____ in. to _____ in. to _____ ft.
 Casing height above land surface: 22 in., weight _____ lbs./ft. Wall thickness or gauge No. 2.117 255
 TYPE OF SCREEN OR PERFORATION MATERIAL:
 1 Steel 3 Stainless steel 5 Fiberglass 8 RMP (SR) 11 Other (specify)
 2 Brass 4 Galvanized steel 6 Concrete tile 9 ABS 12 None used (open hole)
 SCREEN OR PERFORATION OPENINGS ARE:
 1 Continuous slot 3 Mill slot 5 Gauzed wrapped 8 Saw cut 11 None (open hole)
 2 Louvered shutter 4 Key punched 6 Wire wrapped 9 Drilled holes
 7 Torch cut 10 Other (specify)

SCREEN-PERFORATED INTERVALS: From 20 ft. to 40 ft. From _____ ft. to _____ ft. From _____ ft. to _____ ft.
 GRAVEL PACK INTERVALS: From _____ ft. to _____ ft. From _____ ft. to _____ ft. From _____ ft. to _____ ft.

6 GROUT MATERIAL: 1 Neat cement 2 Cement grout 3 Bentonite 4 Other

Grout Intervals: From 20 ft. to Surface ft. From _____ ft. to _____ ft. From _____ ft. to _____ ft.
 What is the nearest source of possible contamination:
 1 Septic tank 4 Lateral lines 7 Pit privy 10 Livestock pens 14 Abandoned water well
 2 Sewer lines 5 Cess pool 8 Sewage lagoon 11 Fuel storage 15 Oil well/Gas well
 3 Watertight sewer lines 6 Seepage pit 9 Feedyard 12 Fertilizer storage 16 Other (specify below) 150 ft.
 13 Insecticide storage
 Direction from well? How many feet?

FROM	TO	LITHOLOGIC LOG	FROM	TO	LITHOLOGIC LOG
0	2	Topsoil			
18	20	Clay			
2	22	SAND and SHALE			
6	28	River gravel			
52	80	SHALE			

7 CONTRACTOR'S OR LANDOWNER'S CERTIFICATION: This water well was (1) constructed, (2) reconstructed, or (3) plugged under my jurisdiction and was completed on (mo/day/year) Aug 8, 89 and this record is true to the best of my knowledge and belief. Kansas Water Well Contractor's License No. _____ This Water Well Record was completed on (mo/day/yr) _____ under the business name of Jay Jackson Drilling by (signature) Jay Jackson

INSTRUCTIONS: Use typewriter or ball point pen. PLEASE PRESS FIRMLY and PRINT clearly. Please fill in blanks, underline or circle the correct answers. Send top three copies to Kansas Department of Health and Environment, Bureau of Water Protection, Topeka, Kansas 66620-7320, Telephone: 913-862-9360. Send one to WATER WELL OWNER and retain one for your records.

Conservation Division
266 N. Main St., Ste. 220
Wichita, KS 67202-1513



Phone: 316-337-6200
Fax: 316-337-6211
<http://kcc.ks.gov/>

Shari Feist Albrecht, Chair
Jay Scott Emler, Commissioner
Pat Apple, Commissioner

Sam Brownback, Governor

September 18, 2014

Mitch Phillips
Black Dog Development LLC
1130 MINNESOTA RD
IOLA, KS 06749

Re: Notice of Intent to Drill
Phillips 1
SE/4 Sec.09-25S-18E
Allen County, Kansas

Dear Mr. Phillips:

Records indicate that a domestic water well is located less than 660 feet from this proposed location. Eastern Kansas Surface Casing Order #133,891-C for Area 2, paragraph 2 states, "No well shall be drilled closer than 660 feet of an existing domestic or municipal water well without written owner notification, a copy of which must be attached to the drilling intent form during filing. Special casing and cementing requirements may be imposed in those areas producing fresh and usable water."

Please attach a copy of the owner notification to the intent filing to further the processing of your notice of intent to drill. A copy of the water well record is attached.

I may be contacted at 316-337-6200 if you need additional information.

Rick Hestermann
Production Department

Dear Mr. Hestermann:

I believe the domestic water well record that was recorded in August 8 1989 is located on the property of Tom and Carla Mueller address 1018 1100 ST that puts the water well 2,023' ~~East~~ & 445' north of my proposed drill location

Thanks

Mitch Phillips

Tom Mueller

GPS Location

39° 58' 47" N
90° 06' 16" W

MP
west
MP
STW
MP
MP

Conservation Division
266 N. Main St., Ste. 220
Wichita, KS 67202-1513



Phone: 316-337-6200
Fax: 316-337-6211
<http://kcc.ks.gov/>

Shari Feist Albrecht, Chair
Jay Scott Emler, Commissioner
Pat Apple, Commissioner

Sam Brownback, Governor

September 19, 2014

Mitch Phillips
Black Dog Development LLC
1130 MINNESOTA RD
IOLA, KS 06749

Re: Drilling Pit Application
Phillips 1
SE/4 Sec.09-25S-18E
Allen County, Kansas

Dear Mitch Phillips:

District staff has inspected the above referenced location and has determined that the reserve pit shall be constructed **without slots**, the bottom shall be flat and reasonably level, and the free fluids must be removed. The fluids are to be removed from the reserve pit as soon as practical after drilling operations have ceased.

If production casing is set all completion fluids shall be removed from the working pits daily. NO completion fluids or non-exempt wastes shall be placed in the reserve pit.

The fluids should be taken to an authorized disposal well. Please call the District Office at (620) 432-2300 when the fluids have been removed. Please file form CDP-5 (August 2008), Exploration and Production Waste Transfer, through KOLAR within 30 days of fluid removal.

A copy of this letter should be posted in the doghouse along with the approved Intent to Drill. If you have any questions or concerns please feel free to contact the District Office at (620) 432-2300.