



Fall & Associates

Stake and Elevation Service

719 W. 5th Street

P.O. Box 404

Concordia, KS. 66901

1-800-536-2821

Date 9-8-14

Invoice Number 0905141

BEREXCO, LLC
Operator

1-10
Number

Deyle
Farm Name

Cheyenne-KS
County-State

10 1s 37w
S T R

900'FNL 900'FEL
Location

Elevation 3108 Gr.

Ordered By: Dana

Berexco, LLC
2020 N. Bramblewood Dr.
Wichita, KS. 67206

Scale 1"=1000'

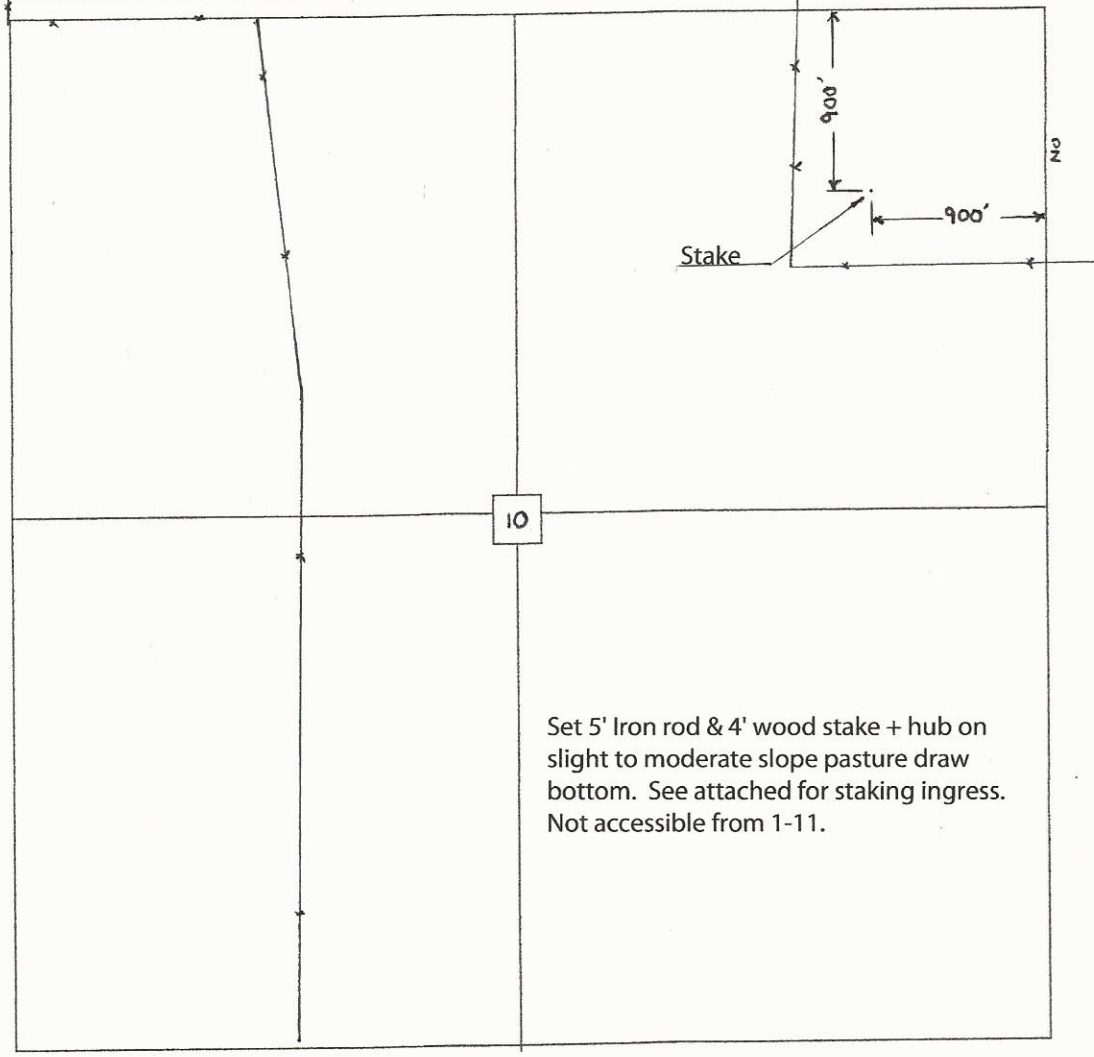

Set 5' Iron rod & 4' wood stake + hub on slight to moderate slope pasture draw bottom. See attached for staking ingress. Not accessible from 1-11.