



Fall & Associates
 Stake and Elevation Service
 719 W. 5th Street
 P.O. Box 404
 Concordia, KS. 66901
 1-800-536-2021

Date 9-8-14

Invoice Number 0905141

BEREXCO, LLC
 Operator

1-10
 Number

Deyle
 Farm Name

Cheyenne-KS
 County-State

10 1s 37w
 S T R

900'FNL 900'FEL
 Location

Berexco, LLC
 2020 N. Bramblewood Dr.
 Wichita, KS. 67206

Elevation 3108 Gr.

Ordered By: Dana

Scale 1"=1000'

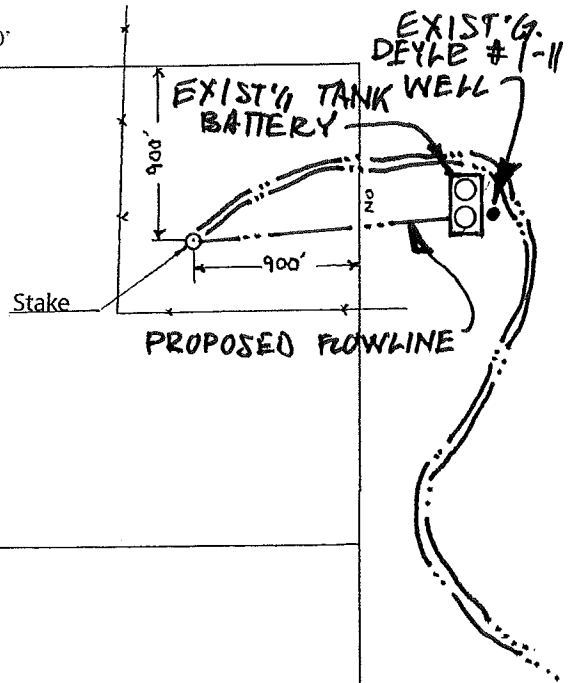
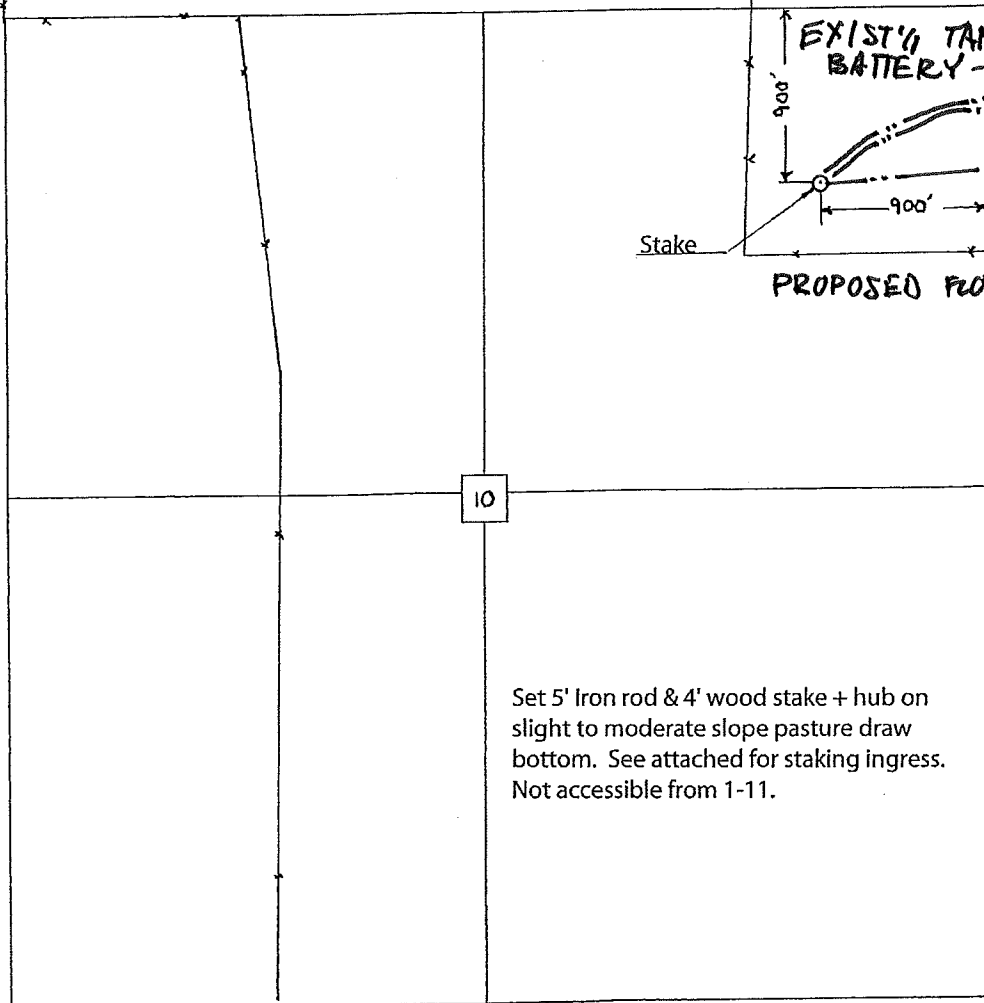

Set 5' Iron rod & 4' wood stake + hub on slight to moderate slope pasture draw bottom. See attached for staking ingress. Not accessible from 1-11.