



**APPLICATION FOR COMMINGLING OF PRODUCTION (K.A.R. 82-3-123) OR FLUIDS (K.A.R. 82-3-123a)** *Commingling ID # \_\_\_\_\_*

OPERATOR: License # \_\_\_\_\_ API No. 15 - \_\_\_\_\_  
Name: \_\_\_\_\_ Spot Description: \_\_\_\_\_  
Address 1: \_\_\_\_\_ - - - - - Sec. \_\_\_\_\_ Twp. \_\_\_\_\_ S. R. \_\_\_\_\_  East  West  
Address 2: \_\_\_\_\_ Feet from  North /  South Line of Section  
City: \_\_\_\_\_ State: \_\_\_\_\_ Zip: \_\_\_\_\_ + \_\_\_\_\_ Feet from  East /  West Line of Section  
Contact Person: \_\_\_\_\_ County: \_\_\_\_\_  
Phone: ( \_\_\_\_\_ ) \_\_\_\_\_ Lease Name: \_\_\_\_\_ Well #: \_\_\_\_\_

1. Name and upper and lower limit of each production interval to be commingled:  
Formation: \_\_\_\_\_ (Perfs): \_\_\_\_\_  
Formation: \_\_\_\_\_ (Perfs): \_\_\_\_\_  
Formation: \_\_\_\_\_ (Perfs): \_\_\_\_\_  
Formation: \_\_\_\_\_ (Perfs): \_\_\_\_\_  
Formation: \_\_\_\_\_ (Perfs): \_\_\_\_\_

2. Estimated amount of fluid production to be commingled from each interval:  
Formation: \_\_\_\_\_ BOPD: \_\_\_\_\_ MCFPD: \_\_\_\_\_ BWPD: \_\_\_\_\_  
Formation: \_\_\_\_\_ BOPD: \_\_\_\_\_ MCFPD: \_\_\_\_\_ BWPD: \_\_\_\_\_  
Formation: \_\_\_\_\_ BOPD: \_\_\_\_\_ MCFPD: \_\_\_\_\_ BWPD: \_\_\_\_\_  
Formation: \_\_\_\_\_ BOPD: \_\_\_\_\_ MCFPD: \_\_\_\_\_ BWPD: \_\_\_\_\_  
Formation: \_\_\_\_\_ BOPD: \_\_\_\_\_ MCFPD: \_\_\_\_\_ BWPD: \_\_\_\_\_

3. Plat map showing the location of the subject well, all other wells on the subject lease, and all wells on offsetting leases within a 1/2 mile radius of the subject well, and for each well the names and addresses of the lessee of record or operator.

4. Signed certificate showing service of the application and affidavit of publication as required in K.A.R. 82-3-135a.

**For Commingling of PRODUCTION ONLY, include the following:**

- 5. Wireline log of subject well. Previously Filed with ACO-1:  Yes  No
- 6. Complete Form ACO-1 (*Well Completion form*) for the subject well.

**For Commingling of FLUIDS ONLY, include the following:**

- 7. Well construction diagram of subject well.
- 8. Any available water chemistry data demonstrating the compatibility of the fluids to be commingled.

**AFFIDAVIT:** I am the affiant and hereby certify that to the best of my current information, knowledge and personal belief, this request for commingling is true and proper and I have no information or knowledge, which is inconsistent with the information supplied in this application.

**Submitted Electronically**

**KCC Office Use Only**  
 Denied  Approved  
15-Day Periods Ends: \_\_\_\_\_  
Approved By: \_\_\_\_\_ Date: \_\_\_\_\_

*Protests may be filed by any party having a valid interest in the application. Protests must be in writing and comply with K.A.R. 82-3-135b and must be filed within 15 days of publication of the notice of application.*

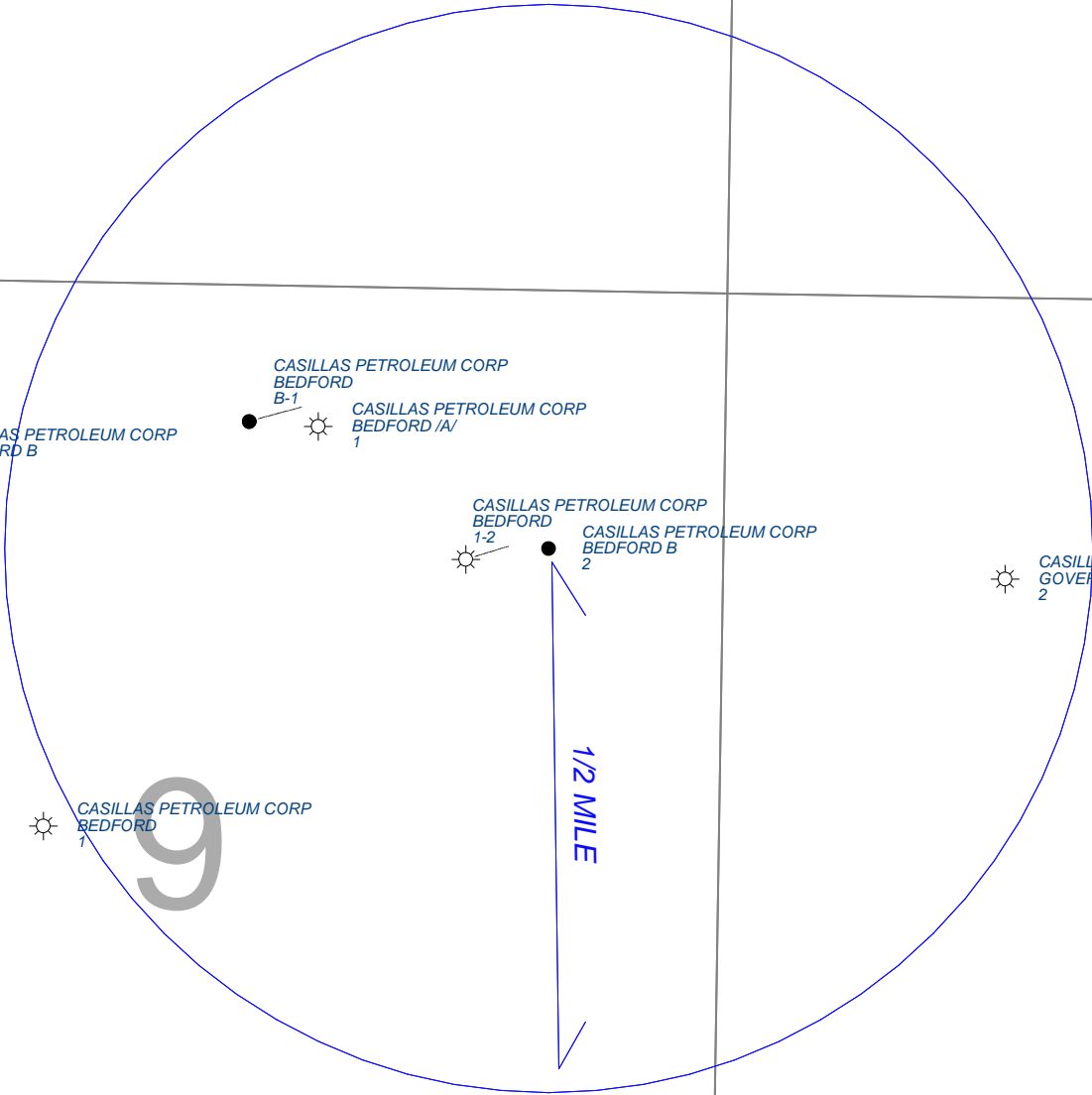

9

10

PETRA 10/20/2014 11:27:15 AM

Casillas Petroleum Corp.  
BEDFORD B-2

0 924  
FEET

POSTED WELL DATA

Operator  
Well Name  
Well Number

October 20, 2014

**AFFIDAVIT**

STATE OF KANSAS \  
- SS.  
County of Sedgwick /

Mark Fletchall, of lawful age, being first duly sworn, deposeth and saith: That he is Record Clerk of The Wichita Eagle, a daily newspaper published in the City of Wichita, County of Sedgwick, State of Kansas, and having a general paid circulation on a daily basis in said County, which said newspaper has been continuously and uninterruptedly published in said County for more than one year prior to the first publication of the notice hereinafter mentioned, and which said newspaper has been entered as second class mail matter at the United States Post Office in Wichita, Kansas, and which said newspaper is not a trade, religious or fraternal publication and that a notice of a true copy is hereto attached was published in the regular and entire Morning issue of said The Wichita Eagle for   1   issues, that the first publication of said notice was

made as aforesaid on the 10th of

November A.D. 2014, with

subsequent publications being made on the following dates:

And affiant further says that he has personal knowledge of the statements above set forth and that they are true.

*Mark Fletchall*

Subscribed and sworn to before me this

10th November, 2014

JENNIFER RAE BAILEY  
Notary Public - State of Kansas  
My Appt. Expires 6/19/2017

*JR Bailey*  
\_\_\_\_\_  
Notary Public Sedgwick County, Kansas

Printer's Fee : \$152.80

**LEGAL PUBLICATION**  
PUBLISHED IN THE WICHITA EAGLE  
NOVEMBER 10, 2014 (3325633)  
BEFORE THE STATE CORPORATION  
COMMISSION OF THE STATE OF KANSAS  
NOTICE OF FILING APPLICATION  
RE: CASILLAS PETROLEUM CORP.  
APPLICATION FOR A PERMIT TO  
AUTHORIZE THE COMMINGLING OF  
ZONES IN THE BEDFORD B2, LOCATED IN  
FINNEY COUNTY, KANSAS  
TO: ALL OIL & GAS PRODUCERS,  
UNLEASED MINERAL INTEREST  
OWNERS, LANDOWNERS, AND ALL  
PERSONS WHOMEVER CONCERNED.  
You, and each of you, are hereby notified  
that Casillas Petroleum Corp. has filed an  
application to commingle, Marmaton,  
Pawnee, Cherokee, Morrow and St.  
Louis zones in the Bedford B-2, located in the  
NE, NE, Sec. 9, T26S, R34W,  
Finney County, Kansas.  
Any persons who object to or protest this  
application shall be required to file their  
objections or protest with the Conservation  
Division of the State Corporation Commission  
of the State of Kansas within thirty (15) days  
from the date of this publication.  
These protests shall be filed pursuant  
to Commission regulations and must  
state specific reasons why the grant of  
the application may cause waste violate  
correlative rights or pollute the natural  
resources of the State of Kansas. If no protests  
are received, this matter will be set hearing.  
All persons interested or concerned shall  
take notice of the foregoing and shall govern  
themselves accordingly.  
Casillas Petroleum Corp.  
348 Rd. DD  
Satanla, KS 67870  
620-276-3693

**Proof Of Publication**  
**State Of Kansas - Finney County**

Dena A. Sattler, being first duly sworn, deposes and says that she is publisher of **THE GARDEN CITY TELEGRAM**, a weekly newspaper printed in the State of Kansas and published in and of general circulation in Finney County, Kansas, on a weekly basis in Finney County, Kansas, and that said newspaper is not a trade, religious, or fraternal publication.

THAT said newspaper is daily published at least weekly fifty (50) times a year; has been so published continuously and uninterruptedly in said county and state for a period of more than five (5) years prior to the first publication of said notice.

THAT the attached notice is a true copy thereof and was published in the regular and entire issue of said newspaper for 1 consecutive days/weeks. The first (1st) publication thereof being made as aforesaid on the 14<sup>th</sup> day of November, 2014.

With subsequent publications being made on the following dates:

- 2<sup>nd</sup> Publication made on the        day of       , 20
- 3<sup>rd</sup> Publication made on the        day of       , 20
- 4<sup>th</sup> Publication made on the        day of       , 20

Publication Fee: \$49.80  
 Affidavits (Additional Copies): @ \$5 each \$         
 Total Publication Fee: \$ 49.80

Sign Dena A. Sattler

Witness my hand this 10<sup>th</sup> day of Nov, 2014

SUBSCRIBED AND SWORN before me this 10<sup>th</sup> day of November, 2014.

(Notary Public)  
 My commission expires 11-25-17

(Published in The Garden City Telegram Wednesday, November 5, 2014)

BEFORE THE STATE CORPORATION COMMISSION OF THE STATE OF KANSAS  
 NOTICE OF FILING APPLICATION

RE: CASILLAS PETROLEUM CORP. APPLICATION FOR A PERMIT TO AUTHORIZE THE COMMINGLING OF ZONES IN THE BEDFORD B2, LOCATED IN FINNEY COUNTY, KANSAS

TO: ALL OIL & GAS PRODUCERS, UNLEASED MINERAL INTEREST OWNERS, LANDOWNERS, AND ALL PERSONS WHOMEVER CONCERNED.

You, and each of you, are hereby notified that Casillas Petroleum Corp. has filed an application to commingle, Marmaton, Pawnee, Cherokee, Morrow and St. Louis zones in the Bedford B-2, located in the NE, NE, Sec. 9, T26S, R34W, Finney County, Kansas.

Any persons who object to or protest this application shall be required to file their objections or protest with the Conservation Division of the State Corporation Commission of the State of Kansas within thirty (15) days from the date of this publication. These protests shall be filed pursuant to Commission regulations and must state specific reasons why the grant of the application may cause waste violate correlative rights or pollute the natural resources of the State of Kansas. If no protests are received, this matter will be set hearing.

All persons interested or concerned shall take notice of the foregoing and shall govern themselves accordingly.

Casillas Petroleum Corp.  
 348 Rd. DD  
 Satanta, KS 67870  
 620-276-3693

236198

NOTARY PUBLIC - State of Kansas  
**NANCY MILLER**  
 My Appt. Exp 11-25-17

Legal Invoice #  
236198

---

CERTIFICATE OF SERVICE

I hereby certify on this 17th day of November, 2014, Casillas Petroleum Corp. is the sole operator within the ½ mile radius of the Bedford B-2 well to be commingled.

  
\_\_\_\_\_  
Melissa Imler

Conservation Division  
Finney State Office Building  
130 S. Market, Rm. 2078  
Wichita, KS 67202-3802



Phone: 316-337-6200  
Fax: 316-337-6211  
<http://kcc.ks.gov/>

Shari Feist Albrecht, Chair  
Jay Scott Emler, Commissioner  
Pat Apple, Commissioner

Sam Brownback, Governor

December 2, 2014

Melissa Imler  
Casillas Petroleum Corp  
348 Rd. DD  
Satanta, KS 67870

RE: Approved Commingling CO111405  
Bedford B 2  
API No. 15-055-21654-00-02

Dear Ms. Imler:

Your Application for Commingling (ACO-4) for the above described well has been reviewed and approved by the Kansas Corporation Commission (KCC) per K.A.R. 82-3-123. Notice was examined and found to be proper per K.A.R. 82-3-135a. No protest had been filed within the 15-day protest period.

Based upon the depth of the St. Louis formation perforations, total oil production shall not exceed 200 BOPD and total gas production shall not exceed 50% of the absolute open flow (AOF).

File form ACO-1 upon completion of the well to commingle.

Sincerely,

Rick Hestermann  
Production Department