



For KCC Use:
 Effective Date: _____
 District # _____
 SGA? Yes No

KANSAS CORPORATION COMMISSION 1226760
 OIL & GAS CONSERVATION DIVISION

Form C-1
 March 2010
 Form must be Typed
 Form must be Signed
 All blanks must be Filled

NOTICE OF INTENT TO DRILL

Must be approved by KCC five (5) days prior to commencing well

Form KSONA-1, Certification of Compliance with the Kansas Surface Owner Notification Act, MUST be submitted with this form.

Expected Spud Date: _____
month day year

OPERATOR: License# _____
 Name: _____
 Address 1: _____
 Address 2: _____
 City: _____ State: _____ Zip: _____ + _____
 Contact Person: _____
 Phone: _____

CONTRACTOR: License# _____
 Name: _____

Well Drilled For:	Well Class:	Type Equipment:
<input type="checkbox"/> Oil	<input type="checkbox"/> Enh Rec	<input type="checkbox"/> Infield
<input type="checkbox"/> Gas	<input type="checkbox"/> Storage	<input type="checkbox"/> Pool Ext.
	<input type="checkbox"/> Disposal	<input type="checkbox"/> Wildcat
<input type="checkbox"/> Seismic ; _____ # of Holes	<input type="checkbox"/> Other	<input type="checkbox"/> Mud Rotary
<input type="checkbox"/> Other: _____		<input type="checkbox"/> Air Rotary
		<input type="checkbox"/> Cable
<input type="checkbox"/> If OWWO: old well information as follows:		

Operator: _____
 Well Name: _____
 Original Completion Date: _____ Original Total Depth: _____

Directional, Deviated or Horizontal wellbore? Yes No
 If Yes, true vertical depth: _____
 Bottom Hole Location: _____
 KCC DKT #: _____

Spot Description: _____
 _____ - _____ - _____ Sec. _____ Twp. _____ S. R. _____ E W
(Q/Q/Q/Q)
 _____ feet from N / S Line of Section
 _____ feet from E / W Line of Section
 Is SECTION: Regular Irregular?

(Note: Locate well on the Section Plat on reverse side)

County: _____
 Lease Name: _____ Well #: _____
 Field Name: _____
 Is this a Prorated / Spaced Field? Yes No
 Target Formation(s): _____
 Nearest Lease or unit boundary line (in footage): _____
 Ground Surface Elevation: _____ feet MSL
 Water well within one-quarter mile: Yes No
 Public water supply well within one mile: Yes No
 Depth to bottom of fresh water: _____
 Depth to bottom of usable water: _____
 Surface Pipe by Alternate: I II
 Length of Surface Pipe Planned to be set: _____
 Length of Conductor Pipe (if any): _____
 Projected Total Depth: _____
 Formation at Total Depth: _____
 Water Source for Drilling Operations:
 Well Farm Pond Other: _____
 DWR Permit #: _____
(Note: Apply for Permit with DWR)
 Will Cores be taken? Yes No
 If Yes, proposed zone: _____

AFFIDAVIT

The undersigned hereby affirms that the drilling, completion and eventual plugging of this well will comply with K.S.A. 55 et. seq.

It is agreed that the following minimum requirements will be met:

1. Notify the appropriate district office **prior** to spudding of well;
2. A copy of the approved notice of intent to drill **shall be** posted on each drilling rig;
3. The minimum amount of surface pipe as specified below **shall be set** by circulating cement to the top; in all cases surface pipe **shall be set** through all unconsolidated materials plus a minimum of 20 feet into the underlying formation.
4. If the well is dry hole, an agreement between the operator and the district office on plug length and placement is necessary **prior to plugging**;
5. The appropriate district office will be notified before well is either plugged or production casing is cemented in;
6. If an ALTERNATE II COMPLETION, production pipe shall be cemented from below any usable water to surface within **120 DAYS** of spud date. Or pursuant to Appendix "B" - Eastern Kansas surface casing order #133,891-C, which applies to the KCC District 3 area, alternate II cementing must be completed within 30 days of the spud date or the well shall be plugged. **In all cases, NOTIFY district office** prior to any cementing.

Submitted Electronically

For KCC Use ONLY

API # 15 - _____

Conductor pipe required _____ feet

Minimum surface pipe required _____ feet per ALT. I II

Approved by: _____

This authorization expires: _____
(This authorization void if drilling not started within 12 months of approval date.)

Spud date: _____ Agent: _____

Remember to:

- File Certification of Compliance with the Kansas Surface Owner Notification Act (KSONA-1) with Intent to Drill;
- File Drill Pit Application (form CDP-1) with Intent to Drill;
- File Completion Form ACO-1 within 120 days of spud date;
- File acreage attribution plat according to field proration orders;
- Notify appropriate district office 48 hours prior to workover or re-entry;
- Submit plugging report (CP-4) after plugging is completed (within 60 days);
- Obtain written approval before disposing or injecting salt water.
- If well will not be drilled or permit has expired (See: authorized expiration date) please check the box below and return to the address below.

Well will not be drilled or Permit Expired Date: _____
 Signature of Operator or Agent: _____

E
W



1226760

For KCC Use ONLY

API # 15 - _____

IN ALL CASES PLOT THE INTENDED WELL ON THE PLAT BELOW

In all cases, please fully complete this side of the form. Include items 1 through 5 at the bottom of this page.

Operator: _____

Lease: _____

Well Number: _____

Field: _____

Number of Acres attributable to well: _____

QTR/QTR/QTR/QTR of acreage: _____ - _____ - _____ - _____

Location of Well: County: _____

_____ feet from N / S Line of Section

_____ feet from E / W Line of Section

Sec. _____ Twp. _____ S. R. _____ E W

Is Section: Regular or Irregular

If Section is Irregular, locate well from nearest corner boundary.

Section corner used: NE NW SE SW

PLAT

Show location of the well. Show footage to the nearest lease or unit boundary line. Show the predicted locations of lease roads, tank batteries, pipelines and electrical lines, as required by the Kansas Surface Owner Notice Act (House Bill 2032).

You may attach a separate plat if desired.

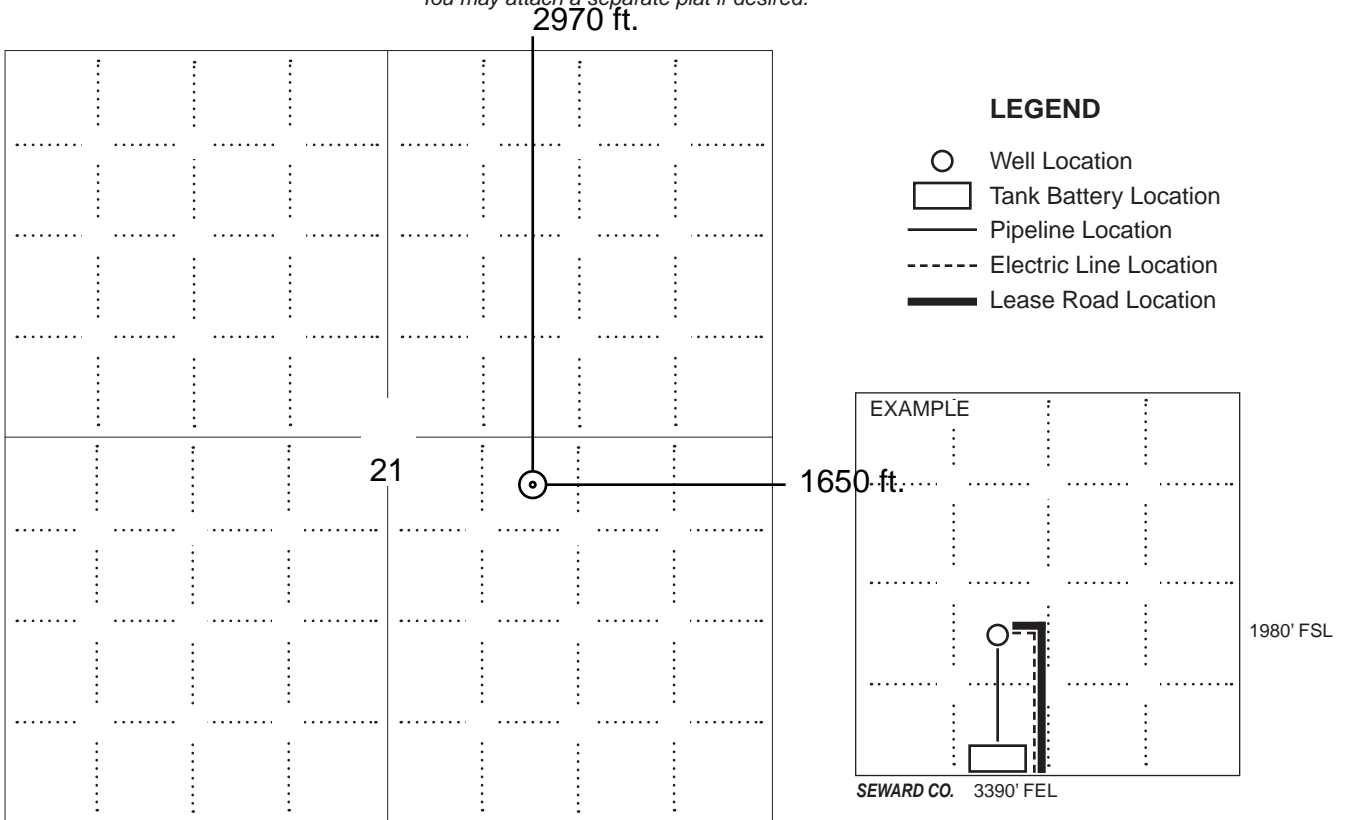

NOTE: In all cases locate the spot of the proposed drilling locaton.

In plotting the proposed location of the well, you must show:

1. The manner in which you are using the depicted plat by identifying section lines, i.e. 1 section, 1 section with 8 surrounding sections, 4 sections, etc.
2. The distance of the proposed drilling location from the south / north and east / west outside section lines.
3. The distance to the nearest lease or unit boundary line (in footage).
4. If proposed location is located within a prorated or spaced field a certificate of acreage attribution plat must be attached: (C0-7 for oil wells; CG-8 for gas wells).
5. The predicted locations of lease roads, tank batteries, pipelines, and electrical lines.



KANSAS CORPORATION COMMISSION 1226760
OIL & GAS CONSERVATION DIVISION

Form CDP-1
May 2010
Form must be Typed

APPLICATION FOR SURFACE PIT

Submit in Duplicate

Operator Name: _____		License Number: _____	
Operator Address: _____			
Contact Person: _____		Phone Number: _____	
Lease Name & Well No.: _____		Pit Location (QQQQ): _____-_____-_____-_____	
Type of Pit: <input type="checkbox"/> Emergency Pit <input type="checkbox"/> Burn Pit <input type="checkbox"/> Settling Pit <input type="checkbox"/> Drilling Pit <input type="checkbox"/> Workover Pit <input type="checkbox"/> Haul-Off Pit <i>(If WP Supply API No. or Year Drilled)</i>		Pit is: <input type="checkbox"/> Proposed <input type="checkbox"/> Existing If Existing, date constructed: _____ Pit capacity: _____ (bbls)	
Is the pit located in a Sensitive Ground Water Area? <input type="checkbox"/> Yes <input type="checkbox"/> No		Chloride concentration: _____ mg/l <i>(For Emergency Pits and Settling Pits only)</i>	
Is the bottom below ground level? <input type="checkbox"/> Yes <input type="checkbox"/> No		Artificial Liner? <input type="checkbox"/> Yes <input type="checkbox"/> No	
How is the pit lined if a plastic liner is not used?		_____	
Pit dimensions (all but working pits): _____ Length (feet) _____ Width (feet) <input type="checkbox"/> N/A: Steel Pits Depth from ground level to deepest point: _____ (feet) <input type="checkbox"/> No Pit			
If the pit is lined give a brief description of the liner material, thickness and installation procedure.		Describe procedures for periodic maintenance and determining liner integrity, including any special monitoring.	
Distance to nearest water well within one-mile of pit: _____ feet Depth of water well _____ feet		Depth to shallowest fresh water _____ feet. Source of information: <input type="checkbox"/> measured <input type="checkbox"/> well owner <input type="checkbox"/> electric log <input type="checkbox"/> KDWR	
Emergency, Settling and Burn Pits ONLY: Producing Formation: _____ Number of producing wells on lease: _____ Barrels of fluid produced daily: _____ Does the slope from the tank battery allow all spilled fluids to flow into the pit? <input type="checkbox"/> Yes <input type="checkbox"/> No		Drilling, Workover and Haul-Off Pits ONLY: Type of material utilized in drilling/workover: _____ Number of working pits to be utilized: _____ Abandonment procedure: _____ _____ Drill pits must be closed within 365 days of spud date.	
<p>Submitted Electronically</p>			

KCC OFFICE USE ONLY

Liner Steel Pit RFAC RFAS

Date Received: _____ Permit Number: _____ Permit Date: _____ Lease Inspection: Yes No



CERTIFICATION OF COMPLIANCE WITH THE KANSAS SURFACE OWNER NOTIFICATION ACT

This form must be submitted with all Forms C-1 (Notice of Intent to Drill); CB-1 (Cathodic Protection Borehole Intent); T-1 (Request for Change of Operator Transfer of Injection or Surface Pit Permit); and CP-1 (Well Plugging Application). Any such form submitted without an accompanying Form KSONA-1 will be returned.

Select the corresponding form being filed: C-1 (Intent) CB-1 (Cathodic Protection Borehole Intent) T-1 (Transfer) CP-1 (Plugging Application)

OPERATOR: License # _____
Name: _____
Address 1: _____
Address 2: _____
City: _____ State: _____ Zip: _____ + _____
Contact Person: _____
Phone: (_____) _____ Fax: (_____) _____
Email Address: _____

Well Location:
____ - ____ - ____ - ____ Sec. ____ Twp. ____ S. R. ____ East West
County: _____
Lease Name: _____ Well #: _____

If filing a Form T-1 for multiple wells on a lease, enter the legal description of the lease below:

Surface Owner Information:

Name: _____
Address 1: _____
Address 2: _____
City: _____ State: _____ Zip: _____ + _____

When filing a Form T-1 involving multiple surface owners, attach an additional sheet listing all of the information to the left for each surface owner. Surface owner information can be found in the records of the register of deeds for the county, and in the real estate property tax records of the county treasurer.

If this form is being submitted with a Form C-1 (Intent) or CB-1 (Cathodic Protection Borehole Intent), you must supply the surface owners and the KCC with a plat showing the predicted locations of lease roads, tank batteries, pipelines, and electrical lines. The locations shown on the plat are preliminary non-binding estimates. The locations may be entered on the Form C-1 plat, Form CB-1 plat, or a separate plat may be submitted.

Select one of the following:

- I certify that, pursuant to the Kansas Surface Owner Notice Act (House Bill 2032), I have provided the following to the surface owner(s) of the land upon which the subject well is or will be located: 1) a copy of the Form C-1, Form CB-1, Form T-1, or Form CP-1 that I am filing in connection with this form; 2) if the form being filed is a Form C-1 or Form CB-1, the plat(s) required by this form; and 3) my operator name, address, phone number, fax, and email address.
- I have not provided this information to the surface owner(s). I acknowledge that, because I have not provided this information, the KCC will be required to send this information to the surface owner(s). To mitigate the additional cost of the KCC performing this task, I acknowledge that I must provide the name and address of the surface owner by filling out the top section of this form and that I am being charged a \$30.00 handling fee, payable to the KCC, which is enclosed with this form.

If choosing the second option, submit payment of the \$30.00 handling fee with this form. If the fee is not received with this form, the KSONA-1 form and the associated Form C-1, Form CB-1, Form T-1, or Form CP-1 will be returned.

I Submitted Electronically

I

Kansas Oil and Gas

Statewide View | Zoom to Location | Filter Wells | Label Wells | Download Wells | Print to PDF | Clear Highlight | Help



STATE OF KANSAS
STATE CORPORATION COMMISSION
130 S. Market, Room 2078
Wichita, KS 67202

WELL PLUGGING RECORD
K.A.R.-82-3-117
WELL NUMBER 1-21

API NUMBER 15-163-21193-00000
LEASE NAME DICK LARGENT

RECEIVED
NOV 19 2002
KCC WICHITA

NOTICE: Fill out **completely** 2310 Ft. from S Section Line
and return to Cons. Div. 1650 Ft. from E Section Line
office within 30 days

LEASE OPERATOR Murfin Drilling Co., Inc. SEC. 21 TWP. 10S RGE. 19W (E) or (W)
ADDRESS 250 N. Water, Suite 300; Wichita, KS 67202 COUNTY ROOKS
PHONE # () 267-3241 OPERATORS LICENSE NO. 30606 Date Well Completed 12/7/80
Character of Well OIL (Oil, Gas, D&A, SWD, Input, Water Supply Well) Plugging commenced 11/8/02
Plugging Completed 11/8/02

The plugging proposal was approved on 11/8/02 (date)
by ROGER MOSES w/KCC Hays, KS. (KCC District Agent's Name).
Is ACO-1 filed? ? If not, is well log attached? NO
Producing Formation LKC Depth to Top 3279 Bottom 3433 TD 3745'PBTD3708CIBP@3485

Show depth and thickness of all water oil and gas formations.

OIL, GAS, OR WATER RECORDS CASING RECORD

Formation	Content	From	To	Size	Put In	Pulled out
		surface	222'	8 5/8		0
		production	3746	5 1/2	3789	0

Describe in detail the manner in which the well was plugged, indicating where the mud fluid was placed and the method or methods used in introducing it into the hole. If cement or other plugs were used, state the character of same and depth placed, from ___ feet to ___ feet each set.

Plugged well as follows: Tied onto 8 5/8. Pressured to 500# & held. Tied onto 5 1/2" csg. Pumped 30 sxs 60-40 poz 10%gel.600#hulls.13sxs gel. 170 sxs 60-40 poz 10%gel.max press 800#, ISIP 300#. Well is P&A Witnessed and approved by Roger Moses w/KCC in Hays,KS

Name of Plugging Contractor Murfin Drilling Company, Inc. License No. 30606 Address 250 N. Water, Suite 300; Wichita, KS 67202

NAME OF PARTY RESPONSIBLE FOR PLUGGING FEES: Murfin Drilling Company, Inc.

STATE OF KANSAS COUNTY OF SEDGWICK ss.
Tom W. Nichols, Production Manager (Employee of Operator) or (Operator) of above-described well, being first duly sworn on oath, says: That I have knowledge of the facts, statements, and matters herein contained and the log of the above-described well as filed that the same are true and correct, so help me God.

(Signature) Tom W. Nichols
(Address) Wichita, KS

SUBSCRIBED AND SWORN TO before me this 12th day of Nov. 2002

Notary Public - Barbara J. Dodson
My Commission Expires: 12/16/03 Form CP-4 Revised 05-88

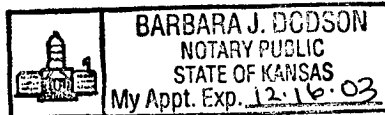

CP

WELL LOG

15-163-21193-0000

COMPANY Murfin Drilling Company

SEC. 21 T. 10S R. 19W
LOG. NE NW SE

FARM Largent NO. 1-21

RIG. NO.

TOTAL DEPTH 3745'

COMM. 11-25-80

COMP. 12-7-80

COUNTY Rooks
KANSAS

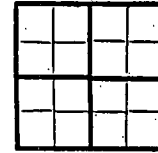

CONTRACTOR John O. Farmer, Inc.

CASING

10 10
15 5/8" set @ 222' w/170 sx.
12 6
13 1/2" set @ 3753.36' w/200 sx.

ELEVATION 2127' GR

PRODUCTION

FIGURES INDICATE BOTTOM OF FORMATIONS

Clay & Sand	20'
Blue Shale	222'
Shale	250'
Sand & Shale	975'
Sand	1225'
Red Bed	1496'
Anhydrite	1529'
Shale & Shell	1710'
Shale	2030'
Lime & Shale	2185'
Shale & Lime	2520'
Lime & Shale	2734'
Shale & Lime	3140'
Lime & Shale	3300'
Lime	3675'
Arbuckle	3745'

WELL FILE

RECEIVED
KANSAS CORP. COMM.
2002 OCT -3 P 12:39

State of Kansas
County of Sedgwick

I, David L. Murfin, Drlg. Mgr. of the Murfin Drilling Company

upon oath state that the above and foregoing is a true and correct copy of the log of the Largent #1-21 well.

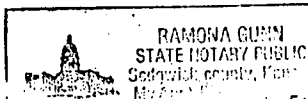

Subscribed and sworn to before me this 5th day of March David L. Murfin 81

My Commission Expires: January 25, 1984

Ramona Gunn
NOTARY PUBLIC

15-163-21193-0000

ALLIED CEMENTING CO., INC.

P.O. BOX 31
RUSSELL, KS 67665
PH (785) 483-3887
FAX (785) 483-5566
FEDERAL TAX ID#

* I N V O I C E *

Invoice Number: 088500

Invoice Date: 11/15/02

RECEIVED

NOV 19 2002

RECEIVED

KCC WICHITA

NOV 18 2002

Sold Murfin Drilling Co.
To: 250 N. Water, St. #300
Wichita, KS
67202

Cust I.D.....: Murfin
P.O. Number...: D.Largent 1-21
P.O. Date....: 11/15/02

Due Date.: 12/15/02

Terms: Net 30

PAID 36 11/15

Item I.D./Desc	Qty	Unit	Price	Net	
Common	120.00	SKS	6.6500	798.00	T
Pozmix	80.00	SKS	3.5500	284.00	T
Gel	14.00	SKS	10.0000	140.00	T
Hulls	6.00	SKS	18.0000	108.00	T
Handling	240.00	SKS	1.1000	264.00	T
Mileage (38)	38.00	MILE	9.6000	364.80	T
240 sks @\$.04 per sk per mi					
Plug	1.00	JOB	475.0000	475.00	T
Mileage pmp trk	38.00	MILE	3.0000	114.00	T

All Prices Are Net, Payable 30 Days Following
Date of Invoice. 1 1/2% Charged Thereafter.
If Account CURRENT take Discount of \$ *254.78*
ONLY if paid within 30 days from Invoice Date

Subtotal: 2547.80
Tax.....: 173.25
Payments: 0.00
Total....: 2721.05

15-163-21193-0000

ALLIED CEMENTING CO., INC. 11463

REMIT TO P.O. BOX 31
RUSSELL, KANSAS 67665

SERVICE POINT:
Russell

DATE <u>11-08-02</u>	SEC.	TWP.	RANGE	CALLED OUT <u>7:00 AM</u>	ON LOCATION <u>8:30 AM</u>	JOB START	JOB FINISH <u>10:30 AM</u>
LEASE <u>Largent</u>	WELL # <u>1-21</u>	LOCATION <u>Zurich SS tw N into</u>			COUNTY <u>ROOKS</u>	STATE <u>Ks</u>	
OLD OR NEW (Circle one)				RECEIVED			

NOV 19 2002

CONTRACTOR ✓

TYPE OF JOB Plug

HOLE SIZE _____ T.D. _____

CASING SIZE _____ DEPTH _____

TUBING SIZE _____ DEPTH _____

DRILL PIPE _____ DEPTH _____

TOOL _____ DEPTH _____

PRES. MAX _____ MINIMUM _____

MEAS. LINE _____ SHOE JOINT _____

CEMENT LEFT IN CSG. _____

PERFS. _____

DISPLACEMENT _____

OWNER _____ KCC WICHITA

EQUIPMENT

PUMP TRUCK CEMENTER Bill

177 HELPER PAul

BULK TRUCK

213 DRIVER Robert

BULK TRUCK

_____ DRIVER _____

CEMENT

AMOUNT ORDERED 240 pbs 60/40-10 Used 200pk Cent
600 Halls (13 pk Gel no charge)

COMMON	<u>120</u>	@	<u>6.65</u>	<u>798.00</u>
POZMIX	<u>80</u>	@	<u>3.55</u>	<u>284.00</u>
GEL	<u>14</u>	@	<u>10.00</u>	<u>140.00</u>
CHLORIDE		@		
<u>Halls</u>	<u>6</u>	@	<u>18.00</u>	<u>108.00</u>
		@		
		@		
		@		
		@		
HANDLING	<u>240</u>	@	<u>1.10</u>	<u>264.00</u>
MILEAGE	<u>4 1/2</u>	@	<u>1.00</u>	<u>364.00</u>
				TOTAL <u>1958.00</u>

REMARKS:

SERVICE

filling down 53 of 30pk Cent of 600 Halls
Follow up 13pk Gel Follow up 170pk Cent
max 800' 300 shut in
2 empty pbs
pump down Ann & press to 500'

DEPTH OF JOB _____

PUMP TRUCK CHARGE _____ 475.00

EXTRA FOOTAGE _____ @ _____

MILEAGE 38 @ 3.00 114.00

PLUG _____ @ _____

_____ @ _____

_____ @ _____

TOTAL 589.00

CHARGE TO: MURFIN

STREET _____

CITY _____ STATE _____ ZIP _____

FLOAT EQUIPMENT

_____ @ _____

_____ @ _____

_____ @ _____

_____ @ _____

_____ @ _____

To Allied Cementing Co., Inc.
You are hereby requested to rent cementing equipment and furnish cementer and helper to assist owner or contractor to do work as is listed. The above work was done to satisfaction and supervision of owner agent or contractor. I have read & understand the "TERMS AND CONDITIONS" listed on the reverse side.

TAX _____

TOTAL CHARGE _____

DISCOUNT _____ IF PAID IN 30 DAYS

SIGNATURE John G. Stra...

PRINTED NAME

October 09, 2014

Zach Patterson
American Oil LLC
1023 RESERVATION RD.
HAYS, KS 67601

Re: Drilling Pit Application
Dick Largent 1-21
SE/4 Sec.21-10S-19W
Rooks County, Kansas

Dear Zach Patterson:

District staff has inspected the location and has determined that an unsealed condition will present a pollution threat to water resources.

District staff has recommended that the reserve pit be lined. If a plastic liner is to be used it must have a minimum thickness of 12 mil. Integrity of the liner must be maintained at all times.

If production casing is set all completion fluids shall be removed from the working pits daily. NO completion fluids or non-exempt wastes shall be placed in the reserve pit.

KEEP PITS away from draw/drainage.

The fluids are to be removed from the reserve pit as soon as the Hutchinson Salt section has been drilled through and displacement of the fluids into the reserve pit has occurred. The fluids should be removed again as soon as practical after drilling operations have ceased.

Please call the District Office at (785) 625-0550 when the fluids have been removed. Please file form CDP-5 (August 2008), Exploration and Production Waste Transfer, through KOLAR within 30 days of fluid removal.

A copy of this letter should be posted in the doghouse along with the approved Intent to Drill. If you have any questions or concerns please feel free to contact the District Office at (785) 625-0550.