

Section 35
32S 6W

Section 36
32S 6W

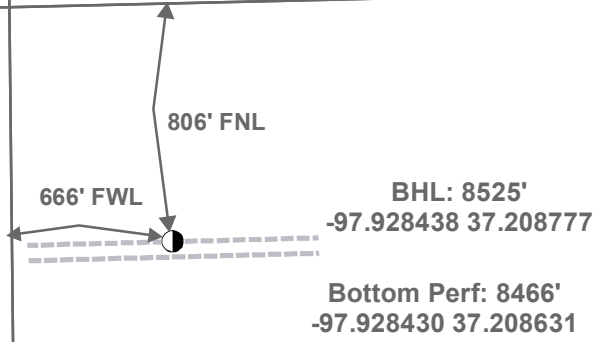

Section 2
33S 6W

Section 1
33S 6W

Harper County

Top Perf: 5082'
-97.927987 37.199390

VOGEL 3306 1-1

Miss Entry: 4636'
-97.927968 37.198219

STEWART 3306 2-1H

ALICE 3306 2-12H

STEWART 3306 3-1H

Section 11
33S 6W

Section 12
33S 6W

ALICE 3306 1-12H



Actual Bottom-Hole Location of Stewart 3306 2-1H
T&R: 33S 6W
Section: 1, 666' FWL & 806' FNL
-97.928438 37.208777

1 in = 667 ft

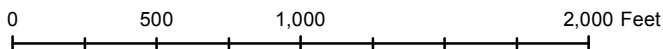

● Actual BH Location

* SandRidge Wells

--- Perf

□ Sections

Draftsman:

Dory Deines

Draft Date: 10/1/2014

Drawing Name/Number:

Addendum_Stewart 3306 2-1H.mxd

Coordinate System:

NAD 1927 State Plane
Kansas South FIPS: 1502