

**Proposed Plan of Construction**  
 E.C. Moody 5-29  
 Sec 29 T25S-R33W  
 Finney County, KS

---

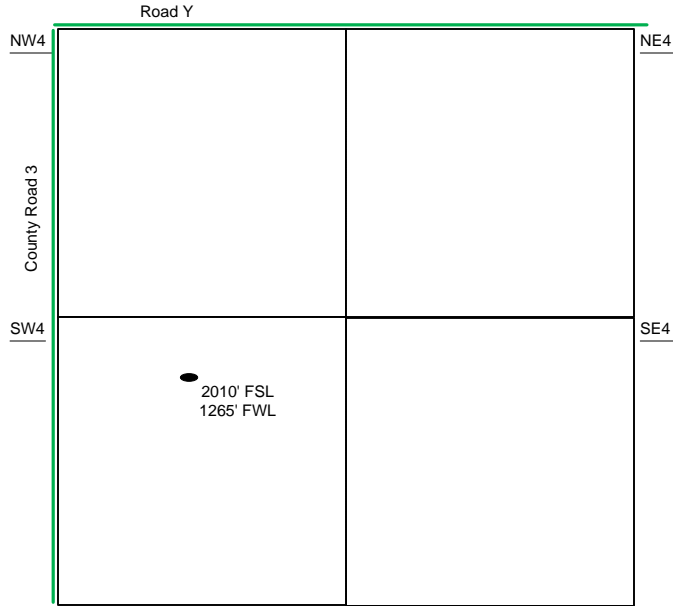

Sec 29 – T25S – R33W

---

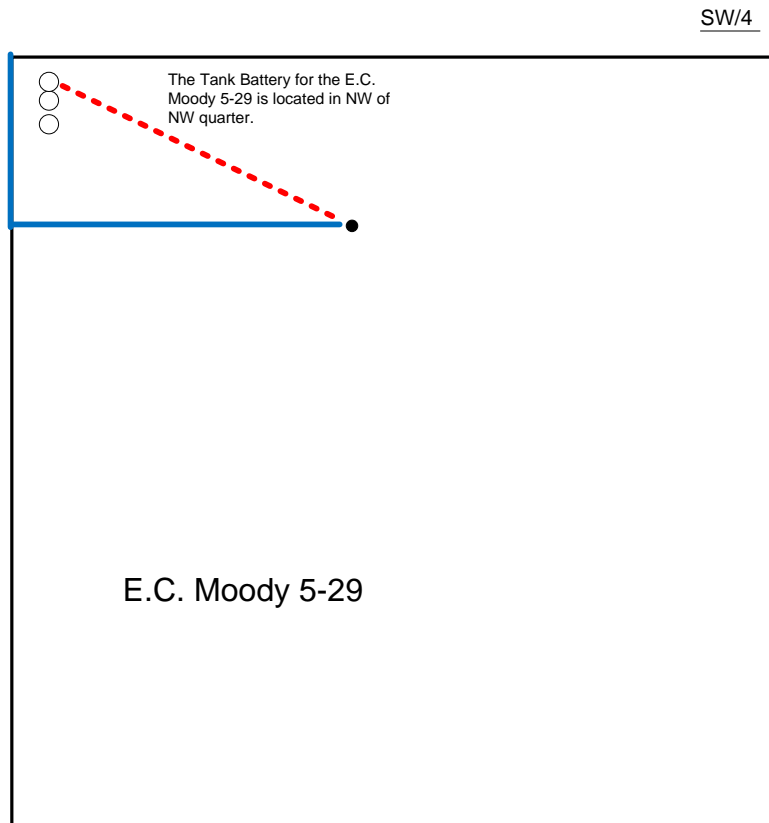

- Well Location
- Proposed Lease Roads
- - - Proposed Pipeline
- Proposed Tank Battery
- Proposed Power Lines
- - - Existing Pipeline

Proposed Details of  
 SW/4 Sec 29 – T25S – R33W

---

Proposed Site Diagram  
 E.C. Moody 5-29  
 October 13, 2014

Note-Drawing **Not** to Scale