

For KCC Use ONLY  
 API # 15 - \_\_\_\_\_

**IN ALL CASES PLOT THE INTENDED WELL ON THE PLAT BELOW**

In all cases, please fully complete this side of the form. Include Items 1 through 5 at the bottom of this page.

Operator: Smith, Richard E. dba Smith Oil Operations  
 Lease: FAIR-SLEEPER TRUST "E"  
 Well Number: 1  
 Field: SNIDER SOUTH

Location of Well: County: STAFFORD  
1155 feet from  N /  S Line of Section  
1568 feet from  E /  W Line of Section  
 Sec. 15 Twp. 21 S. R. 11  E  W

Number of Acres attributable to well: 320  
 QTR/QTR/QTR/QTR of acreage: W2

Is Section:  Regular or  Irregular

If Section is Irregular, locate well from nearest corner boundary.  
 Section corner used:  NE  NW  SE  SW

**PLAT**

Show location of the well. Show footage to the nearest lease or unit boundary line. Show the predicted locations of lease roads, tank batteries, pipelines and electrical lines, as required by the Kansas Surface Owner Notice Act (House Bill 2032). You may attach a separate plat if desired.

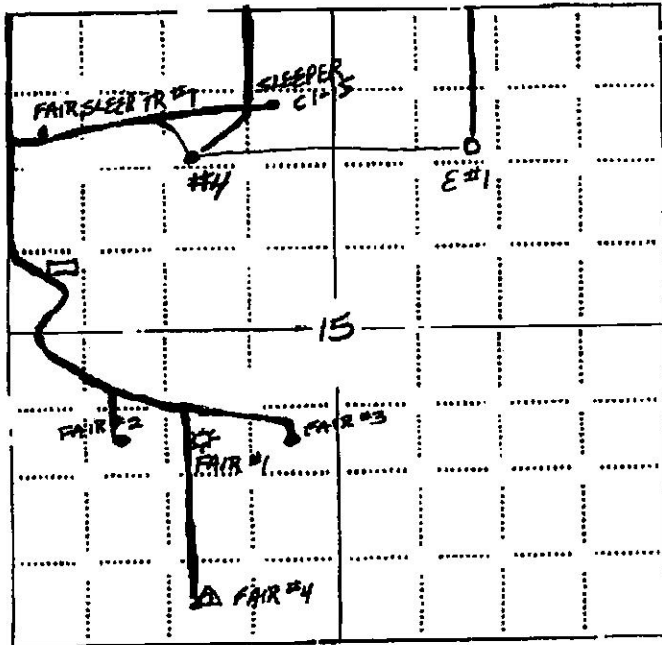

**LEGEND**

- Well Location
- Tank Battery Location
- Pipeline Location
- Electric Line Location
- Lease Road Location

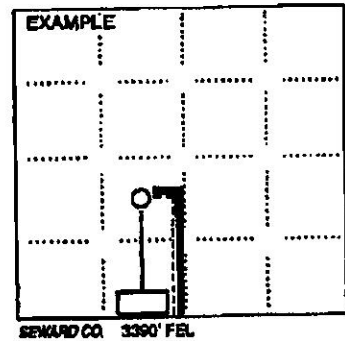

NOTE: In all cases locate the spot of the proposed drilling location.

In plotting the proposed location of the well, you must show:

1. The manner in which you are using the depicted plat by identifying section lines, i.e. 1 section, 1 section with 8 surrounding sections, 4 sections, etc.
2. The distance of the proposed drilling location from the south / north and east / west outside section lines.
3. The distance to the nearest lease or unit boundary line (in footage).
4. If proposed location is located within a prorated or spaced field a certificate of acreage attribution plat must be attached: (CO-7 for oil wells; CG-8 for gas wells).
5. The predicted locations of lease roads, tank batteries, pipelines, and electrical lines.

**BILL CHEW, INC.**  
**FAIR-SLEEPER EAST LEASE**  
**NE. 1/4, SECTION 15, T21S, R11W**  
**STAFFORD COUNTY, KANSAS**

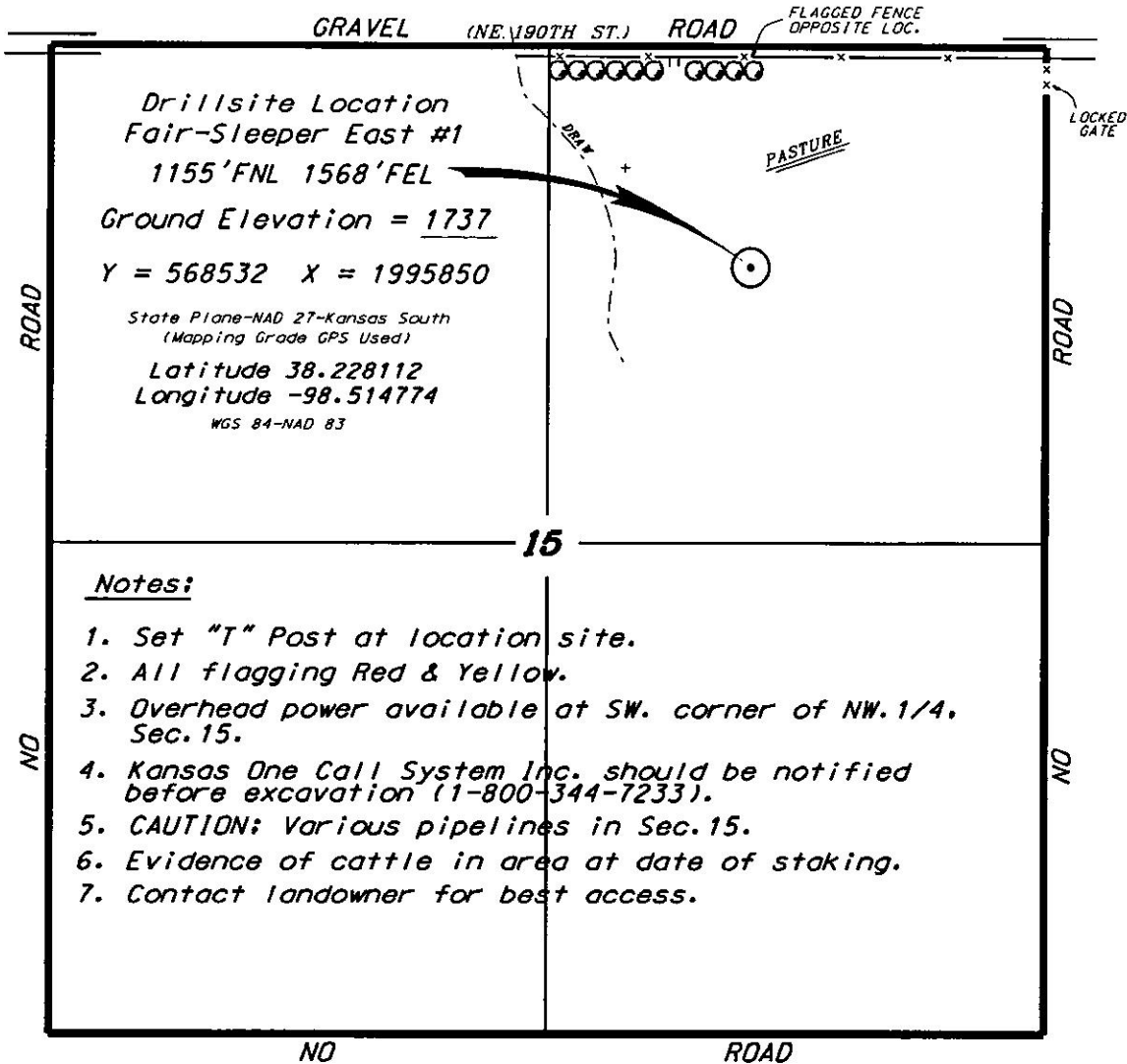

**Notes:**

1. Set "T" Post at location site.
2. All flagging Red & Yellow.
3. Overhead power available at SW. corner of NW. 1/4, Sec. 15.
4. Kansas One Call System Inc. should be notified before excavation (1-800-344-7233).
5. CAUTION: Various pipelines in Sec. 15.
6. Evidence of cattle in area at date of staking.
7. Contact landowner for best access.

\*Ingress and egress to location as shown on this plat is per usage only and may not be legally opened for public use. Contact landowner, tenant and county road department for access.

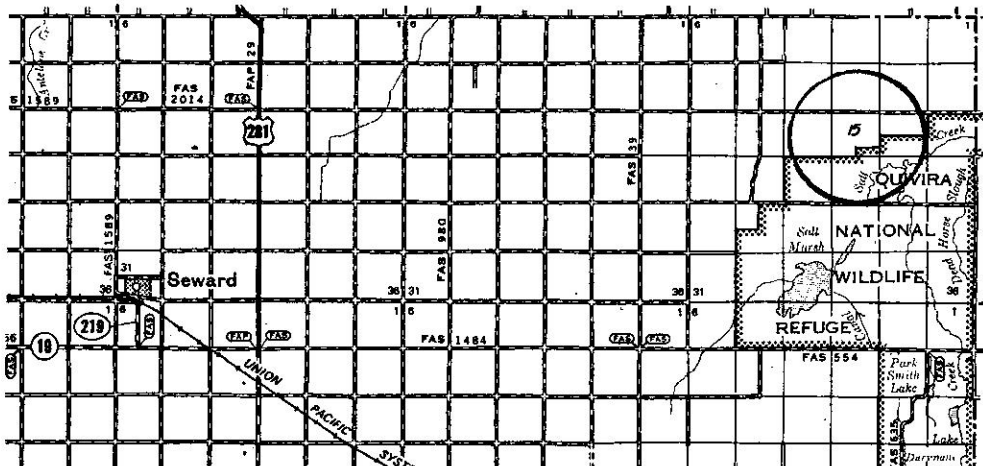

\*Controlling data is based upon the best maps and photographs available to us and upon a regular section of land containing 640 acres.

\*Approximate section lines were determined using the normal standard of care of oilfield surveyors practicing in the state of Kansas. The section corners, which establish the precise section lines, were not necessarily located, and the exact location of the drillsite location in the section is not guaranteed. Therefore, the operator securing this service and accepting this plat and all other parties relying thereon agree to hold Central Kansas Oilfield Services, Inc., its officers and employees harmless from all losses, costs and expenses and said entities released from any liability from incidental or consequential damages.

\*Elevations derived from National Geodetic Vertical Datum.

Date June 24, 2015

**CENTRAL KANSAS OILFIELD SERVICES, INC. (620)792-1977**