





1231864

**For KCC Use ONLY**

API # 15 - \_\_\_\_\_

**IN ALL CASES PLOT THE INTENDED WELL ON THE PLAT BELOW**

In all cases, please fully complete this side of the form. Include items 1 through 5 at the bottom of this page.

Operator: \_\_\_\_\_

Lease: \_\_\_\_\_

Well Number: \_\_\_\_\_

Field: \_\_\_\_\_

Number of Acres attributable to well: \_\_\_\_\_

QTR/QTR/QTR/QTR of acreage: \_\_\_\_\_ - \_\_\_\_\_ - \_\_\_\_\_ - \_\_\_\_\_

Location of Well: County: \_\_\_\_\_

\_\_\_\_\_ feet from  N /  S Line of Section

\_\_\_\_\_ feet from  E /  W Line of Section

Sec. \_\_\_\_\_ Twp. \_\_\_\_\_ S. R. \_\_\_\_\_  E  W

Is Section:  Regular or  Irregular

**If Section is Irregular, locate well from nearest corner boundary.**

Section corner used:  NE  NW  SE  SW

**PLAT**

Show location of the well. Show footage to the nearest lease or unit boundary line. Show the predicted locations of lease roads, tank batteries, pipelines and electrical lines, as required by the Kansas Surface Owner Notice Act (House Bill 2032). You may attach a separate plat if desired.

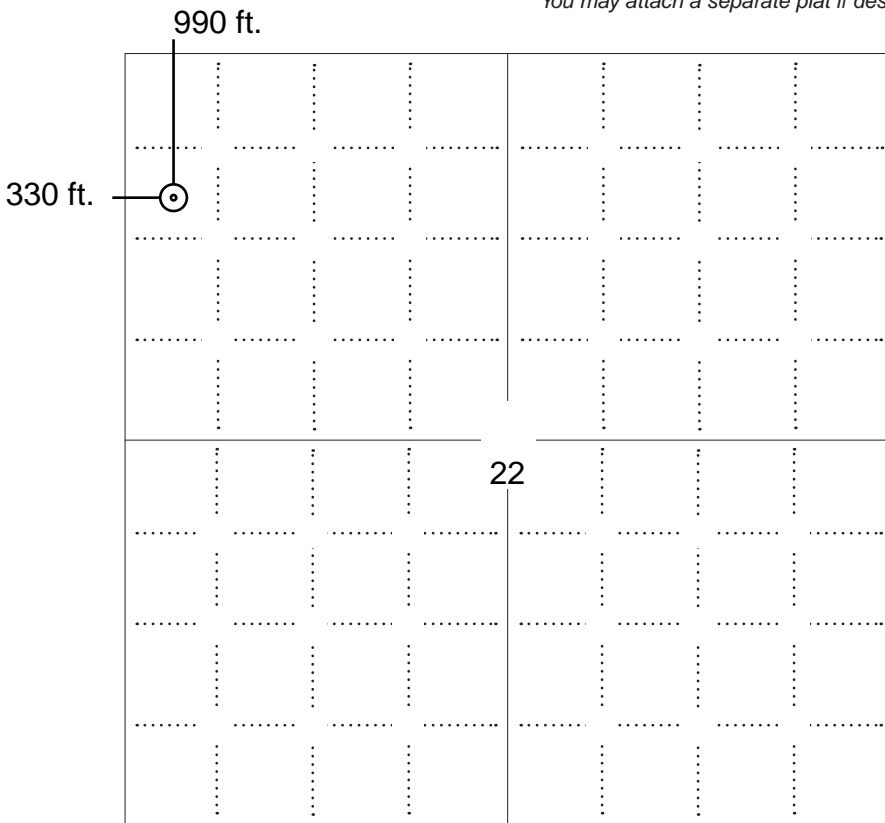

**LEGEND**

- Well Location
- Tank Battery Location
- Pipeline Location
- Electric Line Location
- Lease Road Location



**NOTE: In all cases locate the spot of the proposed drilling locaton.**

**In plotting the proposed location of the well, you must show:**

1. The manner in which you are using the depicted plat by identifying section lines, i.e. 1 section, 1 section with 8 surrounding sections, 4 sections, etc.
2. The distance of the proposed drilling location from the south / north and east / west outside section lines.
3. The distance to the nearest lease or unit boundary line (in footage).
4. If proposed location is located within a prorated or spaced field a certificate of acreage attribution plat must be attached: (C0-7 for oil wells; CG-8 for gas wells).
5. The predicted locations of lease roads, tank batteries, pipelines, and electrical lines.



KANSAS CORPORATION COMMISSION 1231864  
OIL & GAS CONSERVATION DIVISION

Form CDP-1  
May 2010  
Form must be Typed

**APPLICATION FOR SURFACE PIT**

*Submit in Duplicate*

Operator Name: _____		License Number: _____	
Operator Address: _____			
Contact Person: _____		Phone Number: _____	
Lease Name & Well No.: _____		Pit Location (QQQQ): _____-_____-_____-_____	
Type of Pit: <input type="checkbox"/> Emergency Pit <input type="checkbox"/> Burn Pit <input type="checkbox"/> Settling Pit <input type="checkbox"/> Drilling Pit <input type="checkbox"/> Workover Pit <input type="checkbox"/> Haul-Off Pit <i>(If WP Supply API No. or Year Drilled)</i>		Pit is: <input type="checkbox"/> Proposed <input type="checkbox"/> Existing If Existing, date constructed: _____ Pit capacity: _____ (bbls)	
Is the pit located in a Sensitive Ground Water Area? <input type="checkbox"/> Yes <input type="checkbox"/> No		Chloride concentration: _____ mg/l <i>(For Emergency Pits and Settling Pits only)</i>	
Is the bottom below ground level? <input type="checkbox"/> Yes <input type="checkbox"/> No		Artificial Liner? <input type="checkbox"/> Yes <input type="checkbox"/> No	
How is the pit lined if a plastic liner is not used?			
Pit dimensions (all but working pits):    _____ Length (feet)    _____ Width (feet) <input type="checkbox"/> N/A: Steel Pits Depth from ground level to deepest point: _____ (feet) <input type="checkbox"/> No Pit			
If the pit is lined give a brief description of the liner material, thickness and installation procedure.		Describe procedures for periodic maintenance and determining liner integrity, including any special monitoring.	
Distance to nearest water well within one-mile of pit: _____ feet    Depth of water well _____ feet		Depth to shallowest fresh water _____ feet. Source of information: <input type="checkbox"/> measured <input type="checkbox"/> well owner <input type="checkbox"/> electric log <input type="checkbox"/> KDWR	
<b>Emergency, Settling and Burn Pits ONLY:</b> Producing Formation: _____ Number of producing wells on lease: _____ Barrels of fluid produced daily: _____ Does the slope from the tank battery allow all spilled fluids to flow into the pit? <input type="checkbox"/> Yes <input type="checkbox"/> No		<b>Drilling, Workover and Haul-Off Pits ONLY:</b> Type of material utilized in drilling/workover: _____ Number of working pits to be utilized: _____ Abandonment procedure: _____ Drill pits must be closed within 365 days of spud date.	
<p><b>Submitted Electronically</b></p>			

**KCC OFFICE USE ONLY**

Liner     Steel Pit     RFAC     RFAS

Date Received: \_\_\_\_\_ Permit Number: \_\_\_\_\_ Permit Date: \_\_\_\_\_ Lease Inspection:     Yes     No



### CERTIFICATION OF COMPLIANCE WITH THE KANSAS SURFACE OWNER NOTIFICATION ACT

*This form must be submitted with all Forms C-1 (Notice of Intent to Drill); CB-1 (Cathodic Protection Borehole Intent); T-1 (Request for Change of Operator Transfer of Injection or Surface Pit Permit); and CP-1 (Well Plugging Application). Any such form submitted without an accompanying Form KSONA-1 will be returned.*

Select the corresponding form being filed:  C-1 (Intent)  CB-1 (Cathodic Protection Borehole Intent)  T-1 (Transfer)  CP-1 (Plugging Application)

OPERATOR: License # \_\_\_\_\_  
Name: \_\_\_\_\_  
Address 1: \_\_\_\_\_  
Address 2: \_\_\_\_\_  
City: \_\_\_\_\_ State: \_\_\_\_\_ Zip: \_\_\_\_\_ + \_\_\_\_\_  
Contact Person: \_\_\_\_\_  
Phone: ( \_\_\_\_\_ ) \_\_\_\_\_ Fax: ( \_\_\_\_\_ ) \_\_\_\_\_  
Email Address: \_\_\_\_\_

Well Location:  
\_\_\_\_ - \_\_\_\_ - \_\_\_\_ - \_\_\_\_ Sec. \_\_\_\_ Twp. \_\_\_\_ S. R. \_\_\_\_  East  West  
County: \_\_\_\_\_  
Lease Name: \_\_\_\_\_ Well #: \_\_\_\_\_

*If filing a Form T-1 for multiple wells on a lease, enter the legal description of the lease below:*

**Surface Owner Information:**

Name: \_\_\_\_\_  
Address 1: \_\_\_\_\_  
Address 2: \_\_\_\_\_  
City: \_\_\_\_\_ State: \_\_\_\_\_ Zip: \_\_\_\_\_ + \_\_\_\_\_

*When filing a Form T-1 involving multiple surface owners, attach an additional sheet listing all of the information to the left for each surface owner. Surface owner information can be found in the records of the register of deeds for the county, and in the real estate property tax records of the county treasurer.*

*If this form is being submitted with a Form C-1 (Intent) or CB-1 (Cathodic Protection Borehole Intent), you must supply the surface owners and the KCC with a plat showing the predicted locations of lease roads, tank batteries, pipelines, and electrical lines. The locations shown on the plat are preliminary non-binding estimates. The locations may be entered on the Form C-1 plat, Form CB-1 plat, or a separate plat may be submitted.*

**Select one of the following:**

- I certify that, pursuant to the Kansas Surface Owner Notice Act (House Bill 2032), I have provided the following to the surface owner(s) of the land upon which the subject well is or will be located: 1) a copy of the Form C-1, Form CB-1, Form T-1, or Form CP-1 that I am filing in connection with this form; 2) if the form being filed is a Form C-1 or Form CB-1, the plat(s) required by this form; and 3) my operator name, address, phone number, fax, and email address.
- I have not provided this information to the surface owner(s). I acknowledge that, because I have not provided this information, the KCC will be required to send this information to the surface owner(s). To mitigate the additional cost of the KCC performing this task, I acknowledge that I must provide the name and address of the surface owner by filling out the top section of this form and that I am being charged a \$30.00 handling fee, payable to the KCC, which is enclosed with this form.

*If choosing the second option, submit payment of the \$30.00 handling fee with this form. If the fee is not received with this form, the KSONA-1 form and the associated Form C-1, Form CB-1, Form T-1, or Form CP-1 will be returned.*

I Submitted Electronically

I

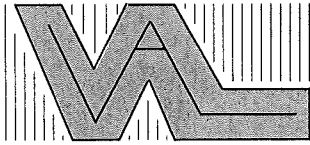

# VAL ENERGY, INC.

200 W. Douglas, Suite 520  
Wichita, Kansas 67202

Office: (316) 263-6688 Fax: (316) 262-2512

November 9<sup>th</sup>, 2014

Kansas Corporation Commission  
130 S. Market Room 2078  
Wichita, KS 67202

Re: Bolack BV 2-22  
Formerly Bolack B-1  
SW NW NW Sec 22-32S-6E  
Cowley County, Kansas

Attn: Rick Hestermann

Dear Rick,

VAL Energy intends to reenter the Bolack B 1-22 located at the above referenced location and has renamed the well the, Bolack BV 2-22 OWWO. This well was drilled in 1961 by Galapp & Everly and 200+ ft of 8 5/8 surface casing was set with 125sx. Of cement, which did circulate. Due to the current regulations requiring 300 ft of surface casing to be set in Range 6E, we request that the permit be approved by the use of Alternate II completion. Should production casing be ran, VAL Energy will 2-stage cement the 5 1/2 casing from 350 ft to surface within the time frame allowed. Should the well be deemed noncommercial, the well will be plugged per the rules and procedures directed by District 2 of the KCC. Time is of the essence as the rig is scheduled to move in Monday November 17, 2016. Please consider and approve the permit application accompanying this letter as all other requirements are met.

Sincerely,

Dustin Wyer



9

WELL LOG

Company: Galapp & Everly  
Winfield, Kansas

Bolack #B #1  
SW NW NW 22-32S-6E  
Cowley County, Kansas

Contractor: Watson Drilling Company, Inc.  
Winfield, Kansas

Commenced: 10/10/61  
Completed: 10/14/61

Casing Record:  
203ft. of 8 5/8" surface casing  
set with 125 sacks cement.

DRY & ABANDONED

lime	0	205
lime & shale	205	820
shale	820	1095
shale & lime	1095	1285
lime	1285	1333
shale	1333	1435
lime	1435	1455
shale & lime	1455	1833
lime	1833	1839
Stalnaker sand	1839	2025
lime	2025	2081
shale	2081	2237
Hogshooter	2237	2239
shale	2239	2280
sand	2280	2298
Core #1	2298	2313

Circulate @ 2282-2285 & 2298  
Full recovery

T. D. 2313

RECEIVED  
STATE GEOLOGICAL SURVEY

OCT 17 1961

STATE GEOLOGICAL SURVEY  
TOPEKA, KANSAS

WELL PLUGGING RECORD

9

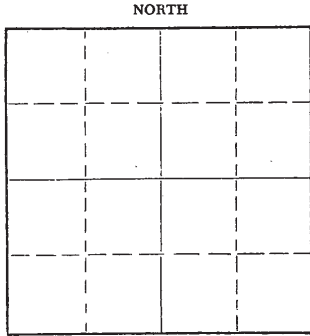

Locate well correctly on above Section Plat

Cowley County, Sec. 22 Twp. 32 Rge. 6 E (E) (W)  
 Location as "NE/CNW/SW" or footage from lines SW NW NW  
 Lease Owner Gralapp & Everly  
 Lease Name Bolack "B" Well No. 1  
 Office Address 528 State Bank Bldg., Winfield, Kansas  
 Character of Well (completed as Oil, Gas or Dry Hole) Dry Hole  
 Date well completed October 14 19 61  
 Application for plugging filed " 14 19 61  
 Application for plugging approved " 14 19 61  
 Plugging commenced " 14 19 61  
 Plugging completed " 14 19 61  
 Reason for abandonment of well or producing formation \_\_\_\_\_

If a producing well is abandoned, date of last production \_\_\_\_\_ 19 \_\_\_\_\_  
 Was permission obtained from the Conservation Division or its agents before plugging was commenced? yes

Name of Conservation Agent who supervised plugging of this well Eugene Graham  
 Producing formation \_\_\_\_\_ Depth to top \_\_\_\_\_ Bottom \_\_\_\_\_ Total Depth of Well 2313 Feet  
 Show depth and thickness of all water, oil and gas formations.

OIL, GAS OR WATER RECORDS

CASING RECORD

FORMATION	CONTENT	FROM	TO	SIZE	PUT IN	PULLED OUT

Describe in detail the manner in which the well was plugged, indicating where the mud fluid was placed and the method or methods used in introducing it into the hole. If cement or other plugs were used, state the character of same and depth placed, from 2313 feet to 0 feet for each plug set.

Heavy mud from 2313 feet to 240 feet; 15 sacks of cement; heavy mud to 40 feet; 10 sacks of cement to 0 feet. 2 sacks of cement in rat hole.

RECEIVED  
 STATE CORPORATION COMMISSION

OCT 27 1961

CONSERVATION DIVISION  
 Wichita, Kansas

(If additional description is necessary, use BACK of this sheet)  
 Name of Plugging Contractor Watson Drilling Company, Inc.  
 Address State Bank Bldg., Winfield, Kansas

STATE OF Kansas, COUNTY OF Cowley, ss.  
Joe R. Everly (employee of owner) or (owner or operator) of the above-described well, being first duly sworn on oath, says: That I have knowledge of the facts, statements, and matters herein contained and the log of the above-described well as filed and that the same are true and correct. So help me God.

(Signature) Joe R. Everly  
528 State Bank Bldg., Winfield, Kansas  
 (Address)

SUBSCRIBED AND SWORN TO before me this 26th day of October, 19 61

My commission expires April 9, 1965

Grace Hill Notary Public.





November 14, 2014

Val Energy, Inc.  
125 N Market St, Ste 1710  
Wichita, KS 67202-1728

RE: Table I Exception  
Bolack BV 2-22 OWWO, Sec.22-T32S-R6E, Cowley County

Dear Mr. Wyer:

The Kansas Corporation Commission (KCC) has received your request, dated November 9, 2014, for an exception to the Table 1 minimum surface pipe requirement of 300 feet and to utilize the existing 203 feet of surface casing and Alternate II cementing rules for this proposed well location.

After review of this matter by technical staff it was determined that:

1. Bedrock at this location is the Permian Chase Group and is located at or near surface.
2. There are no water wells of record within one mile proposed location.

Based on this information, an exception is granted for the Table 1 Minimum Surface Casing Requirements with the following stipulations:

1. Upon completion of the well, the production or long string casing nearest the formation wall shall be cemented from a depth of at least 350 feet back to the surface **within 120 days from the date of re-entry**. Notify the KCC District #2 office prior to spudding the well. The Alternate II cementing **must** be witnessed by district staff, and notification **must** be made at least one day prior.
2. In the event the well is dry, plugging will be performed according to KCC rules and KCC District #2 requirements.

Sincerely,



Ryan A. Hoffman  
Director

cc: Rene Stucky, Production Dept. Supervisor *RS*  
Jeff Klock - Dist. #2 Supervisor ✓ via e-mail 11/14/14