

OPERATOR: Samuel Gary Jr. & Associates, Inc. 1515 Wynkoop Street, Suite 700
Denver, Colorado 80202 office: 303-831-4673 ; fax: 303-863-7285

WELL NAME: STEVEN 1-35

LOCATION: 330 FSL / 500 FEL Sec. 35-4S-24W NORTON COUNTY

SURFACE OWNERS:
Steven & Joni Berry
P.O. Box 307
Lenora, KS 67645

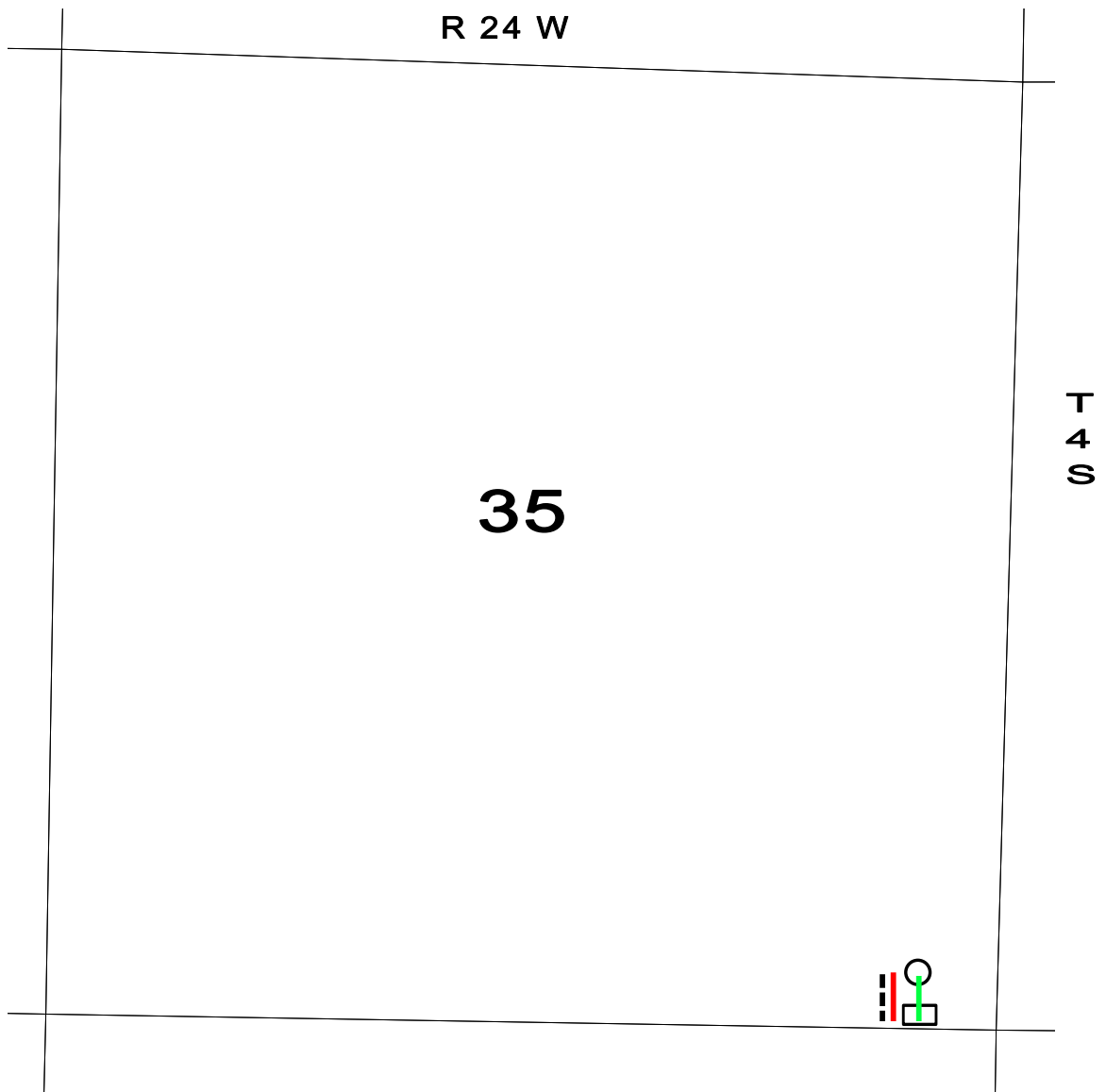

- PROPOSED WELL LOCATION
- ESTIMATED LOCATION OF TANK BATTERY

- ESTIMATED LEASE ROAD
- ESTIMATED LOCATION OF FLOWLINES
- ESTIMATED LOCATION OF ELECTRICAL LINES