

OPERATOR: Samuel Gary Jr. & Associates, Inc. 1515 Wynkoop Street, Suite 700
Denver, Colorado 80202 office: 303-831-4673 ; fax: 303-863-7285

WELL NAME: OTTLEY 1-18

LOCATION: 1730 FNL / 1740 FEL Sec. 18-10S-30W SHERIDAN COUNTY

SURFACE OWNERS:
David & Moriah Ottley
14075 W. Road 120 S.
Grinnell, KS 67738

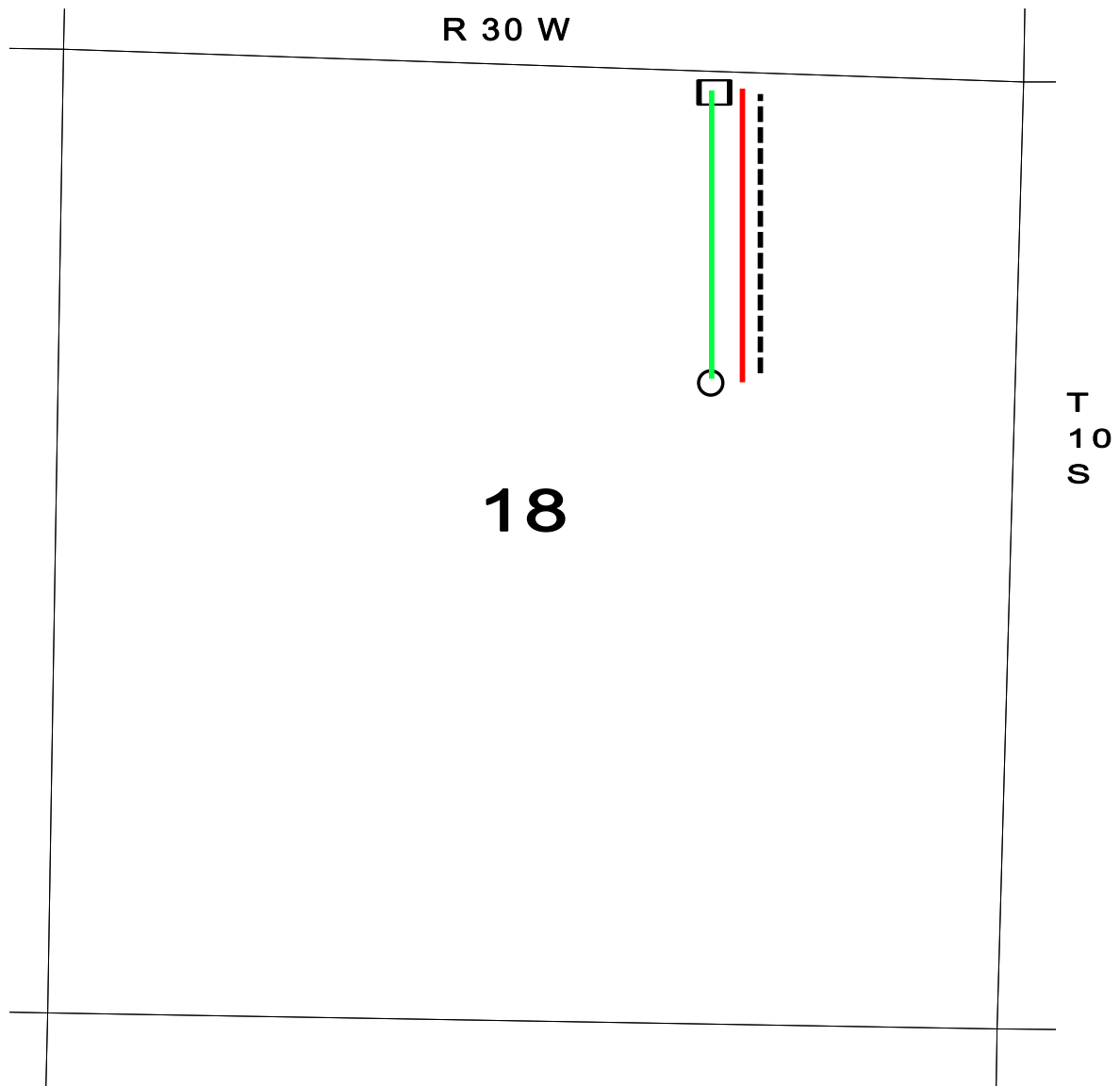

○ PROPOSED WELL LOCATION

□ ESTIMATED LOCATION OF TANK BATTERY

----- ESTIMATED LEASE ROAD
ESTIMATED LOCATION OF FLOWLINES
ESTIMATED LOCATION OF ELECTRICAL LINES