

OPERATOR: Samuel Gary Jr. & Associates, Inc. 1515 Wynkoop Street, Suite 700
Denver, Colorado 80202 office: 303-831-4673 ; fax: 303-863-7285

WELL NAME: RATCLIFF 1-18

LOCATION: 1980 FSL / 1980 FWL Sec. 18-5S-32W RAWLINS COUNTY

SURFACE OWNERS:
Marvin & Dorothy Ratcliff
4834 Birdseye Road
Helena, Montana 59602

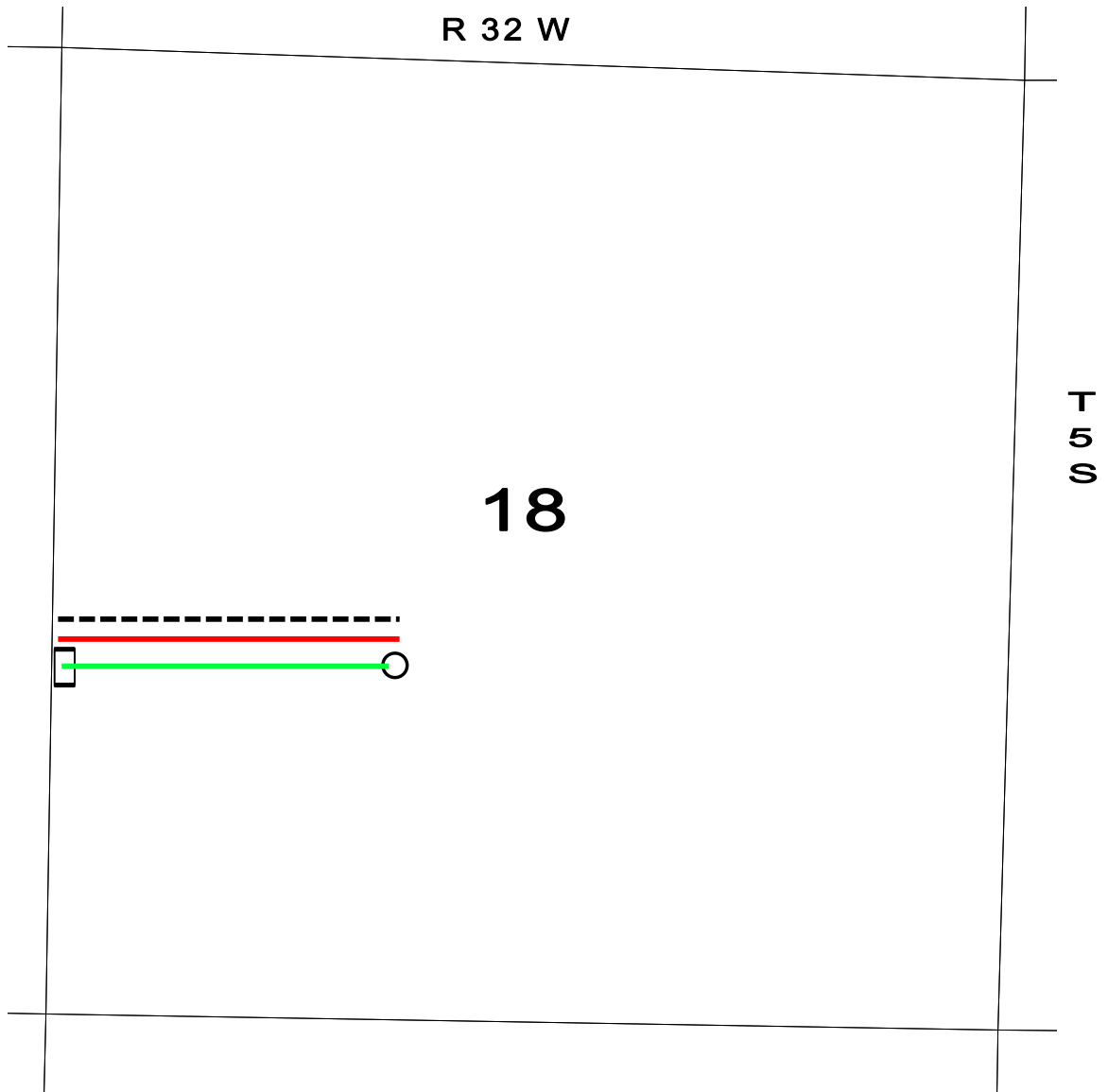

- PROPOSED WELL LOCATION
- ESTIMATED LOCATION OF TANK BATTERY

- ESTIMATED LEASE ROAD
- ESTIMATED LOCATION OF FLOWLINES
- ESTIMATED LOCATION OF ELECTRICAL LINES