



Confidentiality Requested:

Yes No

KANSAS CORPORATION COMMISSION 1235419
OIL & GAS CONSERVATION DIVISION

Form ACO-1

August 2013

Form must be Typed
Form must be Signed
All blanks must be Filled

WELL COMPLETION FORM
WELL HISTORY - DESCRIPTION OF WELL & LEASE

OPERATOR: License # _____

Name: _____

Address 1: _____

Address 2: _____

City: _____ State: _____ Zip: _____ + _____

Contact Person: _____

Phone: (_____) _____

CONTRACTOR: License # _____

Name: _____

Wellsite Geologist: _____

Purchaser: _____

Designate Type of Completion:

- New Well Re-Entry Workover
- Oil WSW SWD SIOW
- Gas D&A ENHR SIGW
- OG GSW Temp. Abd.
- CM (Coal Bed Methane)
- Cathodic Other (Core, Expl., etc.): _____

If Workover/Re-entry: Old Well Info as follows:

Operator: _____

Well Name: _____

Original Comp. Date: _____ Original Total Depth: _____

- Deepening Re-perf. Conv. to ENHR Conv. to SWD
- Plug Back Conv. to GSW Conv. to Producer
- Commingled Permit #: _____
- Dual Completion Permit #: _____
- SWD Permit #: _____
- ENHR Permit #: _____
- GSW Permit #: _____

Spud Date or Recompletion Date	Date Reached TD	Completion Date or Recompletion Date
-----------------------------------	-----------------	---

API No. 15 - _____

Spot Description: _____

_____ - _____ - _____ Sec. _____ Twp. _____ S. R. _____ East West

_____ Feet from North / South Line of Section

_____ Feet from East / West Line of Section

Footages Calculated from Nearest Outside Section Corner:

- NE NW SE SW

GPS Location: Lat: _____, Long: _____
(e.g. xx.xxxxx) (e.g. -xxx.xxxxx)

Datum: NAD27 NAD83 WGS84

County: _____

Lease Name: _____ Well #: _____

Field Name: _____

Producing Formation: _____

Elevation: Ground: _____ Kelly Bushing: _____

Total Vertical Depth: _____ Plug Back Total Depth: _____

Amount of Surface Pipe Set and Cemented at: _____ Feet

Multiple Stage Cementing Collar Used? Yes No

If yes, show depth set: _____ Feet

If Alternate II completion, cement circulated from: _____

feet depth to: _____ w/ _____ sx cmt.

Drilling Fluid Management Plan

(Data must be collected from the Reserve Pit)

Chloride content: _____ ppm Fluid volume: _____ bbls

Dewatering method used: _____

Location of fluid disposal if hauled offsite:

Operator Name: _____

Lease Name: _____ License #: _____

Quarter _____ Sec. _____ Twp. _____ S. R. _____ East West

County: _____ Permit #: _____

AFFIDAVIT

I am the affiant and I hereby certify that all requirements of the statutes, rules and regulations promulgated to regulate the oil and gas industry have been fully complied with and the statements herein are complete and correct to the best of my knowledge.

Submitted Electronically

KCC Office Use ONLY

- Confidentiality Requested
Date: _____
- Confidential Release Date: _____
- Wireline Log Received
- Geologist Report Received
- UIC Distribution
- ALT I II III Approved by: _____ Date: _____

1235419

Operator Name: _____ Lease Name: _____ Well #: _____

Sec. _____ Twp. _____ S. R. _____ East West County: _____

INSTRUCTIONS: Show important tops of formations penetrated. Detail all cores. Report all final copies of drill stems tests giving interval tested, time tool open and closed, flowing and shut-in pressures, whether shut-in pressure reached static level, hydrostatic pressures, bottom hole temperature, fluid recovery, and flow rates if gas to surface test, along with final chart(s). Attach extra sheet if more space is needed.

Final Radioactivity Log, Final Logs run to obtain Geophysical Data and Final Electric Logs must be emailed to kcc-well-logs@kcc.ks.gov. Digital electronic log files must be submitted in LAS version 2.0 or newer AND an image file (TIFF or PDF).

Drill Stem Tests Taken <i>(Attach Additional Sheets)</i>	<input type="checkbox"/> Yes <input type="checkbox"/> No	<input type="checkbox"/> Log	Formation (Top), Depth and Datum	<input type="checkbox"/> Sample
Samples Sent to Geological Survey	<input type="checkbox"/> Yes <input type="checkbox"/> No	Name	Top	Datum
Cores Taken	<input type="checkbox"/> Yes <input type="checkbox"/> No			
Electric Log Run	<input type="checkbox"/> Yes <input type="checkbox"/> No			
List All E. Logs Run:				

CASING RECORD <input type="checkbox"/> New <input type="checkbox"/> Used							
Report all strings set-conductor, surface, intermediate, production, etc.							
Purpose of String	Size Hole Drilled	Size Casing Set (In O.D.)	Weight Lbs. / Ft.	Setting Depth	Type of Cement	# Sacks Used	Type and Percent Additives

ADDITIONAL CEMENTING / SQUEEZE RECORD				
Purpose:	Depth Top Bottom	Type of Cement	# Sacks Used	Type and Percent Additives
<input type="checkbox"/> Perforate				
<input type="checkbox"/> Protect Casing				
<input type="checkbox"/> Plug Back TD				
<input type="checkbox"/> Plug Off Zone				

Did you perform a hydraulic fracturing treatment on this well? Yes No *(If No, skip questions 2 and 3)*

Does the volume of the total base fluid of the hydraulic fracturing treatment exceed 350,000 gallons? Yes No *(If No, skip question 3)*

Was the hydraulic fracturing treatment information submitted to the chemical disclosure registry? Yes No *(If No, fill out Page Three of the ACO-1)*

Shots Per Foot	PERFORATION RECORD - Bridge Plugs Set/Type Specify Footage of Each Interval Perforated	Acid, Fracture, Shot, Cement Squeeze Record <i>(Amount and Kind of Material Used)</i>	Depth

TUBING RECORD: Size: _____ Set At: _____ Packer At: _____ Liner Run: Yes No

Date of First, Resumed Production, SWD or ENHR. _____ Producing Method:
 Flowing Pumping Gas Lift Other *(Explain)* _____

Estimated Production Per 24 Hours	Oil Bbls.	Gas Mcf	Water Bbls.	Gas-Oil Ratio	Gravity

DISPOSITION OF GAS: <input type="checkbox"/> Vented <input type="checkbox"/> Sold <input type="checkbox"/> Used on Lease <i>(If vented, Submit ACO-18.)</i>	METHOD OF COMPLETION: <input type="checkbox"/> Open Hole <input type="checkbox"/> Perf. <input type="checkbox"/> Dually Comp. <input type="checkbox"/> Commingled <i>(Submit ACO-5)</i> <input type="checkbox"/> Other <i>(Specify)</i> _____	PRODUCTION INTERVAL: _____ _____
--	--	---

Form	ACO1 - Well Completion
Operator	Circle Star Operating Corp
Well Name	Lynd Family Trust 18-1
Doc ID	1235419

All Electric Logs Run

DIL
GR
CDN
ML

Form	ACO1 - Well Completion
Operator	Circle Star Operating Corp
Well Name	Lynd Family Trust 18-1
Doc ID	1235419

Tops

Name	Top	Datum
Cedar Hill	1246	998
Anhydrite	1710	534
Topeka	3289	-1045
Heebner	3511	-1267
Lansing	3541	-1297
Base of KC	3788	-1544
Marmaton	3850	-1606
Arbuckle	3955	-1711

Form	ACO1 - Well Completion
Operator	Circle Star Operating Corp
Well Name	Lynd Family Trust 18-1
Doc ID	1235419

Perforations

Shots Per Foot	Perforation Record	Material Record	Depth
2	3854-3870	500 gallon 15% HCL	3854-70
2	3744-48	250 gallon 15% HCL	3744-48
2	3706-10	500 gallons 15% HCL	3706-10
2	3623-27	500 gallons 15% HCL	3623-27
2	3589-91	250 gallons 15% HCL	3589-91
2	1438-52	none	
2	1352-74	none	



PO Box 93999
Southlake, TX 76092

Voice: (817) 546-7282
Fax: (817) 246-3361



INVOICE

Invoice Number: 145180
Invoice Date: Aug 21, 2014
Page: 1

Bill To:
Circle Star Operating Corp
7065 Confederate Pk Rd
Suite 102
Fort Worth, TX 76108

RECEIVED
9/2/14
129

Customer ID	Field Ticket #	Payment Terms	
CircSt	55056	Net 30 Days	
Job Location	Camp Location	Service Date	Due Date
KS2-01	Russell	Aug 21, 2014	9/20/14

Quantity	Item	Description	Unit Price	Amount
1.00	WELL NAME	Lynd Family Trust #18-1		
200.00	CEMENT MATERIALS	Class A Common	17.90	3,580.00
376.00	CEMENT MATERIALS	Gel	0.50	188.00
564.00	CEMENT MATERIALS	Chloride	1.10	620.40
200.00	CEMENT SERVICE	Cubic Feet Charge	2.48	496.00
329.00	CEMENT SERVICE	Ton Mileage Charge	2.75	904.75
1.00	CEMENT SERVICE	Surface	1,512.25	1,512.25
35.00	CEMENT SERVICE	Light Vehicle Mileage	4.40	154.00
70.00	CEMENT SERVICE	Heavy Vehicle Mileage	7.70	539.00
1.00	OPERATOR ASSISTANT	Danny Sinner		
1.00	OPERATOR ASSISTANT	Tracy Jordan		

ALL PRICES ARE NET, PAYABLE
30 DAYS FOLLOWING DATE OF
INVOICE. 1 1/2% CHARGED
THEREAFTER. IF ACCOUNT IS
CURRENT, TAKE DISCOUNT OF

\$ 1,998.60

ONLY IF PAID ON OR BEFORE
Sep 20, 2014

Subtotal	7,994.40
Sales Tax	335.71
Total Invoice Amount	8,330.11
Payment/Credit Applied	
TOTAL	8,330.11

ALLIED OIL & GAS SERVICES, LLC 055056

Federal Tax I.D.# 20-5975804

REMIT TO P.O. BOX 31
RUSSELL, KANSAS 67665

SERVICE POINT:
Russell

DATE <u>8-21-14</u>	SEC. <u>18</u>	TWP. <u>11</u>	RANGE <u>21</u>	CALLED OUT <u>5:00pm</u>	ON LOCATION <u>6:30</u>	JOB START <u>10:30</u>	JOB FINISH <u>11:00 PM</u>
LEASE <u>Family Trust</u>		WELL # <u>18-1</u>	LOCATION <u>Oballah-7N-2E-1E into</u>		COUNTY <u>Trego</u>	STATE <u>Ks</u>	
OLD OR <input checked="" type="radio"/> NEW (Circle one)							

CONTRACTOR Integrity Drilling

TYPE OF JOB 8578 Surface

HOLE SIZE 12 1/4 T.D. 225

CASING SIZE 2 5/8 DEPTH 222

TUBING SIZE _____ DEPTH _____

DRILL PIPE _____ DEPTH _____

TOOL _____ DEPTH _____

PRES. MAX 500 MINIMUM 0

MEAS. LINE _____ SHOE JOINT 15

CEMENT LEFT IN CSG. 15'

PERFS. _____

DISPLACEMENT 13

EQUIPMENT

PUMP TRUCK CEMENTER Steve Orlando

417 HELPER Danny Sinner

BULK TRUCK _____

378 DRIVER Tracy Jordan

BULK TRUCK _____

_____ DRIVER _____

OWNER _____	CEMENT	AMOUNT ORDERED <u>200sk</u>
COMMON <u>200</u>	@ <u>17.90</u>	<u>3580.00</u>
POZMIX _____	@ _____	_____
GEL <u>376</u>	@ <u>.50</u>	<u>188.00</u>
CHLORIDE <u>564</u>	@ <u>1.10</u>	<u>620.40</u>
ASC _____	@ _____	_____
<u>Material</u>	@ _____	<u>4388.40</u>
<u>Alum</u>	@ <u>1097.10</u>	_____
HANDLING <u>200sk</u>	@ <u>2.48</u>	<u>496.00</u>
MILEAGE <u>329.7m</u>	@ <u>2.75</u>	<u>904.75</u>
TOTAL		<u>5789.15</u>

REMARKS:

CHARGE TO: Circle Star Operating Corp

STREET _____

CITY _____ STATE _____ ZIP _____

SERVICE

DEPTH OF JOB <u>0-500</u>	<u>1512.25</u>
PUMP TRUCK CHARGE _____	_____
EXTRA FOOTAGE _____	@ _____
MILEAGE <u>35</u>	@ <u>4.40</u> <u>154.00</u>
MANIFOLD _____	@ _____
<u>Heavy Vehicle 70</u>	@ <u>7.70</u> <u>539.00</u>
<u>Alum 901.50</u>	TOTAL <u>3606.00</u>
	<u>2005.25</u>

PLUG & FLOAT EQUIPMENT

_____	@ _____	_____
_____	@ _____	_____
_____	@ _____	_____
_____	@ _____	_____
_____	@ _____	_____
TOTAL		<u>7994.40</u>

To: Allied Oil & Gas Services, LLC.
You are hereby requested to rent cementing equipment and furnish cementer and helper(s) to assist owner or contractor to do work as is listed. The above work was done to satisfaction and supervision of owner agent or contractor. I have read and understand the "GENERAL TERMS AND CONDITIONS" listed on the reverse side.

SALES TAX (If Any) _____

TOTAL CHARGES 7994.40

DISCOUNT 1998.60 (25%) IF PAID IN 30 DAYS

Net 5995.80

PRINTED NAME _____

SIGNATURE John Lee



PO Box 93999
Southlake, TX 76092

Voice: (817) 546-7282
Fax: (817) 246-3361

INVOICE

Invoice Number: 145341
Invoice Date: Aug 28, 2014
Page: 1

RECEIVED
9/9/14
RT

Bill To:
Circle Star Operating Corp 7065 Confederate Pk Rd Suite 102 Fort Worth, TX 76108

Customer ID	Field Ticket #	Payment Terms	
CircSt	55309	Net 30 Days	
Job Location	Camp Location	Service Date	Due Date
KS2-02	Russell	Aug 28, 2014	9/27/14

Quantity	Item	Description	Unit Price	Amount
1.00	WELL NAME	Lynd Family Trust #18-1		
200.00	CEMENT MATERIALS	ASC	23.50	4,700.00
1,000.00	CEMENT MATERIALS	Gilsonite	0.98	980.00
1,037.00	CEMENT MATERIALS	Salt	0.68	705.16
500.00	CEMENT MATERIALS	Mud Flush	0.98	490.00
200.00	CEMENT SERVICE	Cubic Feet Charge	2.48	496.00
329.00	CEMENT SERVICE	Ton Mileage Charge	2.75	904.75
1.00	CEMENT SERVICE	Long String	2,765.75	2,765.75
35.00	CEMENT SERVICE	Light Vehicle Mileage	4.40	154.00
1.00	CEMENT SERVICE	Manifold Rental	275.00	275.00
70.00	CEMENT SERVICE	Heavy Vehicle Mileage	7.70	539.00
1.00	EQUIPMENT SALES	5-1/2 AFU Float Shoe	545.00	545.00
1.00	EQUIPMENT SALES	5-1/2 Latch Down	660.00	660.00
10.00	EQUIPMENT SALES	5-1/2 Centralizer	57.00	570.00
3.00	EQUIPMENT SALES	5-1/2 Basket	395.00	1,185.00
1.00	EQUIPMENT SALES	Thread Lock	34.00	34.00
1.00	EQUIPMENT SALES	5-1/2 Port Collar	3,590.00	3,590.00
1.00	CEMENT SUPERVISOR	Robert Yakubovich		
1.00	EQUIPMENT OPERATOR	Nathan Donner		
1.00	EQUIPMENT OPERATOR	Kevin Rupp		

Subtotal	18,593.66
Sales Tax	1,029.63
Total Invoice Amount	19,623.29
Payment/Credit Applied	
TOTAL	19,623.29

ALL PRICES ARE NET, PAYABLE
30 DAYS FOLLOWING DATE OF
INVOICE. 1 1/2% CHARGED
THEREAFTER. IF ACCOUNT IS
CURRENT, TAKE DISCOUNT OF

\$ 2,401.93

ONLY IF PAID ON OR BEFORE
Sep 27, 2014

ALLIED OIL & GAS SERVICES, LLC 055309

Federal Tax I.D.# 20-5975804

REMIT TO P.O. BOX 31
RUSSELL, KANSAS 67665

SERVICE POINT:
Russell KS

DATE <u>8-28-11</u>	SEC. <u>18</u>	TWP. <u>11</u>	RANGE <u>21</u>	CALLED OUT	ON LOCATION	JOB START <u>8:30 AM</u>	JOB FINISH <u>9:00 PM</u>
LEASE <u>Yard Family Trust</u>	WELL# <u>18-1</u>		LOCATION <u>Ogallala 7 N 3E to rly</u>		COUNTY <u>Trego</u>	STATE <u>KS</u>	
OLD OR (NEW) (Circle one)							

CONTRACTOR Integrity Drilling #7
 TYPE OF JOB logs string
 HOLE SIZE 7 7/8 I.D. 4010
 CASING SIZE 5 1/2 15.5 DEPTH 4012
 TUBING SIZE DEPTH
 DRILL PIPE DEPTH
 TOOL PC DEPTH 1810
 PRES. MAX MINIMUM
 MEAS. LINE SHOE JOINT 15.99
 CEMENT LEFT IN CSG. 15.99
 PERFS.
 DISPLACEMENT 95

OWNER
 CEMENT
 AMOUNT ORDERED 200 ASC 2.5" Gelsonite 4/s
 COMMON @
 POZMIX @
 GEL @
 CHLORIDE @
 ASC 200 @ 23.50 4700.00
Gelzone - 1000² @ 0.98 980.00
Salt 1037⁴ @ 0.69 705.16
Mud flush 500g @ 0.98 490.00
Material @ 6875.16
20% Disc @ 1375.03
 HANDLING 200.56 @ 2.48 496.00
 MILEAGE 329 #/h 2.75 904.75
 TOTAL ~~8275.97~~

EQUIPMENT
 PUMP TRUCK CEMENTER Robert Y
 # 409 HELPER Matthew D
 BULK TRUCK
 # 481 DRIVER Kevin R
 BULK TRUCK
 # DRIVER

REMARKS:

See log
Thank you!!!

SERVICE
 DEPTH OF JOB 4012
 PUMP TRUCK CHARGE 2765.75
 EXTRA FOOTAGE @
 MILEAGE 35 LV 2.2 @ 4.40 154.00
 MANIFOLD @ 275.00 275.00
70 HV 2.1 @ 7.70 539.00
20% Disc 1026.90 TOTAL 5134.50
~~3733.25~~

CHARGE TO: Circle Star Operating Corp
 STREET _____
 CITY _____ STATE _____ ZIP _____

PLUG & FLOAT EQUIPMENT

WF 5/8 ACU Flang shoe @ 525.00 545.00
 WF 5/8 1st ch down @ 660.00 660.00
 WF controller (10) @ 57.00 570.00
 WF Basket @ 325.00 1135.00
 Thread lock @ 34.00 34.00
 IR 5/8 Part collar 3570.00 3570.00
Disc - 0 - TOTAL 6574.00

To: Allied Oil & Gas Services, LLC.
 You are hereby requested to rent cementing equipment and furnish cementer and helper(s) to assist owner or contractor to do work as is listed. The above work was done to satisfaction and supervision of owner agent or contractor. I have read and understand the "GENERAL TERMS AND CONDITIONS" listed on the reverse side.

PRINTED NAME Payne Woodson
 SIGNATURE [Signature]

SALES TAX (If Any) _____
 TOTAL CHARGES 18593.66
 DISCOUNT 2401.93 20/20/0 IF PAID IN 30 DAYS
net \$ 16191.73

KANSAS CORPORATION COMMISSION
OIL & GAS CONSERVATION DIVISION
APPLICATION FOR INJECTION WELL

Form U-1
July 2014
Form must be Typed
Form must be Signed
All blanks must be Filled

Disposal

Enhanced Recovery: Repressuring
 Waterflood
 Tertiary

Date: 9-30-2014

Operator License Number: 34781 Exp 08/30/15

Operator: Circle Star Operating Corp

Address: 7065 CONFEDERATE PK RD
Suite 102

Received
KANSAS CORPORATION COMMISSION
FORT WORTH : S. Jeffrey Johnson
TX 76108 OCT 15 2014

CC: David E. Bengtson CONSERVATION DIVISION
Contact Person: Jayne Wollison WICHITA, KS

Phone: 817-744-8506

Email: jwollison@circlestarenergy.com

Permit Number: 0-32,049 4-JK

API Number: 15-195-22960-00-00

Well Location

C - SE - SE - SW Sec. 18 Twp. 11 S. R. 21 E W

330 feet from N / S Line of Section

2319 feet from E / W Line of Section

GPS Location: Lat: 39°05'22.4", Long: -99°41'43.0"
(e.g. xx.xxxxx) (e.g. -xx.xxxxx)

Datum: NAD27 NAD83 WGS84

Lease Description: SW 4 SECTION 18 AND S2 OF SE4 SEC 18
11S 21W TREGO COUNTY KANSAS

Lease Name: LYND Well Number: 18-1

Field Name: STRATTON

County: TREGO

Deepest Usable Water

Formation: Dakota

Depth to Bottom of Formation: 900

Check One: Old Well Being Converted Newly Drilled Well Well to be Drilled

Surface Elevation: 2234 feet Well Total Depth: 4020 feet Plug Back Depth: 1800 feet

Datum of top of injection formation: 1425 feet (reference mean sea level)

Injection Formation Description:

Name	top / bottom	perf / open hole	depth
Cedar Hill	1130 / 1450	perforate at	1428 to 1450 feet
Cedar Hill	1130 / 1450	perforate at	1362 to 1384 feet

List of Wells/Facilities Supplying Produced Saltwater or Other Fluids Approved by the Conservation Division:
(attach additional sheets if necessary)

Lease Operator	Lease/Facility Name	Lease/Facility Description	Well ID & Spot Location
1. Circle Star Operating Corp	Lynd Family Trust 13-1	SE 4; 13 11-22	E2 NE NW SE 1044772343
2. Circle Star Operating Corp	Lynd Family Trust 13-2	SW 4; 13 11-22	E2 NW NE SW 1044821561
3. _____	_____	_____	_____

Producing Formation	Strata Depth	Total Dissolved Solids (if available)
1. MARMATON	3860 to 3880 feet	24,000 mg/l
2. MARMATON	3852 to 3872 feet	22,000 mg/l
3. _____	_____ to _____ feet	_____ mg/l

Maximum Requested Liquid Injection Rate: 500 bbls / day; or

Maximum Requested Gas Injection Rate: _____ scf / day. Type of Gas: _____

Maximum Requested Injection Pressure: 100 psig

Well Completion

Type: Tubing & Packer Packerless Tubingless

	Conductor	Surface	Intermediate	Production	Tubing
Size	NA	8.625	NA	5.5	2.875
Setting Depth		225		4020	1340
Amount of Cement		200		200	0
Top of Cement		0		2850	0
Bottom of Cement		225		4020	0

If Alternate II cementing, complete the following:

Perforations / D.V. Tool at 1819 feet, cemented to 0 feet with 220 sx.

Tubing: Type Seal tite Grade J-55 PVC lined

Packer: Type A1 tension Depth 1340

Annulus Corrosion Inhibitor: Type KCL Concentration 3%

List Logs Enclosed: DIL, MIL, CDN, Bond

Well Sketch

(To sketch installation, darken the appropriate lines, indicate cement, and show depths.)

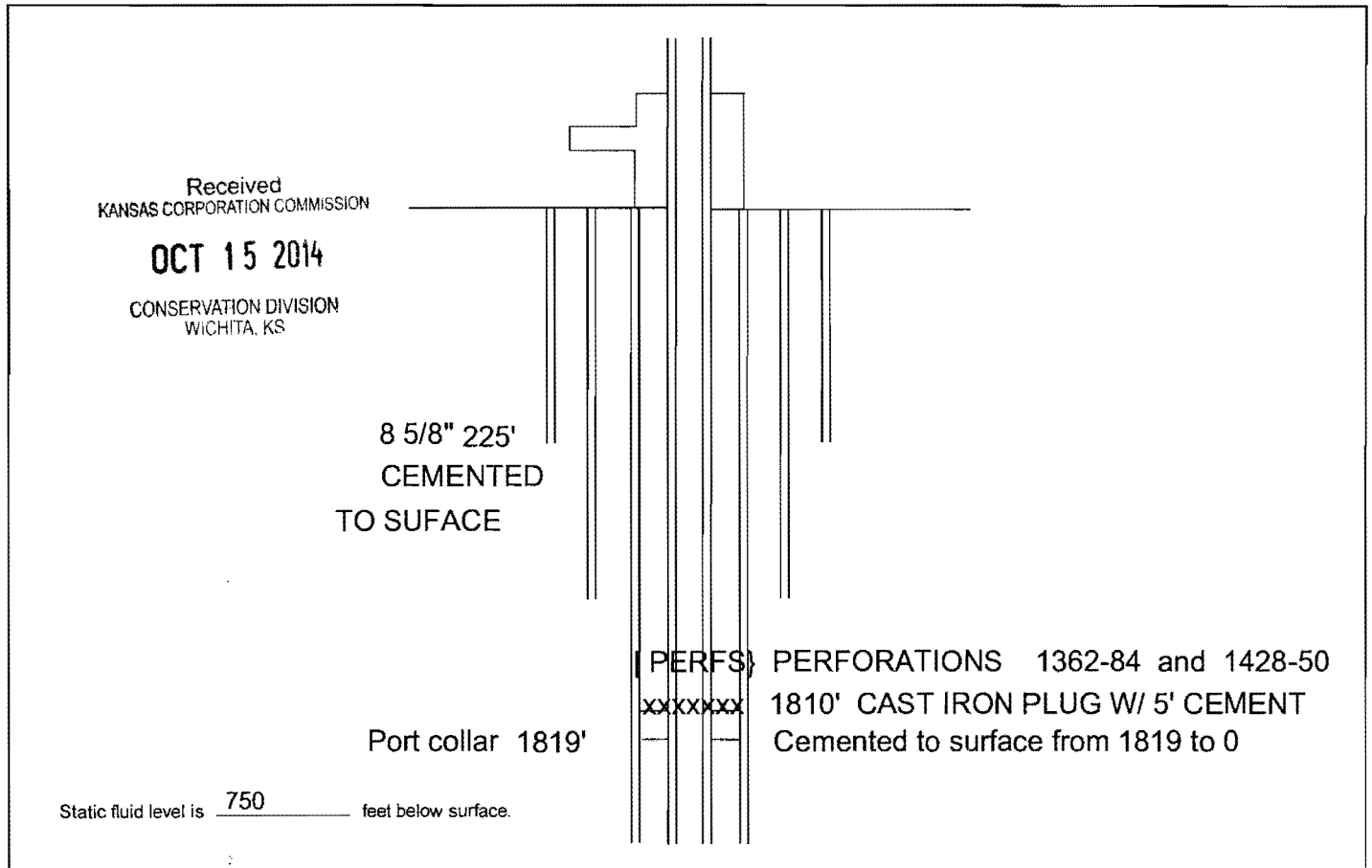

Offset Operators, Unleased Mineral Owners and Landowners acreage

(Attach additional sheets if necessary)

Name:	Legal Description of Leasehold:
Davis Petroleum Inc	See page four
Circle Star Operating Corp	"
Samuel Gary and Associates	"
Pelican Hill Oil and Gas	"

Surface Owner:

Lynd Family Trust Dated 10/30/1996
 Delmer and Dorothy Lynd, Trustees
 34011 F Road
 RR#3 Box 36A
 Ellis, KS 67637

I hereby certify that the statements made herein are true and correct to the best of my knowledge and belief.

[Handwritten Signature]

Applicant or Duly Authorized Agent

Received
KANSAS CORPORATION COMMISSION

OCT 15 2014

CONSERVATION DIVISION
WICHITA, KS

Subscribed and sworn before me this 13th day of October, 2014

[Handwritten Signature: Kay Adams]

Notary Public

My Commission Expires: _____

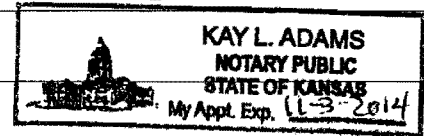

Instructions:

- Fully complete application, including page 4 (*plat map*) showing subject well and all known oil, gas and input wells, including wells being drilled, inactive wells, or dry holes, within one-half mile. Show lease names and operators or unleased mineral rights owners of all lands within one-half mile. Show well numbers and elevations of producing formation tops.
- Attach some type of log (*drillers log, electric log, etc.*).
- Attach some type of verification of cementing for surface casing, longstring, D.V. tool, perforations, etc. (*Cement ticket and job log, bond log, etc.*)
- Attach Affidavit of Notice.
- Fill in schematic drawing of subsurface facilities including: size, setting depth, amount of cement, measured or calculated tops of cement for each of surface, intermediate (*if any*) and production casing; size and setting depth of tubing and packer; geological zone of injection showing top and bottom of injection interval.
- The original and one copy of the application and all attachments shall be mailed to the State Corporation Commission, Conservation Division.
- Deliver or mail one (*1*) copy of the application to the landowner on whose land the injection well is located and to each operator or lessee of record and each unleased mineral rights owner within one-half mile of the applicant well.
- Approval of this application, if granted, is valid only as long as there are no substantial changes in operation set forth in the application. A substantial change requires the approval of a new application. **No injection well may be used without prior written authorization.**
- All application fees must accompany the application.

Plat and Certificate of Injection Well Location and Surrounding Acreages

Operator: CIRCLE STAR OPERATING CORP Location of Well: SE SE SW
 Lease: LYND FAMILY TRUST 330 feet from N / S Line of Section
 Well Number: 18-1 2310 feet from E / W Line of Section
 County: TREGO Sec. 18 Twp. 11 S. R. 21 East West

Plat
 Show the following information: applicant injection well, all producing wells, inactive wells, plugged wells, and other wells within a one-half mile radius, all lease boundaries, lease operators, unleased mineral rights owners, well numbers, and producing wells producing formation tops.

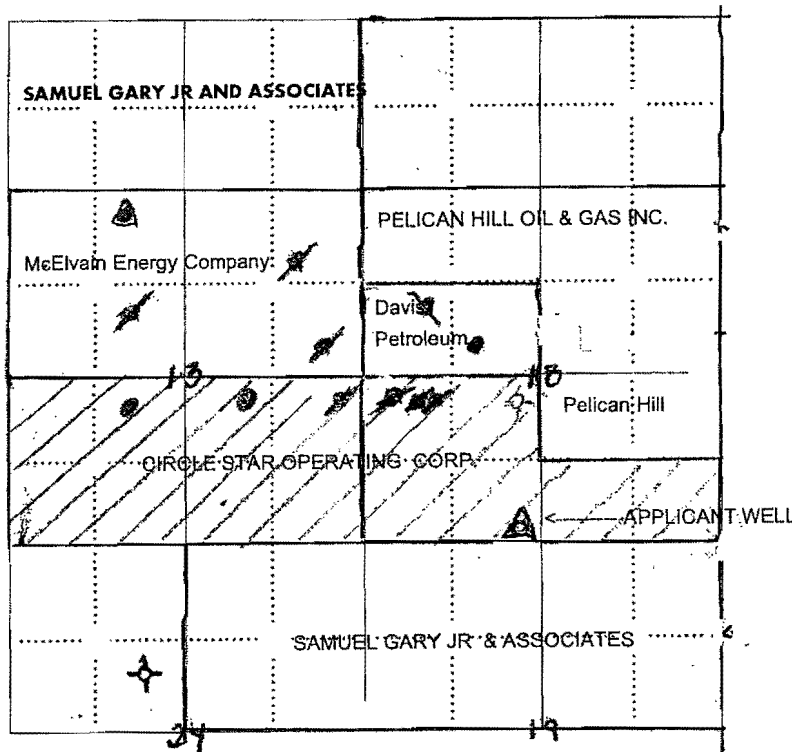

Received
 KANSAS CORPORATION COMMISSION
OCT 15 2014
 CONSERVATION DIVISION
 WICHITA, KS

- applicant well
- producing well
- plugged injection well
- D & A well
- other injection well
- temporary abandoned well
- plugged producer
- water supply well

The undersigned hereby certifies that he / she is a duly authorized agent for Circle Star Operating Corp., and that all of the information shown herein is true, complete and correct to the best of his / her knowledge.

Applicant or Duly Authorized Agent

Subscribed and sworn before me this 13th day of October, 2014

Notary Public

My Commission Expires: _____

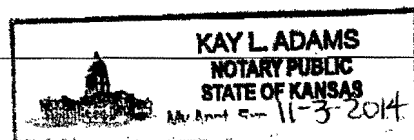

Affidavit of Notice Served

Re: Application for: Circle Star Operating Corp
Well Name: Lynd Family Trust 18-1 SWD Legal Location: C-SE-SE-SW Sec 18-11S-21W

The undersigned hereby certifies that he / she is a duly authorized agent for the applicant, and that on the day 14th of October, 2014, a true and correct copy of the application referenced above was delivered or mailed to the following parties:

Note: A copy of this affidavit must be served as a part of the application.

Name	Address (Attach additional sheets if necessary)
Davis Petroleum Inc.	7 SW 26th Avenue, Great Bend, KS 67530
Circle Star Operating Corp	7065 Confederate Park Rd Suite 102, Ft. Worth TX 76108
Samuel Gary Jr. & Associates, Inc.	1515 Wynkoop, Suite 700, Denver, CO 80202
Pelican Hill Oil & Gas, Inc.	3355 Mission Ave., Suite 237, Oceanside, CA 92058
Lynd Family Trust Dated 10/30/1996 Delmer and Dorothy Lynd, Trustees	34011 F Road, RR#3 Box 36A, Ellis, KS 67637

Received
KANSAS CORPORATION COMMISSION
OCT 15 2014
CONSERVATION DIVISION
WICHITA, KS

I further attest that notice of the filing of this application was published in the Western Kansas World, the official county publication of Trego county. A copy of the affidavit of this publication is attached.

Signed this 13th day of October, 2014

[Signature]
Applicant or Duly Authorized Agent

Subscribed and sworn to before me this 13th day of October, 2014

[Signature]
Notary Public

My Commission Expires: _____

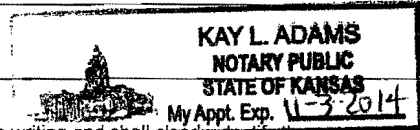

Protests may be filed by any party having a valid interest in the application. Petitions for protests shall be in writing and shall clearly identify the name and address of the protestant and the title of the application. The petition shall include a clear and concise statement of the direct and substantial interest of the protestant in the proceedings, including the manner in which the protestant may be affected, and the nature, extent, character and grounds of the protest. Protestants shall serve the protest upon the applicant by mail or personal service at the same time or before the protestant files the protest with the Conservation Division. Protests must be filed within 30 days of the publication notice of the application.

STATE OF KANSAS,
COUNTY OF TREGO, ss.

Jerry L. Millard/Cathy R. Millard, of lawful age, being duly sworn upon oath states that he/she is the Publisher of

THE WESTERN KANSAS WORLD

A weekly newspaper printed in the State of Kansas, and published in and of general circulation in Trego County, Kansas, with a generally paid circulation on a yearly basis in Trego County, Kansas, and that said newspaper is not a trade, religious or fraternal publication.

Said newspaper is a weekly published at least 50 times a year; has been so published continuously and uninterruptedly in said county and state for a period of more than five years prior to the first publication of said notice; and has been admitted at the post office of WaKeeney, Kansas, in said county as second class matter.

That the attached notice is a true copy thereof and was published in the regular and entire issue of said newspaper for

1 consecutive weeks, the first publication thereof being made as aforesaid on the

9 day of October, 2014.

with subsequent publications being made on the following dates:

_____, 20____
_____, 20____
_____, 20____
_____, 20____

Sign Cathy R. Millard

Subscribed and sworn before this 10 day of October, 2014.

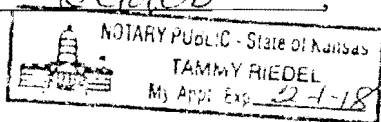

Tammy Riedel
Notary Public

My Commission expires: February 1, 2018

Printer's Fee \$ _____

Additional copies \$ _____

AFFIDAVIT OF PUBLICATION

(Published in the Western Kansas World October 9, 2014)
BEFORE THE STATE CORPORATION COMMISSION
OF THE STATE OF KANSAS

In the Matter of the Application of
CIRCLE STAR OPERATING CORPORATION for a Permit Authorizing the Disposal of Produced Water into the Lynd Family Trust SWD 18-1 Well Located in Trego County, KS
KCC License No. 34781
CONSERVATION DIVISION

NOTICE OF PENDING APPLICATION

TO: ALL OIL AND GAS PRODUCERS, UNLEASED MINERAL INTEREST OWNERS, LANDOWNERS, AND ALL PERSONS WHOMSOEVER CONCERNED.

You, and each of you, are hereby notified that CIRCLE STAR OPERATING CORPORATION has filed an Application before the State Corporation Commission for a permit authorizing the disposal of produced water into the Cedar Hill formation in the Lynd Family Trust SWD 18-1 well located in Trego County, Kansas, at the following location: 330' FSL and 2,319' FWL of Section 18, Township 11 South, Range 21, West Trego County, Kansas. The Application requests that the permit be issued allowing the well to operate with a maximum operating pressure of 100 psig and a maximum injection rate of 500 bbls per day.

The Application for the issuance of a disposal well permit for the Lynd Family Trust SWD 18-1 well is pending before the Commission and will be granted without hearing unless, within thirty (30) days from publication of this notice, a proper written protest is received by the Conservation Division of the Kansas Corporation Commission. Any protest to the Application must be in writing and should clearly state the grounds of objection. The written protest should be mailed to the Kansas Corporation Commission, Conservation Division, 266 North Main Street, Suite 220, Wichita, Kansas, 67202-1513. If a proper written protest is timely filed with the Commission this matter will be set for hearing by the Commission. The hearing will be held at the Commission Hearing Room, Kansas Corporation Commission, 266 North Main Street, Suite 220, Wichita, Kansas.

All parties in any way interested or concerned shall take notice of the foregoing and govern themselves accordingly.

CIRCLE STAR OPERATING CORPORATION
7065 Confederate Park Road, Suite 102
Fort Worth, TX 76108

David E. Bengtson
STINSON LEONARD STREET LLP
1625 N. Waterfront Parkway, Suite 300
Wichita, Kansas 67206-6620
(FAX) 265-1349
Attorneys for Circle Star Operating Corporation

32-1tc

Received
KANSAS CORPORATION COMMISSION

OCT 15 2014

CONSERVATION DIVISION
WICHITA, KS

AFFIDAVIT

STATE OF KANSAS \
- SS.
County of Sedgwick /

Mark Fletchall, of lawful age, being first duly sworn, deposeth and saith: That he is Record Clerk of The Wichita Eagle, a daily newspaper published in the City of Wichita, County of Sedgwick, State of Kansas, and having a general paid circulation on a daily basis in said County, which said newspaper has been continuously and uninterruptedly published in said County for more than one year prior to the first publication of the notice hereinafter mentioned, and which said newspaper has been entered as second class mail matter at the United States Post Office in Wichita, Kansas, and which said newspaper is not a trade, religious or fraternal publication and that a notice of a true copy is hereto attached was published in the regular and entire Morning issue of said The Wichita Eagle for 1 issues, that the first publication of said notice was

made as aforesaid on the 6th of

October A.D. 2014, with

subsequent publications being made on the following dates:

And affiant further says that he has personal knowledge of the statements above set forth and that they are true.

Mark Fletchall

Subscribed and sworn to before me this

6th October, 2014

JENNIFER RAE BAILEY
Notary Public - State of Kansas
My Appt. Expires 10/4/2017

[Handwritten signature]

Notary Public Sedgwick County, Kansas

Printer's Fee : \$244.60

LEGAL PUBLICATION

Published in The Wichita Eagle
October 6, 2014 (3321588)
BEFORE THE STATE CORPORATION
COMMISSION OF THE STATE OF KANSAS
In the Matter of the)
Application of CIRCLE) KCC License
STAR OPERATING) No. 34781
CORPORATION for a) CONSERVATION
Permit Authorizing the) DIVISION
Disposal of Produced)
Water into the Lynd)
Family Trust SWD 18-1)
Well Located in Trego)
County, KS)

NOTICE OF PENDING APPLICATION
TO: ALL OIL AND GAS PRODUCERS,
UNLEASED MINERAL INTEREST
OWNERS, LANDOWNERS, AND ALL
PERSONS WHOMSOEVER CONCERNED.
You, and each of you, are hereby notified that
CIRCLE STAR OPERATING CORPORATION
has filed an Application before the State
Corporation Commission for a permit
authorizing the disposal of produced water into
the Cedar Hill formation in the Lynd Family
Trust SWD 18-1 well located in Trego County,
Kansas, at the following location: 330' FSL and
2,319' FWL of Section 18, Township 11 South,
Range 21 West, Trego County, Kansas. The
Application requests that the permit be issued
allowing the well to operate with a maximum
operating pressure of 100 psig and a maximum
injection rate of 500 bbls per day.
The Application for the issuance of a disposal
well permit for the Lynd Family Trust SWD
18-1 well is pending before the Commission
and will be granted without hearing unless,
within thirty (30) days from publication of this
notice, a proper written protest is received by
the Conservation Division of the Kansas
Corporation Commission. Any protest to the
Application must be in writing and should
clearly state the grounds of objection. The
written protest should be mailed to the Kansas
Corporation Commission, Conservation
Division, 266 North Main Street, Suite 220,
Wichita, Kansas, 67202-1513. If a proper
written protest is timely filed with the
Commission this matter will be set for hearing
by the Commission. The hearing will be held
at the Commission Hearing Room, Kansas
Corporation Commission, 266 North Main
Street, Suite 220, Wichita, Kansas.
All parties in any way interested or concerned
shall take notice of the foregoing and govern
themselves accordingly.

CIRCLE STAR OPERATING
CORPORATION
7065 Confederate Park Road, Suite 102
Fort Worth, TX 76108

David E. Bengtson
STINSON LEONARD STREET LLP
1625 N. Waterfront Parkway, Suite 300
Wichita, Kansas 67206-6620
(316) 265-8800
(FAX) 265-1349

Attorneys for Circle Star Operating
Corporation

Received
KANSAS CORPORATION COMMISSION

OCT 15 2014

CONSERVATION DIVISION
WICHITA, KS

Conservation Division
266 N. Main St., Ste. 220
Wichita, KS 67202-1513



Phone: 316-337-6200
Fax: 316-337-6211
<http://kcc.ks.gov/>

Shari Feist Albrecht, Chair
Jay Scott Emler, Commissioner
Pat Apple, Commissioner

Sam Brownback, Governor

October 15, 2014

S JEFFREY JOHNSON
CIRCLE STAR OPERATING CORP
7065 CONFEDERATE PK RD SUITE 102
FORT WORTH TX 76108

RE: **Application for Injection Well
(Design Approval Requested)**
D-32,049
Lynd #18-1
Sec. 18-11S-21W
Trego County

Dear Mr. Johnson:

This letter is to confirm that we received the above referenced application in the KCC-Central Office on October 15, 2014.

Should you have any **questions** regarding the application, please do not hesitate to **contact Jerry Knobel at j.knobel@kcc.ks.gov or (316) 337-6192.**

Sincerely,

Cindy Metcalf
UIC Department

Cc: Jayme Wollison
David E. Bengtson ✓
Jerry Knobel
file



INVOICE

PO Box 93999
Southlake, TX 76092

Invoice Number: 145621
Invoice Date: Sep 9, 2014
Page: 1

Voice: (817) 546-7282
Fax: (817) 246-3361

Bill To:
Circle Star Operating Corp 7065 Confederate Pk Rd Suite 102 Fort Worth, TX 76108

RECEIVED
9/19/14
RT

Customer ID	Field Ticket #	Payment Terms	
CircSt	55316	Net 30 Days	
Job Location	Camp Location	Service Date	Due Date
KS2-04	Russell	Sep 9, 2014	10/9/14

Quantity	Item	Description	Unit Price	Amount
1.00	WELL NAME	Lynd Family Trust #18-1		
220.00	CEMENT MATERIALS	Acon Blend	25.00	5,500.00
250.00	CEMENT SERVICE	Cubic Feet Charge	2.48	620.00
436.00	CEMENT SERVICE	Ton Mileage Charge	2.75	1,199.00
1.00	CEMENT SERVICE	Port Collar	2,249.84	2,249.84
35.00	CEMENT SERVICE	Light Vehicle Mileage	4.40	154.00
70.00	CEMENT SERVICE	Heavy Vehicle Mileage	7.70	539.00
1.00	CEMENT SUPERVISOR	Robert Yakubovich		
1.00	EQUIPMENT OPERATOR	Nathan Donner		
1.00	EQUIPMENT OPERATOR	Kevin Rupp		

ALL PRICES ARE NET, PAYABLE
30 DAYS FOLLOWING DATE OF
INVOICE. 1 1/2% CHARGED
THEREAFTER. IF ACCOUNT IS
CURRENT, TAKE DISCOUNT OF

\$ 2,565.46

ONLY IF PAID ON OR BEFORE

Oct 9, 2014

Subtotal	10,261.84
Sales Tax	420.75
Total Invoice Amount	10,682.59
Payment/Credit Applied	
TOTAL	10,682.59

ALLIED OIL & GAS SERVICES, LLC 055316

Federal Tax I.D.# 20-5975804

REMIT TO P.O. BOX 31
RUSSELL, KANSAS 67665

SERVICE POINT:
Russell KS

DATE <u>9-9-14</u>	SEC. <u>18</u>	TWP. <u>11</u>	RANGE <u>21</u>	CALLED OUT	ON LOCATION	JOB START <u>5:30 PM</u>	JOB FINISH <u>6:00 PM</u>
LEASE <u>Trust</u>		WELL# <u>18-1</u>		LOCATION <u>Og 11-4 KS 7-2 SE to Rig</u>		COUNTY <u>Trego</u>	STATE <u>KS</u>
OLD OR <input checked="" type="radio"/> NEW (Circle one)							

CONTRACTOR

TYPE OF JOB Port Collar

HOLE SIZE 7 7/8 T.D. 480

CASING SIZE 5 1/2 15.5 DEPTH 4012

TUBING SIZE DEPTH

DRILL PIPE DEPTH

TOOL PC DEPTH 1810

PRES. MAX MINIMUM

MEAS. LINE SHOE JOINT

CEMENT LEFT IN CSG.

PERFS.

DISPLACEMENT 9

EQUIPMENT

PUMP TRUCK CEMENTER Robert Y

407 HELPER Nathan D

BULK TRUCK

423 DRIVER Kevin R

BULK TRUCK

DRIVER

REMARKS:

see log

cement did circulate to surface

Thank you

CHARGE TO: Circle Star

STREET _____

CITY _____ STATE _____ ZIP _____

To: Allied Oil & Gas Services, LLC.

You are hereby requested to rent cementing equipment and furnish cementer and helper(s) to assist owner or contractor to do work as is listed. The above work was done to satisfaction and supervision of owner agent or contractor. I have read and understand the "GENERAL TERMS AND CONDITIONS" listed on the reverse side.

PRINTED NAME John Foss

SIGNATURE [Signature]

OWNER

CEMENT used 220

AMOUNT ORDERED 250 ACON

COMMON @ _____

POZMIX @ _____

GEL @ _____

CHLORIDE @ _____

ASC @ _____

ACON 220 @ 25.00 5500.00

Material @ 5500.00

Loss @ 1375.00

HANDLING 250 sacks @ 2.48 620.00

MILEAGE 436 Hm @ 2.75 1199.00

TOTAL 7319.00

SERVICE

DEPTH OF JOB 1810

PUMP TRUCK CHARGE 2249.84

EXTRA FOOTAGE @ _____

MILEAGE 35 LV H I @ 4.40 154.00

MANIFOLD 70 HVM I @ 7.70 539.00

4161.84

Disc 1190.46 TOTAL 2971.38

PLUG & FLOAT EQUIPMENT

@ _____

@ _____

@ _____

@ _____

@ _____

TOTAL _____

SALES TAX (If Any) _____

TOTAL CHARGES 10261.84

DISCOUNT 2565.46 (25%) IF PAID IN 30 DAYS

net 7696.38