



Confidentiality Requested:

Yes No

KANSAS CORPORATION COMMISSION 1236690
OIL & GAS CONSERVATION DIVISION

Form ACO-1
August 2013

Form must be Typed
Form must be Signed
All blanks must be Filled

WELL COMPLETION FORM
WELL HISTORY - DESCRIPTION OF WELL & LEASE

OPERATOR: License # _____

Name: _____

Address 1: _____

Address 2: _____

City: _____ State: _____ Zip: _____ + _____

Contact Person: _____

Phone: (_____) _____

CONTRACTOR: License # _____

Name: _____

Wellsite Geologist: _____

Purchaser: _____

Designate Type of Completion:

- New Well Re-Entry Workover
- Oil WSW SWD SIOW
- Gas D&A ENHR SIGW
- OG GSW Temp. Abd.
- CM (Coal Bed Methane)
- Cathodic Other (Core, Expl., etc.): _____

If Workover/Re-entry: Old Well Info as follows:

Operator: _____

Well Name: _____

Original Comp. Date: _____ Original Total Depth: _____

- Deepening Re-perf. Conv. to ENHR Conv. to SWD
- Plug Back Conv. to GSW Conv. to Producer
- Commingled Permit #: _____
- Dual Completion Permit #: _____
- SWD Permit #: _____
- ENHR Permit #: _____
- GSW Permit #: _____

Spud Date or Recompletion Date	Date Reached TD	Completion Date or Recompletion Date
-----------------------------------	-----------------	---

API No. 15 - _____

Spot Description: _____

_____ - _____ - _____ Sec. _____ Twp. _____ S. R. _____ East West

_____ Feet from North / South Line of Section

_____ Feet from East / West Line of Section

Footages Calculated from Nearest Outside Section Corner:

- NE NW SE SW

GPS Location: Lat: _____, Long: _____
(e.g. xx.xxxxx) (e.g. -xxx.xxxxx)

Datum: NAD27 NAD83 WGS84

County: _____

Lease Name: _____ Well #: _____

Field Name: _____

Producing Formation: _____

Elevation: Ground: _____ Kelly Bushing: _____

Total Vertical Depth: _____ Plug Back Total Depth: _____

Amount of Surface Pipe Set and Cemented at: _____ Feet

Multiple Stage Cementing Collar Used? Yes No

If yes, show depth set: _____ Feet

If Alternate II completion, cement circulated from: _____

feet depth to: _____ w/ _____ sx cmt.

Drilling Fluid Management Plan

(Data must be collected from the Reserve Pit)

Chloride content: _____ ppm Fluid volume: _____ bbls

Dewatering method used: _____

Location of fluid disposal if hauled offsite:

Operator Name: _____

Lease Name: _____ License #: _____

Quarter _____ Sec. _____ Twp. _____ S. R. _____ East West

County: _____ Permit #: _____

AFFIDAVIT

I am the affiant and I hereby certify that all requirements of the statutes, rules and regulations promulgated to regulate the oil and gas industry have been fully complied with and the statements herein are complete and correct to the best of my knowledge.

Submitted Electronically

KCC Office Use ONLY

- Confidentiality Requested
Date: _____
- Confidential Release Date: _____
- Wireline Log Received
- Geologist Report Received
- UIC Distribution
- ALT I II III Approved by: _____ Date: _____

1236690

Operator Name: _____ Lease Name: _____ Well #: _____

Sec. _____ Twp. _____ S. R. _____ East West County: _____

INSTRUCTIONS: Show important tops of formations penetrated. Detail all cores. Report all final copies of drill stems tests giving interval tested, time tool open and closed, flowing and shut-in pressures, whether shut-in pressure reached static level, hydrostatic pressures, bottom hole temperature, fluid recovery, and flow rates if gas to surface test, along with final chart(s). Attach extra sheet if more space is needed.

Final Radioactivity Log, Final Logs run to obtain Geophysical Data and Final Electric Logs must be emailed to kcc-well-logs@kcc.ks.gov. Digital electronic log files must be submitted in LAS version 2.0 or newer AND an image file (TIFF or PDF).

Drill Stem Tests Taken <input type="checkbox"/> Yes <input type="checkbox"/> No <i>(Attach Additional Sheets)</i> Samples Sent to Geological Survey <input type="checkbox"/> Yes <input type="checkbox"/> No Cores Taken <input type="checkbox"/> Yes <input type="checkbox"/> No Electric Log Run <input type="checkbox"/> Yes <input type="checkbox"/> No List All E. Logs Run: _____	<input type="checkbox"/> Log Formation (Top), Depth and Datum <input type="checkbox"/> Sample Name Top Datum
--	---

CASING RECORD <input type="checkbox"/> New <input type="checkbox"/> Used							
Report all strings set-conductor, surface, intermediate, production, etc.							
Purpose of String	Size Hole Drilled	Size Casing Set (In O.D.)	Weight Lbs. / Ft.	Setting Depth	Type of Cement	# Sacks Used	Type and Percent Additives

ADDITIONAL CEMENTING / SQUEEZE RECORD				
Purpose:	Depth Top Bottom	Type of Cement	# Sacks Used	Type and Percent Additives
<input type="checkbox"/> Perforate <input type="checkbox"/> Protect Casing <input type="checkbox"/> Plug Back TD <input type="checkbox"/> Plug Off Zone				

Did you perform a hydraulic fracturing treatment on this well? Yes No *(If No, skip questions 2 and 3)*

Does the volume of the total base fluid of the hydraulic fracturing treatment exceed 350,000 gallons? Yes No *(If No, skip question 3)*

Was the hydraulic fracturing treatment information submitted to the chemical disclosure registry? Yes No *(If No, fill out Page Three of the ACO-1)*

Shots Per Foot	PERFORATION RECORD - Bridge Plugs Set/Type Specify Footage of Each Interval Perforated	Acid, Fracture, Shot, Cement Squeeze Record <i>(Amount and Kind of Material Used)</i>	Depth

TUBING RECORD: Size: _____ Set At: _____ Packer At: _____ Liner Run: Yes No

Date of First, Resumed Production, SWD or ENHR: _____ Producing Method:
 Flowing Pumping Gas Lift Other *(Explain)* _____

Estimated Production Per 24 Hours	Oil Bbls.	Gas Mcf	Water Bbls.	Gas-Oil Ratio	Gravity

DISPOSITION OF GAS: <input type="checkbox"/> Vented <input type="checkbox"/> Sold <input type="checkbox"/> Used on Lease <i>(If vented, Submit ACO-18.)</i>	METHOD OF COMPLETION: <input type="checkbox"/> Open Hole <input type="checkbox"/> Perf. <input type="checkbox"/> Dually Comp. <input type="checkbox"/> Commingled <i>(Submit ACO-5)</i> <input type="checkbox"/> Other <i>(Specify)</i> _____	PRODUCTION INTERVAL: _____ _____
--	---	---

Form	ACO1 - Well Completion
Operator	Bach, Jason dba Bach Oil Production
Well Name	Karon 1
Doc ID	1236690

Tops

Name	Top	Datum
Stone Corral	1672	+333
Base Stone Corral	1675	+330
Topeka	3013	-1008
Heebner	3213	-1208
Toronto	3243	-1238
Lansing	3261	-1256
Muncie	3372	-1367
Stark	3437	-1432



INVOICE

PO Box 93999
Southlake, TX 76092

Invoice Number: 145485
Invoice Date: Sep 5, 2014
Page: 1

Voice: (817) 546-7282
Fax: (817) 246-3361

Bill To:
Bach Oil Production 82 W. 500 Ln. Phillipsburg, KS 67661

Customer ID	Field Ticket #	Payment Terms	
Bach	55486	Net 30 Days	
Job Location	Camp Location	Service Date	Due Date
KS2-01	Russell	Sep 5, 2014	10/5/14

Quantity	Item	Description	Unit Price	Amount
1.00	WELL NAME	Karon #1		
175.00	CEMENT MATERIALS	Class A Common	17.90	3,132.50
330.00	CEMENT MATERIALS	Gel	0.24	79.20
495.00	CEMENT MATERIALS	Chloride	0.80	396.00
175.00	CEMENT SERVICE	Cubic Feet Charge	2.48	434.00
412.50	CEMENT SERVICE	Ton Mileage Charge	2.60	1,072.50
1.00	CEMENT SERVICE	Surface	1,512.25	1,512.25
50.00	CEMENT SERVICE	Pump Truck Mileage	7.70	385.00
50.00	CEMENT SERVICE	Light Vehicle Mileage	4.40	220.00
1.00	CEMENT SUPERVISOR	Tony Pfannenstiel		
1.00	OPERATOR ASSISTANT	Danny Sinner		
1.00	OPERATOR ASSISTANT	Tracy Jordan		

Subtotal	7,231.45
Sales Tax	239.91
Total Invoice Amount	7,471.36
Payment/Credit Applied	
TOTAL	7,471.36

ALL PRICES ARE NET, PAYABLE
30 DAYS FOLLOWING DATE OF
INVOICE. 1 1/2% CHARGED
THEREAFTER. IF ACCOUNT IS
CURRENT, TAKE DISCOUNT OF

\$ 1,735.55

ONLY IF PAID ON OR BEFORE
Oct 5, 2014

ALLIED OIL & GAS SERVICES, LLC 055486

Federal Tax I.D.# 20-5975804

REMIT TO P.O. BOX 31
RUSSELL, KANSAS 67665

SERVICE POINT

Russell

DATE <i>9.5.14</i>	SEC. <i>1</i>	TWP. <i>1</i>	RANGE <i>19</i>	CALLED OUT	ON LOCATION	JOB START <i>8:00</i>	JOB FINISH <i>9:00</i>
LEASE <i>Karon</i>	WELL# <i>1</i>	LOCATION <i>Phillipsburg Ks</i>	COUNTY <i>Phillip</i>	STATE <i>Kr</i>			
OLD OR NEW (Circle one) <i>N</i>				<i>to 183 + 383 OCT 26 W into</i>			

CONTRACTOR <i>Wartin #24</i>	OWNER
TYPE OF JOB <i>SWIAGE</i>	
HOLE SIZE <i>12 1/8</i>	T.D.
CASING SIZE <i>8 5/8</i>	DEPTH <i>220.0'</i>
TUBING SIZE	DEPTH
DRILL PIPE	DEPTH
TOOL	DEPTH
PREV. MAX	MINIMUM
MEAS. LINE	SHOE JOINT <i>15</i>
CEMENT LEFT IN CSG. <i>15</i>	
PERFS.	
DISPLACEMENT <i>13.05 ^{lb} #20</i>	

CEMENT AMOUNT ORDERED <i>175 sk con</i>	
<i>27 gal + 31 cc</i>	
COMMON <i>175sk</i>	@ <i>17.9</i> \$ <i>3132.50</i>
POZMIX	@
GEL <i>330lb</i>	@ <i>.24</i> \$ <i>79.20</i>
CHLORIDE <i>495lb</i>	@ <i>.80</i> \$ <i>396.00</i>
ASC	@
<i>Material</i>	@ <i>3609.70</i>
<i>Alum</i>	@ <i>865.85</i>
HANDLING <i>175sk lbs</i>	@ <i>2.48</i> \$ <i>434.00</i>
MILEAGE <i>413</i>	<i>77m</i> @ <i>2.60</i> \$ <i>1072.00</i>
<i>412.5</i>	TOTAL \$ <i>5114.20</i>

EQUIPMENT

PUMP TRUCK # <i>417</i>	CEMENTER <i>Alum Pleasent</i>
	HELPER <i>Dahony Binner</i>
BULK TRUCK # <i>420</i>	DRIVER <i>Tracy J.</i>
BULK TRUCK #	DRIVER

REMARKS:

See Cementing Job log
Cement to Swiaged

SERVICE

DEPTH OF JOB	<i>220.0'</i>
PUMP TRUCK CHARGE	<i>\$1512.25</i>
EXTRA FOOTAGE	@
MILEAGE <i>Alum 50</i>	@ <i>7.70</i> \$ <i>385.00</i>
MANIFOLD <i>high 50</i>	@ <i>4.40</i> \$ <i>220.00</i>
<i>Alum 869.70</i>	TOTAL \$ <i>2117.25</i>

CHARGE TO: *BACH OIL*

STREET _____

CITY _____ STATE _____ ZIP *67665*

PLUG & FLOAT EQUIPMENT

@	
@	
@	
@	
@	
TOTAL	<i>0</i>

To: Allied Oil & Gas Services, LLC.
You are hereby requested to rent cementing equipment and furnish cementer and helper(s) to assist owner or contractor to do work as is listed. The above work was done to satisfaction and supervision of owner agent or contractor. I have read and understand the "GENERAL TERMS AND CONDITIONS" listed on the reverse side.

PRINTED NAME *Anthony Martin*

SIGNATURE *Anthony Martin*

SALES TAX (if Any) _____

TOTAL CHARGES \$ *7,231.45*

DISCOUNT \$ *1,735.55 (24%)* IF PAID IN 30 DAYS

Net. *5495.90*



PO Box 93999
Southlake, TX 76092

Voice: (817) 546-7282
Fax: (817) 246-3361

INVOICE

Invoice Number: 145631
Invoice Date: Sep 10, 2014
Page: 1

Bill To:
Bach Oil Production 82 W. 500 Ln. Phillipsburg, KS 67661

Customer ID	Field Ticket #	Payment Terms	
Bach	55488	Net 30 Days	
Job Location	Camp Location	Service Date	Due Date
KS2-03	Russell	Sep 10, 2014	10/10/14

Quantity	Item	Description	Unit Price	Amount
1.00	WELL NAME	Karon #1		
255.00	CEMENT MATERIALS	60/40 Blend	15.30	3,901.50
55.00	CEMENT MATERIALS	Flo Seal	2.97	163.35
255.00	CEMENT SERVICE	Cubic Feet Charge	2.48	632.40
550.00	CEMENT SERVICE	Ton Mileage Charge	2.75	1,512.50
1.00	CEMENT SERVICE	Plug to Abandon	2,558.75	2,558.75
50.00	CEMENT SERVICE	Pump Truck Mileage	7.70	385.00
50.00	CEMENT SERVICE	Light Vehicle Mileage	4.40	220.00
1.00	EQUIPMENT SALES	8-5/8 Wooden Plug	110.00	110.00
1.00	CEMENT SUPERVISOR	Tony Pfannenstiel		
1.00	OPERATOR ASSISTANT	Danny Sinner		
1.00	OPERATOR ASSISTANT	Tyler Wellbrock		

ALL PRICES ARE NET, PAYABLE
30 DAYS FOLLOWING DATE OF
INVOICE. 1 1/2% CHARGED
THEREAFTER. IF ACCOUNT IS
CURRENT, TAKE DISCOUNT OF

\$ 2,370.87

ONLY IF PAID ON OR BEFORE

Oct 10, 2014

Subtotal	9,483.50
Sales Tax	630.65
Total Invoice Amount	10,114.15
Payment/Credit Applied	
TOTAL	10,114.15

ALLIED OIL & GAS SERVICES, LLC 05b+88

Federal Tax I.D.# 20-5975804

REMIT TO P.O. BOX 31
RUSSELL, KANSAS 67665

SERVICE POINT: Russell

DATE <u>9.10.14</u>	SEC. <u>1</u>	TWP <u>1</u>	RANGE <u>99</u>	CALLED OUT	ON LOCATION	JOB START <u>3:00</u>	JOB FINISH <u>4:00</u>
LEASE <u>Karon</u>	WELL # <u>1</u>	LOCATION <u>Phillipsburg Ks</u>			COUNTY <u>Phillips</u>	STATE <u>Ks</u>	
OLD OR <input checked="" type="radio"/> NEW (Circle one)			n to 183 & 383 Jct w 2 1/2 m n			Info.	

CONTRACTOR <u>Martin #24</u>	OWNER
TYPE OF JOB <u>PTA</u>	
HOLE SIZE <u>7 7/8</u>	T.D.
CASING SIZE	DEPTH
TUBING SIZE	DEPTH
DRILL PIPE <u>4 1/2</u>	DEPTH <u>1670</u>
TOOL	DEPTH
PRES. MAX	MINIMUM
MEAS. LINE	SHOE JOINT
CEMENT LEFT IN CSG.	
PERFS.	
DISPLACEMENT	

EQUIPMENT			
PUMP TRUCK # <u>417</u>	CEMENTER <u>Amy Plank</u>	CEMENT AMOUNT ORDERED <u>255sl</u>	
	HELPER <u>Danny S</u>		
BULK TRUCK # <u>985</u>	DRIVER <u>Tyler</u>		
BULK TRUCK # _____	DRIVER _____		
REMARKS:			
<u>21=1670' 2 50sl</u>			
<u>22=1125' 100sl</u>			
<u>23=270' 2 50sl</u>			
<u>24=40' 2 10sl + 1x 8 5/8 wooden plug</u>			
<u>25=PTA 30sl</u>			
<u>26=170' 2 15sl</u>			
<u>See Cementing Job Log</u>			
		HANDLING <u>255sl Ft.</u>	<u>2.48 \$ 632.40</u>
		MILEAGE <u>550</u>	<u>97m @ 2.75 \$ 1,512.50</u>
			TOTAL <u>\$ 2,144.90</u>

SERVICE			
DEPTH OF JOB		<u>1670'</u>	
PUMP TRUCK CHARGE		<u>\$ 2,558.75</u>	
EXTRA FOOTAGE	@		
MILEAGE <u>Neqvy. 50</u>	@	<u>7.7</u>	<u>\$ 385.00</u>
MANIFOLD <u>high 50</u>	@	<u>4.4</u>	<u>\$ 220.00</u>
	@		
	@		
	@		
CHARGE TO: <u>BACK OIL</u>			
STREET			
CITY	STATE	ZIP	
		<u>Frank</u>	
		<u>1327.16</u>	TOTAL <u>\$ 3,113.75</u>

PLUG & FLOAT EQUIPMENT			
<u>1x 8 5/8 wooden plug</u>	@		<u>\$ 110.00</u>
	@		
	@		
	@		
	@		
<u>Allow 27.50</u>			TOTAL <u>\$ 110.00</u>

SALES TAX (If Any) _____

TOTAL CHARGES \$ 9,483.50

DISCOUNT \$ 2,370.87 (25%) PAID IN 30 DAYS

PRINTED NAME Anthony Martin

SIGNATURE Anthony Martin Net 7/12.63

To: Allied Oil & Gas Services, LLC.
You are hereby requested to rent cementing equipment and furnish cementer and helper(s) to assist owner or contractor to do work as is listed. The above work was done to satisfaction and supervision of owner agent or contractor. I have read and understand the "GENERAL TERMS AND CONDITIONS" listed on the reverse side.

GEOLOGIST'S REPORT

DRILLING TIME AND SAMPLE LOG

**BACH OIL PRODUCTION
WELL: KARON #1**

**LOC.: T1S R19W, Sec. 1
SE SW SE NW
2870 North, 1945 East,
from SW corner
PHILLIPS COUNTY, KANSAS
API: 15-147-20744-00-00**

**DRILLING CONTR.: MURFIN RIG #24
SPUD: 09-05-14 COMP: 09-09-14
MUD UP: 2800' TYPE MUD: CHEM.
DRILL TIME: 2900 to' RTD
RTD: 3441' LTD: 3428'
SAMPLES SAVED: 2900'-RTD
GEOLOGIST: ROBERT J. PETERSEN**

ELEVATION

KB: 2005
GL: 2000
LOG MEASURED
FROM: KB

SURFACE CASING

8 5/8" Set @ 220'
W/175 SX 3% CC 2%gel

PRODUCTION CASING

D&A

WELL LOG SURVEYS

RAG

ELECTRIC LOG TOPS

FORMATION	DEPTH	DATUM	POS.
Stone Corral	1672	+333	-8
Base Stone Corral	1675	+330	-7
Topeka	3013	-1008	-6
Heebner	3213	-1208	-4
Toronto	3243	-1238	-4
Lansing	3261	-1256	-5
Muncie	3372	-1367	-4
Stark	3437	-1432	-4

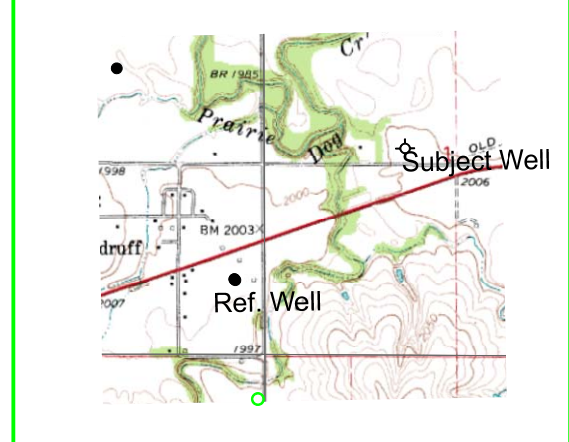

REFERENCE WELL:

Bach Oil Production
OFB #1
T1S R19W, Sec. 2
NW NE SE SE
1045 North, 400 West, from SE corner

REMARKS AND RECOMMENDATIONS

This well was plugged and abandoned by the operator.

Respectfully submitted,

Robert J. Petersen
Robert J. Petersen

DAILY REPORT

@7:00 A.M.

09-05-14 MIRU/SPUD

09-06-14 320'

09-07-14 2220'

09-08-14 3095'

09-09-14 3441'

