

CHEROKEE WARRIOR, INC./RANEY OIL COMPANY, LLC
 PADGETT LEASE
 SW. 1/4, SECTION 23, T34S, R2E
 SUMNER COUNTY, KANSAS

ROCK (E. 140TH ST. S.) ROAD

Notes:

1. Set (2) wood stakes at location site.
2. All flagging Red & Yellow.
3. Overhead power available at S. & W. lines, Sec.23 and at the NE. corner of Sec.23.
4. Kansas One Call System Inc. should be notified before excavation (1-800-344-7233).
5. CAUTION; Various pipelines in Sec.23.
6. Section 23 is irregular.
7. Location fell at the west edge of a terrace, no alternate set per landowner.
8. Contact landowner for best access and as to location of wood stakes in wheat.

ROAD (S. RIVER RD.)

ROCK

ROAD

ROCK

ROCK (E. 150TH ST. S.) ROAD

ROAD (S. OXFORD RD.)

ROCK

ROAD

ROCK

23

Drillsite Location
 Padgett #5

W. 1/2 NE SW

1980'FSL 1650'FWL

Ground Elevation = 1220

Y = 151985 X = 2385639

State Plane-NAD 27-Kansas South
 (Mapping Grade GPS Used)

Latitude 37.076487

Longitude -97.178530

WGS 84-NAD 83

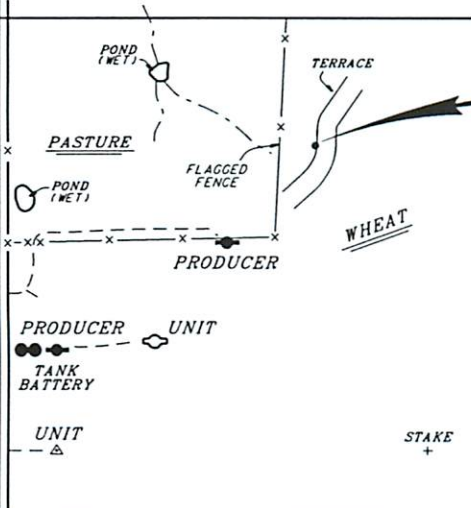

*Ingress and egress to location as shown on this plat is per usage only and may not be legally opened for public use. Contact landowner, tenant and county road department for access.

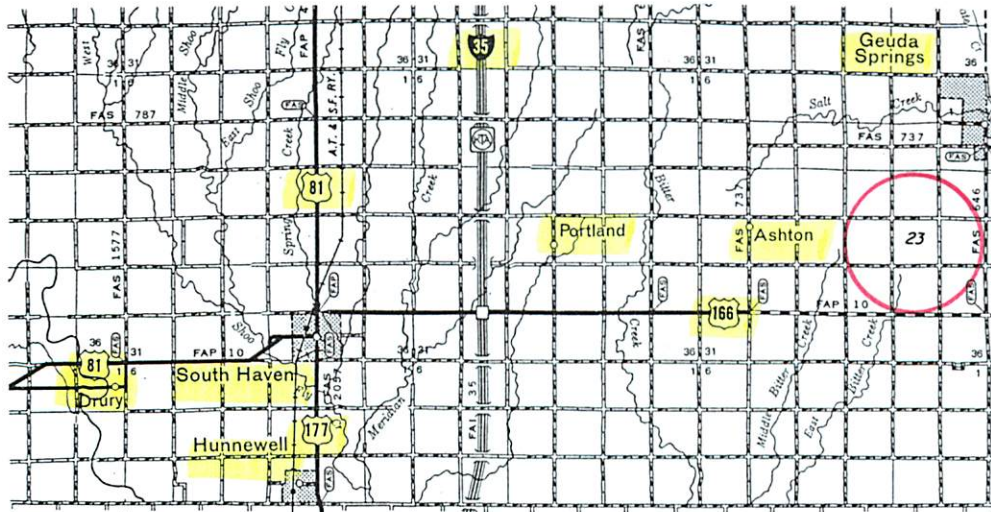

* Controlling data is based upon the best maps and photographs available to us and upon a regular section of land containing 640 acres.
 * Approximate section lines were determined using the normal standard of care of oilfield surveyors practicing in the state of Kansas. The section corners, which establish the precise section lines, were not necessarily located, and the exact location of the drillsite location in the section is not guaranteed. Therefore, the operator securing this service and accepting this plat and all other parties relying thereon agree to hold Central Kansas Oilfield Services, Inc., its officers and employees harmless from all losses, costs and expenses and said entities released from any liability from incidental or consequential damages.
 * Elevations derived from National Geodetic Vertical Datum.

Date December 10, 2014