

Project: Saline County (NAD-83)  
 Site: Sec 13-T15S-R03W  
 Well: Muir 1-13H  
 Plan: Plan 071114 A1 (Muir 1-13H/Wellbore #1)

WELL DETAILS: Muir 1-13H			
Ground Level:		1252.0	
Northing	Easting	Latitude	Longitude
153377.00	1426930.00	38° 45' 13.538 N	97° 35' 53.411 W

SECTION DETAILS									
MD	Inc	Azi	TVD	+N/-S	+E/-W	Dleg	TFace	V Sect	Annotation
0.0	0.00	0.00	0.0	0.0	0.0	0.00	0.00	0.0	
2516.1	0.00	0.00	2516.1	0.0	0.0	0.00	0.00	0.0	Start Build 8.00
3391.1	70.00	174.01	3189.1	-468.7	49.2	8.00	174.01	471.2	Start Turn 0.00
3541.1	70.00	174.01	3240.4	-608.9	63.9	0.00	0.00	612.2	Start Build 10.00
3743.3	90.22	174.01	3275.0	-805.9	84.6	10.00	0.00	810.4	Landing Point
7661.7	90.22	174.02	3260.0	-4703.0	493.0	0.00	100.55	4728.8	TD at 7661.7

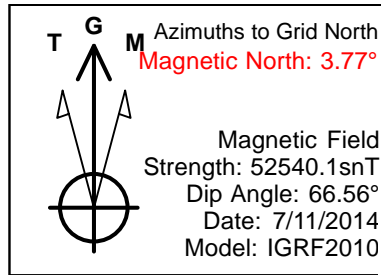
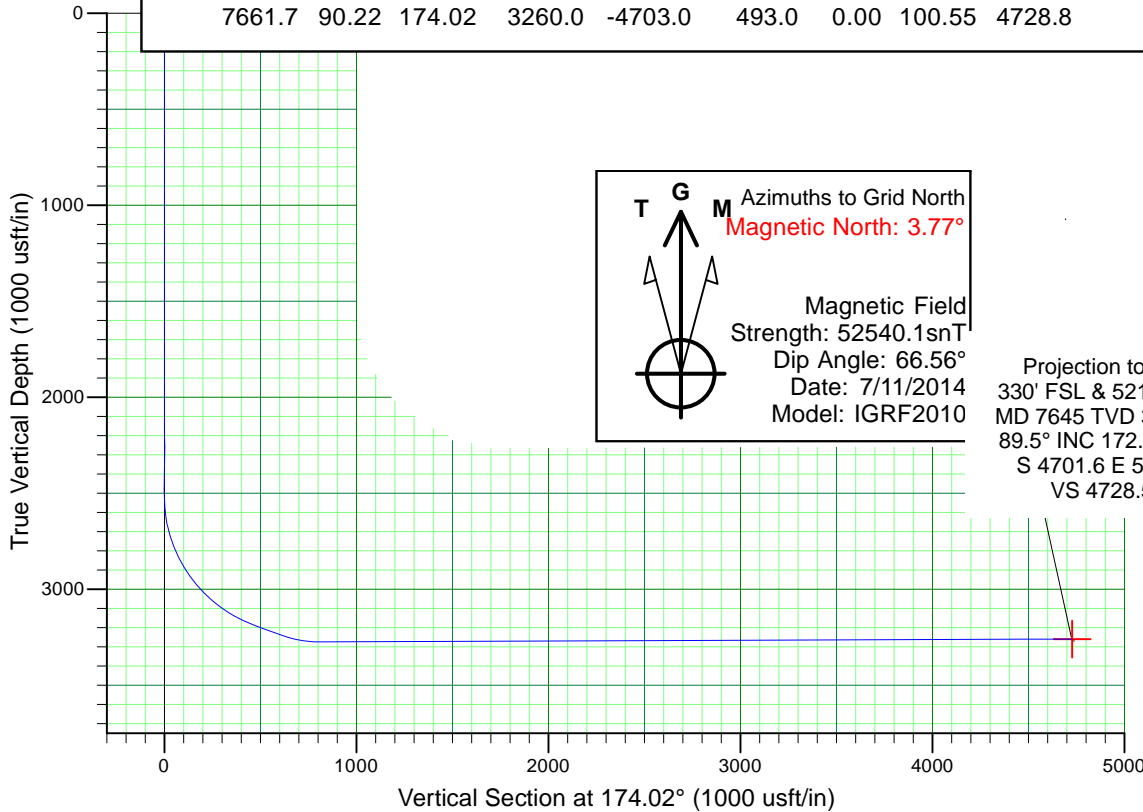

Projection to TD  
 330' FSL & 521' FEL  
 MD 7645 TVD 3252.7  
 89.5° INC 172.3° AZI  
 S 4701.6 E 503.8  
 VS 4728.5

