

DUSENBURY 3408 1-10H YETI SWD 3408 1-15
 HUNT 3408 2-15H * * HUNT 3408 3-15H
 * *



Miss Entry: 5189'
 -98.174474 37.091747

Top Perf: 5661'
 -98.174397 37.090474

Section 15
 34S 8W

Harper County

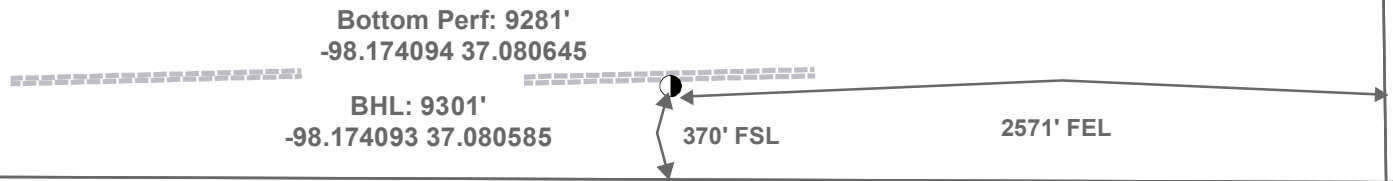

Section 22
 34S 8W



Actual Bottom-Hole Location of Hunt 3408 2-15H
 T&R: 34S 8W
 Section: 15, 2571' FEL & 370' FSL
 -98.174093 37.080585

1 in = 666 ft



● Actual BH Location

* SandRidge Wells

--- Perf

□ Sections

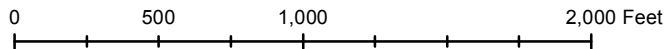

Draftsman:

Dory Deines

Draft Date: 4/10/2015

Drawing Name/Number:

Addendum_Hunt 3408 2-15H.mxd

Coordinate System:

NAD 1927 State Plane
 Kansas South FIPS: 1502