

**L.D. DRILLING, INC.
CASEY LEASE
SW.1/4, SECTION 7, T2S, R37W
CHEYENNE COUNTY, KANSAS**

Directions:

From the intersection of Highway 161 and Highway 36 (In Bird City, Ks.) go 10.0 miles North on Highway 161, then go 0.50 miles East on a county road, then go 0.23 miles South on a county road to flagged electric wire fence gate on the east side of road, then follow a trail approx. 0.35 miles Southeast to a flagged gate, then continue following a trail approx. 0.34 miles Southeast to a flagged gate on the west line of Section 7, then go 0.10 miles Northeast to location.

Notes:

1. Set iron rod at location site.
2. All flagging Red & Yellow.
3. No overhead power available at Sec.7.
4. Kansas One Call System Inc. should be notified before excavation (1-800-344-7233).
5. CAUTION; Various pipelines in Sec.7.
6. Evidence of cattle in area at date of staking.
7. Contact landowner for best access.
8. Location fell in a low draw area, no close visible alternate available.

*Ingress and egress to location as shown on this plat is per usage only and may not be legally opened for public use. Contact landowner, tenant and county road department for access.

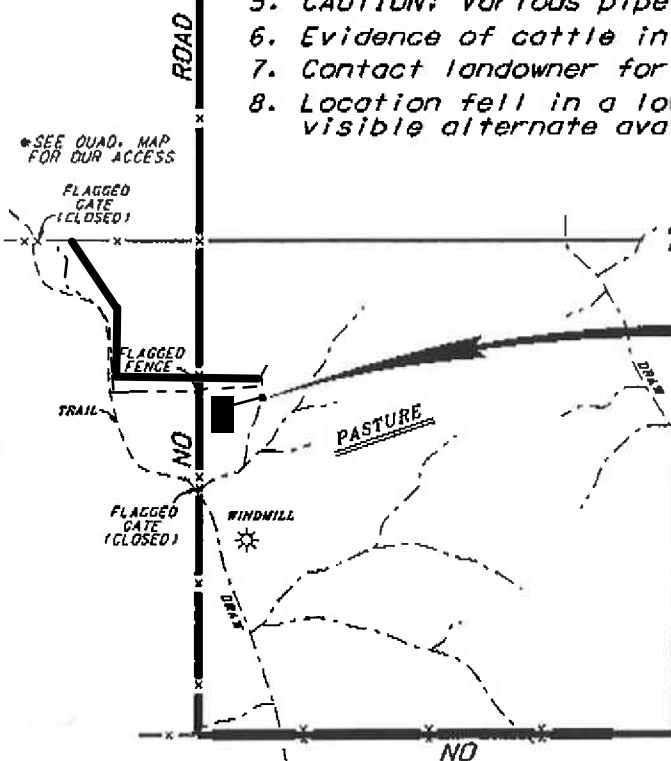

**Drillsite Location
Casey #1-7
1783'FSL 330'FWL
Ground Elevation = 3248
Y = 586980 X = 1012330
State Plane-NAD 27-Kansas North
(Mapping Grade GPS Used)
Latitude 39.892235
Longitude -101.521054
NAD 83-NAD 83**

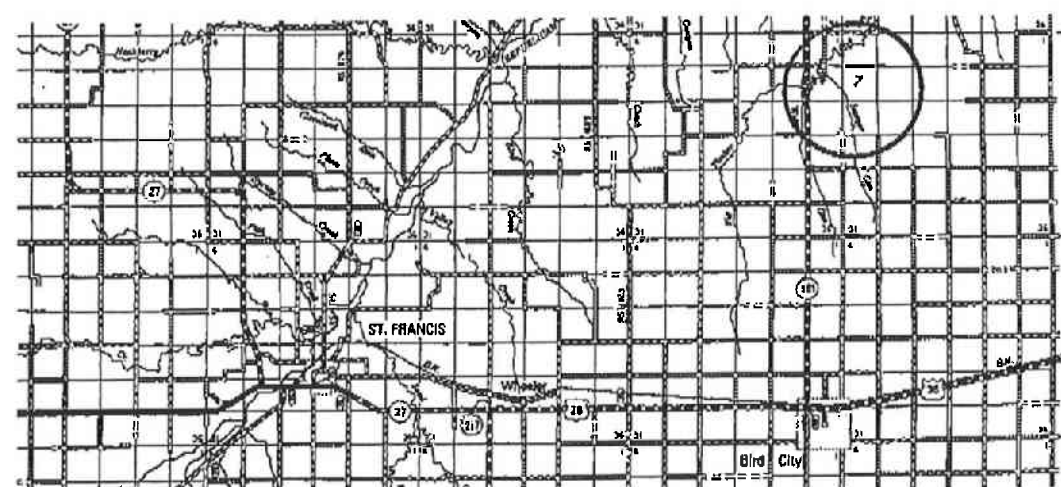
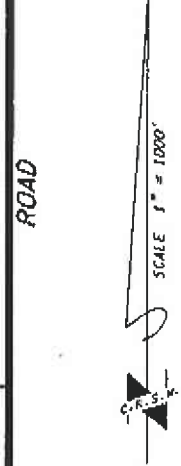

Controlling data is based upon the best maps and photographs available to us and upon a regular section of land containing 640 acres.
Approximate section lines were determined using the normal standard of care of oilfield surveyors practicing in the state of Kansas. The section corners which establish the precise section lines were not necessarily located, and the exact location of the drillsite location in the section is not guaranteed. Therefore, the operator securing this service and accepting this plat and all other parties relying thereon agree to hold Central Kansas Oilfield Services, Inc., its officers and employees harmless from all losses, costs and expenses and said entities released from any liability from incidental or consequential damages.
Elevations derived from National Geodetic Vertical Datum.

April 9, 2015