

OPERATOR: Samuel Gary Jr. & Associates, Inc. 1515 Wynkoop Street, Suite 700
Denver, Colorado 80202 office: 303-831-4673 ; fax: 303-863-7285

WELL NAME: BIXENMAN 1-33

LOCATION: 2050 FNL / 2030 FWL Sec. 33-10S-30W SHERIDAN COUNTY

SURFACE OWNERS:

William Bixenman
P.O. Box 306
Grinnell, KS 67738

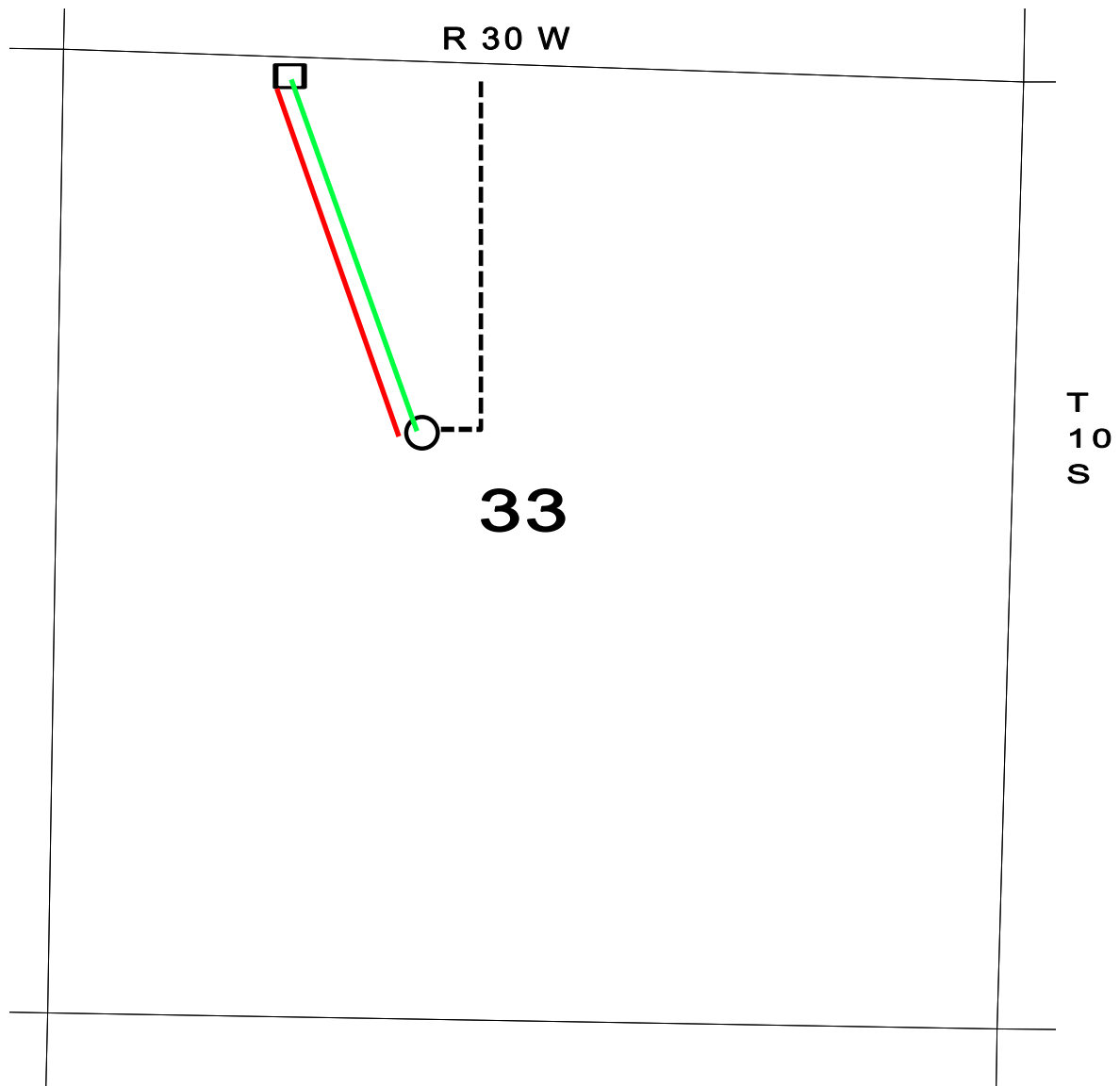

- PROPOSED WELL LOCATION
- ESTIMATED LOCATION OF TANK BATTERY

- ESTIMATED LEASE ROAD
- ESTIMATED LOCATION OF FLOWLINES
- ESTIMATED LOCATION OF ELECTRICAL LINES