

**Operator: Cholla Production, LLC
10390 Bradford Road, Suite 201
Littleton, CO 80127**

**Location to be staked in early June,
2015 by Fall and Associates**

**Cholla Production, LLC
Blaesi 3-3**

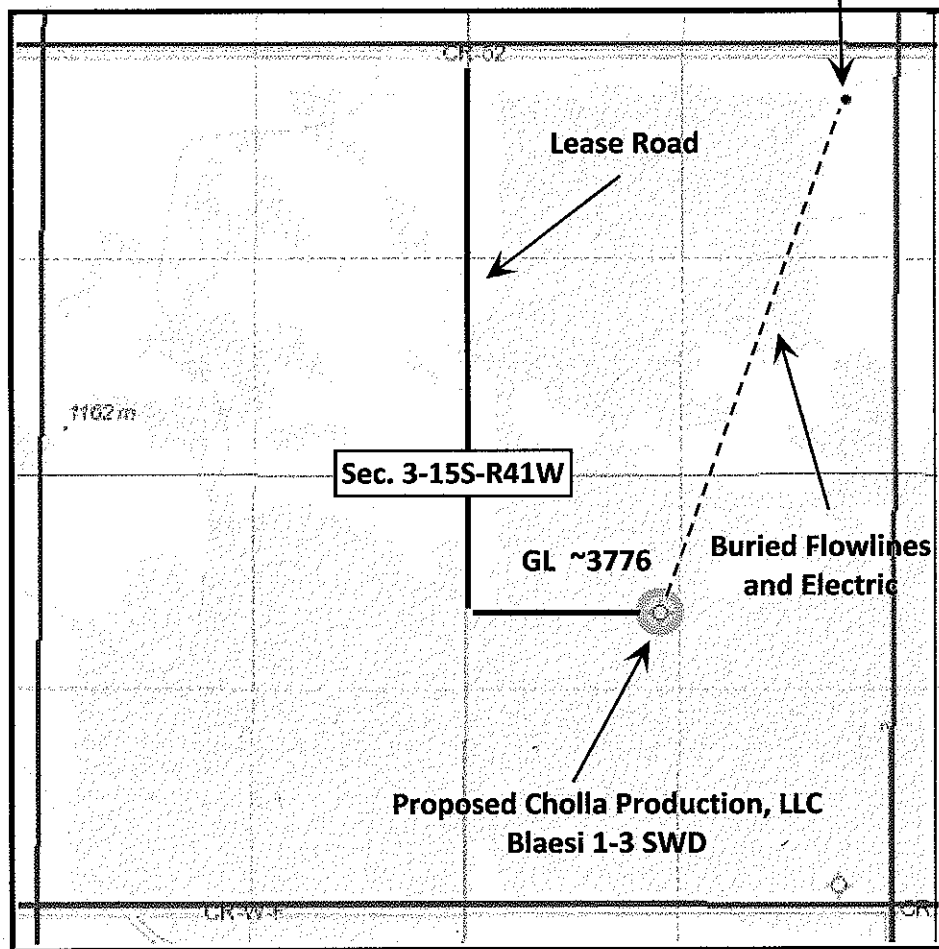

**Location of Proposed Re-entry of
Red Oak Energy, Inc. Blaesi 1-3,
for conversion to a SWD well.
Well is located 1825 FSL 1450 FEET
Section 3-15S-41W
Wallace Co., KS
New Well Name is
Cholla Production, LLC Blaesi 1-3 SWD**