

Proposed Plan of Construction

E.C. Moody 6-29
Sec 29 T25S-R33W
Finney County, KS

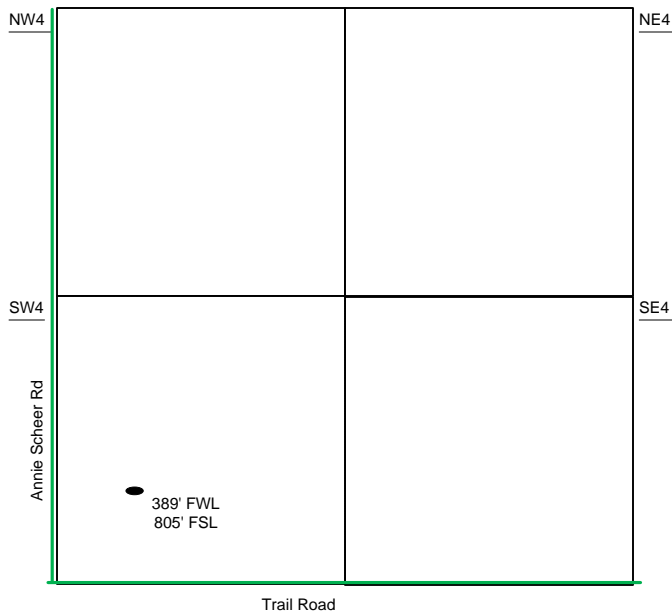

Sec 29 – T25S – R33W

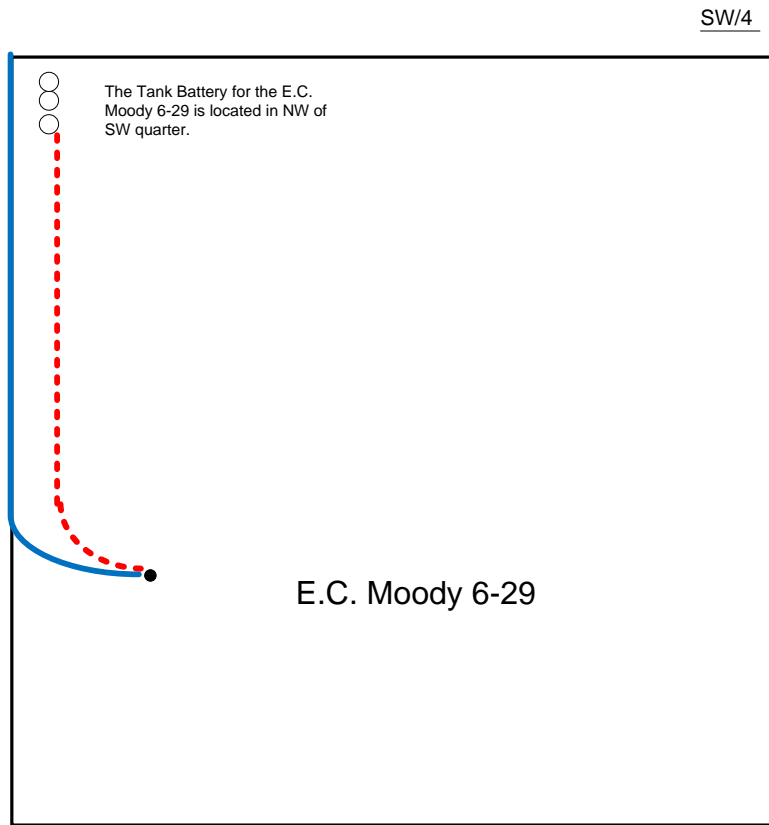

Proposed Details of
SW/4 Sec 29 – T25S – R33W

Note-Drawing **Not** to Scale

Proposed Site Diagram
E.C. Moody 6-29
May 28, 2015