

**OPERATOR:** Samuel Gary Jr. & Associates, Inc. 1515 Wynkoop Street, Suite 700  
Denver, Colorado 80202 office: 303-831-4673 ; fax: 303-863-7285

**WELL NAME:** LEWIS 1-18

**LOCATION:** 375 FNL / 640 FEL Sec. 18-5S-35W RAWLINS COUNTY

**SURFACE OWNERS:**

Margaret Lewis  
10851 Mastin St. #1000  
Overland Park, KS 66210

Jane Lewis  
954 SW Woodbrige Ct.  
Topeka, KS 66606

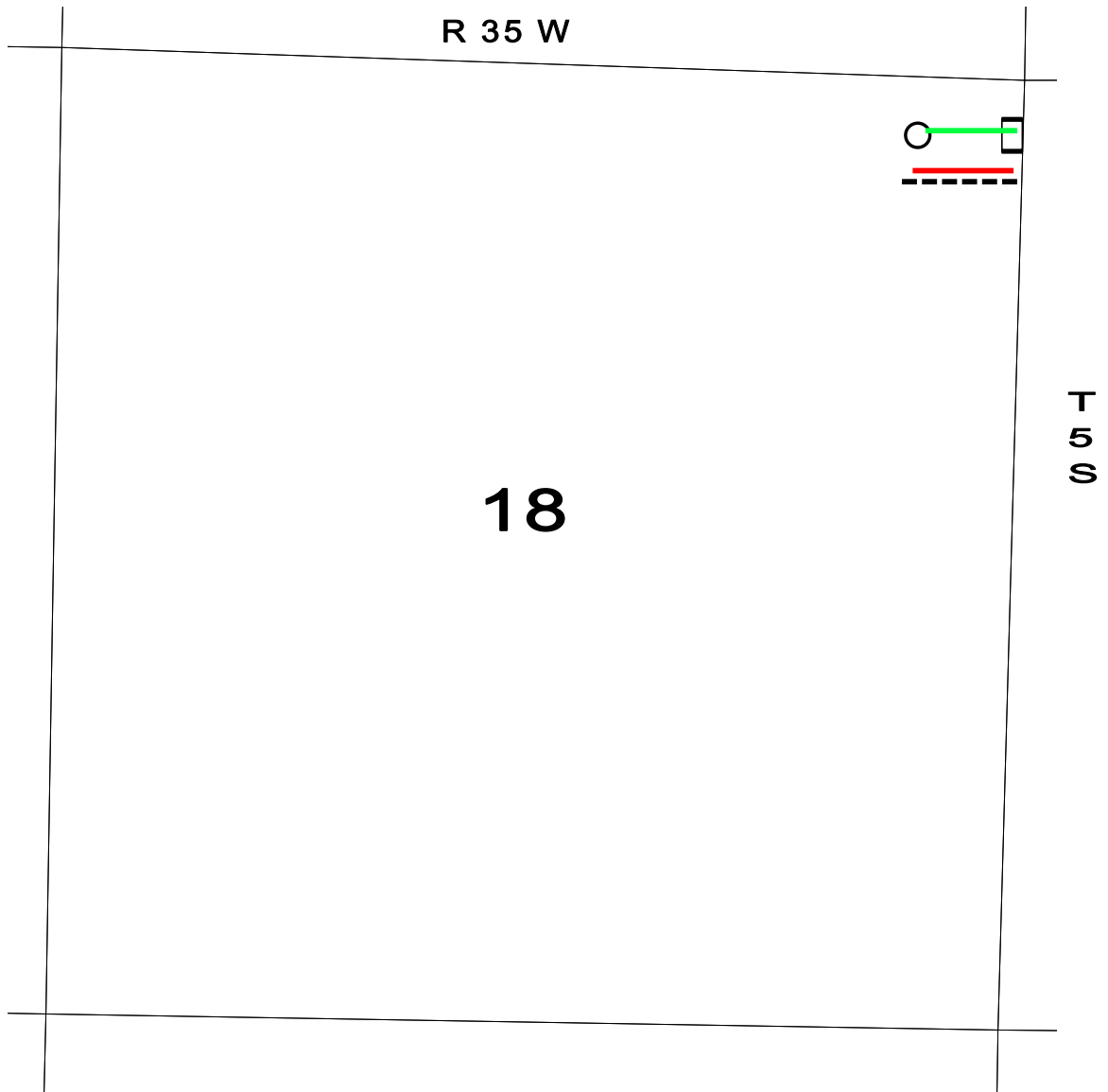

○ PROPOSED WELL LOCATION

□ ESTIMATED LOCATION OF TANK BATTERY

----- ESTIMATED LEASE ROAD

— ESTIMATED LOCATION OF FLOWLINES

— ESTIMATED LOCATION OF ELECTRICAL LINES