



For KCC Use:

Effective Date: \_\_\_\_\_

District # \_\_\_\_\_

SGA?  Yes  No

KANSAS CORPORATION COMMISSION  
OIL & GAS CONSERVATION DIVISION

1264230

Form C-1

March 2010

Form must be Typed  
Form must be Signed  
All blanks must be Filled

NOTICE OF INTENT TO DRILL

Must be approved by KCC five (5) days prior to commencing well

Form KSONA-1, Certification of Compliance with the Kansas Surface Owner Notification Act, MUST be submitted with this form.

Expected Spud Date: \_\_\_\_\_  
month day year

OPERATOR: License# \_\_\_\_\_

Name: \_\_\_\_\_

Address 1: \_\_\_\_\_

Address 2: \_\_\_\_\_

City: \_\_\_\_\_ State: \_\_\_\_\_ Zip: \_\_\_\_\_ + \_\_\_\_\_

Contact Person: \_\_\_\_\_

Phone: \_\_\_\_\_

CONTRACTOR: License# \_\_\_\_\_

Name: \_\_\_\_\_

Well Drilled For: Well Class: Type Equipment:

- |                              |                                   |                                    |                                     |
|------------------------------|-----------------------------------|------------------------------------|-------------------------------------|
| <input type="checkbox"/> Oil | <input type="checkbox"/> Enh Rec  | <input type="checkbox"/> Infield   | <input type="checkbox"/> Mud Rotary |
| <input type="checkbox"/> Gas | <input type="checkbox"/> Storage  | <input type="checkbox"/> Pool Ext. | <input type="checkbox"/> Air Rotary |
|                              | <input type="checkbox"/> Disposal | <input type="checkbox"/> Wildcat   | <input type="checkbox"/> Cable      |

Seismic ; \_\_\_\_\_ # of Holes  Other  
 Other: \_\_\_\_\_

If OWWO: old well information as follows:

Operator: \_\_\_\_\_

Well Name: \_\_\_\_\_

Original Completion Date: \_\_\_\_\_ Original Total Depth: \_\_\_\_\_

Directional, Deviated or Horizontal wellbore?  Yes  No

If Yes, true vertical depth: \_\_\_\_\_

Bottom Hole Location: \_\_\_\_\_

KCC DKT #: \_\_\_\_\_

Spot Description: \_\_\_\_\_

\_\_\_\_\_-\_\_\_\_\_-\_\_\_\_\_-\_\_\_\_\_-\_\_\_\_\_-\_\_\_\_\_-\_\_\_\_\_-\_\_\_\_\_-\_\_\_\_\_-\_\_\_\_\_-\_\_\_\_\_-\_\_\_\_\_-  
Sec. \_\_\_\_\_ Twp. \_\_\_\_\_ S. R. \_\_\_\_\_  E  W  
(Q/Q/Q/Q) \_\_\_\_\_ feet from  N /  S Line of Section  
\_\_\_\_\_ feet from  E /  W Line of Section

Is SECTION:  Regular  Irregular?

(Note: Locate well on the Section Plat on reverse side)

County: \_\_\_\_\_

Lease Name: \_\_\_\_\_ Well #: \_\_\_\_\_

Field Name: \_\_\_\_\_

Is this a Prorated / Spaced Field?  Yes  No

Target Formation(s): \_\_\_\_\_

Nearest Lease or unit boundary line (in footage): \_\_\_\_\_

Ground Surface Elevation: \_\_\_\_\_ feet MSL

Water well within one-quarter mile:  Yes  No

Public water supply well within one mile:  Yes  No

Depth to bottom of fresh water: \_\_\_\_\_

Depth to bottom of usable water: \_\_\_\_\_

Surface Pipe by Alternate:  I  II

Length of Surface Pipe Planned to be set: \_\_\_\_\_

Length of Conductor Pipe (if any): \_\_\_\_\_

Projected Total Depth: \_\_\_\_\_

Formation at Total Depth: \_\_\_\_\_

Water Source for Drilling Operations:  
 Well  Farm Pond  Other: \_\_\_\_\_

DWR Permit #: \_\_\_\_\_

(Note: Apply for Permit with DWR )

Will Cores be taken?  Yes  No

If Yes, proposed zone: \_\_\_\_\_

AFFIDAVIT

The undersigned hereby affirms that the drilling, completion and eventual plugging of this well will comply with K.S.A. 55 et. seq.

It is agreed that the following minimum requirements will be met:

1. Notify the appropriate district office **prior** to spudding of well;
2. A copy of the approved notice of intent to drill **shall be** posted on each drilling rig;
3. The minimum amount of surface pipe as specified below **shall be set** by circulating cement to the top; in all cases surface pipe **shall be set** through all unconsolidated materials plus a minimum of 20 feet into the underlying formation.
4. If the well is dry hole, an agreement between the operator and the district office on plug length and placement is necessary **prior to plugging**;
5. The appropriate district office will be notified before well is either plugged or production casing is cemented in;
6. If an ALTERNATE II COMPLETION, production pipe shall be cemented from below any usable water to surface within **120 DAYS** of spud date. Or pursuant to Appendix "B" - Eastern Kansas surface casing order #133,891-C, which applies to the KCC District 3 area, alternate II cementing must be completed within 30 days of the spud date or the well shall be plugged. **In all cases, NOTIFY district office** prior to any cementing.

Submitted Electronically

**For KCC Use ONLY**

API # 15 - \_\_\_\_\_

Conductor pipe required \_\_\_\_\_ feet

Minimum surface pipe required \_\_\_\_\_ feet per ALT.  I  II

Approved by: \_\_\_\_\_

**This authorization expires:** \_\_\_\_\_  
(This authorization void if drilling not started within 12 months of approval date.)

Spud date: \_\_\_\_\_ Agent: \_\_\_\_\_

Remember to:

- File Certification of Compliance with the Kansas Surface Owner Notification Act (KSONA-1) with Intent to Drill;
- File Drill Pit Application (form CDP-1) with Intent to Drill;
- File Completion Form ACO-1 within 120 days of spud date;
- File acreage attribution plat according to field proration orders;
- Notify appropriate district office 48 hours prior to workover or re-entry;
- Submit plugging report (CP-4) after plugging is completed (within 60 days);
- Obtain written approval before disposing or injecting salt water.
- If well will not be drilled or permit has expired (See: authorized expiration date) please check the box below and return to the address below.

**Well will not be drilled or Permit Expired** Date: \_\_\_\_\_  
Signature of Operator or Agent:

Mail to: KCC - Conservation Division,  
130 S. Market - Room 2078, Wichita, Kansas 67202

E  
 W



1264230

For KCC Use ONLY

API # 15 - \_\_\_\_\_

### IN ALL CASES PLOT THE INTENDED WELL ON THE PLAT BELOW

In all cases, please fully complete this side of the form. Include items 1 through 5 at the bottom of this page.

Operator: \_\_\_\_\_

Lease: \_\_\_\_\_

Well Number: \_\_\_\_\_

Field: \_\_\_\_\_

Number of Acres attributable to well: \_\_\_\_\_

QTR/QTR/QTR/QTR of acreage: \_\_\_\_\_ - \_\_\_\_\_ - \_\_\_\_\_ - \_\_\_\_\_

Location of Well: County: \_\_\_\_\_

\_\_\_\_\_ feet from  N /  S Line of Section

\_\_\_\_\_ feet from  E /  W Line of Section

Sec. \_\_\_\_\_ Twp. \_\_\_\_\_ S. R. \_\_\_\_\_  E  W

Is Section:  Regular or  Irregular

**If Section is Irregular, locate well from nearest corner boundary.**

Section corner used:  NE  NW  SE  SW

### PLAT

Show location of the well. Show footage to the nearest lease or unit boundary line. Show the predicted locations of lease roads, tank batteries, pipelines and electrical lines, as required by the Kansas Surface Owner Notice Act (House Bill 2032). You may attach a separate plat if desired.

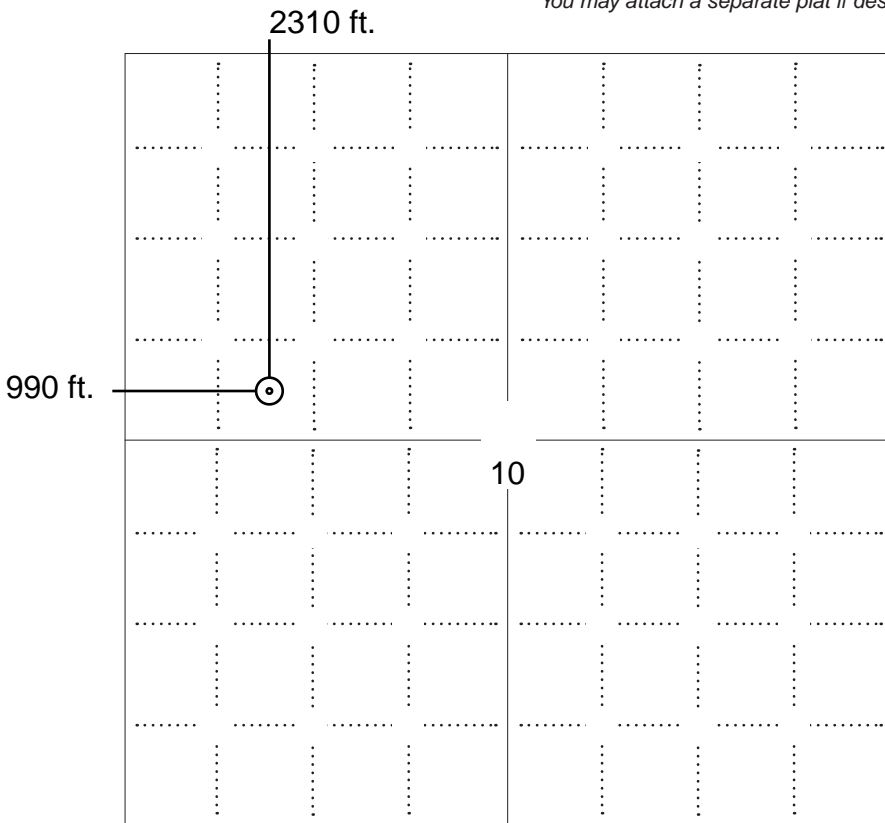

### LEGEND

- Well Location
- Tank Battery Location
- Pipeline Location
- Electric Line Location
- Lease Road Location



**NOTE: In all cases locate the spot of the proposed drilling locaton.**

#### In plotting the proposed location of the well, you must show:

1. The manner in which you are using the depicted plat by identifying section lines, i.e. 1 section, 1 section with 8 surrounding sections, 4 sections, etc.
2. The distance of the proposed drilling location from the south / north and east / west outside section lines.
3. The distance to the nearest lease or unit boundary line (in footage).
4. If proposed location is located within a prorated or spaced field a certificate of acreage attribution plat must be attached: (C0-7 for oil wells; CG-8 for gas wells).
5. The predicted locations of lease roads, tank batteries, pipelines, and electrical lines.



KANSAS CORPORATION COMMISSION 1264230  
OIL & GAS CONSERVATION DIVISION

Form CDP-1  
May 2010  
Form must be Typed

**APPLICATION FOR SURFACE PIT**

*Submit in Duplicate*

Operator Name: _____		License Number: _____	
Operator Address: _____			
Contact Person: _____		Phone Number: _____	
Lease Name & Well No.: _____		Pit Location (QQQQ): _____-_____-_____-_____	
Type of Pit: <input type="checkbox"/> Emergency Pit <input type="checkbox"/> Burn Pit <input type="checkbox"/> Settling Pit <input type="checkbox"/> Drilling Pit <input type="checkbox"/> Workover Pit <input type="checkbox"/> Haul-Off Pit <i>(If WP Supply API No. or Year Drilled)</i>		Pit is: <input type="checkbox"/> Proposed <input type="checkbox"/> Existing If Existing, date constructed: _____ Pit capacity: _____ (bbls)	
Is the pit located in a Sensitive Ground Water Area? <input type="checkbox"/> Yes <input type="checkbox"/> No		Chloride concentration: _____ mg/l <i>(For Emergency Pits and Settling Pits only)</i>	
Is the bottom below ground level? <input type="checkbox"/> Yes <input type="checkbox"/> No		Artificial Liner? <input type="checkbox"/> Yes <input type="checkbox"/> No	
How is the pit lined if a plastic liner is not used?			
Pit dimensions (all but working pits):    _____ Length (feet)    _____ Width (feet) <input type="checkbox"/> N/A: Steel Pits Depth from ground level to deepest point: _____ (feet) <input type="checkbox"/> No Pit			
If the pit is lined give a brief description of the liner material, thickness and installation procedure.		Describe procedures for periodic maintenance and determining liner integrity, including any special monitoring.	
Distance to nearest water well within one-mile of pit: _____ feet    Depth of water well _____ feet		Depth to shallowest fresh water _____ feet. Source of information: <input type="checkbox"/> measured <input type="checkbox"/> well owner <input type="checkbox"/> electric log <input type="checkbox"/> KDWR	
<b>Emergency, Settling and Burn Pits ONLY:</b> Producing Formation: _____ Number of producing wells on lease: _____ Barrels of fluid produced daily: _____ Does the slope from the tank battery allow all spilled fluids to flow into the pit? <input type="checkbox"/> Yes <input type="checkbox"/> No		<b>Drilling, Workover and Haul-Off Pits ONLY:</b> Type of material utilized in drilling/workover: _____ Number of working pits to be utilized: _____ Abandonment procedure: _____ Drill pits must be closed within 365 days of spud date.	
<p><b>Submitted Electronically</b></p>			

**KCC OFFICE USE ONLY**

Liner     Steel Pit     RFAC     RFAS

Date Received: \_\_\_\_\_ Permit Number: \_\_\_\_\_ Permit Date: \_\_\_\_\_ Lease Inspection:     Yes     No



### CERTIFICATION OF COMPLIANCE WITH THE KANSAS SURFACE OWNER NOTIFICATION ACT

*This form must be submitted with all Forms C-1 (Notice of Intent to Drill); CB-1 (Cathodic Protection Borehole Intent); T-1 (Request for Change of Operator Transfer of Injection or Surface Pit Permit); and CP-1 (Well Plugging Application). Any such form submitted without an accompanying Form KSONA-1 will be returned.*

Select the corresponding form being filed:  C-1 (Intent)  CB-1 (Cathodic Protection Borehole Intent)  T-1 (Transfer)  CP-1 (Plugging Application)

OPERATOR: License # \_\_\_\_\_  
Name: \_\_\_\_\_  
Address 1: \_\_\_\_\_  
Address 2: \_\_\_\_\_  
City: \_\_\_\_\_ State: \_\_\_\_\_ Zip: \_\_\_\_\_ + \_\_\_\_\_  
Contact Person: \_\_\_\_\_  
Phone: ( \_\_\_\_\_ ) \_\_\_\_\_ Fax: ( \_\_\_\_\_ ) \_\_\_\_\_  
Email Address: \_\_\_\_\_

Well Location:  
\_\_\_\_ - \_\_\_\_ - \_\_\_\_ - \_\_\_\_ Sec. \_\_\_\_ Twp. \_\_\_\_ S. R. \_\_\_\_  East  West  
County: \_\_\_\_\_  
Lease Name: \_\_\_\_\_ Well #: \_\_\_\_\_

*If filing a Form T-1 for multiple wells on a lease, enter the legal description of the lease below:*

**Surface Owner Information:**

Name: \_\_\_\_\_  
Address 1: \_\_\_\_\_  
Address 2: \_\_\_\_\_  
City: \_\_\_\_\_ State: \_\_\_\_\_ Zip: \_\_\_\_\_ + \_\_\_\_\_

*When filing a Form T-1 involving multiple surface owners, attach an additional sheet listing all of the information to the left for each surface owner. Surface owner information can be found in the records of the register of deeds for the county, and in the real estate property tax records of the county treasurer.*

*If this form is being submitted with a Form C-1 (Intent) or CB-1 (Cathodic Protection Borehole Intent), you must supply the surface owners and the KCC with a plat showing the predicted locations of lease roads, tank batteries, pipelines, and electrical lines. The locations shown on the plat are preliminary non-binding estimates. The locations may be entered on the Form C-1 plat, Form CB-1 plat, or a separate plat may be submitted.*

**Select one of the following:**

- I certify that, pursuant to the Kansas Surface Owner Notice Act (House Bill 2032), I have provided the following to the surface owner(s) of the land upon which the subject well is or will be located: 1) a copy of the Form C-1, Form CB-1, Form T-1, or Form CP-1 that I am filing in connection with this form; 2) if the form being filed is a Form C-1 or Form CB-1, the plat(s) required by this form; and 3) my operator name, address, phone number, fax, and email address.
- I have not provided this information to the surface owner(s). I acknowledge that, because I have not provided this information, the KCC will be required to send this information to the surface owner(s). To mitigate the additional cost of the KCC performing this task, I acknowledge that I must provide the name and address of the surface owner by filling out the top section of this form and that I am being charged a \$30.00 handling fee, payable to the KCC, which is enclosed with this form.

*If choosing the second option, submit payment of the \$30.00 handling fee with this form. If the fee is not received with this form, the KSONA-1 form and the associated Form C-1, Form CB-1, Form T-1, or Form CP-1 will be returned.*

I Submitted Electronically

I



Hagerman #13-10 OWWO

Sec 10- T20S-R19W

2310' FNL & 990' FWL

Pawnee County, KS

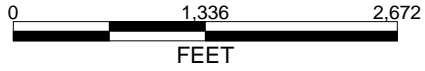

SYMBOL HIGHLIGHT

HAGERMAN RE-ENTRY

- WELL SYMBOLS
- Plugged Oil Well
- Oil Well
- Gas Well
- Dry Hole
- Abandoned Location - Permit
- Dry Hole, With Show of Oil
- Dry Hole, With Show of Oil & Gas
- Dry Hole, With Show of Gas
- Plugged Gas Well

September 15, 2015

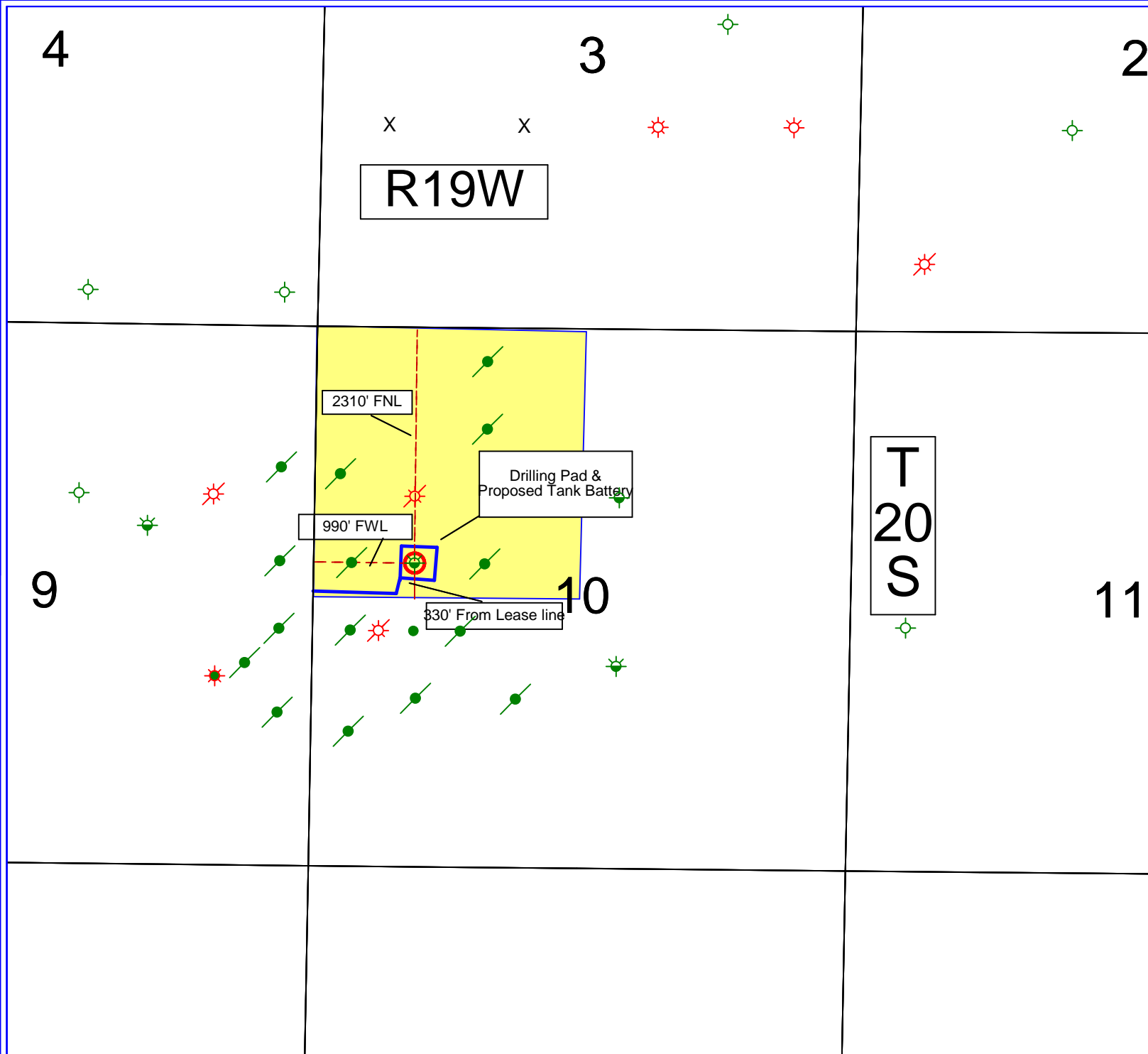



**Notice:** Fill out COMPLETELY and return to Conservation Division at the address below within 60 days from plugging date.

KANSAS CORPORATION COMMISSION 1124120  
OIL & GAS CONSERVATION DIVISION

Form CP-4  
March 2009

Type or Print on this Form  
Form must be Signed  
All blanks must be Filled

**WELL PLUGGING RECORD**  
K.A.R. 82-3-117

OPERATOR: License #: \_\_\_\_\_  
 Name: \_\_\_\_\_  
 Address 1: \_\_\_\_\_  
 Address 2: \_\_\_\_\_  
 City: \_\_\_\_\_ State: \_\_\_\_\_ Zip: \_\_\_\_\_ + \_\_\_\_\_  
 Contact Person: \_\_\_\_\_  
 Phone: ( \_\_\_\_\_ ) \_\_\_\_\_  
 Type of Well: (Check one)  Oil Well  Gas Well  OG  D&A  Cathodic  
 Water Supply Well  Other: \_\_\_\_\_  SWD Permit #: \_\_\_\_\_  
 ENHR Permit #: \_\_\_\_\_  Gas Storage Permit #: \_\_\_\_\_  
 Is ACO-1 filed?  Yes  No If not, is well log attached?  Yes  No  
 Producing Formation(s): List All (If needed attach another sheet)  
 \_\_\_\_\_ Depth to Top: \_\_\_\_\_ Bottom: \_\_\_\_\_ T.D. \_\_\_\_\_  
 \_\_\_\_\_ Depth to Top: \_\_\_\_\_ Bottom: \_\_\_\_\_ T.D. \_\_\_\_\_  
 \_\_\_\_\_ Depth to Top: \_\_\_\_\_ Bottom: \_\_\_\_\_ T.D. \_\_\_\_\_

API No. 15 - \_\_\_\_\_  
 Spot Description: \_\_\_\_\_  
 \_\_\_\_\_ - \_\_\_\_\_ - \_\_\_\_\_ Sec. \_\_\_\_\_ Twp. \_\_\_\_\_ S. R. \_\_\_\_\_  East  West  
 \_\_\_\_\_ Feet from  North /  South Line of Section  
 \_\_\_\_\_ Feet from  East /  West Line of Section  
 Footages Calculated from Nearest Outside Section Corner:  
 NE  NW  SE  SW  
 County: \_\_\_\_\_  
 Lease Name: \_\_\_\_\_ Well #: \_\_\_\_\_  
 Date Well Completed: \_\_\_\_\_  
 The plugging proposal was approved on: \_\_\_\_\_ (Date)  
 by: \_\_\_\_\_ (KCC District Agent's Name)  
 Plugging Commenced: \_\_\_\_\_  
 Plugging Completed: \_\_\_\_\_

Show depth and thickness of all water, oil and gas formations.

Oil, Gas or Water Records		Casing Record (Surface, Conductor & Production)			
Formation	Content	Casing	Size	Setting Depth	Pulled Out

Describe in detail the manner in which the well is plugged, indicating where the mud fluid was placed and the method or methods used in introducing it into the hole. If cement or other plugs were used, state the character of same depth placed from (bottom), to (top) for each plug set.

Plugging Contractor License #: \_\_\_\_\_ Name: \_\_\_\_\_  
 Address 1: \_\_\_\_\_ Address 2: \_\_\_\_\_  
 City: \_\_\_\_\_ State: \_\_\_\_\_ Zip: \_\_\_\_\_ + \_\_\_\_\_  
 Phone: ( \_\_\_\_\_ ) \_\_\_\_\_  
 Name of Party Responsible for Plugging Fees: \_\_\_\_\_  
 State of \_\_\_\_\_ County, \_\_\_\_\_, ss.  
 \_\_\_\_\_  Employee of Operator or  Operator on above-described well,  
 (Print Name)

being first duly sworn on oath, says: That I have knowledge of the facts statements, and matters herein contained, and the log of the above-described well is as filed, and the same are true and correct, so help me God.

Submitted Electronically

Mail to: KCC - Conservation Division, 130 S. Market - Room 2078, Wichita, Kansas 67202

TO:  
STATE CORPORATION COMMISSION  
CONSERVATION DIVISION - PLUGGING  
130 SOUTH MARKET, SUITE 2078  
WICHITA, KANSAS 67202

API Well Number: 15-145-21694-00-00  
Spot: SESWNW Sec/Twnshp/Rge: 10-20S-19W  
2310 feet from N Section Line, 990 feet from W Section Line  
Lease Name: HAGERMAN Well #: 13-10  
County: PAWNEE Total Vertical Depth: 4509 feet

Operator License No.: 33721  
Op Name: MID-CON ENERGY OPERATING, INC.  
Address: 2431 E 61ST ST STE 850  
TULSA, OK 74136

String	Size	Depth (ft)	Pulled (ft)	Comment
SURF	8.625	500		

Well Type: DH UIC Docket No: \_\_\_\_\_ Date/Time to Plug: 10/24/2012 4:00 PM  
Plug Co. License No.: 33784 Plug Co. Name: TRINIDAD DRILLING LIMITED PARTNERSHIP  
Proposal Rcvd. from: \_\_\_\_\_ Company: \_\_\_\_\_ Phone: \_\_\_\_\_

Proposed Plugging Method: 1ST PLUG AT 1400' WITH 50 SX CMT. 2ND PLUG AT 530' WITH 50 SX CMT. 3RD PLUG AT 60' WITH 20 SX CMT. 4TH PLUG TO CIRCULATE RAT HOLE WITH 30 SX CMT. 5TH PLUG TO CIRCULATE MOUSE HOLE WITH 20 SX CMT.

Plugging Proposal Received By: KEN JEHLIK WitnessType: NONE  
Date/Time Plugging Completed: 10/25/2012 2:00 AM KCC Agent: KEN JEHLIK

Actual Plugging Report:

Perfs:

1ST PLUG AT 1430' WITH 50 SX CMT. 2ND PLUG AT 532' WITH 50 SX CMT. 3RD PLUG AT 60' WITH 20 SX CMT. 4TH PLUG TO CIRCULATE RAT HOLE WITH 30 SX CMT. 5TH PLUG TO CIRCULATE MOUSE HOLE WITH 20 SX CMT.

Remarks: USED 60/40 POZMIX 4% GEL BY ALLIED.

Plugged through: DP

District: 01

Signed [Signature] (TECHNICIAN)

RECEIVED  
NOV 14 2012  
KCC WICHITA

ANY

# ALLIED OIL & GAS SERVICES, LLC 059042

Federal Tax I.D.# 20-5975804

REMIT TO P.O. BOX 93999  
SOUTHLAKE, TEXAS 76092

SERVICE POINT:  
Credit Bend, KS

DATE <u>10-24-12</u>	SEC. <u>10</u>	TWP. <u>205</u>	RANGE <u>19W</u>	CALLED OUT	ON LOCATION <u>2:40 PM</u>	JOB START <u>12:00 AM</u>	JOB FINISH <u>1:00 AM</u>
LEASE <u>Hogman</u>		WELL # <u>13-10</u>		LOCATION <u> Hwy 96W to Wash Center, turn South on 183,000 county line &amp; turn West on Yrd (not 700)</u>		COUNTY <u>Prumer</u>	STATE <u>KS</u>
OLD OR NEW (Circle one)				For 6 miles, turn North on rd 290 for 4 miles, East into location			

CONTRACTOR Trinidad 215  
 TYPE OF JOB PTA  
 HOLE SIZE 7-7/8" T.D. 4509 FT  
 CASING SIZE 8-5/8" 24" DEPTH 507 FT  
 TUBING SIZE DEPTH  
 DRILL PIPE 4 1/2" 16.6" DEPTH 1432 FT  
 TOOL DEPTH  
 PRES. MAX MINIMUM  
 MEAS. LINE SHOE JOINT  
 CEMENT LEFT IN CSG.  
 PERFS.  
 DISPLACEMENT

OWNER Mid Con  
 CEMENT  
 AMOUNT ORDERED 170 sy 60/40 + 4% Gel  
1.25% Flt Seal

EQUIPMENT

PUMP TRUCK CEMENTER Charles E King  
 # 724 HELPER Josh Isaac + Vori Klumbar  
 BULK TRUCK  
 # 544/198 DRIVER Den Casper  
 BULK TRUCK  
 # DRIVER

COMMON	<u>102</u>	@ <u>17.90</u>	<u>1.825</u>
POZMIX	<u>68</u>	@ <u>9.35</u>	<u>635.80</u>
GEL	<u>6</u>	@ <u>23.40</u>	<u>140.40</u>
CHLORIDE		@	
ASC		@	
<u>1/2 seal</u>	<u>27</u>	@ <u>2.97</u>	<u>80.19</u>
		@	
		@	
		@	
		@	
		@	
		@	
HANDLING	<u>181.8</u>	@ <u>2.48</u>	<u>450.86</u>
MILEAGE	<u>7.62 x 46</u>	<u>2.60</u>	<u>911.35</u>
TOTAL			<u>4044.90</u>

REMARKS:

Plug 1 @ 1432 ft: 6 FW, 12.5 (50 sy) cement, 2 FW  
Plug 2 @ 524 ft: 6 FW, 12.5 (50 sy) cement, 4 FW  
Plug 3 @ 20 ft: 5 FW (20 sy) cement, 1 FW  
Plug Rat Hole with 7.5 bbls (30 sy) cement  
Plug Mouse Hole with 5 bbls (20 sy) cement

SERVICE

DEPTH OF JOB 1432  
 PUMP TRUCK CHARGE 2249.84  
 EXTRA FOOTAGE @  
 MILEAGE Hum 46 @ 7.70 354.80  
 MANIFOLD @  
Hum 46 @ 4.40 202.80  
wait time 2 hrs @ 450.00 900.00

CHARGE TO: Mid Con  
 STREET \_\_\_\_\_  
 CITY \_\_\_\_\_ STATE \_\_\_\_\_ ZIP \_\_\_\_\_

TOTAL 3706.44

PLUG & FLOAT EQUIPMENT

_____	@ _____	_____
_____	@ _____	_____
_____	@ _____	_____
_____	@ _____	_____
_____	@ _____	_____

TOTAL \_\_\_\_\_

To: Allied Oil & Gas Services, LLC.  
 You are hereby requested to rent cementing equipment and furnish cementer and helper(s) to assist owner or contractor to do work as is listed. The above work was done to satisfaction and supervision of owner agent or contractor. I have read and understand the "GENERAL TERMS AND CONDITIONS" listed on the reverse side.

SALES TAX (If Any) \_\_\_\_\_  
 TOTAL CHARGES 7.750.84  
 DISCOUNT 25% 1.937.21 IF PAID IN 30 DAYS  
5.813.13

PRINTED NAME Charles Armer  
 SIGNATURE Charles Armer



Date 10-24-12 District Great Bend Ticket No. 054042  
 Company Mid Con Rig Trinidad 215  
 Lease Hagerman Well No. 13-10  
 County Powder State KS  
 Location South of R. Rush Center Field \_\_\_\_\_

CEMENT DATA:  
 Spacer Type: Fresh Water  
 Amt. 8 bbls Sk's Yield \_\_\_\_\_ ft<sup>3</sup>/sk Density 8.54 PPG

CASING DATA: Conductor  PTA  Squeeze  Misc   
 Surface  Intermediate  Production  Liner   
 Size 8 5/8" Type \_\_\_\_\_ Weight 24 Collar \_\_\_\_\_

LEAD: Pump Time \_\_\_\_\_ hrs. Type 60/40 + 4% cut  
7.75 1/2" Flo-seal Excess \_\_\_\_\_  
 Amt. 170 Sk's Yield 1,40 ft<sup>3</sup>/sk Density 14.5 PPG  
 TAIL: Pump Time \_\_\_\_\_ hrs. Type 60/40 +  
 Excess \_\_\_\_\_

Casing Depths: Top 0 Bottom 507

Amt. \_\_\_\_\_ Sk's Yield \_\_\_\_\_ ft<sup>3</sup>/sk Density \_\_\_\_\_ PPG  
 WATER: Lead 6.51 gals/sk Tail \_\_\_\_\_ gals/sk Total 26.5 Bbls.

Drill Pipe: Size 4 1/2" Weight 16.60 Collars \_\_\_\_\_  
 Open Hole: Size 7 7/8" T.D. 4509 ft. P.B. to \_\_\_\_\_ ft.

Pump Trucks Used 224  
 Bulk Equip. 544/198

CAPACITY FACTORS:  
 Casing: Bbls/Lin. ft. .0636 Lin. ft./Bbl. 15.70  
 Open Holes: Bbls/Lin. ft. .0602 Lin. ft./Bbl. 16.5993  
 Drill Pipe: Bbls/Lin. ft. .01422 Lin. ft./Bbl. 70.32  
 Annulus: OH Bbls/Lin. ft. .0406 Lin. ft./Bbl. 24.6474  
CS Bbls/Lin. ft. .0440 Lin. ft./Bbl. 22.72  
 Perforations: From \_\_\_\_\_ ft. to \_\_\_\_\_ ft. Amt. \_\_\_\_\_

Float Equip: Manufacturer \_\_\_\_\_  
 Shoe: Type \_\_\_\_\_ Depth \_\_\_\_\_  
 Float: Type \_\_\_\_\_ Depth \_\_\_\_\_  
 Centralizers: Quantity \_\_\_\_\_ Plugs Top \_\_\_\_\_ Btm. \_\_\_\_\_  
 Stage Collars \_\_\_\_\_  
 Special Equip. \_\_\_\_\_  
 Disp. Fluid Type WBM + FW Amt. \_\_\_\_\_ Bbls. Weight 92,83 PPG  
 Mud Type WBM Weight 4.2 PPG

COMPANY REPRESENTATIVE Charles Duma

CEMENTER Chad E. Smith

TIME	PRESSURES PSI		FLUID PUMPED DATA			REMARKS
	AM/PM	DRILL PIPE CASING	ANNULUS	TOTAL FLUID	Pumped Per Time Period	
2:40 PM						Arrive on Location
10:36 PM		50		6	6	Fresh Water Ahead
10:39 PM		50		18.5	12.5	Plug 1 Cement
10:43 PM		50		20.5	2	Fresh Water Behind
10:44 PM		50		34.5	14	Displace
10:51 PM						POOH
11:40 PM		50		40.5	6	Fresh Water Ahead
11:43 PM		50		53	12.5	Plug 2 Cement
11:48 PM		50		57	4	Displace
11:51 PM						POOH
12:19 AM		50		62	5	Plug 3 Cement
12:21 AM		50		63	1	Displace
12:51 AM		50		70.5	7.5	Plug Rat Hole
12:57 AM		50		75.5	5	Plug Mouse Hole
1:00 AM						wash up + Rig Down
1:30 AM						leave Location

# ALLIED OIL & GAS SERVICES, LLC 053579

Federal Tax I.D.# 20-5975804

REMIT TO P.O. BOX 31  
RUSSELL, KANSAS 67665

SERVICE POINT:  
Green Bay, KS

DATE <u>10-17-12</u>	SEC. <u>10</u>	TWP. <u>20S</u>	RANGE <u>19W</u>	CALLED OUT	ON LOCATION <u>4:45 AM</u>	JOB START <u>6:30 AM</u>	JOB FINISH <u>9:10 AM</u>
LEASE <u>Hogman</u>		WELL# <u>13-10</u>		LOCATION <u>Rush County, KS T36W</u>		COUNTY <u>Pruple</u>	STATE <u>KS</u>
OLD OR NEW (Circle one) <u>NEW</u>				<u>Van Elnor</u>			

CONTRACTOR <u>Triadic Drilling # 215</u>	OWNER
TYPE OF JOB <u>gun core</u>	
HOLE SIZE <u>12 1/4</u> T.D.	CEMENT
CASING SIZE <u>5 5/8</u> DEPTH <u>521.71</u>	AMOUNT ORDERED <u>325 sks Class A</u>
TUBING SIZE DEPTH	<u>39 cc 21 gel</u>
DRILL PIPE <u>4 1/2</u> DEPTH	
TOOL DEPTH	
PRES. MAX MINIMUM	COMMON <u>325 @ 17.90 5.817.50</u>
MEAS. LINE SHOE JOINT	POZMIX @
CEMENT LEFT IN CSG. <u>42.14</u>	GEL <u>6 @ 23.40 140.40</u>
PERFS.	CHLORIDE <u>11 @ 64.00 704.00</u>
DISPLACEMENT <u>30,546 bbl's Freshwater</u>	ASC @
EQUIPMENT	
PUMP TRUCK CEMENTER <u>Dustin Chambers</u>	
# <u>366</u> HELPER <u>Travis Hall</u>	
BULK TRUCK	
# <u>544-193</u> DRIVER <u>Kevin Weighers</u>	
BULK TRUCK	
# DRIVER	
	HANDLING <u>351.24 @ 2.48 871.07</u>
	MILEAGE <u>16.03 X 46 X 2.60 1,917.78</u>
	TOTAL <u>9,450.15</u>

**REMARKS:**

Break circulation with Big mud  
mix 325 sks Class A 39cc 21 gel  
Preferse Plug in Pruple 30.54 bbl's  
Land plug pressure 600 #  
Levent find circulation  
plug run 9:00 AM  
plug run  
calculate bbl's to pit 305 sks

**SERVICE**

DEPTH OF JOB <u>521.</u>	
PUMP TRUCK CHARGE <u>2058.20</u>	
EXTRA FOOTAGE @	
MILEAGE <u>HUM 46 @ 7.70 354.20</u>	
MANIFOLD @	
<u>LUM 46 @ 4.40 202.20</u>	

TOTAL 2,614.80

CHARGE TO: Mid-Con Energy  
STREET \_\_\_\_\_  
CITY \_\_\_\_\_ STATE \_\_\_\_\_ ZIP \_\_\_\_\_

**PLUG & FLOAT EQUIPMENT**

<u>8 5/8</u>	
<u>(w) 2 centralizers @ 74.88 149.76</u>	
<u>1 Rubber Plug 8 5/8 @ 131.04</u>	
<u>1 insert with ball @ 446.74 446.74</u>	

TOTAL 727.74

To: Allied Oil & Gas Services, LLC.  
You are hereby requested to rent cementing equipment and furnish cementer and helper(s) to assist owner or contractor to do work as is listed. The above work was done to satisfaction and supervision of owner agent or contractor. I have read and understand the "GENERAL TERMS AND CONDITIONS" listed on the reverse side.

SALES TAX (If Any) _____	
TOTAL CHARGES <u>12,792.69</u>	
<u>25% 3,198.17</u>	
DISCOUNT _____ IF PAID IN 30 DAYS	
<u>9,594.52</u>	

PRINTED NAME X Ryan Lojsetan

SIGNATURE X [Signature]

Thank You!!

Date 10-17-12 District Great Bend, KS Ticket No. 53571  
 Company Midcon Rig Tipichid #215  
 Lease Hagerman Well No. 17-12  
 County Lawrence State KS  
 Location Rush center, 756W Field \_\_\_\_\_  
 (2N E 27W)

CASING DATA: Conductor  PTA  Squeeze  Misc   
 Surface  Intermediate  Production  Liner   
 Size 8 5/8 Type new Weight 24# Collar SPd

Casing Depths: Top KB Bottom 521, 71

Drill Pipe: Size 4 1/2 Weight 166 Collars x hole  
 Open Hole: Size 12 1/4 T.D. \_\_\_\_\_ ft. P.B. to \_\_\_\_\_ ft.

CAPACITY FACTORS:  
 Casing: Bbbls/Lin. ft. 0.637 Lin. ft./Bbl. 15.70  
 Open Holes: Bbbls/Lin. ft. 0.454 Lin. ft./Bbl. 0.85  
 Drill Pipe: Bbbls/Lin. ft. 0.142 Lin. ft./Bbl. 70.32  
 Annulus: Bbbls/Lin. ft. 0.735 Lin. ft./Bbl. 13.60  
 Bbbls/Lin. ft. \_\_\_\_\_ Lin. ft./Bbl. \_\_\_\_\_  
 Perforations: From \_\_\_\_\_ ft. to \_\_\_\_\_ ft. Amt. \_\_\_\_\_

CEMENT DATA:  
 Spacer Type: Freshwater  
 Amt. 5 bbls Skys Yield \_\_\_\_\_ ft<sup>3</sup>/sk Density 9.34 PPG

LEAD: Pump Time \_\_\_\_\_ hrs. Type \_\_\_\_\_  
 Excess \_\_\_\_\_

Amt. \_\_\_\_\_ Skys Yield \_\_\_\_\_ ft<sup>3</sup>/sk Density \_\_\_\_\_ PPG

TAIL: Pump Time Thicken time hrs. Type Class A 34cc  
2.4 gal Excess \_\_\_\_\_

Amt. 325 Skys Yield 1.34 ft<sup>3</sup>/sk Density 15.2 PPG

WATER: Lead \_\_\_\_\_ gals/sk Tail \_\_\_\_\_ gals/sk Total \_\_\_\_\_ Bbbls.

Pump Trucks Used 366 - Irving H  
 Bulk Equip. 544-195 Kewanee

Float Equip: Manufacturer \_\_\_\_\_  
 Shoe: Type \_\_\_\_\_ Depth \_\_\_\_\_

Float: Type \_\_\_\_\_ Depth \_\_\_\_\_  
 Centralizers: Quantity 2 Plugs Top Rubber Btm. \_\_\_\_\_

Stage Collars \_\_\_\_\_  
 Special Equip. Ingrs r Ball

Disp. Fluid Type Freshwater Amt. \_\_\_\_\_ Bbbls. Weight 9.34 PPG  
 Mud Type Water Weight 9.1 PPG

COMPANY REPRESENTATIVE \_\_\_\_\_

CEMENTER Justin C

TIME	PRESSURES PSI		FLUID PUMPED DATA			REMARKS
	DRILL PIPE CASING	ANNULUS	TOTAL FLUID	Pumped Per Time Period	RATE Bbbls Min.	
						ON location - Rig up Had 400gals mixing
						Run 4 1/2 casing Break circulation with Pig mud Hook up cement pump
				5663		Pump 5663 freshwater ahead
			55.37	50.37		Mix 325 sks Class A 34cc 2.4 gal Shut Pump + Release plug
			65.91	30.54		Displace 30.54 bbls freshwater
						land plug pressure - 600 #
						Cement del circulation
						Plug down - 9:00 AM
						Pig down -
						landed plug went to floor toolpusher was there pipe went up about 5 ft Because they didn't clean it down plug pushed, it back down