



1265370

For KCC Use ONLY

API # 15 - _____

IN ALL CASES PLOT THE INTENDED WELL ON THE PLAT BELOW

In all cases, please fully complete this side of the form. Include items 1 through 5 at the bottom of this page.

Operator: _____

Lease: _____

Well Number: _____

Field: _____

Number of Acres attributable to well: _____

QTR/QTR/QTR/QTR of acreage: _____ - _____ - _____ - _____

Location of Well: County: _____

_____ feet from N / S Line of Section

_____ feet from E / W Line of Section

Sec. _____ Twp. _____ S. R. _____ E W

Is Section: Regular or Irregular

If Section is Irregular, locate well from nearest corner boundary.

Section corner used: NE NW SE SW

PLAT

Show location of the well. Show footage to the nearest lease or unit boundary line. Show the predicted locations of lease roads, tank batteries, pipelines and electrical lines, as required by the Kansas Surface Owner Notice Act (House Bill 2032). You may attach a separate plat if desired.

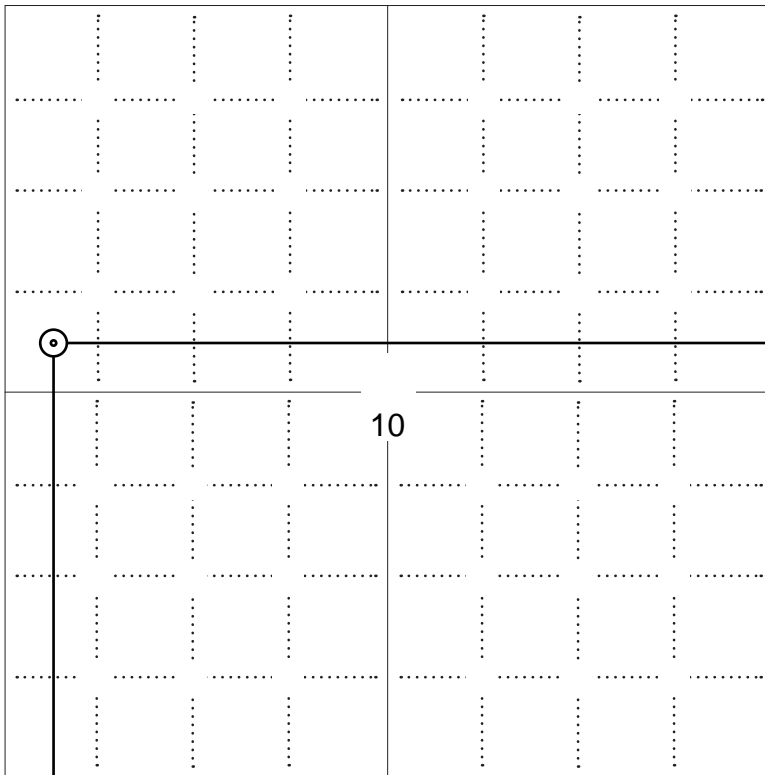

LEGEND

- Well Location
- Tank Battery Location
- Pipeline Location
- Electric Line Location
- Lease Road Location

4950 ft.

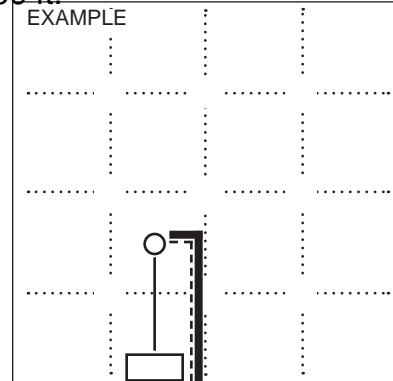

NOTE: In all cases locate the spot of the proposed drilling locaton.

2970 ft.

In plotting the proposed location of the well, you must show:

1. The manner in which you are using the depicted plat by identifying section lines, i.e. 1 section, 1 section with 8 surrounding sections, 4 sections, etc.
2. The distance of the proposed drilling location from the south / north and east / west outside section lines.
3. The distance to the nearest lease or unit boundary line (in footage).
4. If proposed location is located within a prorated or spaced field a certificate of acreage attribution plat must be attached: (C0-7 for oil wells; CG-8 for gas wells).
5. The predicted locations of lease roads, tank batteries, pipelines, and electrical lines.



KANSAS CORPORATION COMMISSION 1265370
OIL & GAS CONSERVATION DIVISION

Form CDP-1
May 2010
Form must be Typed

APPLICATION FOR SURFACE PIT

Submit in Duplicate

Operator Name: _____		License Number: _____	
Operator Address: _____			
Contact Person: _____		Phone Number: _____	
Lease Name & Well No.: _____		Pit Location (QQQQ): _____-_____-_____-_____	
Type of Pit: <input type="checkbox"/> Emergency Pit <input type="checkbox"/> Burn Pit <input type="checkbox"/> Settling Pit <input type="checkbox"/> Drilling Pit <input type="checkbox"/> Workover Pit <input type="checkbox"/> Haul-Off Pit <i>(If WP Supply API No. or Year Drilled)</i>		Pit is: <input type="checkbox"/> Proposed <input type="checkbox"/> Existing If Existing, date constructed: _____ Pit capacity: _____ (bbls)	
Is the pit located in a Sensitive Ground Water Area? <input type="checkbox"/> Yes <input type="checkbox"/> No		Chloride concentration: _____ mg/l <i>(For Emergency Pits and Settling Pits only)</i>	
Is the bottom below ground level? <input type="checkbox"/> Yes <input type="checkbox"/> No		Artificial Liner? <input type="checkbox"/> Yes <input type="checkbox"/> No	
How is the pit lined if a plastic liner is not used?			
Pit dimensions (all but working pits): _____ Length (feet) _____ Width (feet) <input type="checkbox"/> N/A: Steel Pits Depth from ground level to deepest point: _____ (feet) <input type="checkbox"/> No Pit			
If the pit is lined give a brief description of the liner material, thickness and installation procedure.		Describe procedures for periodic maintenance and determining liner integrity, including any special monitoring.	
Distance to nearest water well within one-mile of pit: _____ feet Depth of water well _____ feet		Depth to shallowest fresh water _____ feet. Source of information: <input type="checkbox"/> measured <input type="checkbox"/> well owner <input type="checkbox"/> electric log <input type="checkbox"/> KDWR	
Emergency, Settling and Burn Pits ONLY: Producing Formation: _____ Number of producing wells on lease: _____ Barrels of fluid produced daily: _____ Does the slope from the tank battery allow all spilled fluids to flow into the pit? <input type="checkbox"/> Yes <input type="checkbox"/> No		Drilling, Workover and Haul-Off Pits ONLY: Type of material utilized in drilling/workover: _____ Number of working pits to be utilized: _____ Abandonment procedure: _____ _____ Drill pits must be closed within 365 days of spud date.	
<p>Submitted Electronically</p>			

KCC OFFICE USE ONLY

Liner Steel Pit RFAC RFAS

Date Received: _____ Permit Number: _____ Permit Date: _____ Lease Inspection: Yes No



CERTIFICATION OF COMPLIANCE WITH THE KANSAS SURFACE OWNER NOTIFICATION ACT

This form must be submitted with all Forms C-1 (Notice of Intent to Drill); CB-1 (Cathodic Protection Borehole Intent); T-1 (Request for Change of Operator Transfer of Injection or Surface Pit Permit); and CP-1 (Well Plugging Application). Any such form submitted without an accompanying Form KSONA-1 will be returned.

Select the corresponding form being filed: C-1 (Intent) CB-1 (Cathodic Protection Borehole Intent) T-1 (Transfer) CP-1 (Plugging Application)

OPERATOR: License # _____
Name: _____
Address 1: _____
Address 2: _____
City: _____ State: _____ Zip: _____ + _____
Contact Person: _____
Phone: (_____) _____ Fax: (_____) _____
Email Address: _____

Well Location:
____ - ____ - ____ - ____ Sec. ____ Twp. ____ S. R. ____ East West
County: _____
Lease Name: _____ Well #: _____

If filing a Form T-1 for multiple wells on a lease, enter the legal description of the lease below:

Surface Owner Information:

Name: _____
Address 1: _____
Address 2: _____
City: _____ State: _____ Zip: _____ + _____

When filing a Form T-1 involving multiple surface owners, attach an additional sheet listing all of the information to the left for each surface owner. Surface owner information can be found in the records of the register of deeds for the county, and in the real estate property tax records of the county treasurer.

If this form is being submitted with a Form C-1 (Intent) or CB-1 (Cathodic Protection Borehole Intent), you must supply the surface owners and the KCC with a plat showing the predicted locations of lease roads, tank batteries, pipelines, and electrical lines. The locations shown on the plat are preliminary non-binding estimates. The locations may be entered on the Form C-1 plat, Form CB-1 plat, or a separate plat may be submitted.

Select one of the following:

- I certify that, pursuant to the Kansas Surface Owner Notice Act (House Bill 2032), I have provided the following to the surface owner(s) of the land upon which the subject well is or will be located: 1) a copy of the Form C-1, Form CB-1, Form T-1, or Form CP-1 that I am filing in connection with this form; 2) if the form being filed is a Form C-1 or Form CB-1, the plat(s) required by this form; and 3) my operator name, address, phone number, fax, and email address.
- I have not provided this information to the surface owner(s). I acknowledge that, because I have not provided this information, the KCC will be required to send this information to the surface owner(s). To mitigate the additional cost of the KCC performing this task, I acknowledge that I must provide the name and address of the surface owner by filling out the top section of this form and that I am being charged a \$30.00 handling fee, payable to the KCC, which is enclosed with this form.

If choosing the second option, submit payment of the \$30.00 handling fee with this form. If the fee is not received with this form, the KSONA-1 form and the associated Form C-1, Form CB-1, Form T-1, or Form CP-1 will be returned.

I Submitted Electronically

I

ADVANTAGE ELEVATIONS

OIL FIELD SURVEYORS

BOX 8604 - PRATT, KS 67124
(620) 672-6491

92151

INVOICE NO.

VAL ENERGY INC

OPERATOR

1 SWD

NO.

KENNEDY

FARM

COWLEY

COUNTY

10

S

30s

T

5e

R

C SW SW NW

LOCATION

ELEVATION: 1334' GR



VAL ENERGY INC
125 N Market Ste 1710
Wichita, KS 67202

AUTHORIZED BY: Todd Allam

SCALE: 1" = 1000'

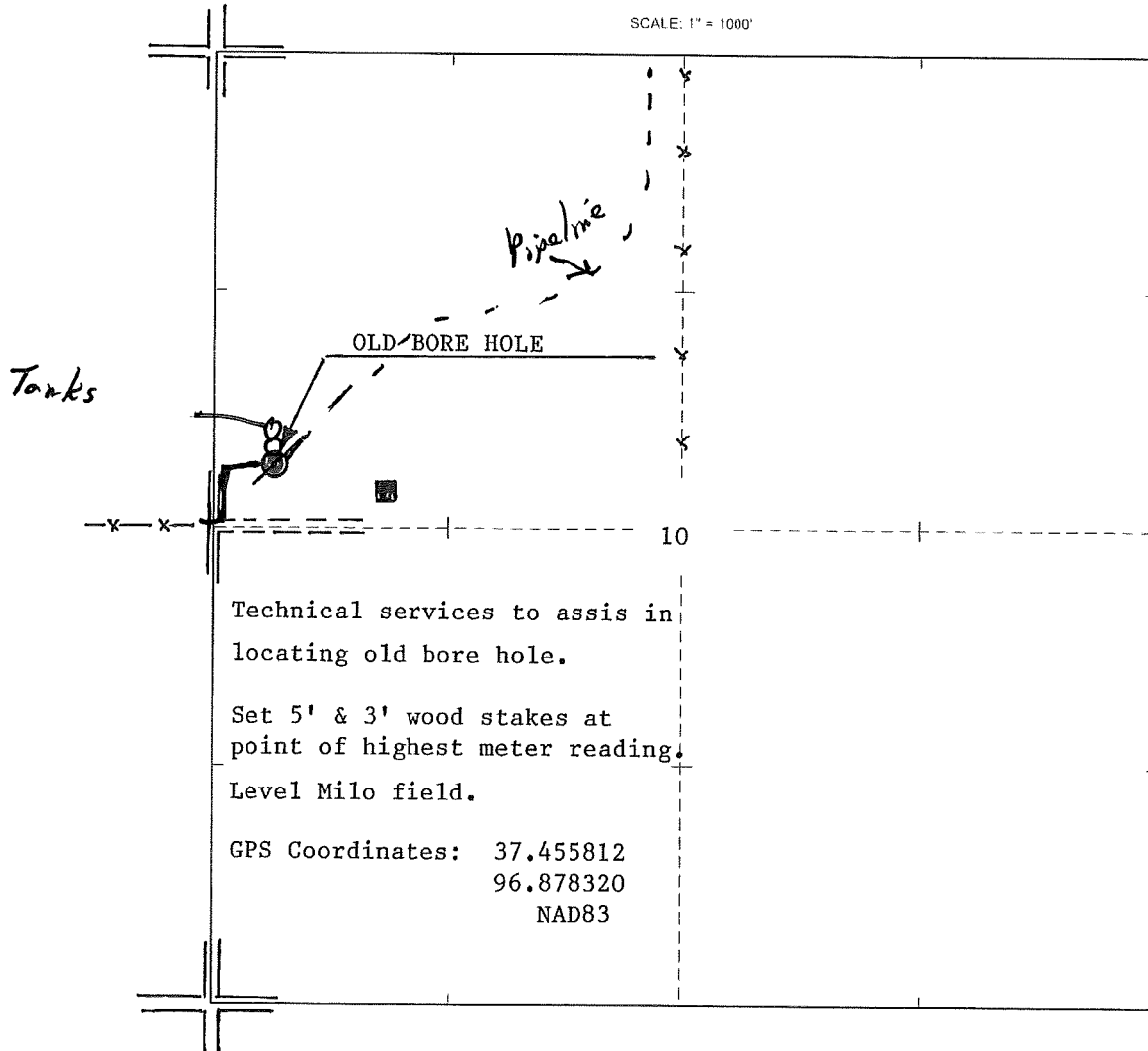

Technical services to assist in locating old bore hole.

Set 5' & 3' wood stakes at point of highest meter reading.

Level Milo field.

GPS Coordinates: 37.455812
96.878320
NAD83

DATE STAKED: 9/2/15

**NOTICE TO OPERATORS FILING INTENT TO DRILL
FOR DISPOSAL OR ENHANCED RECOVERY
INJECTION WELLS, (CLASS II INJECTION WELL)**

The attached approved Notice of Intent to Drill indicates the proposed well is to be used for injection. An approved "Intent to Drill" does not approve injection authority as a Class II Injection Well in Kansas.

Before any well is used for injection purposes, the operator must file an application for injection authority in accordance with K.A.R. 82-3-401 and provide notice in accordance with K.A.R. 82-3-402. The Conservation Division must issue a written permit granting the application before commencement of injection.

The Conservation Division requirements and restrictions associated with Class II Injection are identified in K.A.R. 82-3-400 et seq of our regulations. Associated regulations governing drilling, completion and injection applications may be found in K.A.R. 82-3-135, Table I, Table II, in the Cedar Hills Sandstone Moratorium, (Docket #156,397-C), and the Eastern Kansas Surface Casing Order, (Docket #133,891-C).

If you have questions regarding the approval of injection authority, an injection application may be filed as a "Design Approval" before actual drilling and completion of the well occurs. If you have any questions or concerns regarding Class II injection wells or regulations, call the Underground Injection Control Department at 316-337-6200.

Failure to obtain commission approval before beginning injection is punishable by a penalty, shut-in of the well or both.

STATE OF KANSAS
 STATE CORPORATION COMMISSION
 Give All Information Completely
 Make Required Affidavit
 Mail or Deliver Report to:
 Conservation Division
 State Corporation Commission
 800 Biting Building
 Wichita, Kansas

15-035-00736-0000

WELL PLUGGING RECORD

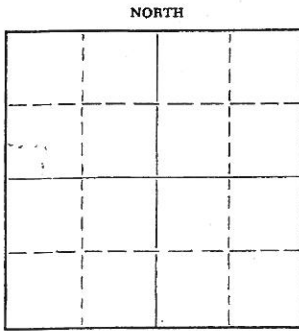

Locate well correctly on above
 Section Plat

Cowley County, Sec 10 Twp. 30S Rge. 5E (E) (W)
 Location as "NE/CNW&SW" or footage from lines SW SW NW
 Lease Owner McNeish & Galapp
 Lease Name Kennedy Well No. 1
 Office Address 528 State Bank Bldg., Winfield, Kansas
 Character of Well (completed as Oil, Gas or Dry Hole) Dry Hole
 Date well completed Sept. 29 19 55
 Application for plugging filed Sept. 29 19 55
 Application for plugging approved Sept. 29 19 55
 Plugging commenced Sept. 29 19 55
 Plugging completed Sept. 29 19 55
 Reason for abandonment of well or producing formation _____

If a producing well is abandoned, date of last production _____ 19 _____
 Was permission obtained from the Conservation Division or its agents before plugging was commenced? yes

Name of Conservation Agent who supervised plugging of this well W. S. Lemaster
 Producing formation _____ Depth to top _____ Bottom _____ Total Depth of Well 2933 Feet
 Show depth and thickness of all water, oil and gas formations.

OIL, GAS OR WATER RECORDS				CASING RECORD		
FORMATION	CONTENT	FROM	TO	SIZE	PUT IN	PULLED OUT

Describe in detail the manner in which the well was plugged, indicating where the mud fluid was placed and the method or methods used in introducing it into the hole. If cement or other plugs were used, state the character of same and depth placed, from _____ feet to _____ feet for each plug set.

Plugged with mud from 2933 ft. to 230 ft.; cement from 230 ft. to 190 ft.; mud from 190 ft. to 40 ft.; cement from 40 ft. to 0 ft.

RECEIVED
 STATE CORPORATION COMMISSION

OCT 12 1955

CONSERVATION DIVISION
 Wichita, Kansas

Name of Plugging Contractor _____
 Address _____

STATE OF Kansas, COUNTY OF Cowley, ss.
Geo. T. McNeish, one of operators (employee of owner) or (owner or operator) of the above-described well, being first duly sworn on oath, says: That I have knowledge of the facts, statements, and matters herein contained and the log of the above-described well as filed and that the same are true and correct. So help me God.

(Signature) Geo. T. McNeish
528 State Bank Bldg., Winfield, Kansas
 (Address)

SUBSCRIBED AND SWORN TO before me this 4th day of October, 19 55

My commission expires April 9, 1957
Grace Hill Notary Public.

PLUGGING
 FILE SEC 10 Twp 30 R 5E
 BOOK PAGE 4 LINES

15-035-00736-0000

WELL LOG

Farm: Kennedy #1
SW SW NW Sec. 10-30S-5E
Cowley County, Kans.

Company: McNeish & Gralapp
Winfield, Kansas

Contractor: Watson Drilling Company, Inc.
Winfield, Kansas.

Comm: 9-20-55
Comp: 9-29-55

Casing Record:
209 ft. of 8 5/8" surface csg.

WELL DRY & PLUGGED

Surface clay	0	195
lime	195	200
shale	200	294
lime & shale	294	1800
shale	1800	1890
shale & sand	1830	1890
sandy shale & lime	1890	2000
sand & shale	2000	2040
shale	2040	2241
lime K. C.	2241	2490
lime & shale	2490	2515
lime	2515	2555
shale	2555	2562
shale & lime	2562	2585
sandy lime shale	2585	2621
lime	2621	2683
lime & shale	2683	2870
sand	2870	2873
CORE #1	2873	2887
shale	2887	2910
Mississippi Lime	2910	2933

T. D. 2933 ft.

Plugged 9-29-55 Mud from 2933 ft. to 230 ft.;
cement from 230 ft. to 190 ft.; mud from 190 ft. to 40 ft.;
cement from 40 ft. to 0 ft.

PLUGGING
 WPA SEC. 10 30 5E
 BOOK PAGE 4 LINE 35