

L.D. DRILLING, INC.
SLAGLE FAMILY TRUST LEASE
SW. 1/4, SECTION 30, T20S, R25W
NESS COUNTY, KANSAS

Directions:

From the intersection of Highway 283 and Highway 96 (in Ness City, Kansas) go 8.6 miles West on Highway 96, then go 11.0 miles South, then go 4.0 miles West to the NW corner of Section 30, then go 0.62 miles South to a flagged fence on the east edge of road, then go 0.12 miles East to location.

GRAVEL (20 ROAD) ROAD

Notes:

1. Set iron rod at location site.
2. All flagging Red & Yellow.
3. Overhead power available at S. & W. lines, Sec. 30.
4. Kansas One Call System Inc. should be notified before excavation (1-800-344-7233).
5. CAUTION: Various pipelines in Sec. 30.
6. Section 30 is irregular.
7. Evidence of cattle in pasture at date of staking.
8. Contact landowner for best access.
9. Drillsite area will require approximately a 1' cut/fill.

FLAGGED FENCE OPPOSITE LOC.

PASTURE
 GATE (CLOSED)
 ABANDONED FARMSTEAD
 FIELD ENTRANCE
 DRAIN

30
 Old Well Location
 Slagle Family Trust
 #1-30 O.W.W.O.
 1995'FSL 650'FWL
 (4074'FEL)
 Ground Elevation = 2408
 Y = 592229 X = 1531743
 State Plane-NAD 27-Kansas South
 (Mapping Grade GPS Used)
 Latitude 38.281911
 Longitude -100.131790
 WGS 84-NAD 83

GRAVEL (10 ROAD) ROAD

*Ingress and egress to location as shown on this plat is per usage only and may not be legally opened for public use. Contact landowner, tenant and county road department for access.

SCALE 1" = 1000'

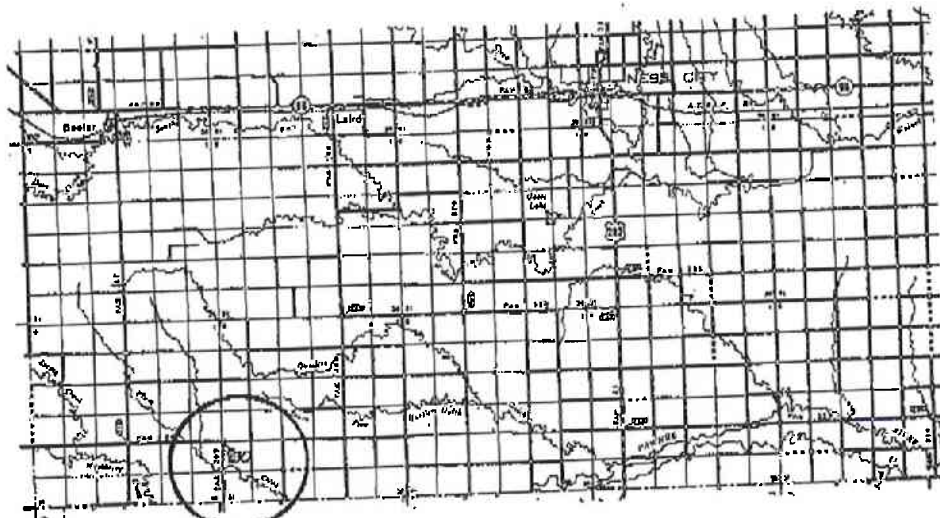

* Controlling data is based upon the best maps and photographs available to us and upon a regular section of land containing 640 acres.
 * Approximate section lines were determined using the normal standard of care of oilfield surveyors practicing in the state of Kansas. The section corners, which establish the precise section lines, were not necessarily located, and the exact location of the driftpile location in the section is not guaranteed. Therefore, the operator accepting this service and accepting this plat and all other matters relying thereon agree to hold Central Kansas Oilfield Services, Inc., its officers and employees harmless from all losses, costs and expenses and said entities released from any liability from incidental or consequential damages.
 * Elevations derived from National Geodetic Vertical Datum.

Date **September 22, 2015**