

**TYLUKA OPERATIONS, LLC**

**AXMAN LEASE**

**SW.1/4, SECTION 18, T17S, R14W**

**BARTON COUNTY, KANSAS**

PAVED (NW. 150 RD.) ROAD

TANK BATTERY  
DIRT ROAD  
(MA) OIL OPERATIONS, INC.  
AXMAN/YARMER UNIT #1

Notes:

1. Set (2) wood stakes at location site.
2. All flagging Red & Yellow.
3. Overhead power available at E. line, Sec. 18 and at the SW. corner of Sec. 18.
4. Kansas One Call System Inc. should be notified before excavation (1-800-344-7233).
5. CAUTION: Various pipelines in Sec. 18.
6. Contact landowner for best access.
7. Location 10' west of the west edge of a grass water-way, set alternate 50' west.

Drillsite Location

**Axman #1-18**

1953'FSL 921'FWL

**Ground Elevation = 1884**

Y = 693424 X = 1880121

State Plane-NAD 27-Kansas South  
(Mapping Grade GPS Used)

Latitude 38.570333

Longitude -98.919593

WGS 84-NAD 83

\*Alternate Location  
(50' west of Loc.)

1953'FSL 871'FWL

**Ground Elevation = 1884**

Y = 693424 X = 1880071

Latitude 38.570342

Longitude -98.919791

FIELD ENTRANCE

NO

(NW. 80 AVE.)

DIRT (NW. 140 RD.) ROAD

ROAD

(NW. 70 AVE.)

GRAVEL



\*Ingress and egress to location as shown on this plat is for usage only and may not be legally opened for public use. Contact landowner, tenant and county road department for access.

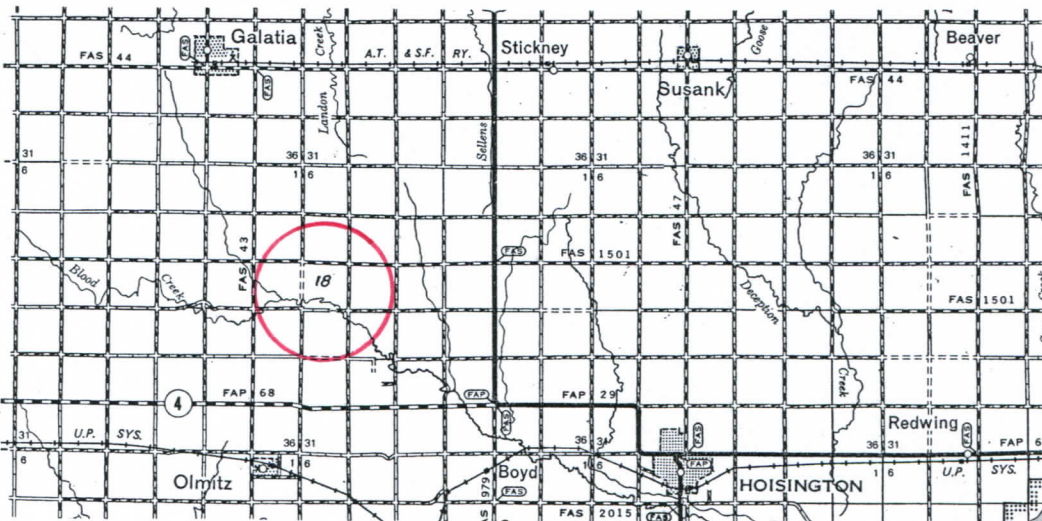

\* Controlling data is based upon the best maps and photographs available to us and upon a regular section of land containing 640 acres.  
 \* Approximate section lines were determined using the normal standard of care of oilfield surveyors practicing in the state of Kansas. The section corners, which establish the precise section lines, were not necessarily located, and the exact location of the drillsite location in the section is not guaranteed. Therefore, the operator securing this service and accepting this plat and all other parties relying thereon agree to hold Central Kansas Oilfield Services, Inc., its officers and employees harmless from all losses, costs and expenses and said entities released from any liability from incidental or consequential damages.  
 \* Elevations derived from National Geodetic Vertical Datum.

Date November 4, 2015