

Proposed Plan of Construction
 McWilliams E-5
 Sec 21 T24S-R33W
 Finney County, KS

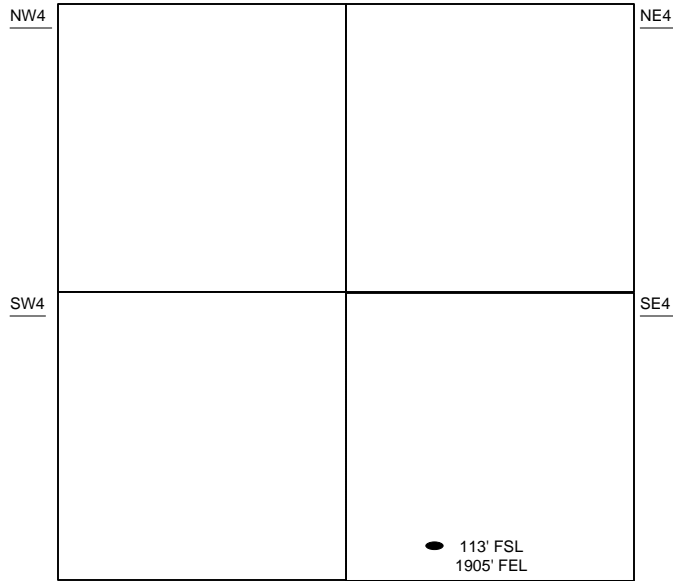

Sec 21 – T24S – R33W

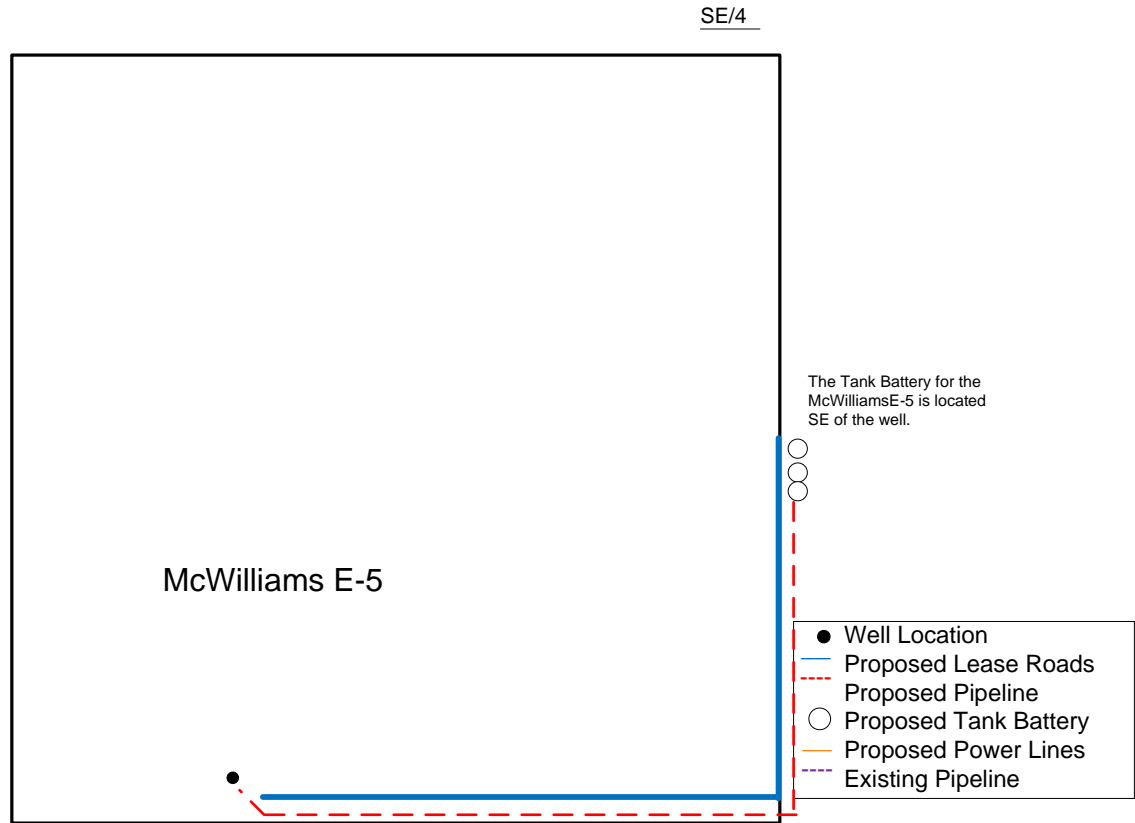

Proposed Details of
 SE/4 Sec 21 – T24S – R33W

Proposed Site Diagram
 McWilliams E-5
 July 14, 2015

Note-Drawing **Not** to Scale