

Proposed Plan of Construction
MML 1-10
Sec 10 T31S-R33W
Seward County, KS

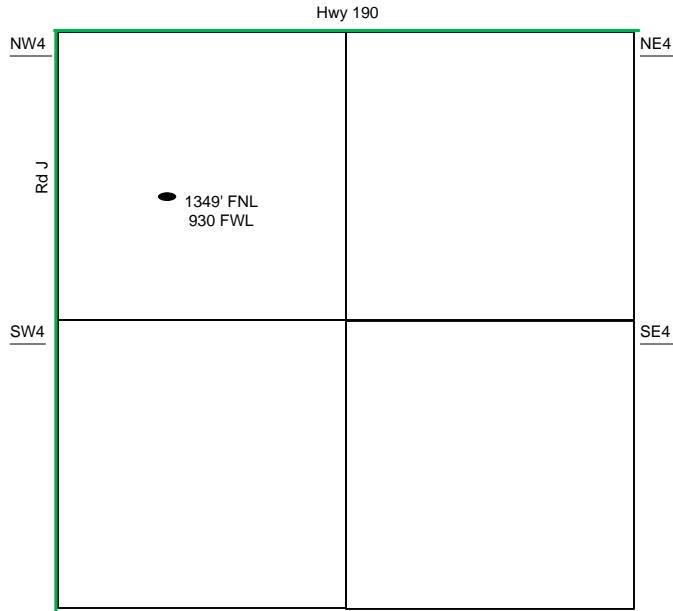

Sec 10 - T31S - R33W

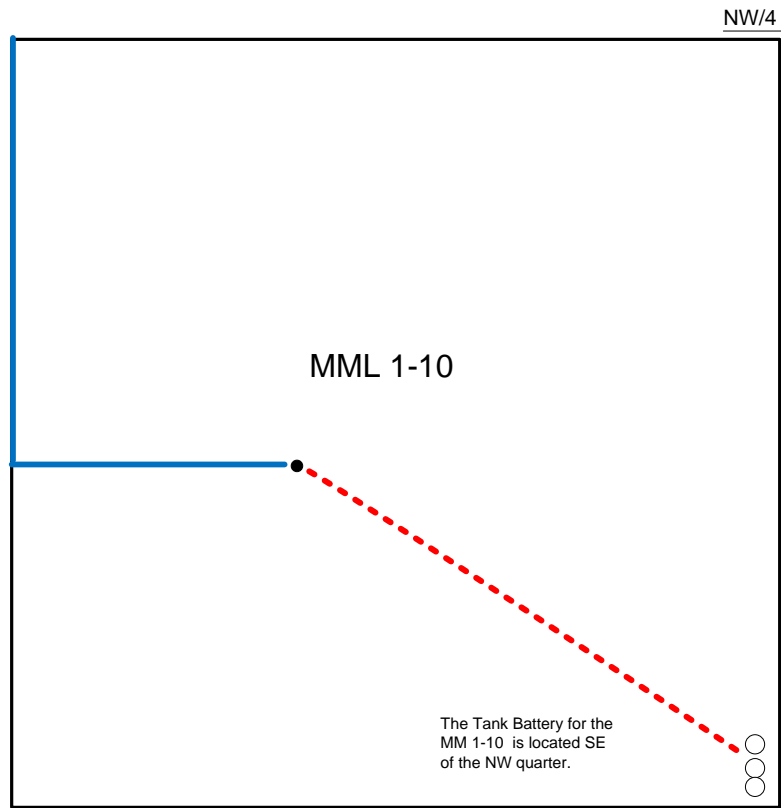

- Well Location
- Proposed Lease Roads
- - - Proposed Pipeline
- Proposed Tank Battery
- Proposed Power Lines
- - - Existing Pipeline

Proposed Details of
NW/4 Sec 10 - T31S - R33W

Proposed Site Diagram
MML 1-10
February 8th, 2016

Note-Drawing **Not** to Scale