

VINCENT OIL CORPORATION  
 STEELE LEASE  
 SE. 1/4, SECTION 32, T27S, R23W  
 FORD COUNTY, KANSAS

NO ROAD

Notes:

1. Set (2) wood stakes at location site.
2. All flagging Red & Yellow.
3. Overhead power available at S. line, Sec. 32.
4. Kansas One Call System Inc. should be notified before excavation (1-800-344-7233).
5. CAUTION; Various pipelines in Sec. 32.
6. Contact landowner for best access and as to location of wood stakes in wheat.

ROAD (119 ROAD)  
 GRAVEL

ROAD (120 ROAD)  
 DIRT

32

Drillsite Location  
 Steele #1-32  
 210' FSL 2263' FEL  
 Ground Elevation = 2498  
 Y = 359880 X = 1606290  
 State Plane-NAD 27-Kansas South  
 (Mapping Grade GPS Used)  
 Latitude 37.647154807  
 Longitude -99.859869497  
 (NAD 27)

WHEAT

MARKED UNDERGROUND FIBER OPTIC  
 CABLE APPROX. 150' S. OF LOC.

PAVED (SADDLE ROAD) FLAGGED ROAD ROAD  
 OPPOSITE LOC.



\*Ingress and egress to location as shown on this plot is per usage only and may not be legally opened for public use. Contact landowner, tenant and county road department for access.

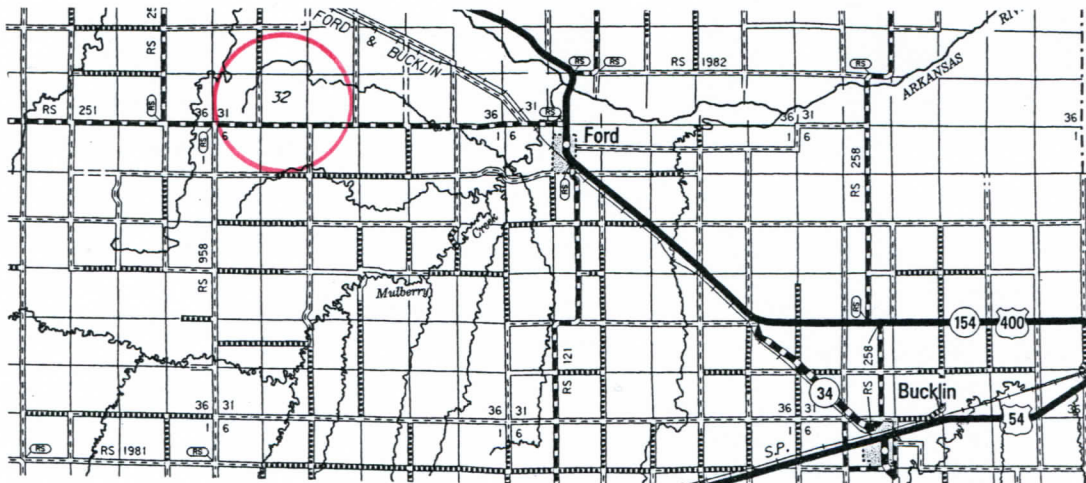

\* Controlling data is based upon the best maps and photographs available to us and upon a regular section of land containing 640 acres.

\* Approximate section lines were determined using the normal standard of care of oilfield surveyors practicing in the state of Kansas. The section corners, which establish the precise section lines, were not necessarily located, and the exact location of the drillsite location in the section is not guaranteed. Therefore, the operator securing this service and accepting this plot and all other parties relying thereon agree to hold Central Kansas Oilfield Services, Inc., its officers and employees harmless from all losses, costs and expenses and said entities released from any liability from incidental or consequential damages.

\* Elevations derived from National Geodetic Vertical Datum.

Date February 10, 2016