

Proposed Plan of Construction

Triple P 2-1
Sec 2 T28S-R33W
Haskell County, KS

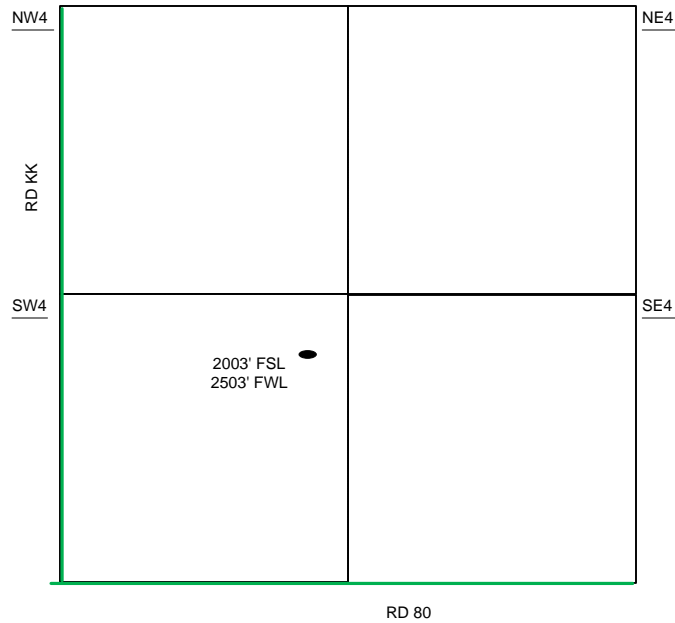

Sec 2 - T28S - R33W

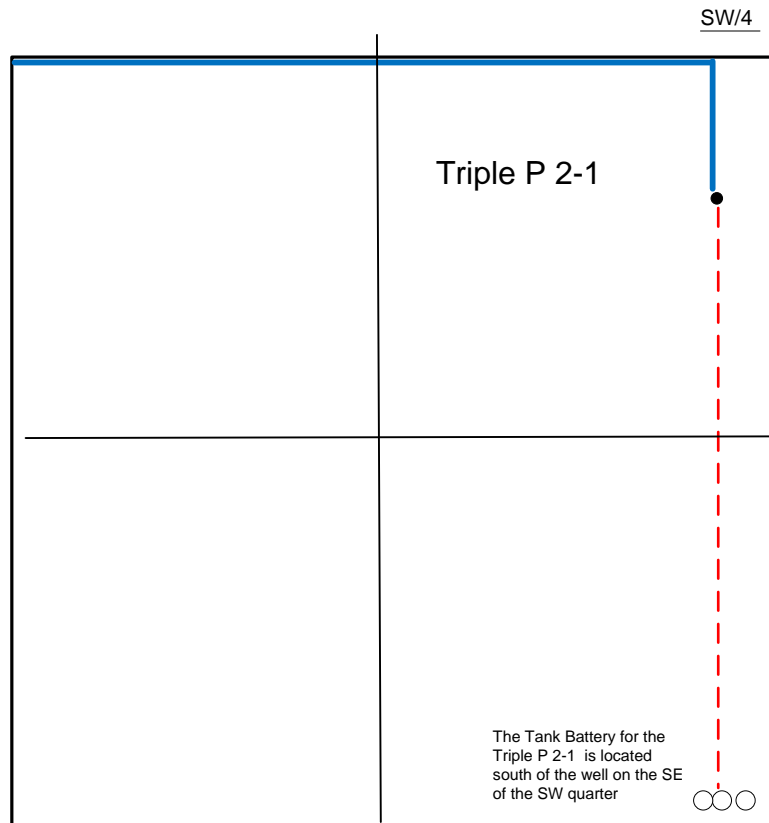

- Well Location
- Proposed Lease Roads
- - - Proposed Pipeline
- Proposed Tank Battery
- Proposed Power Lines
- - - Existing Pipeline

Proposed Details of
SW/4 Sec 2 - T28S - R33W

Proposed Site Diagram
Triple P 2-1
July 28, 2016

Note-Drawing **Not** to Scale