

**GORE OIL COMPANY
KEAS LEASE
SE. 1/4, SECTION 16, T9S, R17W
ROOKS COUNTY, KANSAS**

GRAVEL (U ROAD) ROAD

Notes:

1. Set iron rod at location site.
2. All flagging Red & Yellow.
3. Overhead power available at S. & E. lines and E. 3/4 of N. line and S. 1/4 of W. line, Sec. 16.
4. Kansas One Call System Inc. should be notified before excavation (1-800-344-7233).
5. CAUTION; Various pipelines in Sec. 16.
6. Bull in pasture at date of staking.
7. Contact landowner for best access.
8. Location fell 43' east of a N-S fence, no alternate set per instructions.

Ingress and egress to location as shown on this plot is per usage only and may not be legally opened for public use. Contact landowner, tenant and county road department for access.

ROAD (21 ROAD)
GRAVEL

ROAD (22 ROAD)
GRAVEL

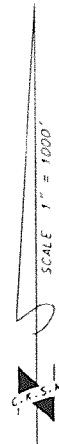

16

Drillsite Location
Keas #1
1890'FSL 1100'FEL
Ground Elevation = 2102
Y = 342872 X = 1655176
State Plane-NAD 27-Kansas North
Latitude 39.268363
Longitude -99.218355
NCS 84-NAD 83

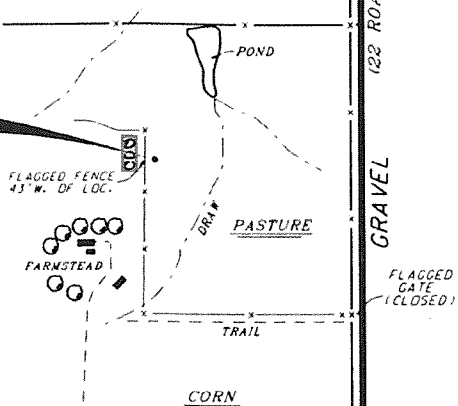

GRAVEL (V ROAD) ROAD

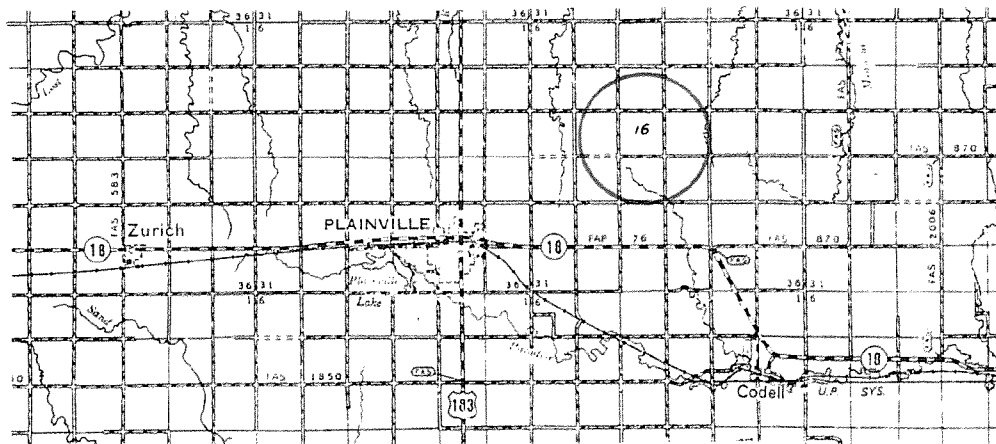

- Contouring data is based upon the best maps and photographs available to us and upon a regular section of land containing 640 acres.
- Approximate section lines were determined using the normal standard of care of oilfield surveyors practicing in the state of Kansas. The section corners, which establish the precise section lines, were not necessarily located, and the exact location of the drillsite location on the section is not guaranteed. Therefore, the operator securing this service and accepting this plot and all other parties relying thereon agree to hold Central Kansas Oilfield Services, Inc., its officers and employees harmless from all losses, costs and expenses and hold parties released from any liability from incidental or consequential damages.
- Elevations derived from National Geodetic Vertical Datum.

Date July 23, 2018

CENTRAL KANSAS OILFIELD SERVICES, INC. (620)792-1977