

Proposed Plan of Construction

North Pebble 26-2
Sec 26 T24S-R32W
Finney County, KS

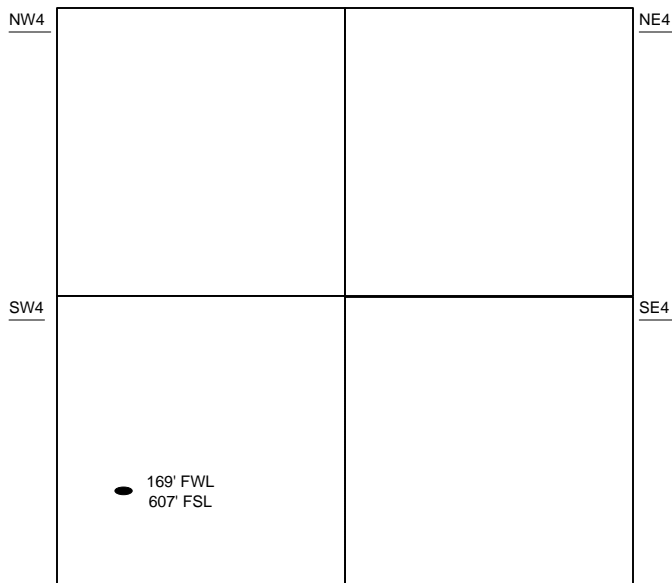

Sec 26 - T24S - R32W

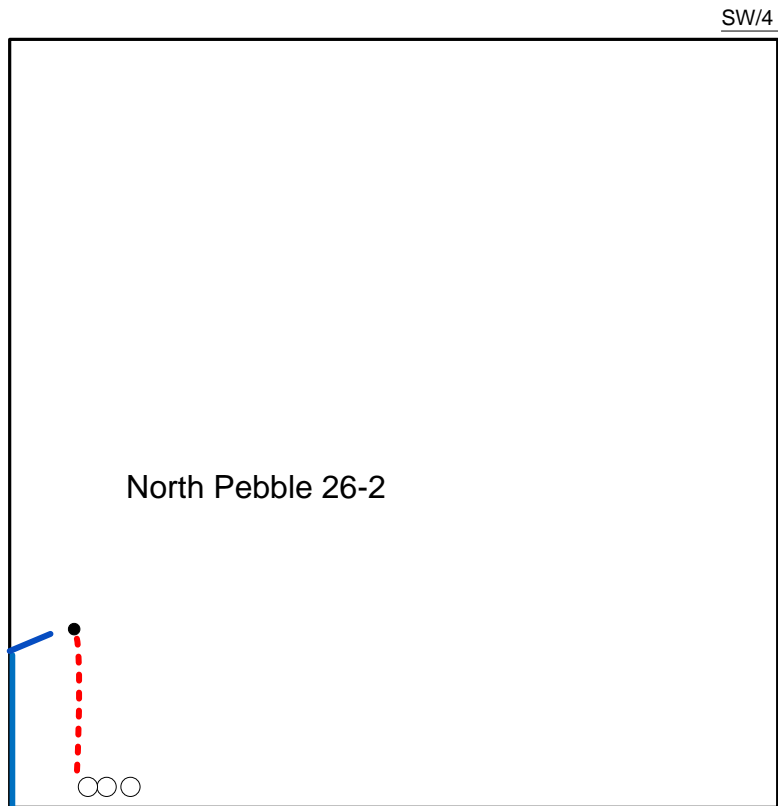

- Well Location
- Proposed Lease Roads
- - - Proposed Pipeline
- Proposed Tank Battery
- Proposed Power Lines
- - - Existing Pipeline

The Tank Battery for the North Pebble 26-2 is located SW of the SW quarter.

Proposed Details of
SW/4 Sec 26 - T24S - R32W

Note-Drawing **Not** to Scale

Proposed Site Diagram
North Pebble 26-2
April 19, 2015