



APPLICATION FOR COMMINGLING OF PRODUCTION (K.A.R. 82-3-123) OR FLUIDS (K.A.R. 82-3-123a) *Commingling ID # _____*

OPERATOR: License # _____ API No. 15 - _____
Name: _____ Spot Description: _____
Address 1: _____ - - - - - Sec. _____ Twp. _____ S. R. _____ East West
Address 2: _____ Feet from North / South Line of Section
City: _____ State: _____ Zip: _____ + _____ Feet from East / West Line of Section
Contact Person: _____ County: _____
Phone: (_____) _____ Lease Name: _____ Well #: _____

1. Name and upper and lower limit of each production interval to be commingled:
Formation: _____ (Perfs): _____
Formation: _____ (Perfs): _____
Formation: _____ (Perfs): _____
Formation: _____ (Perfs): _____
Formation: _____ (Perfs): _____

2. Estimated amount of fluid production to be commingled from each interval:
Formation: _____ BOPD: _____ MCFPD: _____ BWPD: _____
Formation: _____ BOPD: _____ MCFPD: _____ BWPD: _____
Formation: _____ BOPD: _____ MCFPD: _____ BWPD: _____
Formation: _____ BOPD: _____ MCFPD: _____ BWPD: _____
Formation: _____ BOPD: _____ MCFPD: _____ BWPD: _____

3. Plat map showing the location of the subject well, all other wells on the subject lease, and all wells on offsetting leases within a 1/2 mile radius of the subject well, and for each well the names and addresses of the lessee of record or operator.

4. Signed certificate showing service of the application and affidavit of publication as required in K.A.R. 82-3-135a.

For Commingling of PRODUCTION ONLY, include the following:

- 5. Wireline log of subject well. Previously Filed with ACO-1: Yes No
- 6. Complete Form ACO-1 (*Well Completion form*) for the subject well.

For Commingling of FLUIDS ONLY, include the following:

- 7. Well construction diagram of subject well.
- 8. Any available water chemistry data demonstrating the compatibility of the fluids to be commingled.

AFFIDAVIT: I am the affiant and hereby certify that to the best of my current information, knowledge and personal belief, this request for commingling is true and proper and I have no information or knowledge, which is inconsistent with the information supplied in this application.

Submitted Electronically

KCC Office Use Only
 Denied Approved
15-Day Periods Ends: _____
Approved By: _____ Date: _____

Protests may be filed by any party having a valid interest in the application. Protests must be in writing and comply with K.A.R. 82-3-135b and must be filed within 15 days of publication of the notice of application.

APPLICATION FOR COMMINGLING OF PRODUCTION OR FLUIDS

Operator, Lessee or Unleased Mineral Owner
Within a ½ mile radius of Ritchie Exploration, Inc.'s

#1 Bridges 24CD
1790' FSL & 782' FWL
Section 24-14S-32W
Logan Co., KS

Township 14 South, Range 32 West

Sec. 23:	NE/4	Infinity Oil, Inc. 1014 E 29th Hays, KS 67601	Operator #2, #3 Ellis
	SE/4	Ritchie Exploration, Inc. P.O. Box 783188 Wichita, KS 67278-3188	Operator: #2, #3 Ellis 23D
Sec. 24:	NE/4	Lario Oil & Gas Company 301 S. Market St. Wichita, KS 67202	Operator: Nuss #1-24
	NW/4	Frederick Nuss; Barbara Nuss; Joanne Nuss; Catherine Nuss c/o Frederick Nuss P.O. Box 2080 Great Bend, KS 67530	Landowners
	SW/4; W/2SE/4	Ritchie Exploration, Inc.	Operator: #1 Bridges 24CD
Sec. 25:	NW/4; W/2NE/4	Ritchie Exploration, Inc.	Lessee
Sec. 26:	NE/4	Trans Pacific Oil Corporation 100 S. Main St, Ste 200 Wichita, KS 67202-3734	Operator: #1, #2, #3, #5 Krebs S, #5 Krebs R

R 32 W

T
14
S

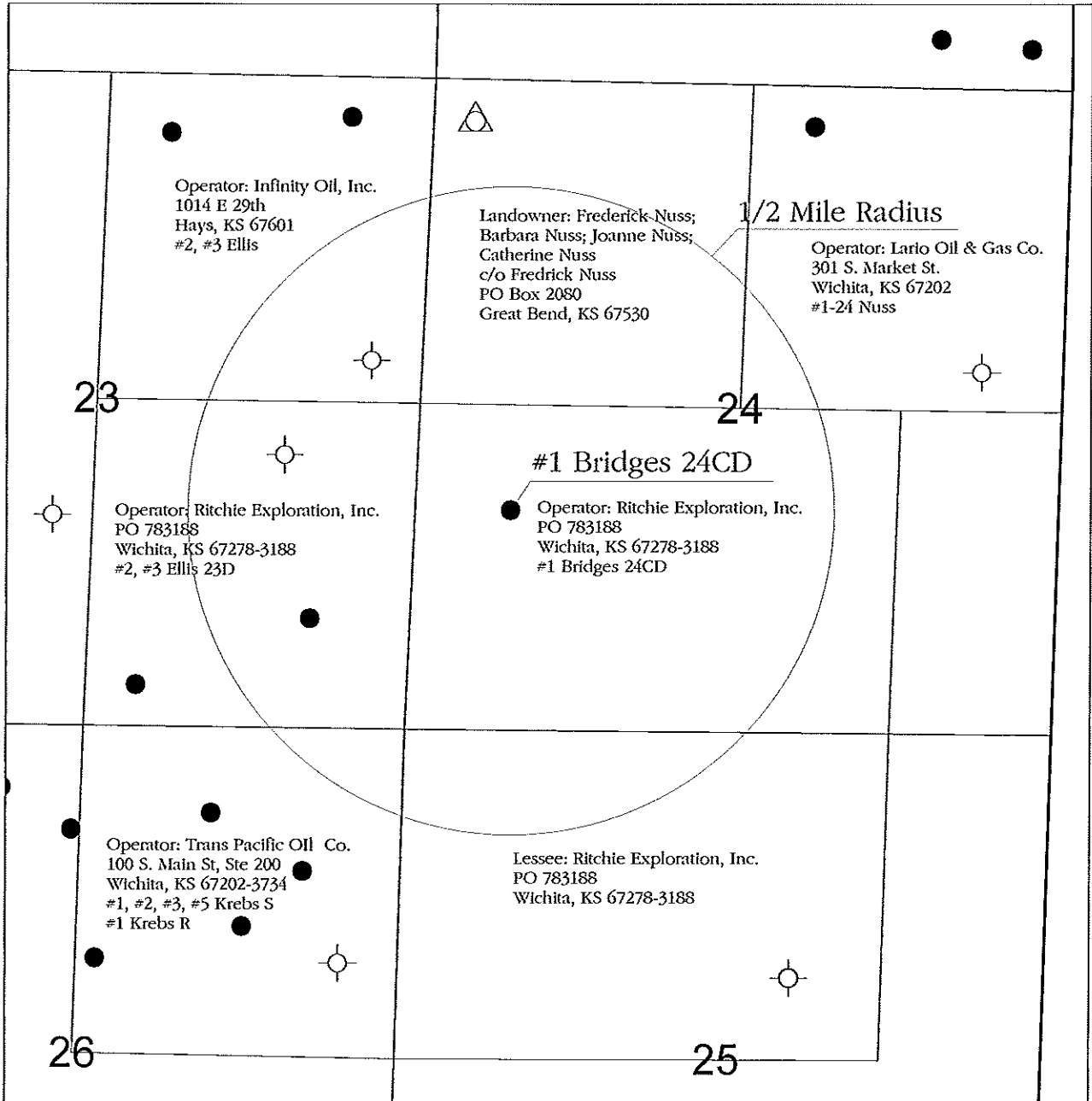

Legend

- Oil Well
- ⊕ Dry and Abandoned Well
- △ Service Well



RITCHIE
EXPLORATION, INC.
Wichita, Kansas

Application for
Commingling of
Production or Fluids

Applicant Well: #1 Bridges 24CD
All Wells within 1/2 Mile Radius
Name and Address of Lessee of Record or Operator
On Offsetting Leases

Logan County, Kansas		
Prepared By: Justin Clegg	Scale: 1 : 16,000	Date: September 12, 2016

AFFIDAVIT

STATE OF KANSAS)
 - SS.
County of Sedgwick)

Peter Fiorini, of lawful age, being first duly sworn, deposeth and saith: That he is Production Manager of Ritchie Exploration, County of Sedgwick, State of Kansas, and that notice was given to all lessee of record or operator within ½ mile radius of the Bridges 24CD #1 well located in the County of Logan (see attached plat map). This notice included a letter regarding the Commingle Application. All notices were mailed on September 13, 2016.

made as aforesaid on the 13th of

September A.D. 2016

And affiant further says that he has personal knowledge of the statements above set forth and that they are true.

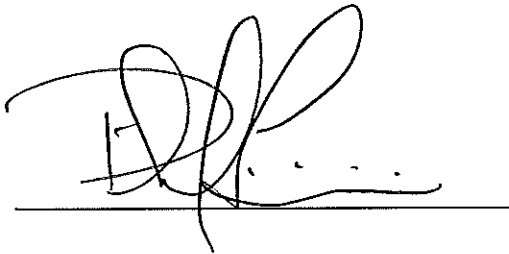

A handwritten signature in black ink, appearing to read 'P. Fiorini', is written over a horizontal line.

Subscribed and sworn to before me this

13th day of September 2016

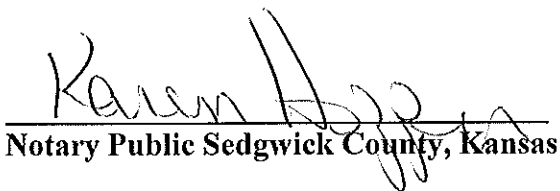

A handwritten signature in black ink, appearing to read 'Karen Hopper', is written over a horizontal line.

Notary Public Sedgwick County, Kansas





LEGAL PROOF OF PUBLICATION

Account #	Ad Number	Identification	PO	Amount	Cols	Lines
453699	0002676959	Published in the Wichita Eagle September 16, 20		\$139.20	1	38

Attention: karen hopper

RITCHIE EXPLORATION INC
P O BOX 783188
WICHITA, KS 672783188

In The STATE OF KANSAS
In and for the County of Sedgwick
AFFIDAVIT OF PUBLICATION

1 Insertions

Beginning issue of: 09/16/2016

Ending issue of: 09/16/2016

STATE OF KANSAS)

.SS

County of Sedgwick)

Dale Seiwert, of lawful age, being first duly sworn, deposeth and saith: That he is Record Clerk of The Wichita Eagle, a daily newspaper published in the City of Wichita, County of Sedgwick, State of Kansas, and having a general paid circulation on a daily basis in said County, which said newspaper has been continuously and uninterruptedly published in said County for more than one year prior to the first publication of the notice hereinafter mentioned, and which said newspaper has been entered as second class mail matter at the United States Post Office in Wichita, Kansas, and which said newspaper is not a trade, religious or fraternal publication and that a notice of a true copy is hereto attached was published in the regular and entire Morning issue of said The Wichita Eagle from 9/16/2016 to 09/16/2016.

I certify (or declare) under the penalty of perjury that the foregoing is true and correct.

(Signature of Principal Clerk)

DATED: 9/16/2016

LEGAL PUBLICATION

Published in the Wichita Eagle
September 16, 2016 (2676959)

LEGAL NOTICE

You, and each of you, are hereby notified that Ritchie Exploration, Inc. has filed an application to commence the commencing of production from the Lansing/ Kansas City, Morrow Sand and Johnson sources of supply for the #1 Bridges 24CD well located approx. S1/2 NW SW of Section 24-14S-34W, Logan County, Kansas. Any persons who object to or protest this application shall be required to file their objections or protests with the Conservation Division of the State Corporation Commission of the State of Kansas within fifteen (15) days from the date of the publication. These protests shall be filed pursuant to Commission regulations and must state specific reasons why the grant of the application may cause waste, violate correlative rights or pollute the natural resources of the state of Kansas. If no protests are received, this application may be granted through a summary proceeding. If valid protests are received, this matter will be set for hearing.

All persons interested or concerned shall take notice of the foregoing and shall govern themselves accordingly.
RITCHIE EXPLORATION, INC.
P.O. Box 783188
Wichita, KS 67278-3188
(316) 691-9500

Notary Public Sedgwick County, Kansas

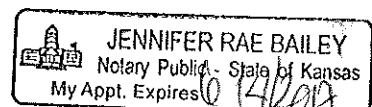

Proof of P

State of Kansas,
County of Logan, ss:

of lawful age, being duly sworn upon oath states that he/she is the editor of **THE OAKLEY GRAPHIC**.

THAT said newspaper has been published at least weekly 50 times a year and has been so published for at least five years prior to the first publication of the attached notice.

THAT said newspaper was entered as second class matter at the post office of its publication;

THAT said newspaper has a general paid circulation on a daily, weekly, monthly, or yearly basis in LOGAN County, Kansas and is NOT a trade, religious or fraternal publication and has been printed and published in LOGAN County, Kansas.

THE ATTACHED was published on the following dates in a regular issue of said newspaper:

- 1st Publication was made on the 21 day of Sept, 20 16
- 2nd Publication was made on the _____ day of _____, 20 _____
- 3rd Publication was made on the _____ day of _____, 20 _____
- 4th Publication was made on the _____ day of _____, 20 _____
- 5th Publication was made on the _____ day of _____, 20 _____
- 6th Publication was made on the _____ day of _____, 20 _____

Publication fee \$ 51.30
 Affidavit, Notary's Fees \$ _____
 Additional Copies _____ @ _____ \$ _____
 Total Publication Fee \$ 51.30

Dawn Wendel
(Signed)

Witness my hand this 21 day of Sept, 20 16

SUBSCRIBED and SWORN to before me this 21 day of Sept, 20 16.

Kelly C Anderson
(Notary Public)

My commission expires 2-7-2018

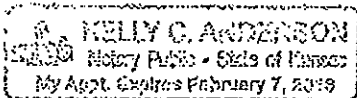

Published in the Oakley Graphic Sept. 21, 2016
LEGAL NOTICE

You, and each of you, are hereby notified that Ritchie Exploration, Inc. has filed an application

to commence the commingling of production from the Lansing/Kansas City, Morrow Sand and Johnson sources of supply for the #1 Bridges 24CD well located approx. S/2 NW SW of Section 24-14S-32W, Logan County, Kansas.

Any persons who object to or protest this application shall be required to file their objections or protests with the Conservation Division of the State Corporation Commission of the State of Kansas within fifteen (15) days from the date of the publication. These protests shall be filed pursuant to Commission regulations and must state specific reasons why the grant of the application may cause waste, violate correlative rights or pollute the natural resources of the state of Kansas.

If no protests are received this application may be granted through a summary proceeding. If valid protests are received, this matter will be set for hearing.

All persons interested or concerned shall take notice of the foregoing and shall govern themselves accordingly.

RITCHIE
EXPLORATION, INC.
P.O. Box 783188
Wichita, KS 67278-3188
(316) 691-9500

Confidentiality Requested:

Yes No

KANSAS CORPORATION COMMISSION 1231050
OIL & GAS CONSERVATION DIVISION

Form ACO-1

August 2013

Form must be Typed

Form must be Signed

All blanks must be Filled

CONFIDENTIAL WELL COMPLETION FORM

WELL HISTORY - DESCRIPTION OF WELL & LEASE

OPERATOR: License # 4767

Name: Ritchie Exploration, Inc.

Address 1: 8100 E 22ND ST N # 700

Address 2: BOX 783188

City: WICHITA State: KS Zip: 67278 + 3188

Contact Person: Peter Fiorini

Phone: (316) 691-9500

CONTRACTOR: License # 34082

Name: Alliance Well Service Inc.

Wellsite Geologist: Jeff Christian

Purchaser: NCRA

Designate Type of Completion:

- New Well Re-Entry Workover
- Oil WSW SWD SIOW
- Gas D&A ENHR SIGW
- OG GSW Temp. Abd.
- CM (Coal Bed Methane)
- Cathodic Other (Cora, Expl., etc.): _____

If Workover/Re-entry: Old Well Info as follows:

Operator: Ritchie Exploration, Inc.

Well Name: Bridges 24CD

Original Comp. Date: 07/24/2010 Original Total Depth: 4460

- Deepening Re-perf. Conv. to ENHR Conv. to SWD
- Plug Back Conv. to GSW Conv. to Producer

- Commingled Permit #: _____
- Dual Completion Permit #: _____
- SWD Permit #: _____
- ENHR Permit #: _____
- GSW Permit #: _____

<u>09/15/2014</u>	<u>09/15/2014</u>	<u>09/18/2014</u>
Spud Date or Recompletion Date	Date Reached TD	Completion Date or Recompletion Date

API No. 15 - 15-109-20926-00-01

Spot Description: 140'N & 122'E of

S2_NW_SW Sec. 24 Twp. 14 S. R. 32 East West

1790 Feet from North / South Line of Section

782 Feet from East / West Line of Section

Footages Calculated from Nearest Outside Section Corner:

- NE NW SE SW

GPS Location: Lat: _____, Long: _____
(e.g. xx.xxxxx) (e.g. -xxx.xxxxx)

Datum: NAD27 NAD83 WGS84

County: Logan

Lease Name: Bridges 24CD Well #: 1

Field Name: _____

Producing Formation: LKC, Johnson, Morrow

Elevation: Ground: 2743 Kelly Bushing: 2753

Total Vertical Depth: 4460 Plug Back Total Depth: 4427

Amount of Surface Pipe Set and Cemented at: 214 Feet

Multiple Stage Cementing Collar Used? Yes No

If yes, show depth set: 2197 Feet

If Alternate II completion, cement circulated from: 0

feet depth to: 2197 w/ 245 sx cmt.

Drilling Fluid Management Plan

(Data must be collected from the Reserve Pit)

Chloride content: _____ ppm Fluid volume: _____ bbls

Dewatering method used: _____

Location of fluid disposal if hauled offsite: _____

Operator Name: _____

Lease Name: _____ License #: _____

Quarter _____ Sec. _____ Twp. _____ S. R. _____ East West

County: _____ Permit #: _____

AFFIDAVIT

I am the affiant and I hereby certify that all requirements of the statutes, rules and regulations promulgated to regulate the oil and gas industry have been fully complied with and the statements herein are complete and correct to the best of my knowledge.

Submitted Electronically

KCC Office Use ONLY

- Confidentiality Requested
Date: 11/07/2014
- Confidential Release Date: _____
- Wireline Log Received
- Geologist Report Received
- UIC Distribution
- ALT I II III Approved by: NAOMI JAMES Date: 11/07/2014



1231050

Operator Name: Ritchie Exploration, Inc. Lease Name: Bridges 24CD Well #: 1
Sec. 24 Twp. 14 S. R. 32 East West County: Logan

INSTRUCTIONS: Show important tops of formations penetrated. Detail all cores. Report all final copies of drill stems tests giving interval tested, time tool open and closed, flowing and shut-in pressures, whether shut-in pressure reached static level, hydrostatic pressures, bottom hole temperature, fluid recovery, and flow rates if gas to surface test, along with final chart(s). Attach extra sheet if more space is needed.

Final Radioactivity Log, Final Logs run to obtain Geophysical Data and Final Electric Logs must be emailed to kcc-well-logs@kcc.ks.gov. Digital electronic log files must be submitted in LAS version 2.0 or newer AND an image file (TIFF or PDF).

Drill Stem Tests Taken (Attach Additional Sheets) Samples Sent to Geological Survey Cores Taken Electric Log Run List All E. Logs Run: Log Formation (Top), Depth and Datum Sample Name Attached Top Attached Datum Attached

CASING RECORD Table with columns: Purpose of String, Size Hole Drilled, Size Casing Set (In O.D.), Weight Lbs. / Ft., Setting Depth, Type of Cement, # Sacks Used, Type and Percent Additives. Includes rows for Surface and Production.

ADDITIONAL CEMENTING / SQUEEZE RECORD Table with columns: Purpose, Depth Top Bottom, Type of Cement, # Sacks Used, Type and Percent Additives.

Did you perform a hydraulic fracturing treatment on this well? Does the volume of the total base fluid of the hydraulic fracturing treatment exceed 350,000 gallons? Was the hydraulic fracturing treatment information submitted to the chemical disclosure registry?

PERFORATION RECORD - Bridge Plugs Set/Type Table with columns: Shots Per Foot, Specify Footage of Each Interval Perforated, Acid, Fracture, Shot, Cement Squeeze Record (Amount and Kind of Material Used), Depth.

TUBING RECORD: Size: 2.875 Set At: 4408 Packer At: Liner Run: Yes No

Date of First, Resumed Production, SWD or ENHR. 9/18/2014 Producing Method: Flowing Pumping Gas Lift Other (Explain)

Estimated Production Per 24 Hours Oil Bbls. 23.80 Gas Mcf Water Bbls. 20.02 Gas-Oil Ratio Gravity 27

DISPOSITION OF GAS: Vented Sold Used on Lease METHOD OF COMPLETION: Open Hole Perf. Dually Comp. Commingled Other (Specify) PRODUCTION INTERVAL:

Form	ACO1 - Well Completion
Operator	Ritchie Exploration, Inc.
Well Name	Bridges 24CD 1
Doc ID	1231050

Tops

Name	Top	Datum
Anhydrite	2217	+536
B/Anhydrite	2232	+521
Heebner	3735	-982
Lansing	3770	-1017
Lansing C	3805	-1052
Lansing D	3820	-1067
Lansing E	3857	-1104
Muncie Shale	3928	-1175
Lansing H	3942	-1189
Lansing I	3974	-1221
Lansing J	4002	-1249
Lansing K	4036	-1283
Lansing L	4067	-1314
BKC	4111	-1358
Marmaton	4133	-1380
Altamont	4153	-1400
Pawnee	4222	-1469
Myric Station	4260	-1507
Fort Scott	4275	-1522
Cherokee Shale	4303	-1550
Johnson	4344	-1591
B/Johnson	4374	-1621
Morrow Sand	4384	-1631
Mississippian	4392	-1639

Conservation Division
266 N. Main St., Ste. 220
Wichita, KS 67202-1513



Phone: 316-337-6200
Fax: 316-337-6211
<http://kcc.ks.gov/>

Jay Scott Emler, Chairman
Shari Feist Albrecht, Commissioner
Pat Apple, Commissioner

Sam Brownback, Governor

October 6, 2016

Peter Fiorini
Ritchie Exploration, Inc.
P.O. Box 783188
Wichita, KS 67278-3188

RE: Approved Commingling CO091604
Bridges 24CD 1
API No. 15-109-20926-00-01

Dear Mr. Fiorini:

Your Application for Commingling (ACO-4) for the above described well has been reviewed and approved by the Kansas Corporation Commission (KCC) per K.A.R. 82-3-123. Notice was examined and found to be proper per K.A.R. 82-3-135a. No protest had been filed within the 15-day protest period.

Based upon the depth of the Morrow Sand formation perforations, total oil production shall not exceed 200 BOPD and total gas production shall not exceed 50% of the absolute open flow (AOF).

Sincerely,

Rick Hestermann
Production Department