

L.D. DRILLING, INC.
MILLER LEASE
SE.1/4, SECTION 5, T3S, R23W
NORTON COUNTY, KANSAS

Directions:

From the intersection of Highway 283 and Highway 36-383 (in Norton, Kansas) go 1.18 miles Southwest on Highway 36-383, then go 0.53 miles South on a county road, then go 0.28 miles Southwest, then go 0.80 miles West to the NE. corner of the Southeast Quarter of Section 5, then go 0.10 miles South to a flag on the west edge of road, then go 0.18 miles West to location.

HIGHWAY (ROAD M) 36-383

Notes:

1. Set (3) wood stakes at location site.
2. All flagging Red & Yellow.
3. Overhead power available at N. line and N.1/2 of W. line, Sec.5 and in the SW.1/4 of Sec.5.
4. Kansas One Call System Inc. should be notified before excavation (1-800-344-7233).
5. CAUTION: Various pipelines in Sec.5.
6. Contact landowner for best access and as to location of wood stakes in milo.
7. Drillsite area will require approximately a 1' cut/fill.

Drillsite Location

#1-5 Miller "A"

2090'FSL 990'FEL

Ground Elevation = 2338

Y = 546779 X = 1457961

State Plane-NAD 27-Kansas North
 (Mapping Grade GPS Used)

Latitude 39.818755

Longitude -99.930249

WGS 84-NAD 83

GRAVEL ROAD (ROAD W3)

NO ROAD

NO ROAD

(ROAD W2) DIRT ROAD

NO ROAD

(ROAD N)

DIRT ROAD

SCALE 1" = 1000'

C.T.S.M.

FLAGGED ROAD OPPOSITE LOC.

(TERRACED) MILO

RAILROAD

DRAY

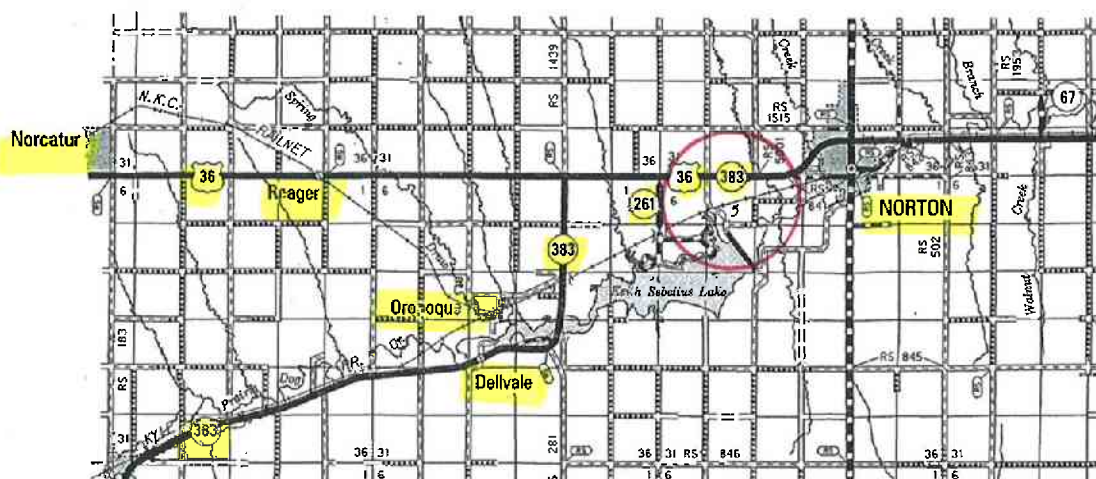

* Controlling data is based upon the best maps and photographs available to us and upon a regular section of land containing 640 acres.

* Approximate section lines were determined using the normal standard of care of oilfield surveyors practicing in the state of Kansas. The section corners, which establish the precise section lines, were not necessarily located, and the exact location of the drillsite location in the section is not guaranteed. Therefore, the operator securing this service and accepting this plot and all other parties relying thereon agree to hold Central Kansas Oilfield Services, Inc., its officers and employees harmless from all losses, costs and expenses and said entities released from any liability from incidental or consequential damages.

* Elevations derived from National Geodetic Vertical Datum.

Date August 31, 2016

CENTRAL KANSAS OILFIELD SERVICES, INC. (620)792-1977

* Ingress and egress to location as shown on this plot is for usage only and may not be legally opened for public use. Contact landowner, tenant and county road department for access.