



APPLICATION FOR COMMINGLING OF PRODUCTION (K.A.R. 82-3-123) OR FLUIDS (K.A.R. 82-3-123a) *Commingling ID # _____*

OPERATOR: License # _____ API No. 15 - _____
Name: _____ Spot Description: _____
Address 1: _____ - - - - - Sec. _____ Twp. _____ S. R. _____ East West
Address 2: _____ Feet from North / South Line of Section
City: _____ State: _____ Zip: _____ + _____ Feet from East / West Line of Section
Contact Person: _____ County: _____
Phone: (_____) _____ Lease Name: _____ Well #: _____

1. Name and upper and lower limit of each production interval to be commingled:
Formation: _____ (Perfs): _____
Formation: _____ (Perfs): _____
Formation: _____ (Perfs): _____
Formation: _____ (Perfs): _____
Formation: _____ (Perfs): _____

2. Estimated amount of fluid production to be commingled from each interval:
Formation: _____ BOPD: _____ MCFPD: _____ BWPD: _____
Formation: _____ BOPD: _____ MCFPD: _____ BWPD: _____
Formation: _____ BOPD: _____ MCFPD: _____ BWPD: _____
Formation: _____ BOPD: _____ MCFPD: _____ BWPD: _____
Formation: _____ BOPD: _____ MCFPD: _____ BWPD: _____

3. Plat map showing the location of the subject well, all other wells on the subject lease, and all wells on offsetting leases within a 1/2 mile radius of the subject well, and for each well the names and addresses of the lessee of record or operator.

4. Signed certificate showing service of the application and affidavit of publication as required in K.A.R. 82-3-135a.

For Commingling of PRODUCTION ONLY, include the following:

- 5. Wireline log of subject well. Previously Filed with ACO-1: Yes No
- 6. Complete Form ACO-1 (*Well Completion form*) for the subject well.

For Commingling of FLUIDS ONLY, include the following:

- 7. Well construction diagram of subject well.
- 8. Any available water chemistry data demonstrating the compatibility of the fluids to be commingled.

AFFIDAVIT: I am the affiant and hereby certify that to the best of my current information, knowledge and personal belief, this request for commingling is true and proper and I have no information or knowledge, which is inconsistent with the information supplied in this application.

Submitted Electronically

KCC Office Use Only
 Denied Approved
15-Day Periods Ends: _____
Approved By: _____ Date: _____

Protests may be filed by any party having a valid interest in the application. Protests must be in writing and comply with K.A.R. 82-3-135b and must be filed within 15 days of publication of the notice of application.

R 29 W

T
12
S

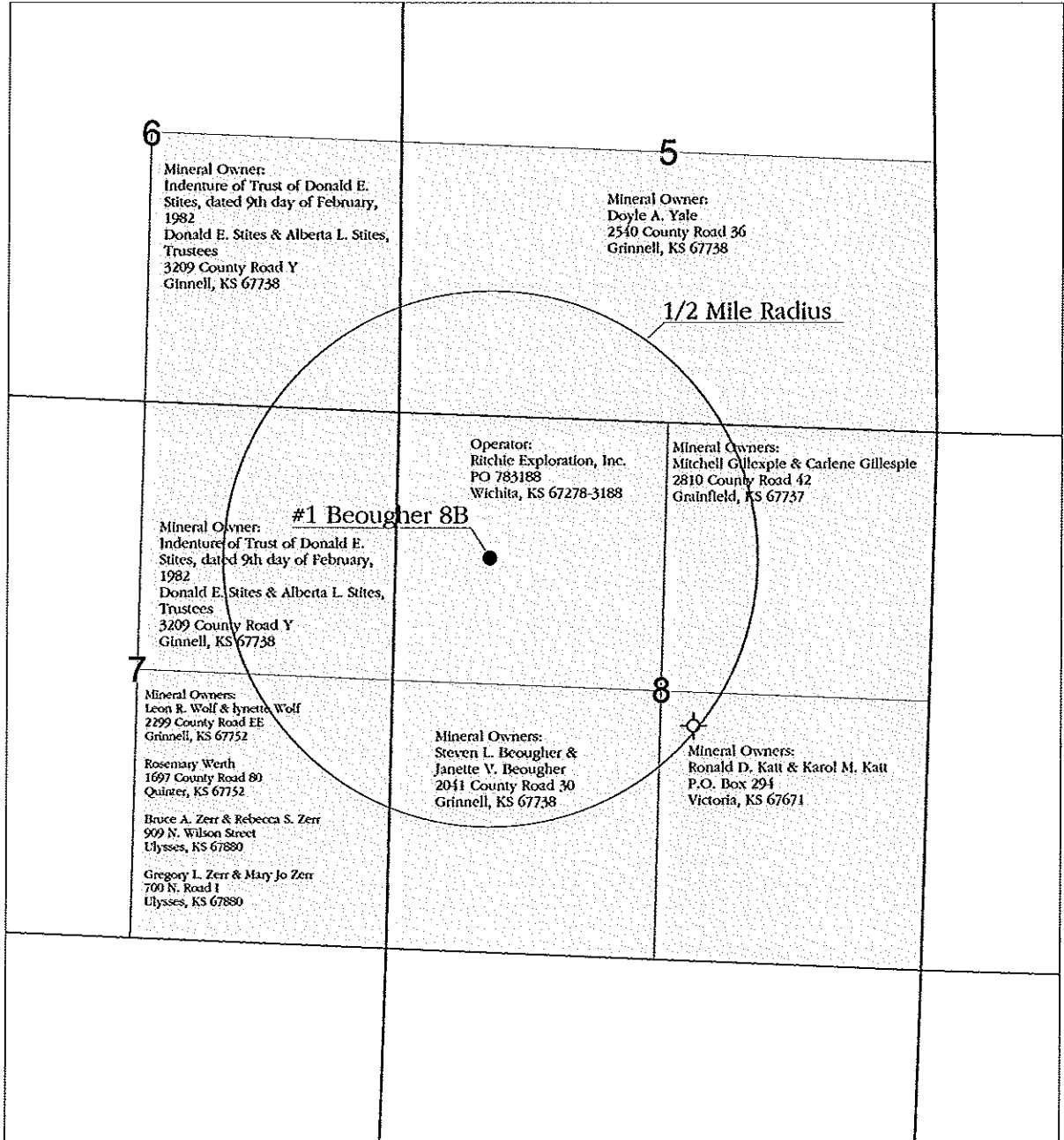

- Legend**
- Oil Well
 - Dry and Abandoned Well

 <p>RITCHIE EXPLORATION, INC. Wichita, Kansas</p>		<p>Application for Commingle of Production or Fluids</p>
<p>Applicant Well: #1 Beougher 8B All Wells on Offsetting Leases within 1/2 Mile Radius Name and Address of Lessee of Record or Operator On Offsetting Leases</p>		
<p>Gove County, Kansas</p>		
<p>Prepared By: Justin Clegg</p>	<p>Scale: 1 : 20,000</p>	<p>Date: October 18, 2016</p>

APPLICATION FOR COMMINGLING OF PRODUCTION OR FLUIDS

**Operator, Lessee or Unleased Mineral Owner
within a ½ mile radius of Ritchie Exploration, Inc.'s**

**#1 Beougher 8B
1400' FNL & 930' FWL
Section 8-12S-29W
Gove Co., KS**

Township 12 South, Range 29 West

Sec. 5:	S/2	Doyle A. Yale 2540 County Road 36 Grinnell, KS 67738	Mineral Owner
Sec. 6:	SE/4	Indenture of Trust of Donald E. Stites, dated the 9th day of February, 1982 Donald E. Stites & Alberta L. Stites, Trustees 3209 County Road Y Grinnell, KS 67738	Mineral Owner
Sec. 7:	NE/4	Indenture of Trust of Donald E. Stites, dated the 9th day of February, 1982 Donald E. Stites & Alberta L. Stites, Trustees 3209 County Road Y Grinnell, KS 67738	Mineral Owner
	SE/4	Leon R. Wolf & Lynette Wolf 2299 County Road EE Grinnell, KS 67738	Mineral Owners
		Rosemary Werth 1697 County Road 80 Quinter, KS 67752	Mineral Owner
		Bruce A. Zerr & Rebecca S. Zerr 909 N. Wilson Street Ulysses, KS 67880	Mineral Owners
		Gregory L. Zerr & Mary Jo Zerr 700 N. Road I Ulysses, KS 67880	Mineral Owners

Township 12 South, Range 29 West

Sec. 8:	NE/4	Mitchell Gillespie & Carlene Gillespie 2810 County Road 42 Grainfield, KS 67737	Mineral Owners
	NW/4	Ritchie Exploration, Inc. P.O. Box 783188 Wichita, KS 67278-3188	Operator: #1 Beougher 8B
	SW/4	Steven L. Beougher & Janette V. Beougher 2041 County Road 30 Grinnell, KS 67738	Mineral Owners
	SE/4	Ronald D. Katt & Karol M. Katt P.O. Box 294 Victoria, KS 67671	Mineral Owners

AFFIDAVIT

STATE OF KANSAS)
 - SS.
County of Sedgwick)

Peter Fiorini, of lawful age, being first duly sworn, deposeth and saith: That he is Production Manager of Ritchie Exploration, County of Sedgwick, State of Kansas, and that notice was given to all lessee of record or operator within ½ mile radius of the Beougher 8B #1 well located in the County of Gove (see attached plat map). This notice included a letter and a copy of the Commingle Application (ACO-4). All notices were mailed on October 28, 2016.

made as aforesaid on the 28th of

October A.D. 2016

And affiant further says that he has personal knowledge of the statements above set forth and that they are true.

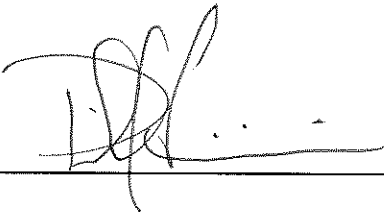

Subscribed and sworn to before me this

28th day of October 2016



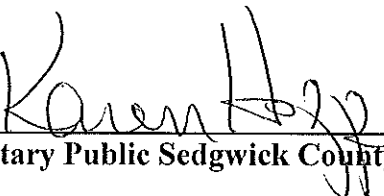

Notary Public Sedgwick County, Kansas

AFFIDAVIT OF PUBLICATION

State of Kansas,

Gove County, ss:

Roxanne Broeckelman,
being first duly sworn, deposes and
says: That she is
co-publisher of

Gove County Advocate, a weekly
newspaper printed in the State of
Kansas, and published in and of
general circulation in Gove County,
Kansas, with a general paid
circulation on a weekly basis in
Gove County, Kansas, and that said
newspaper is not a trade, religious
or fraternal publication.

Said newspaper is a weekly
published at least 50 times a year;
and has been so published
continuously and uninterruptedly in
said county and state for a period of
more than five years prior to the first
publication of said notice; and has
been admitted at the post office in
Quinter in said county as periodical
class mail matter.

That the attached notice is a true
copy thereof and was published in
the regular and entire issue of said
newspaper for one
consecutive week(s), the first
publication thereof being made as
aforesaid on the 9th day
of November, 2016,
with subsequent publications being
made on the following dates:

_____, _____
_____, _____
_____, _____
_____, _____
_____, _____
_____, _____
_____, _____

Printer's Fee\$ 19.20

Additional Copies\$ _____

Affidavit Fees\$ 2.00

Total Publication Fees \$ 21.20

Roxanne Broeckelman

Subscribed and sworn to before me
this 9th day of
November, 2016

Linda L. Zerr
Notary Public

My commission expires:
January 8, 2017

LEGAL ADVERTISING
(Published in the Gove County Advocate, Quinter,
KS, Wed., November 9, 2016 - 11)

LEGAL NOTICE

You, and each of you, are hereby notified that
Ritchie Exploration, Inc. has filed an application
to commence the commingling of production from
the Lansing/Kansas City, Pawnee, Myrick and
Fort Scott sources of supply for the #1 Beougher
8B well located approx. E/2 W/2 NW of Section
8-12S-29W, Gove County, Kansas.

Any persons who object to or protest this ap-
plication shall be required to file their objections
or protests with the Conservation Division of the
State Corporation Commission of the State of
Kansas within fifteen (15) days from the date of
the publication. These protests shall be filed pur-
suant to Commission regulations and must state
specific reasons why the grant of the application
may cause waste, violate correlative rights or pol-
lute the natural resources of the state of Kansas.
If no protests are received, this application may
be granted through a summary proceeding. If
valid protests are received, this matter will be set
for hearing.

All persons interested or concerned shall take
notice of the foregoing and shall govern them-
selves accordingly.

RITCHIE EXPLORATION, INC.
P.O. Box 783188
Wichita, KS 67278-3188
(316) 691-9500

LINDA L. ZERR
NOTARY PUBLIC
STATE OF KANSAS
My Appl. Exp. 1-8-2017



LEGAL PROOF OF PUBLICATION

Account #	Ad Number	Identification	PO	Amount	Cols	Lines
453699	0002760294	Published in the Wichita Eagle November 3, 2016		\$139.20	1	38

Attention: karen hopper

RITCHIE EXPLORATION INC
P O BOX 783188
WICHITA, KS 672783188

In The STATE OF KANSAS
In and for the County of Sedgwick
AFFIDAVIT OF PUBLICATION

1 Insertions

Beginning issue of: 11/03/2016

Ending issue of: 11/03/2016

STATE OF KANSAS)

.SS

County of Sedgwick)

LEGAL PUBLICATION

Published in the Wichita Eagle
November 3, 2016 (2760294)

LEGAL NOTICE

You, and each of you, are hereby notified that Ritchie Exploration, Inc. has filed an application to commence the commencing of production from the Lansing/Kansas City, Pawnee, Myrick and Fort Scott sources of supply for the #1 Brougher 6B well located approx. E/2 W/2 NW of Section 8-12S-29W, Gove County, Kansas.

Any persons who object to or protest this application shall be required to file their objections or protests with the Conservation Division of the State Corporation Commission of the State of Kansas within fifteen (15) days from the date of the publication. These protests shall be filed pursuant to Commission regulations and must state specific reasons why the grant of the application may cause waste, violate correlative rights or pollute the natural resources of the state of Kansas.

If no protests are received, this application may be granted through a summary proceeding. If valid protests are received, this matter will be set for hearing.

All persons interested or concerned shall take notice of the foregoing and shall govern themselves accordingly.

RITCHIE EXPLORATION, INC.
P.O. Box 783188
Wichita, KS 67278-3188
(316) 691-9900

Dale Seiwert, of lawful age, being first duly sworn, deposeseth and saith: That he is Record Clerk of The Wichita Eagle, a daily newspaper published in the City of Wichita, County of Sedgwick, State of Kansas, and having a general paid circulation on a daily basis in said County, which said newspaper has been continuously and uninterruptedly published in said County for more than one year prior to the first publication of the notice hereinafter mentioned, and which said newspaper has been entered as second class mail matter at the United States Post Office in Wichita, Kansas, and which said newspaper is not a trade, religious or fraternal publication and that a notice of a true copy is hereto attached was published in the regular and entire Morning issue of said The Wichita Eagle from 11/3/2016 to 11/03/2016.

I certify (or declare) under the penalty of perjury that the foregoing is true and correct.

(Signature of Principal Clerk)

DATED: 11/3/2016

Notary Public Sedgwick County, Kansas

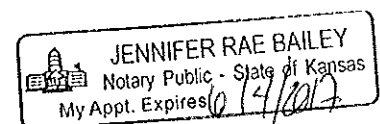



Confidentiality Requested:

Yes No

KANSAS CORPORATION COMMISSION 1234608
OIL & GAS CONSERVATION DIVISION

Form ACO-1

August 2013

Form must be Typed

Form must be Signed

All blanks must be Filled

CONFIDENTIAL WELL COMPLETION FORM

WELL HISTORY - DESCRIPTION OF WELL & LEASE

OPERATOR: License # 4767

Name: Ritchie Exploration, Inc.

Address 1: 8100 E 22ND ST N # 700

Address 2: BOX 783188

City: WICHITA State: KS Zip: 67278 + 3188

Contact Person: Peter Fiorini

Phone: (316) 691-9500

CONTRACTOR: License # 34082

Name: Alliance Well Service Inc.

Wellsite Geologist: Peter Fiorini

Purchaser: JP Energy

Designate Type of Completion:

- New Well
- Re-Entry
- Workover
- Oil
- Gas
- OG
- CM (Coal Bed Methane)
- Cathodic
- WSW
- D&A
- Other (Core, Expl., etc.): _____
- SWD
- ENHR
- GSW
- SIOW
- SIGW
- Temp. Abd.

If Workover/Re-entry: Old Well Info as follows:

Operator: Ritchie Exploration, Inc.

Well Name: Beougher 8B

Original Comp. Date: 2/20/2013 Original Total Depth: 4620

- Deepening
- Re-perf.
- Plug Back
- Conv. to ENHR
- Conv. to SWD
- Conv. to GSW
- Conv. to Producer
- Commingled
- Dual Completion
- SWD
- ENHR
- GSW
- Permit #: _____
- Permit #: _____
- Permit #: _____
- Permit #: _____

<u>11/12/2014</u>	<u>11/12/2014</u>	<u>11/19/2014</u>
Spud Date or Recompletion Date	Date Reached TD	Completion Date or Recompletion Date

API No. 15 - 15-063-22084-00-01

Spot Description: 80'N & 60'W of E2W2NW

E2_W2_NW Sec. 8 Twp. 12 S. R. 29 East West

1400 Feet from North / South Line of Section

930 Feet from East / West Line of Section

Footages Calculated from Nearest Outside Section Corner:

NE NW SE SW

GPS Location: Lat: _____, Long: _____
(e.g. xx.xxxxx) (e.g. -xxx.xxxxx)

Datum: NAD27 NAD83 WGS84

County: Gove

Lease Name: Beougher 8B Well #: 1

Field Name: _____

Producing Formation: LKC/Pawnee/Myrick/FortScott

Elevation: Ground: 2821 Kelly Bushing: 2826

Total Vertical Depth: 4620 Plug Back Total Depth: 4560

Amount of Surface Pipe Set and Cemented at: 255 Feet

Multiple Stage Cementing Collar Used? Yes No

If yes, show depth set: 2279 Feet

If Alternate II completion, cement circulated from: 0

feet depth to: 2279 w/ 500 sx cmt.

Drilling Fluid Management Plan

(Data must be collected from the Reserve Pit)

Chloride content: _____ ppm Fluid volume: _____ bbls

Dewatering method used: _____

Location of fluid disposal if hauled offsite: _____

Operator Name: _____

Lease Name: _____ License #: _____

Quarter _____ Sec. _____ Twp. _____ S. R. _____ East West

County: _____ Permit #: _____

AFFIDAVIT

I am the affiant and I hereby certify that all requirements of the statutes, rules and regulations promulgated to regulate the oil and gas industry have been fully complied with and the statements herein are complete and correct to the best of my knowledge.

Submitted Electronically

KCC Office Use ONLY

Confidentiality Requested

Date: 12/11/2014

Confidential Release Date: _____

Wireline Log Received

Geologist Report Received

UIC Distribution

ALT I II III Approved by: NAOMI JAMES Date: 12/11/2014



1234608

Operator Name: Ritchie Exploration, Inc. Lease Name: Beougher 8B Well #: 1
 Sec. 8 Twp. 12 S. R. 29 East West County: Gove

INSTRUCTIONS: Show important tops of formations penetrated. Detail all cores. Report all final copies of drill stems tests giving interval tested, time tool open and closed, flowing and shut-in pressures, whether shut-in pressure reached static level, hydrostatic pressures, bottom hole temperature, fluid recovery, and flow rates if gas to surface test, along with final chart(s). Attach extra sheet if more space is needed.

Final Radioactivity Log, Final Logs run to obtain Geophysical Data and Final Electric Logs must be emailed to kcc-well-logs@kcc.ks.gov. Digital electronic log files must be submitted in LAS version 2.0 or newer AND an image file (TIFF or PDF).

Drill Stem Tests Taken <input type="checkbox"/> Yes <input checked="" type="checkbox"/> No <i>(Attach Additional Sheets)</i> Samples Sent to Geological Survey <input type="checkbox"/> Yes <input checked="" type="checkbox"/> No Cores Taken <input type="checkbox"/> Yes <input checked="" type="checkbox"/> No Electric Log Run <input type="checkbox"/> Yes <input checked="" type="checkbox"/> No List All E. Logs Run:	<input type="checkbox"/> Log Formation (Top), Depth and Datum <input checked="" type="checkbox"/> Sample Name Attached Top Attached Datum Attached
--	---

CASING RECORD <input checked="" type="checkbox"/> New <input type="checkbox"/> Used							
Report all strings set-conductor, surface, intermediate, production, etc.							
Purpose of String	Size Hole Drilled	Size Casing Set (In O.D.)	Weight Lbs. / Ft.	Setting Depth	Type of Cement	# Sacks Used	Type and Percent Additives
Surface	12.25	8.625	23	255	Common	165	3% cc, 2% gel
Production	7.875	4.5	10.5	4605	ASC	225	10% sa't, 2% gel & 5#/sx g/lson/te

ADDITIONAL CEMENTING / SQUEEZE RECORD				
Purpose:	Depth Top Bottom	Type of Cement	# Sacks Used	Type and Percent Additives
<input type="checkbox"/> Perforate				
<input type="checkbox"/> Protect Casing	-			
<input type="checkbox"/> Plug Back TD				
<input type="checkbox"/> Plug Off Zone	-			

Did you perform a hydraulic fracturing treatment on this well? Yes No *(If No, skip questions 2 and 3)*
 Does the volume of the total base fluid of the hydraulic fracturing treatment exceed 350,000 gallons? Yes No *(If No, skip question 3)*
 Was the hydraulic fracturing treatment information submitted to the chemical disclosure registry? Yes No *(If No, fill out Page Three of the ACO-1)*

Shots Per Foot	PERFORATION RECORD - Bridge Plugs Set/Type Specify Footage of Each Interval Perforated	Acid, Fracture, Shot, Cement Squeeze Record <i>(Amount and Kind of Material Used)</i>	Depth
4	4392-4398	500 Gals 15% NE Acid	
4	4365.5-4368.5	500 Gals 15% NE Acid	
4	4180-4186	500 Gals 15% NE Acid	

TUBING RECORD: Size: 2.375 Set At: 4528 Packer At: Liner Run: Yes No

Date of First, Resumed Production, SWD or ENHR: 11/19/2014
 Producing Method: Flowing Pumping Gas Lift Other *(Explain)* _____
 Estimated Production Per 24 Hours: Oil 13.36 Bbls. Gas Mcf Water 15.03 Bbls. Gas-Oil Ratio Gravity 35

DISPOSITION OF GAS: <input type="checkbox"/> Vented <input type="checkbox"/> Sold <input type="checkbox"/> Used on Lease <i>(If vented, Submit ACO-18.)</i>	METHOD OF COMPLETION: <input type="checkbox"/> Open Hole <input checked="" type="checkbox"/> Perf. <input type="checkbox"/> Dually Comp. <input checked="" type="checkbox"/> Commingled <i>(Submit ACO-5) (Submit ACO-4)</i> <input type="checkbox"/> Other <i>(Specify)</i> _____	PRODUCTION INTERVAL: _____ _____
---	---	--

Form	ACO1 - Well Completion
Operator	Ritchie Exploration, Inc.
Well Name	Beougher 8B 1
Doc ID	1234608

Tops

Name	Top	Datum
Anhydrite	2306	+520
B/Anhydrite	2337	+489
Stotler	3514	-688
Heebner	3874	-1048
Lansing	3920	-1094
Muncie Shale	4048	-1222
Stark Shale	4137	-1311
Hush	4166	-1340
BKC	4193	-1367
Marmaton	4217	-1391
Altamont	4233	-1407
Pawnee	4309	-1483
Myrick	4355	-1529
Fort Scott	4386	-1560
Cherokee Shale	4414	-1588
Mississippian	4494	-1668

Conservation Division
266 N. Main St., Ste. 220
Wichita, KS 67202-1513



Phone: 316-337-6200
Fax: 316-337-6211
<http://kcc.ks.gov/>

Jay Scott Emler, Chairman
Shari Feist Albrecht, Commissioner
Pat Apple, Commissioner

Sam Brownback, Governor

November 28, 2016

Peter Fiorini
Ritchie Exploration, Inc.
P.O. Box 783188
Wichita, KS 67278-3188

RE: Approved Commingling CO111603
Beougher 8B1
API No. 15-063-22084-00-01

Dear Mr. Fiorini:

Your Application for Commingling (ACO-4) for the above described well has been reviewed and approved by the Kansas Corporation Commission (KCC) per K.A.R. 82-3-123. Notice was examined and found to be proper per K.A.R. 82-3-135a. No protest had been filed within the 15-day protest period.

Based upon the depth of the Fort Scott formation perforations, total oil production shall not exceed 200 BOPD and total gas production shall not exceed 50% of the absolute open flow (AOF).

Sincerely,

Rick Hestermann
Production Department