

MID-CONTINENT ENERGY CORPORATION  
 WHITE LEASE  
 SW.1/4, SECTION 8, T16S, R10W  
 ELLSWORTH COUNTY, KANSAS

GRAVEL (AVENUE N) ROAD

Notes:

1. Tied out cellar on existing drillsite pad.
2. All flagging Red & Yellow.
3. Overhead power available at N., E. & W. lines, Sec. 8.
4. Kansas One Call System Inc. should be notified before excavation (1-800-344-7233).
5. CAUTION; Various pipelines in Sec. 8.
6. Contact landowner for best access.

ROAD (2ND ROAD)  
 GRAVEL

(2ND ROAD)

GRAVEL

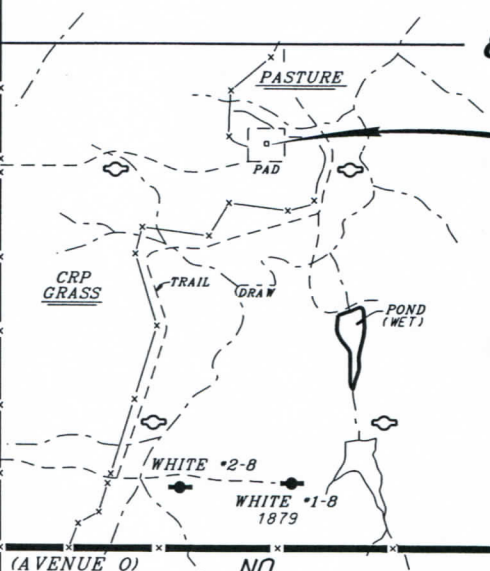

8

(Revised)  
 Drillsite Location  
 White "B" #3  
 2115'FSL 1460'FWL  
 Ground Elevation = 1851  
 Y = 123966 X = 1869686  
 State Plane-NAD 27-Kansas North  
 Latitude 38.672849  
 Longitude -98.456690  
 WGS 84-NAD 83

ROAD (3RD ROAD)  
 GRAVEL

(AVENUE O) NO ROAD

\*Ingress and egress to location as shown on this plot is per usage only and may not be legally opened for public use. Contact landowner, tenant and county road department for access.

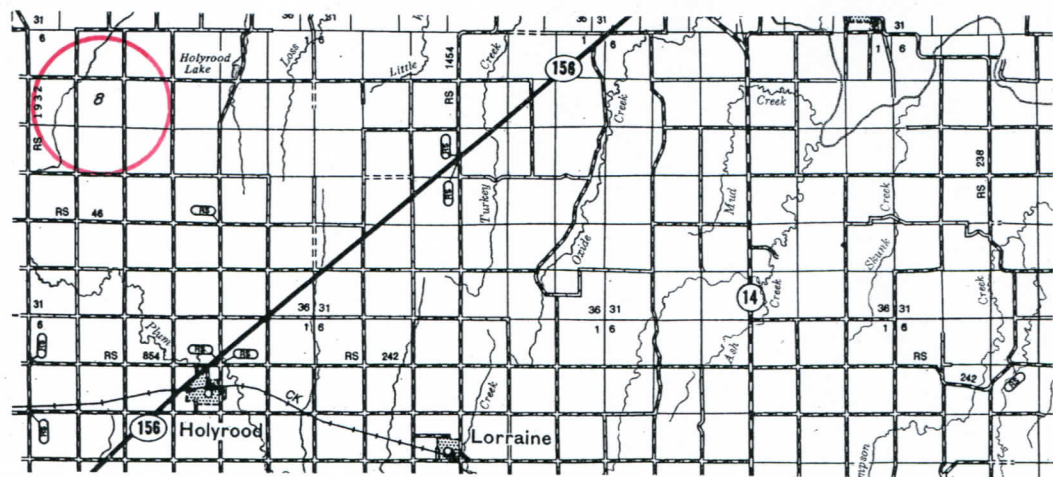

\* Controlling data is based upon the best maps and photographs available to us and upon a regular section of land containing 640 acres.  
 \* Approximate section lines were determined using the normal standard of care of oilfield surveyors practicing in the state of Kansas. The section corners, which establish the precise section lines, were not necessarily located, and the exact location of the drillsite location in the section is not guaranteed. Therefore, the operator securing this service and accepting this plot and all other parties relying thereon agree to hold Central Kansas Oilfield Services, Inc., its officers and employees harmless from all losses, costs and expenses and said entities released from any liability from incidental or consequential damages.  
 \* Elevations derived from National Geodetic Vertical Datum.

Date January 6, 2017