

Proposed Plan of Construction
 Charles 12-1
 Sec 12 T27S-R34W
 Grant County, KS

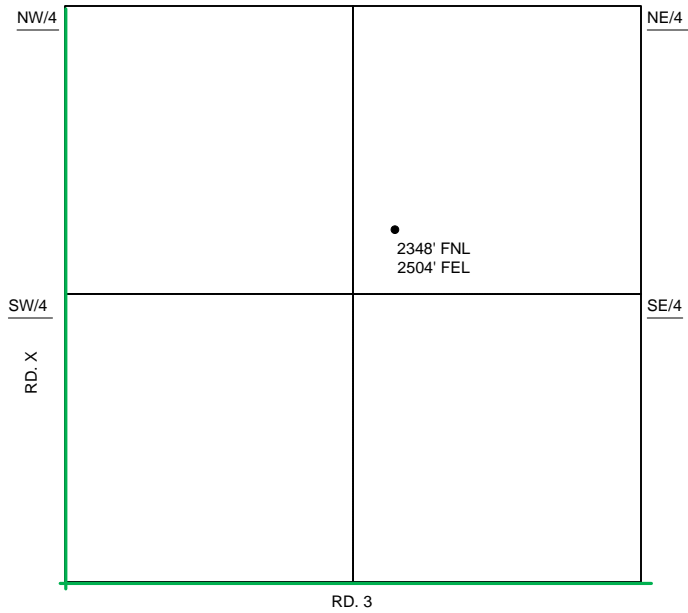

Sec 12 - T27S - R34W

The Tank Battery for the Charles 12-1 IS located NW of the well (Existing Lottie Tank Battery NW/4 Sec 12 - T27S - R35W).



The Tank Battery for the Frank D-1 is located in the NE of the NE quarter

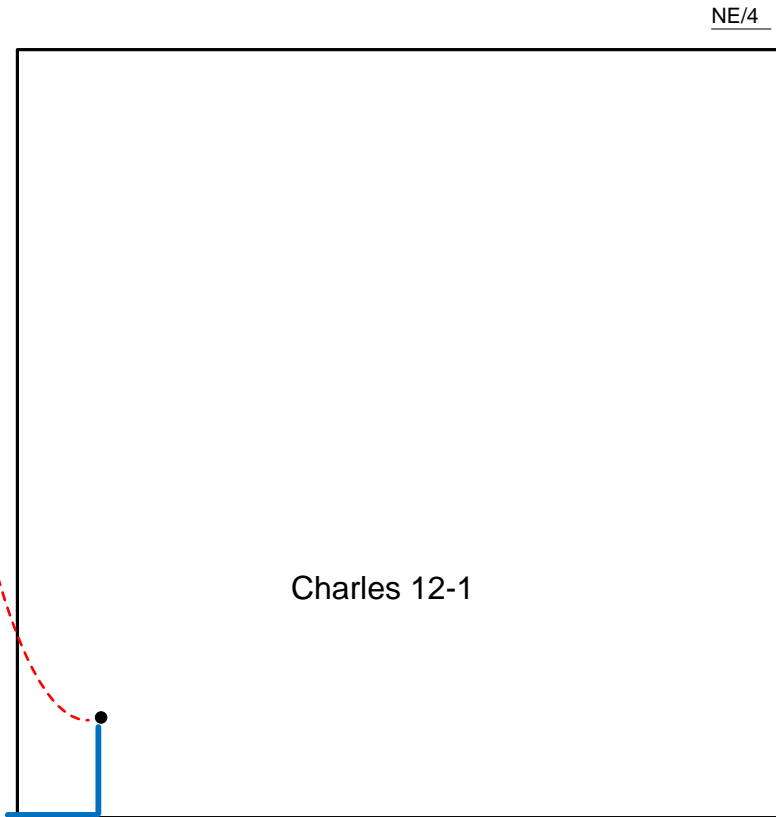

Proposed Details of
 NE/4 Sec 12 -T27S -R35W

Note-Drawing **Not** to Scale