

Proposed Plan of Construction

Crossbow 3-11
Sec 11 T29S-R38W
Grant County, KS

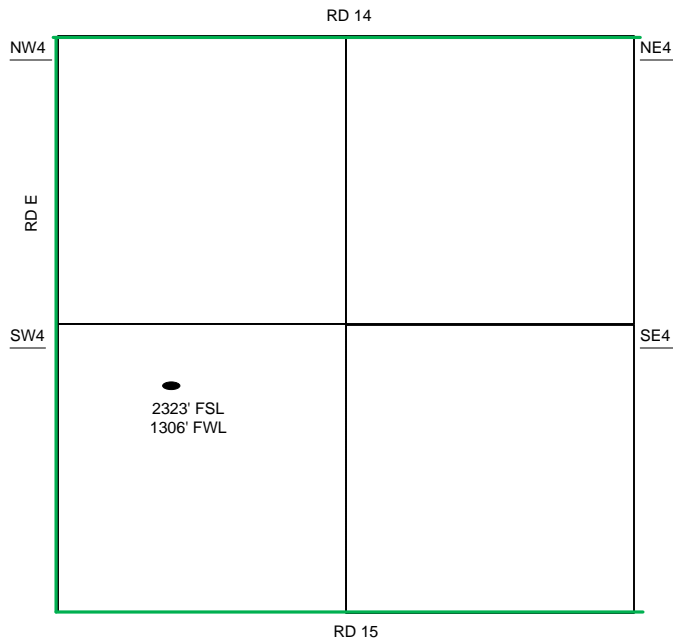

The Tank Battery for the Crossbow 3-11 will be located NW of the SW/4



Sec 11 - T29S - R38W

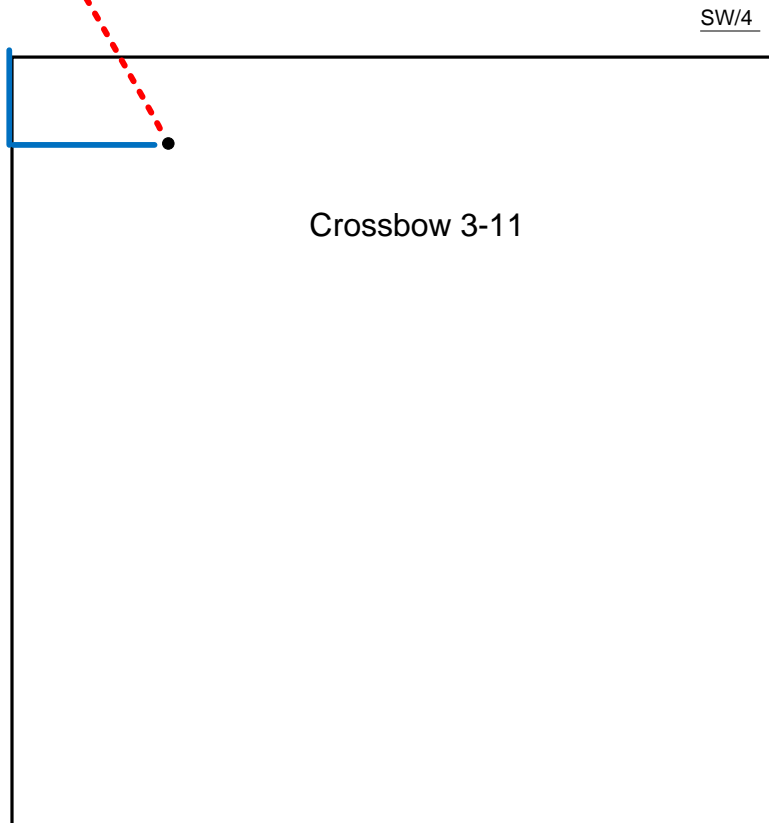

- Well Location
- Proposed Lease Roads
- - - Proposed Pipeline
- Proposed Tank Battery
- Proposed Power Lines
- - - Existing Pipeline

Proposed Details of
SW/4 Sec 11 - T29S - R38W

Proposed Site Diagram
Crossbow 3-11
March 14, 2016

Note-Drawing **Not** to Scale