

For KCC Use:
Effective Date: _____
District # _____
SGA? Yes No

KANSAS CORPORATION COMMISSION 1350294
OIL & GAS CONSERVATION DIVISION

Form C-1
March 2010

Form must be Typed
Form must be Signed
All blanks must be Filled

NOTICE OF INTENT TO DRILL

Must be approved by KCC five (5) days prior to commencing well

Form KSONA-1, Certification of Compliance with the Kansas Surface Owner Notification Act, MUST be submitted with this form.

Expected Spud Date: _____
month day year

OPERATOR: License# _____
Name: _____
Address 1: _____
Address 2: _____
City: _____ State: _____ Zip: _____ + _____
Contact Person: _____
Phone: _____

CONTRACTOR: License# _____
Name: _____

Well Drilled For:	Well Class:	Type Equipment:
<input type="checkbox"/> Oil	<input type="checkbox"/> Enh Rec	<input type="checkbox"/> Infield
<input type="checkbox"/> Gas	<input type="checkbox"/> Storage	<input type="checkbox"/> Pool Ext.
	<input type="checkbox"/> Disposal	<input type="checkbox"/> Wildcat
<input type="checkbox"/> Seismic ; _____ # of Holes	<input type="checkbox"/> Other	<input type="checkbox"/> Mud Rotary
<input type="checkbox"/> Other: _____		<input type="checkbox"/> Air Rotary
		<input type="checkbox"/> Cable

If OWWO: old well information as follows:

Operator: _____
Well Name: _____
Original Completion Date: _____ Original Total Depth: _____

Directional, Deviated or Horizontal wellbore? Yes No
If Yes, true vertical depth: _____
Bottom Hole Location: _____
KCC DKT #: _____

Spot Description: _____
_____ - _____ - _____ Sec. _____ Twp. _____ S. R. _____ E W
(Q/Q/Q/Q) _____ feet from N / S Line of Section
_____ feet from E / W Line of Section
Is SECTION: Regular Irregular?

(Note: Locate well on the Section Plat on reverse side)

County: _____
Lease Name: _____ Well #: _____
Field Name: _____
Is this a Prorated / Spaced Field? Yes No
Target Formation(s): _____
Nearest Lease or unit boundary line (in footage): _____
Ground Surface Elevation: _____ feet MSL
Water well within one-quarter mile: Yes No
Public water supply well within one mile: Yes No
Depth to bottom of fresh water: _____
Depth to bottom of usable water: _____
Surface Pipe by Alternate: I II
Length of Surface Pipe Planned to be set: _____
Length of Conductor Pipe (if any): _____
Projected Total Depth: _____
Formation at Total Depth: _____
Water Source for Drilling Operations:
 Well Farm Pond Other: _____
DWR Permit #: _____
(Note: Apply for Permit with DWR)
Will Cores be taken? Yes No
If Yes, proposed zone: _____

AFFIDAVIT

The undersigned hereby affirms that the drilling, completion and eventual plugging of this well will comply with K.S.A. 55 et. seq.

It is agreed that the following minimum requirements will be met:

1. Notify the appropriate district office **prior** to spudding of well;
2. A copy of the approved notice of intent to drill **shall be** posted on each drilling rig;
3. The minimum amount of surface pipe as specified below **shall be set** by circulating cement to the top; in all cases surface pipe **shall be set** through all unconsolidated materials plus a minimum of 20 feet into the underlying formation.
4. If the well is dry hole, an agreement between the operator and the district office on plug length and placement is necessary **prior to plugging**;
5. The appropriate district office will be notified before well is either plugged or production casing is cemented in;
6. If an ALTERNATE II COMPLETION, production pipe shall be cemented from below any usable water to surface within **120 DAYS** of spud date. Or pursuant to Appendix "B" - Eastern Kansas surface casing order #133,891-C, which applies to the KCC District 3 area, alternate II cementing must be completed within 30 days of the spud date or the well shall be plugged. **In all cases, NOTIFY district office** prior to any cementing.

Submitted Electronically

<p>For KCC Use ONLY</p> <p>API # 15 - _____</p> <p>Conductor pipe required _____ feet</p> <p>Minimum surface pipe required _____ feet per ALT. <input type="checkbox"/> I <input type="checkbox"/> II</p> <p>Approved by: _____</p> <p>This authorization expires: _____ (This authorization void if drilling not started within 12 months of approval date.)</p> <p>Spud date: _____ Agent: _____</p>
--

Remember to:

- File Certification of Compliance with the Kansas Surface Owner Notification Act (KSONA-1) with Intent to Drill;
- File Drill Pit Application (form CDP-1) with Intent to Drill;
- File Completion Form ACO-1 within 120 days of spud date;
- File acreage attribution plat according to field proration orders;
- Notify appropriate district office 48 hours prior to workover or re-entry;
- Submit plugging report (CP-4) after plugging is completed (within 60 days);
- Obtain written approval before disposing or injecting salt water.
- If well will not be drilled or permit has expired (See: authorized expiration date) please check the box below and return to the address below.

Well will not be drilled or Permit Expired Date: _____
Signature of Operator or Agent:

E
 W

For KCC Use ONLY

API # 15 - _____

IN ALL CASES PLOT THE INTENDED WELL ON THE PLAT BELOW

In all cases, please fully complete this side of the form. Include items 1 through 5 at the bottom of this page.

Operator: _____

Lease: _____

Well Number: _____

Field: _____

Number of Acres attributable to well: _____

QTR/QTR/QTR/QTR of acreage: _____ - _____ - _____ - _____

Location of Well: County: _____

_____ feet from N / S Line of Section

_____ feet from E / W Line of Section

Sec. _____ Twp. _____ S. R. _____ E W

Is Section: Regular or Irregular

If Section is Irregular, locate well from nearest corner boundary.

Section corner used: NE NW SE SW

PLAT

Show location of the well. Show footage to the nearest lease or unit boundary line. Show the predicted locations of lease roads, tank batteries, pipelines and electrical lines, as required by the Kansas Surface Owner Notice Act (House Bill 2032). You may attach a separate plat if desired.

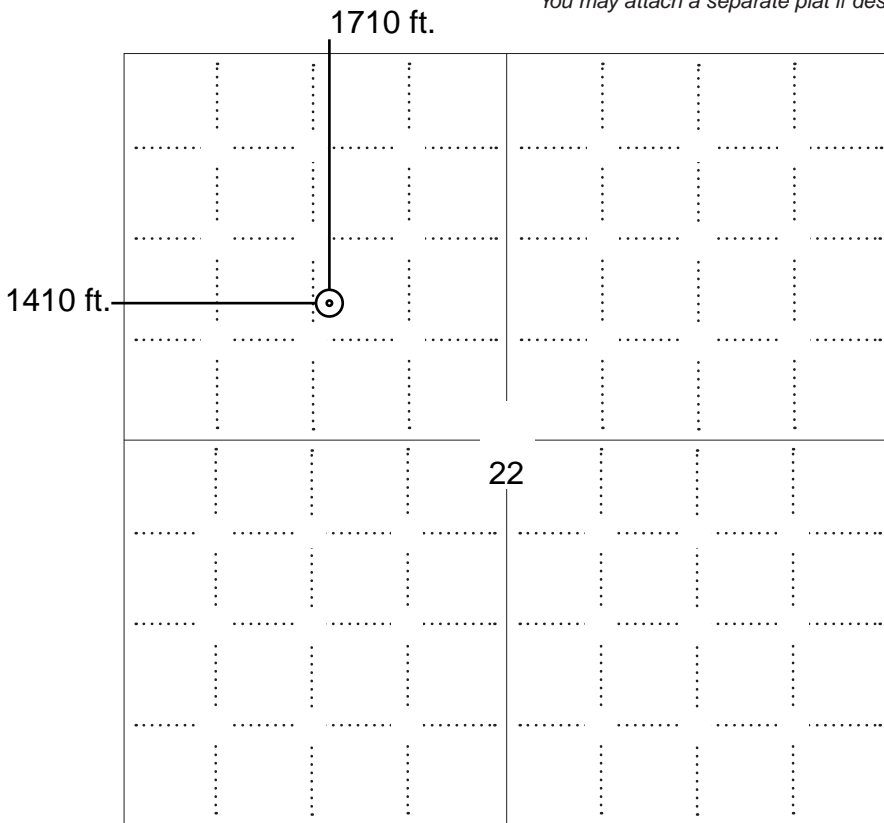

LEGEND

- Well Location
- Tank Battery Location
- Pipeline Location
- Electric Line Location
- Lease Road Location



NOTE: In all cases locate the spot of the proposed drilling locaton.

In plotting the proposed location of the well, you must show:

1. The manner in which you are using the depicted plat by identifying section lines, i.e. 1 section, 1 section with 8 surrounding sections, 4 sections, etc.
2. The distance of the proposed drilling location from the south / north and east / west outside section lines.
3. The distance to the nearest lease or unit boundary line (in footage).
4. If proposed location is located within a prorated or spaced field a certificate of acreage attribution plat must be attached: (C0-7 for oil wells; CG-8 for gas wells).
5. The predicted locations of lease roads, tank batteries, pipelines, and electrical lines.

APPLICATION FOR SURFACE PIT

Submit in Duplicate

Operator Name: _____		License Number: _____	
Operator Address: _____			
Contact Person: _____		Phone Number: _____	
Lease Name & Well No.: _____		Pit Location (QQQQ): _____-_____-_____-_____	
Type of Pit: <input type="checkbox"/> Emergency Pit <input type="checkbox"/> Burn Pit <input type="checkbox"/> Settling Pit <input type="checkbox"/> Drilling Pit <input type="checkbox"/> Workover Pit <input type="checkbox"/> Haul-Off Pit <i>(If WP Supply API No. or Year Drilled)</i>		Pit is: <input type="checkbox"/> Proposed <input type="checkbox"/> Existing If Existing, date constructed: _____ Pit capacity: _____ (bbls)	
Is the pit located in a Sensitive Ground Water Area? <input type="checkbox"/> Yes <input type="checkbox"/> No		Chloride concentration: _____ mg/l <i>(For Emergency Pits and Settling Pits only)</i>	
Is the bottom below ground level? <input type="checkbox"/> Yes <input type="checkbox"/> No		Artificial Liner? <input type="checkbox"/> Yes <input type="checkbox"/> No	
How is the pit lined if a plastic liner is not used?		_____	
Pit dimensions (all but working pits): _____ Length (feet) _____ Width (feet) <input type="checkbox"/> N/A: Steel Pits Depth from ground level to deepest point: _____ (feet) <input type="checkbox"/> No Pit			
If the pit is lined give a brief description of the liner material, thickness and installation procedure.		Describe procedures for periodic maintenance and determining liner integrity, including any special monitoring.	
Distance to nearest water well within one-mile of pit: _____ feet Depth of water well _____ feet		Depth to shallowest fresh water _____ feet. Source of information: <input type="checkbox"/> measured <input type="checkbox"/> well owner <input type="checkbox"/> electric log <input type="checkbox"/> KDWR	
Emergency, Settling and Burn Pits ONLY: Producing Formation: _____ Number of producing wells on lease: _____ Barrels of fluid produced daily: _____ Does the slope from the tank battery allow all spilled fluids to flow into the pit? <input type="checkbox"/> Yes <input type="checkbox"/> No		Drilling, Workover and Haul-Off Pits ONLY: Type of material utilized in drilling/workover: _____ Number of working pits to be utilized: _____ Abandonment procedure: _____ _____ Drill pits must be closed within 365 days of spud date.	
Submitted Electronically			

KCC OFFICE USE ONLY

Liner Steel Pit RFAC RFAS

Date Received: _____ Permit Number: _____ Permit Date: _____ Lease Inspection: Yes No

CERTIFICATION OF COMPLIANCE WITH THE KANSAS SURFACE OWNER NOTIFICATION ACT

This form must be submitted with all Forms C-1 (Notice of Intent to Drill); CB-1 (Cathodic Protection Borehole Intent); T-1 (Request for Change of Operator Transfer of Injection or Surface Pit Permit); and CP-1 (Well Plugging Application). Any such form submitted without an accompanying Form KSONA-1 will be returned.

Select the corresponding form being filed: C-1 (Intent) CB-1 (Cathodic Protection Borehole Intent) T-1 (Transfer) CP-1 (Plugging Application)

OPERATOR: License # _____
Name: _____
Address 1: _____
Address 2: _____
City: _____ State: _____ Zip: _____ + _____
Contact Person: _____
Phone: (_____) _____ Fax: (_____) _____
Email Address: _____

Well Location:
____ - ____ - ____ - ____ Sec. ____ Twp. ____ S. R. ____ East West
County: _____
Lease Name: _____ Well #: _____

If filing a Form T-1 for multiple wells on a lease, enter the legal description of the lease below:

Surface Owner Information:

Name: _____
Address 1: _____
Address 2: _____
City: _____ State: _____ Zip: _____ + _____

When filing a Form T-1 involving multiple surface owners, attach an additional sheet listing all of the information to the left for each surface owner. Surface owner information can be found in the records of the register of deeds for the county, and in the real estate property tax records of the county treasurer.

If this form is being submitted with a Form C-1 (Intent) or CB-1 (Cathodic Protection Borehole Intent), you must supply the surface owners and the KCC with a plat showing the predicted locations of lease roads, tank batteries, pipelines, and electrical lines. The locations shown on the plat are preliminary non-binding estimates. The locations may be entered on the Form C-1 plat, Form CB-1 plat, or a separate plat may be submitted.

Select one of the following:

- I certify that, pursuant to the Kansas Surface Owner Notice Act (House Bill 2032), I have provided the following to the surface owner(s) of the land upon which the subject well is or will be located: 1) a copy of the Form C-1, Form CB-1, Form T-1, or Form CP-1 that I am filing in connection with this form; 2) if the form being filed is a Form C-1 or Form CB-1, the plat(s) required by this form; and 3) my operator name, address, phone number, fax, and email address.
- I have not provided this information to the surface owner(s). I acknowledge that, because I have not provided this information, the KCC will be required to send this information to the surface owner(s). To mitigate the additional cost of the KCC performing this task, I acknowledge that I must provide the name and address of the surface owner by filling out the top section of this form and that I am being charged a \$30.00 handling fee, payable to the KCC, which is enclosed with this form.

If choosing the second option, submit payment of the \$30.00 handling fee with this form. If the fee is not received with this form, the KSONA-1 form and the associated Form C-1, Form CB-1, Form T-1, or Form CP-1 will be returned.

I Submitted Electronically

GARTH UNIT #1

Township: 6

Range: 20

County: ROOKS

State: KANSAS

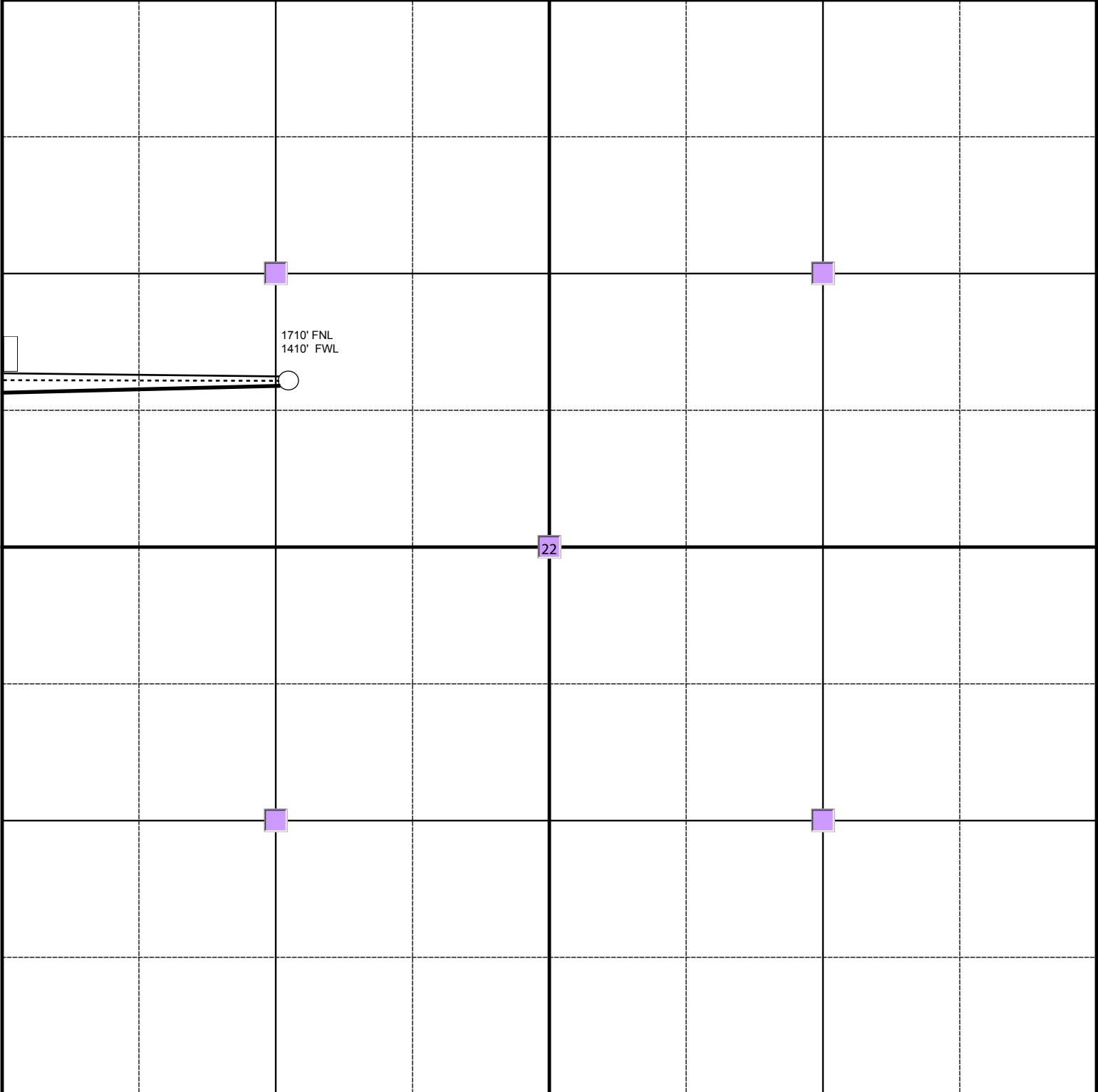

Tank Battery

Road

Pipeline

Electric Line

DECLARATION OF UNITIZATION

(Garth #1 Unit)

THIS DECLARATION OF UNITIZATION is made this 20th day of September, 2016, by JASPAR CO., (hereinafter "Lessee"), WITNESSETH:

WHEREAS, the parties hereto desire the Oil and Gas Leases shown on Exhibit A, attached hereto and incorporated herein by reference, be consolidated and unitized into one operating unit according to, and in compliance with, the Rules and Regulations of the Kansas Corporation Commission.

AND WHEREAS, the Lessors of the **Clark Leases** covering the W $\frac{1}{2}$ NW $\frac{1}{4}$ Sec. 22-6-20 and the **Gartrell Lease** covering the E $\frac{1}{2}$ NW $\frac{1}{4}$ Sec. 22-6-20 have previously authorized Lessee to pool and unitize said lease so that each Lessor would receive pro rata division of all royalties from the sale of oil or gas or either of them produced from the Unitized Area in the proportion that each Lessor's mineral interest bears to the total minerals within the Unitized Area as set forth in Exhibit A.

NOW, THEREFORE, in consideration of these premises and of the mutual benefits hereinafter contained, Lessee does hereby pool and unitize the oil and gas leases set forth in Exhibit A in accordance with the following terms and conditions:

1. By virtue of the power and authority granted by each landowner/lessor to the Lessee, Lessee declares for all purposes that the oil and gas leases set forth in Exhibit A are pooled and unitized forming the Unitized Area described therein. The Unitized Area shall be developed and operated as one leased tract regardless of how the same or the minerals thereunder may be divided in ownership, just as though such Unitized Area had originally been covered by a single oil and gas lease. The oil, gas or either of them in, under or produced from said Unitized Area is pooled and unitized and shall be treated as an entirety and the royalties thereon shall be paid ratably to the owners of each particular tract in such Unitized Area in accordance with Exhibit A and as their interest in each such particular tract may appear and according to the applicable royalty provisions and other terms of the oil and gas lease covering that particular tract.

2. Exhibit A sets forth and establishes the total acreage owned by each Lessor. Royalty, overriding royalty, and working interest payments will be based upon the decimal interest in production from said Unitized Area as is also shown thereon and on the Division Order when issued.

3. Any oil or gas well producing in commercial quantities under the terms of this agreement, or the oil and gas leases subject to this agreement, shall be deemed to be drilled under the terms of and located on the lands covered by each of said oil and gas lease and operations for the drilling, reworking of or production of all oil or gas from any such well or wells shall operate to keep in force the entire oil and gas leasehold estate

Page 1 of 2

Received for record at 9:00 o'clock A M. on 26 day
 State of Kansas) Oct. 20 16, and recorded in Book 480 of _____
 Rooks County) Records at Page 270
 Register of Deeds Rosalie Sprack

EXHIBIT A

UNIT AREA
(Garth #1 Unit)

A TRACT IN THE NORTHWEST QUARTER (NW $\frac{1}{4}$) OF SECTION 22, TOWNSHIP 6 SOUTH, RANGE 20 WEST OF THE SIXTH P.M., Rooks County, Kansas, Beginning 750 feet East and 270 feet North of the Southwest Corner of said NW $\frac{1}{4}$, thence North 1,320 feet, thence East 1,320 feet, thence South 1,320 feet, thence West 1,320 feet to the place of beginning.

OIL AND GAS LEASES POOLED AND UNITIZED

CLARK LEASES

Oil and Gas Lease dated May 28, 2015, recorded in Book 470, pages 105-6, from Barbara R. Clark, widow, Lessor, to and in favor of JASPAR CO., **ONLY IN SO FAR AS** said lease covers the land described below.

A TRACT IN THE WEST HALF OF THE NORTHWEST QUARTER (W $\frac{1}{2}$ NW $\frac{1}{4}$) OF SECTION 22, TOWNSHIP 6 SOUTH, RANGE 20 WEST OF THE SIXTH P.M., Rooks County, Kansas, Beginning 270 feet North of the Southeast Corner of the W $\frac{1}{2}$ NW $\frac{1}{4}$ Sec. 22-6-20, thence North 1,320 feet, thence West 570 feet, thence South 1,320 feet, thence East 750 feet to the place of beginning.

Oil and Gas Lease dated May 28, 2015, recorded in Book 469, pages 275-6, from Susan K. Thayer and Kevin L. Thayer, her husband, Lessors, to and in favor of JASPAR CO., **ONLY IN SO FAR AS** said lease covers the land described below.

A TRACT IN THE WEST HALF OF THE NORTHWEST QUARTER (W $\frac{1}{2}$ NW $\frac{1}{4}$) OF SECTION 22, TOWNSHIP 6 SOUTH, RANGE 20 WEST OF THE SIXTH P.M., Rooks County, Kansas, Beginning 270 feet North of the Southeast Corner of the W $\frac{1}{2}$ NW $\frac{1}{4}$ Sec. 22-6-20, thence North 1,320 feet, thence West 570 feet, thence South 1,320 feet, thence East 750 feet to the place of beginning.

Oil and Gas Lease dated May 28, 2015, recorded in Book 470, pages 103-4, from Gregory A. Gartrell and Susan R. Gartrell, his wife, Lessors, to and in favor of JASPAR CO., **ONLY IN SO FAR AS** said lease covers the land described below.

A TRACT IN THE WEST HALF OF THE NORTHWEST QUARTER (W $\frac{1}{2}$ NW $\frac{1}{4}$) OF SECTION 22, TOWNSHIP 6 SOUTH, RANGE 20 WEST OF

Handwritten signature or mark at the bottom of the page.

THE SIXTH P.M., Rooks County, Kansas, Beginning 270 feet North of the Southeast Corner of the W $\frac{1}{2}$ NW $\frac{1}{4}$ Sec. 22-6-20, thence North 1,320 feet, thence West 570 feet, thence South 1,320 feet, thence East 750 feet to the place of beginning.

GARTRELL LEASE

Oil and Gas Lease dated May 28, 2015, recorded in Book 470, pages 101-2, from Gregory A. Gartrell and Susan R. Gartrell, his wife, Lessors, to and in favor of JASPAR, Co., **ONLY IN SO FAR AS** said lease covers the land described below.

A TRACT IN THE EAST HALF OF THE NORTHWEST QUARTER (E $\frac{1}{2}$ NW $\frac{1}{4}$) OF SECTION 22, TOWNSHIP 6 SOUTH, RANGE 20 WEST OF THE SIXTH P.M., Rooks County, Kansas, Beginning 270 feet North of the Southwest Corner of the E $\frac{1}{2}$ NW $\frac{1}{4}$ Sec. 22-6-20, thence North 1,320 feet, thence East 750 feet, thence South 1,320 feet, thence West 750 feet to the place of beginning.

TRACT PARTICIPATION

Each of the above tracts will participate in the production of oil, gas and other minerals proportionately based on square footage contribution to the from the Unit Area with the Clark Leases covering 43% of the Unit Area and the Gartrell Lease covering 57% of the Unit Area.

ROYALTY PARTICIPATION

Gregory A. Gartrell and Susan K. Thayer as Co-executors .026875 Royalty
of the estate of Barbara R. Clark, deceased Rooks County
District Court Case No. 16 PR 29
415 6 Road
Stockton, KS 67669

Susan K. Thayer and Kevin L. Thayer .0134375 Royalty
410 South 5th St.
Stockton, KS 67669

Gregory A. Gartrell and Susan R. Gartrell .0845875 Royalty
as Trustees of the Gregory and Susan Gartrell
Trust u/a/d March 13, 2015
415 6 Road
Stockton, KS 67669