

APPLICATION FOR COMMINGLING OF PRODUCTION (K.A.R. 82-3-123) OR FLUIDS (K.A.R. 82-3-123a) *Commingling ID # _____*

OPERATOR: License # _____ API No. 15 - _____
Name: _____ Spot Description: _____
Address 1: _____ - - - - - Sec. _____ Twp. _____ S. R. _____ East West
Address 2: _____ Feet from North / South Line of Section
City: _____ State: _____ Zip: _____ + _____ Feet from East / West Line of Section
Contact Person: _____ County: _____
Phone: (_____) _____ Lease Name: _____ Well #: _____

1. Name and upper and lower limit of each production interval to be commingled:
Formation: _____ (Perfs): _____
Formation: _____ (Perfs): _____
Formation: _____ (Perfs): _____
Formation: _____ (Perfs): _____
Formation: _____ (Perfs): _____

2. Estimated amount of fluid production to be commingled from each interval:
Formation: _____ BOPD: _____ MCFPD: _____ BWPD: _____
Formation: _____ BOPD: _____ MCFPD: _____ BWPD: _____
Formation: _____ BOPD: _____ MCFPD: _____ BWPD: _____
Formation: _____ BOPD: _____ MCFPD: _____ BWPD: _____
Formation: _____ BOPD: _____ MCFPD: _____ BWPD: _____

3. Plat map showing the location of the subject well, all other wells on the subject lease, and all wells on offsetting leases within a 1/2 mile radius of the subject well, and for each well the names and addresses of the lessee of record or operator.

4. Signed certificate showing service of the application and affidavit of publication as required in K.A.R. 82-3-135a.

For Commingling of PRODUCTION ONLY, include the following:

- 5. Wireline log of subject well. Previously Filed with ACO-1: Yes No
- 6. Complete Form ACO-1 (*Well Completion form*) for the subject well.

For Commingling of FLUIDS ONLY, include the following:

- 7. Well construction diagram of subject well.
- 8. Any available water chemistry data demonstrating the compatibility of the fluids to be commingled.

AFFIDAVIT: I am the affiant and hereby certify that to the best of my current information, knowledge and personal belief, this request for commingling is true and proper and I have no information or knowledge, which is inconsistent with the information supplied in this application.

Submitted Electronically

KCC Office Use Only
 Denied Approved
15-Day Periods Ends: _____
Approved By: _____ Date: _____

Protests may be filed by any party having a valid interest in the application. Protests must be in writing and comply with K.A.R. 82-3-135b and must be filed within 15 days of publication of the notice of application.

STATE OF KANSAS

Rooks

COUNTY

SS.

Affidavit of Publication

Frank Mercer, being first duly sworn, deposes and says: That he is publisher of the *Plainville Times*, a weekly newspaper printed in the State of Kansas, and published in and of general circulation in Rooks County, Kansas, with a general paid circulation on a weekly basis in Rooks County, Kansas, and that said newspaper is not a trade, religious or fraternal publication.

Said newspaper is a weekly published one day a week and has been published continuously and uninterruptedly in said county and state for a period of more than five years prior to the first publication of said notice; and has been admitted at the post office of Plainville, Kansas, in said county as second class matter.

That the attached notice is a true copy thereof and was published in the regular and entire issue of said newspaper for 1 consecutive week, the first publication thereof being made as aforesaid on the 30th day of March, 2017, with subsequent publications being made on the following dates:

_____, 20____, 20____
_____, 20____, 20____
_____, 20____, 20____

Signed: [Signature]

Subscribed and sworn to before me this 31st day of March, 2017.
[Signature]
Notary Public's Signature
My Commission expires: Aug 3 2020

Publication Fee \$ 40.88
Affidavit, Notary's Fee \$.55
Additional copies @ \$ _____
Total Publication Fee \$ 41.43

Published in the Thursday, March 30, 2017 issue of the PlainvilleTimes) t1

BEFORE THE STATE CORPORATION COMMISSION OF THE STATE OF KANSAS NOTICE OF FILING APPLICATION

RE: Citation Oil & Gas Corp. -- Application for a permit to authorize the downhole commingling of the LKC, Topeka and Toronto zones in the Barry LKC Unit 6-15 well located in Rooks County, Kansas.

TO: All Oil and Gas Producers, Unleased Mineral Interest Owners, Landowners, and all persons whomever concerned.

You, and each of you, are hereby notified that Citation Oil & Gas Corp. has filed an application to commence the downhole commingling of the LKC, Topeka and Toronto Formations in the Barry LKC Unit 6-15 lease, located in the NE SW NE SE of Section 2, Township 9 South, Range 19 West, Rooks County, Kansas.

Any persons who object to or protest this application shall be required to file their objections or protests with the Conservation Division of the State Corporation Commission of the State of Kansas within fifteen (15) days from the date of this publication. These protests shall be filed pursuant to Commission regulations and must state specific reasons why the grant of the application may cause waste, violate correlative rights or pollute the natural resources of the state of Kansas.

All persons interested or concerned shall take notice of the foregoing and shall govern themselves accordingly.

Citation Oil & Gas Corp.
P.O. Box 690688
Houston, Texas 77269
Phone: 281-891-1000



Offset Operators with in a 1/2 mile radius

Name:	Legal Description of Leasehold:
Citation Oil & Gas Corp. (operator lease holder)	NE NW SE of Section 2, T9S-R19W, Rooks County, KS
Brent D. Flemming Revocable Trust	SE SW of Section 1, T9S-R19W, Rooks County, KS
Gick Rickard Fleming	SE SW of Section 1, T9S-R19W, Rooks County, KS
Black River Royalties LLC	SE SW of Section 1, T9S-R19W, Rooks County, KS
Kimbra M. Jerman	SE SW of Section 1, T9S-R19W, Rooks County, KS
Gick Family LLC	SE SW of Section 1, T9S-R19W, Rooks County, KS

I hereby certify that the statements made herein are true and correct to the best of my knowledge and belief.

Sandra Goncalves
Applicant or Duly Authorized Agent

Subscribed and sworn before me this 20 day of April, 2017

Notary Public

My Commission Expires: _____

Instructions:

1. Fully complete application, including page 4 (*plat map*) showing subject well and all known oil, gas and input wells, including wells being drilled, inactive wells, or dry holes, within one-half mile. Show lease names and operators or unleased mineral rights owners of all lands within one-half mile. Show well numbers and elevations of producing formation tops.
2. Attach some type of log (*drillers log, electric log, etc.*).
3. Attach some type of verification of cementing for surface casing, longstring, D.V. tool, perforations, etc. (*Cement ticket and job log, bond log, etc.*)
4. Attach Affidavit of Notice.
5. Fill in schematic drawing of subsurface facilities including: size, setting depth, amount of cement, measured or calculated tops of cement for each of surface, intermediate (*if any*) and production casing; size and setting depth of tubing and packer; geological zone of injection showing top and bottom of injection interval.
6. The original and one copy of the application and all attachments shall be mailed to the State Corporation Commission, Conservation Division.
7. Deliver or mail one (*1*) copy of the application to the landowner on whose land the injection well is located and to each operator or lessee of record and each unleased mineral rights owner within one-half mile of the applicant well.
8. Approval of this application, if granted, is valid only as long as there are no substantial changes in operation set forth in the application. A substantial change requires the approval of a new application. **No injection well may be used without prior written authorization.**
9. All application fees must accompany the application.

LEGAL PROOF OF PUBLICATION

Account #	Ad Number	Identification	PO	Amount	Cols	Lines
516230	0002993139	BEFORE THE STATE CORPORATION COMMISS		\$319.84	1	52

Attention:

CITATION OIL & GAS CORP.
 PO BOX 690688
 HOUSTON, TX 772690688

BEFORE THE STATE CORPORATION
 COMMISSION OF THE STATE OF KANSAS
 NOTICE OF FILING APPLICATION

RE: Citation Oil & Gas Corp. -- Application for a permit to authorize the downhole commingling of the LKC, Topeka and Toronto zones in the Barry LKC Unit 6-15 well located in Rooks County, Kansas.

TO: All Oil and Gas Producers, Unleased Mineral Interest Owners, Landowners, and all persons whomsoever concerned.

You, and each of you, are hereby notified that Citation Oil & Gas Corp. has filed an application to commence the downhole commingling of the LKC, Topeka and Toronto Formations in the Barry LKC Unit 6-15 lease, located in the NE SW NE SE of Section 2, Township 9 South, Range 19 West, Rooks County, Kansas.

Any persons who object to or protest this application shall be required to file their objections or protests with the Conservation Division of the State Corporation Commission of the State of Kansas within fifteen (15) days from the date of this publication. These protests shall be filed pursuant to Commission regulations and must state specific reasons why the grant of the application may cause waste, violate correlative rights or pollute the natural resources of the state of Kansas.

All persons interested or concerned shall take notice of the foregoing and shall govern themselves accordingly.

Citation Oil & Gas Corp.
 P.O. Box 690688
 Houston, Texas 77269
 Phone: 281-891-1000

In The STATE OF KANSAS
 In and for the County of Sedgwick
 AFFIDAVIT OF PUBLICATION

1 Insertions

Beginning issue of: 03/24/2017

Ending issue of: 03/24/2017

STATE OF KANSAS)
 .SS
 County of Sedgwick)

Dale Seiwert, of lawful age, being first duly sworn, deposeth and saith: That he is Record Clerk of The Wichita Eagle, a daily newspaper published in the City of Wichita, County of Sedgwick, State of Kansas, and having a general paid circulation on a daily basis in said County, which said newspaper has been continuously and uninterruptedly published in said County for more than one year prior to the first publication of the notice hereinafter mentioned, and which said newspaper has been entered as second class mail matter at the United States Post Office in Wichita, Kansas, and which said newspaper is not a trade, religious or fraternal publication and that a notice of a true copy is hereto attached was published in the regular and entire Morning issue of said The Wichita Eagle from 3/24/2017 to 03/24/2017.

I certify (or declare) under the penalty of perjury that the foregoing is true and correct.

Dale Seiwert

(Signature of Principal Clerk)

DATED: 3/24/2017

Jennifer Rae Bailey
 Notary Public Sedgwick County, Kansas

JENNIFER RAE BAILEY
 Notary Public - State of Kansas
 My Appt. Expires 12/1/2017



API # 1516303366

Barry LKC Unit #6-15

SW NE SE Sec. 2-T9S-R19W

Rooks County, Kansas

Current Wellbore Schematic

PROPOSED

Spud Date: 06/29/1945
Completed: 07/10/1945

Field: Barry

GL: 2012.5'
KB: 2015'

Surface Casing :
10-3/4", 27# set @ 238'
Cemented with 240 sx

TOC Unknown

Production Casing:
6", 18# H-40 set @ 3428'
Cemented with 300 sx

CIBP @ 3405' 10/1987
Model D Packer @ 3410' 5/63

Original PBDT 3395'
Deepened to 3440' 5/63

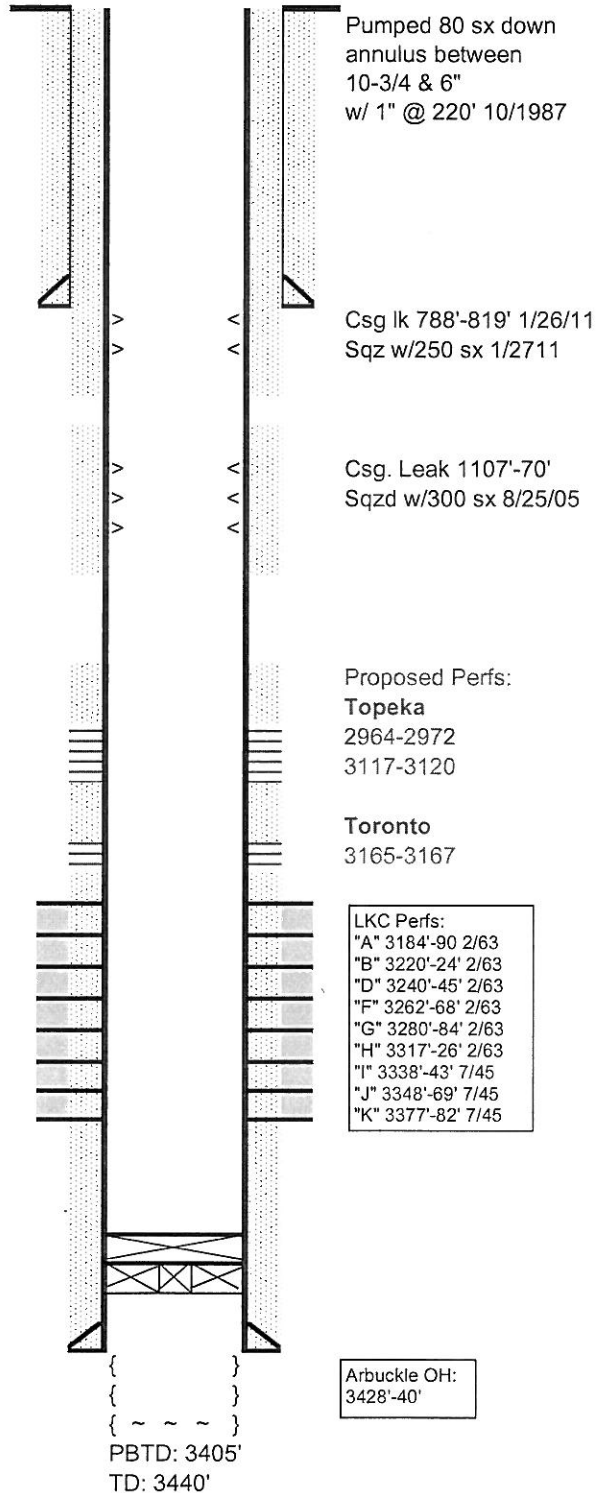

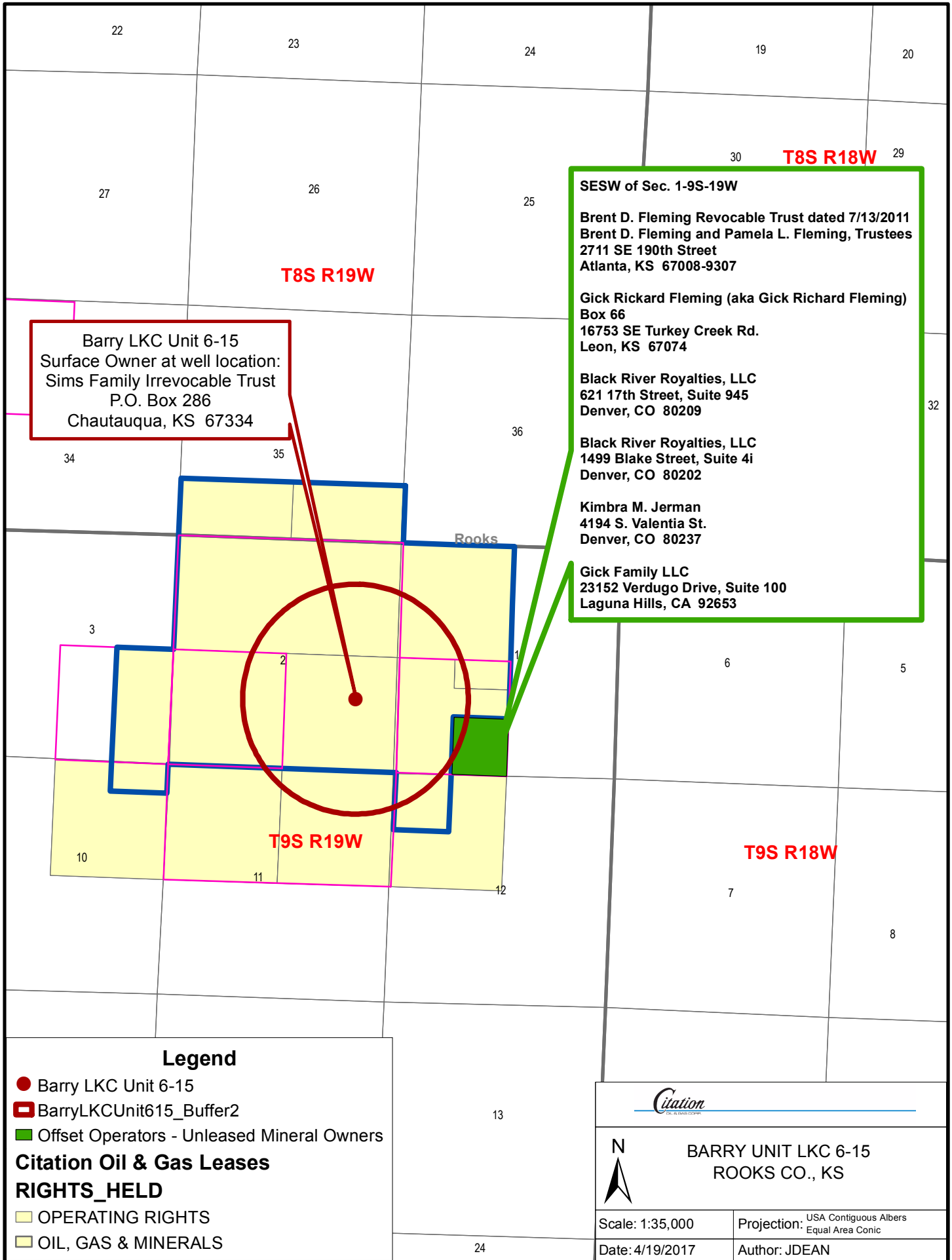

Barry LKC Unit 6-15
 Surface Owner at well location:
 Sims Family Irrevocable Trust
 P.O. Box 286
 Chautauqua, KS 67334

SESW of Sec. 1-9S-19W

Brent D. Fleming Revocable Trust dated 7/13/2011
 Brent D. Fleming and Pamela L. Fleming, Trustees
 2711 SE 190th Street
 Atlanta, KS 67008-9307

Gick Rickard Fleming (aka Gick Richard Fleming)
 Box 66
 16753 SE Turkey Creek Rd.
 Leon, KS 67074

Black River Royalties, LLC
 621 17th Street, Suite 945
 Denver, CO 80209

Black River Royalties, LLC
 1499 Blake Street, Suite 4i
 Denver, CO 80202

Kimbra M. Jerman
 4194 S. Valentia St.
 Denver, CO 80237

Gick Family LLC
 23152 Verdugo Drive, Suite 100
 Laguna Hills, CA 92653

Legend

- Barry LKC Unit 6-15
 - ▭ BarryLKCUnit615_Buffer2
 - ▭ Offset Operators - Unleased Mineral Owners
- Citation Oil & Gas Leases**
- RIGHTS_HELD**
- ▭ OPERATING RIGHTS
 - ▭ OIL, GAS & MINERALS



BARRY UNIT LKC 6-15
ROOKS CO., KS

Scale: 1:35,000

Projection: USA Contiguous Albers
 Equal Area Conic

Date: 4/19/2017

Author: JDEAN

Conservation Division
266 N. Main St., Ste. 220
Wichita, KS 67202-1513



Phone: 316-337-6200
Fax: 316-337-6211
<http://kcc.ks.gov/>

Pat Apple, Chairman
Shari Feist Albrecht, Commissioner
Jay Scott Emler, Commissioner

Sam Brownback, Governor

May 5, 2017

Sandra Goncalves
Citation Oil & Gas Corp
14077 Cutten Rd
Houston, TX 77269-0688

RE: Approved Commingling CO041704
Barry LKC Unit 6-15
API No. 15-163-03366-00-00

Dear Ms. Goncalves:

Your Application for Commingling (ACO-4) for the above described well has been reviewed and approved by the Kansas Corporation Commission (KCC) per K.A.R. 82-3-123. Notice was examined and found to be proper per K.A.R. 82-3-135a. No protest had been filed within the 15-day protest period.

Based upon the depth of the LKC formation perforations, total oil production shall not exceed 100 BOPD and total gas production shall not exceed 50% of the absolute open flow (AOF).

File form ACO-1 upon completion of the well to commingle.

Sincerely,

Rick Hestermann
Production Department