

APPLICATION FOR COMMINGLING OF PRODUCTION (K.A.R. 82-3-123) OR FLUIDS (K.A.R. 82-3-123a) *Commingling ID #* _____

OPERATOR: License # _____ API No. 15 - _____
Name: _____ Spot Description: _____
Address 1: _____ - - - - - Sec. _____ Twp. _____ S. R. _____ East West
Address 2: _____ Feet from North / South Line of Section
City: _____ State: _____ Zip: _____ + _____ Feet from East / West Line of Section
Contact Person: _____ County: _____
Phone: (_____) _____ Lease Name: _____ Well #: _____

1. Name and upper and lower limit of each production interval to be commingled:
Formation: _____ (Perfs): _____
Formation: _____ (Perfs): _____
Formation: _____ (Perfs): _____
Formation: _____ (Perfs): _____
Formation: _____ (Perfs): _____

2. Estimated amount of fluid production to be commingled from each interval:
Formation: _____ BOPD: _____ MCFPD: _____ BWPD: _____
Formation: _____ BOPD: _____ MCFPD: _____ BWPD: _____
Formation: _____ BOPD: _____ MCFPD: _____ BWPD: _____
Formation: _____ BOPD: _____ MCFPD: _____ BWPD: _____
Formation: _____ BOPD: _____ MCFPD: _____ BWPD: _____

3. Plat map showing the location of the subject well, all other wells on the subject lease, and all wells on offsetting leases within a 1/2 mile radius of the subject well, and for each well the names and addresses of the lessee of record or operator.

4. Signed certificate showing service of the application and affidavit of publication as required in K.A.R. 82-3-135a.

For Commingling of PRODUCTION ONLY, include the following:

- 5. Wireline log of subject well. Previously Filed with ACO-1: Yes No
- 6. Complete Form ACO-1 (*Well Completion form*) for the subject well.

For Commingling of FLUIDS ONLY, include the following:

- 7. Well construction diagram of subject well.
- 8. Any available water chemistry data demonstrating the compatibility of the fluids to be commingled.

AFFIDAVIT: I am the affiant and hereby certify that to the best of my current information, knowledge and personal belief, this request for commingling is true and proper and I have no information or knowledge, which is inconsistent with the information supplied in this application.

Submitted Electronically

KCC Office Use Only
 Denied Approved
15-Day Periods Ends: _____
Approved By: _____ Date: _____

Protests may be filed by any party having a valid interest in the application. Protests must be in writing and comply with K.A.R. 82-3-135b and must be filed within 15 days of publication of the notice of application.



Baumer #9
SE NW NW Section 27-T11S-R17W
Ellis County, Kansas
PROPOSED WBD

API # 1505105916

Spud Date: 06/13/1937
Completed: 07/11/1937

Field: Bemis-Shutts

GL:
KB: 1991'

Surface Casing :
15-1/2", 70# set @ 50'
Cemented with 50 sx

10" 40# set at 1200'
Cemented with 400 sx

TOC Unknown

Production Casing:
7", 24# set @ 3488'
Cemented with 175 sx

83 jts. 5-1/2" 14# liner set at 3488'
Cemented with 470 sx 10/2003

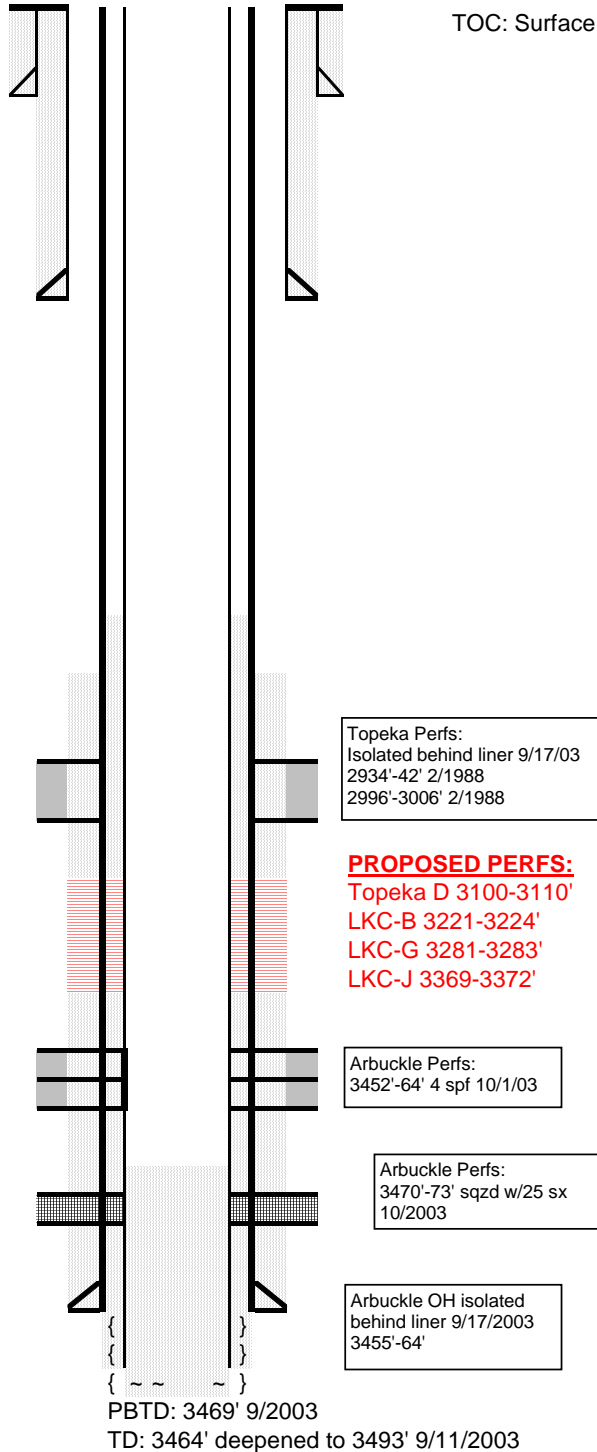

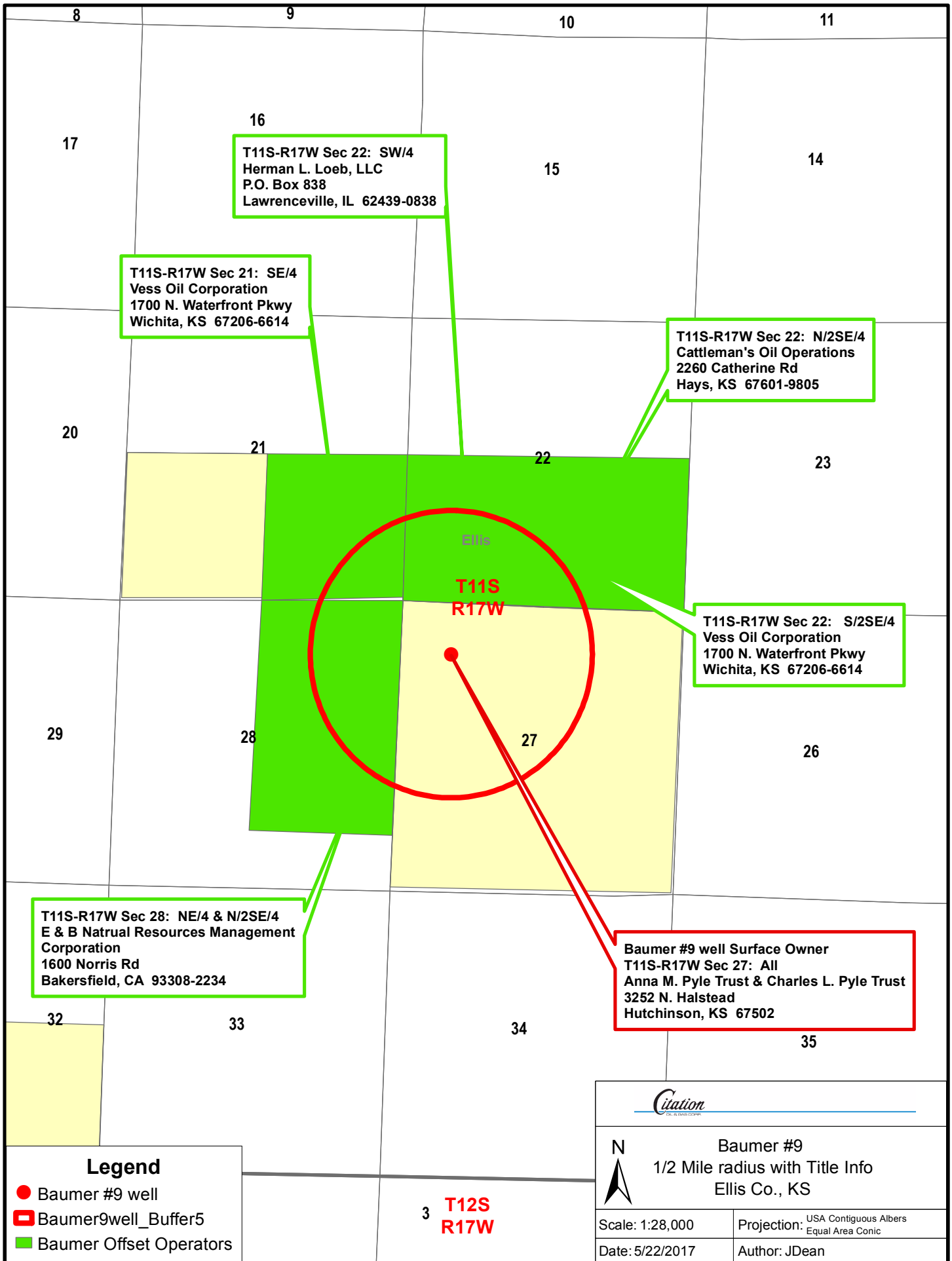

Legend

- Baumer #9 well
- ▭ Baumer9well_Buffer5
- Baumer Offset Operators

Citation

Baumer #9
 1/2 Mile radius with Title Info
 Ellis Co., KS

Scale: 1:28,000	Projection: USA Contiguous Albers Equal Area Conic
Date: 5/22/2017	Author: JDean

3 **T12S
R17W**

Offset Operators with in a 1/2 mile radius & Surface Owner

Name:	Legal Description of Leasehold:
Herman L. Loeb, LLC	T11S-R17W Sec 22 SW/4
Vess Oil Corporation	T11-R17W Sec 21 SE/4 and T11S-R17W Sec 22 S/2 SE/4
Cattleman's Oil Operations	T11S-R17W Sec 22 N/2 SE/4
E&B Natural Resources Management Corporation	T11S-R17W Sec 28 NE/7 & N/2 SE/4
Anna M. Pyle Trust & Charles L. Pyle Trust	T11-R17W Sec 27: all

I hereby certify that the statements made herein are true and correct to the best of my knowledge and belief.

Sandra Glanau
 Applicant or Duly Authorized Agent

Subscribed and sworn before me this 23 day of May, 2017



Sharon Ward
 Notary Public
 My Commission Expires: 11/28/2019

Instructions:

- Fully complete application, including page 4 (*plat map*) showing subject well and all known oil, gas and input wells, including wells being drilled, inactive wells, or dry holes, within one-half mile. Show lease names and operators or unleased mineral rights owners of all lands within one-half mile. Show well numbers and elevations of producing formation tops.
- Attach some type of log (*drillers log, electric log, etc.*).
- Attach some type of verification of cementing for surface casing, longstring, D.V. tool, perforations, etc. (*Cement ticket and job log, bond log, etc.*)
- Attach Affidavit of Notice.
- Fill in schematic drawing of subsurface facilities including: size, setting depth, amount of cement, measured or calculated tops of cement for each of surface, intermediate (*if any*) and production casing; size and setting depth of tubing and packer; geological zone of injection showing top and bottom of injection interval.
- The original and one copy of the application and all attachments shall be mailed to the State Corporation Commission, Conservation Division.
- Deliver or mail one (*1*) copy of the application to the landowner on whose land the injection well is located and to each operator or lessee of record and each unleased mineral rights owner within one-half mile of the applicant well.
- Approval of this application, if granted, is valid only as long as there are no substantial changes in operation set forth in the application. A substantial change requires the approval of a new application. **No injection well may be used without prior written authorization.**
- All application fees must accompany the application.

AFFIDAVIT OF PUBLICATION

State of Kansas, Ellis County, ss:

Mary Karst

being first duly sworn, deposes and says:

That he/she is Advertising Manager of THE HAYS DAILY NEWS, a daily newspaper printed in the State of Kansas, and published in and of general circulation in Ellis County, Kansas, with a general paid circulation on a yearly basis in Ellis County, Kansas, and that said newspaper is not a trade, religious or fraternal publication.

Said newspaper is published daily, except Saturday, is published at least weekly 50 times a year; has been so published continuously and uninterrupted in said county and state for a period of more than five years prior to the first publication of said notice; and has been admitted at the post office of Hays in said county as second class matter.

That the attached notice is a true copy thereof and was published in the regular and entire issue of said newspaper for 1 consecutive day, the first publication thereof being made as aforesaid on the 14th day of May, 2017, with subsequent publications being made on the following dates:

20 _____ 20 _____
20 _____ 20 _____
20 _____ 20 _____

Mary Karst

Subscribed and sworn to before me this 14th day of May, 2017.

[Signature]
Notary Public

My Appointment expires 5-28-17 \$59.80
Printer's Fee \$ _____
Additional copies \$ _____
Total Fee \$59.80

(Published in The Hays Daily News May 14, 2017)

BEFORE THE STATE CORPORATION COMMISSION OF THE STATE OF KANSAS
NOTICE OF FILING APPLICATION

RE: Citation Oil & Gas Corp. Application for a permit to authorize the downhole commingling of the Topeka, LKC and Arbuckle zones in the Baurner 9 well located in Ellis, Kansas. TO: All Oil and Gas Producers, Unleased Mineral Interest Owners, Landowners, and all persons whomsoever concerned. You, and each of you, are hereby notified that Citation Oil & Gas Corp. has filed an application to commence the downhole commingling of the Topeka, LKC and Arbuckle Formations in the Baurner 9 well, located in the SE NW NW of Section 27, Township 11 South, Range 17 West, Ellis County, Kansas. Any persons who object to or protest this application shall be required to file their objections or protests with the Conservation Division of the State Corporation Commission of the State of Kansas within fifteen (15) days from the date of this publication. These protests shall be filed pursuant to Commission regulations and must state specific reasons why the grant of the application may cause waste, violate correlative rights or pollute the natural resources of the state of Kansas. All persons interested or concerned shall take notice of the foregoing and shall govern themselves accordingly. Citation Oil & Gas Corp. P.O. Box 690688 Houston, Texas 77269 Phone: 281-891-1000

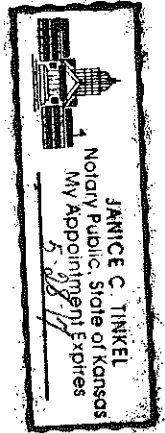



LEGAL PROOF OF PUBLICATION

Account #	Ad Number	Identification	PO	Amount	Cols	Lines
516230	0003073827	BEFORE THE STATE CORPORATION COMMISS		\$304.17	1	51

Attention:

CITATION OIL & GAS CORP.
 PO BOX 690688
 HOUSTON, TX 772690688

**BEFORE THE STATE CORPORATION
 COMMISSION OF THE STATE OF KANSAS
 NOTICE OF FILING APPLICATION**

RE: Citation Oil & Gas Corp. –
 Application for a permit to authorize the
 downhole commingling of the Topeka,
 LKC and Arbuckle zones in the Baumer 9
 well located in Ellis, Kansas.

TO: All Oil and Gas Producers, Unleased
 Mineral Interest Owners, Landowners,
 and all persons whomever concerned.

You, and each of you, are hereby notified
 that Citation Oil & Gas Corp. has filed an
 application to commence the downhole
 commingling of the Topeka, LKC and
 Arbuckle Formations in the Baumer 9
 well, located in the SE NW NW of
 Section 27, Township 11 South, Range
 17 West, Ellis County, Kansas.

Any persons who object to or protest
 this application shall be required to file
 their objections or protests with the
 Conservation Division of the State
 Corporation Commission of the State of
 Kansas within fifteen (15) days from the
 date of this publication. These protests
 shall be filed pursuant to Commission
 regulations and must state specific
 reasons why the grant of the application
 may cause waste, violate correlative
 rights or pollute the natural resources of
 the state of Kansas.

All persons interested or concerned shall
 take notice of the foregoing and shall
 govern themselves accordingly.

Citation Oil & Gas Corp.
 P.O. Box 690688
 Houston, Texas 77269
 Phone: 281-891-1000

In The STATE OF KANSAS
 In and for the County of Sedgwick
 AFFIDAVIT OF PUBLICATION

1 Insertions

Beginning issue of: 05/12/2017

Ending issue of: 05/12/2017

STATE OF KANSAS)

.SS

County of Sedgwick)

Dale Seiwert, of lawful age, being first duly
 sworn, deposeth and saith: That he is
 Record Clerk of The Wichita Eagle, a daily
 newspaper published in the City of Wichita,
 County of Sedgwick, State of Kansas, and
 having a general paid circulation on a daily
 basis in said County, which said
 newspaper has been continuously and
 uninterruptedly published in said County for
 more than one year prior to the first
 publication of the notice hereinafter
 mentioned, and which said newspaper has
 been entered as second class mail matter
 at the United States Post Office in Wichita,
 Kansas, and which said newspaper is not a
 trade, religious or fraternal publication and
 that a notice of a true copy is hereto
 attached was published in the regular and
 entire Morning issue of said The Wichita
 Eagle from 5/12/2017 to 05/12/2017.

I certify (or declare) under the penalty of
 perjury that the foregoing is true and correct.

Dale Seiwert

(Signature of Principal Clerk)

DATED: 5/12/2017

Jennifer Rae Bailey
 Notary Public Sedgwick County, Kansas

JENNIFER RAE BAILEY
 Notary Public - State of Kansas
 My Appt. Expires 6/1/2017

Conservation Division
266 N. Main St., Ste. 220
Wichita, KS 67202-1513



Phone: 316-337-6200
Fax: 316-337-6211
<http://kcc.ks.gov/>

Pat Apple, Chairman
Shari Feist Albrecht, Commissioner
Jay Scott Emler, Commissioner

Sam Brownback, Governor

June 7, 2017

Sandra Goncalves
Citation Oil & Gas Corp
14077 Cutten Rd
Houston, TX 77269-0688

RE: Approved Commingling CO051702
Baumer #9
API No. 15-051-05916-00-00

Dear Ms. Goncalves:

Your Application for Commingling (ACO-4) for the above described well has been reviewed and approved by the Kansas Corporation Commission (KCC) per K.A.R. 82-3-123. Notice was examined and found to be proper per K.A.R. 82-3-135a. No protest had been filed within the 15-day protest period.

Based upon the depth of the Arbuckle formation perforations, total oil production shall not exceed 100 BOPD and total gas production shall not exceed 50% of the absolute open flow (AOF).

File form ACO-1 upon completion of the well to commingle.

Sincerely,

Rick Hestermann
Production Department