

APPLICATION FOR COMMINGLING OF PRODUCTION (K.A.R. 82-3-123) OR FLUIDS (K.A.R. 82-3-123a) *Commingling ID # _____*

OPERATOR: License # _____ API No. 15 - _____
Name: _____ Spot Description: _____
Address 1: _____ - - - - - Sec. _____ Twp. _____ S. R. _____ East West
Address 2: _____ Feet from North / South Line of Section
City: _____ State: _____ Zip: _____ + _____ Feet from East / West Line of Section
Contact Person: _____ County: _____
Phone: (_____) _____ Lease Name: _____ Well #: _____

1. Name and upper and lower limit of each production interval to be commingled:
Formation: _____ (Perfs): _____
Formation: _____ (Perfs): _____
Formation: _____ (Perfs): _____
Formation: _____ (Perfs): _____
Formation: _____ (Perfs): _____

2. Estimated amount of fluid production to be commingled from each interval:
Formation: _____ BOPD: _____ MCFPD: _____ BWPD: _____
Formation: _____ BOPD: _____ MCFPD: _____ BWPD: _____
Formation: _____ BOPD: _____ MCFPD: _____ BWPD: _____
Formation: _____ BOPD: _____ MCFPD: _____ BWPD: _____
Formation: _____ BOPD: _____ MCFPD: _____ BWPD: _____

3. Plat map showing the location of the subject well, all other wells on the subject lease, and all wells on offsetting leases within a 1/2 mile radius of the subject well, and for each well the names and addresses of the lessee of record or operator.

4. Signed certificate showing service of the application and affidavit of publication as required in K.A.R. 82-3-135a.

For Commingling of PRODUCTION ONLY, include the following:

- 5. Wireline log of subject well. Previously Filed with ACO-1: Yes No
- 6. Complete Form ACO-1 (*Well Completion form*) for the subject well.

For Commingling of FLUIDS ONLY, include the following:

- 7. Well construction diagram of subject well.
- 8. Any available water chemistry data demonstrating the compatibility of the fluids to be commingled.

AFFIDAVIT: I am the affiant and hereby certify that to the best of my current information, knowledge and personal belief, this request for commingling is true and proper and I have no information or knowledge, which is inconsistent with the information supplied in this application.

Submitted Electronically

KCC Office Use Only
 Denied Approved
15-Day Periods Ends: _____
Approved By: _____ Date: _____

Protests may be filed by any party having a valid interest in the application. Protests must be in writing and comply with K.A.R. 82-3-135b and must be filed within 15 days of publication of the notice of application.

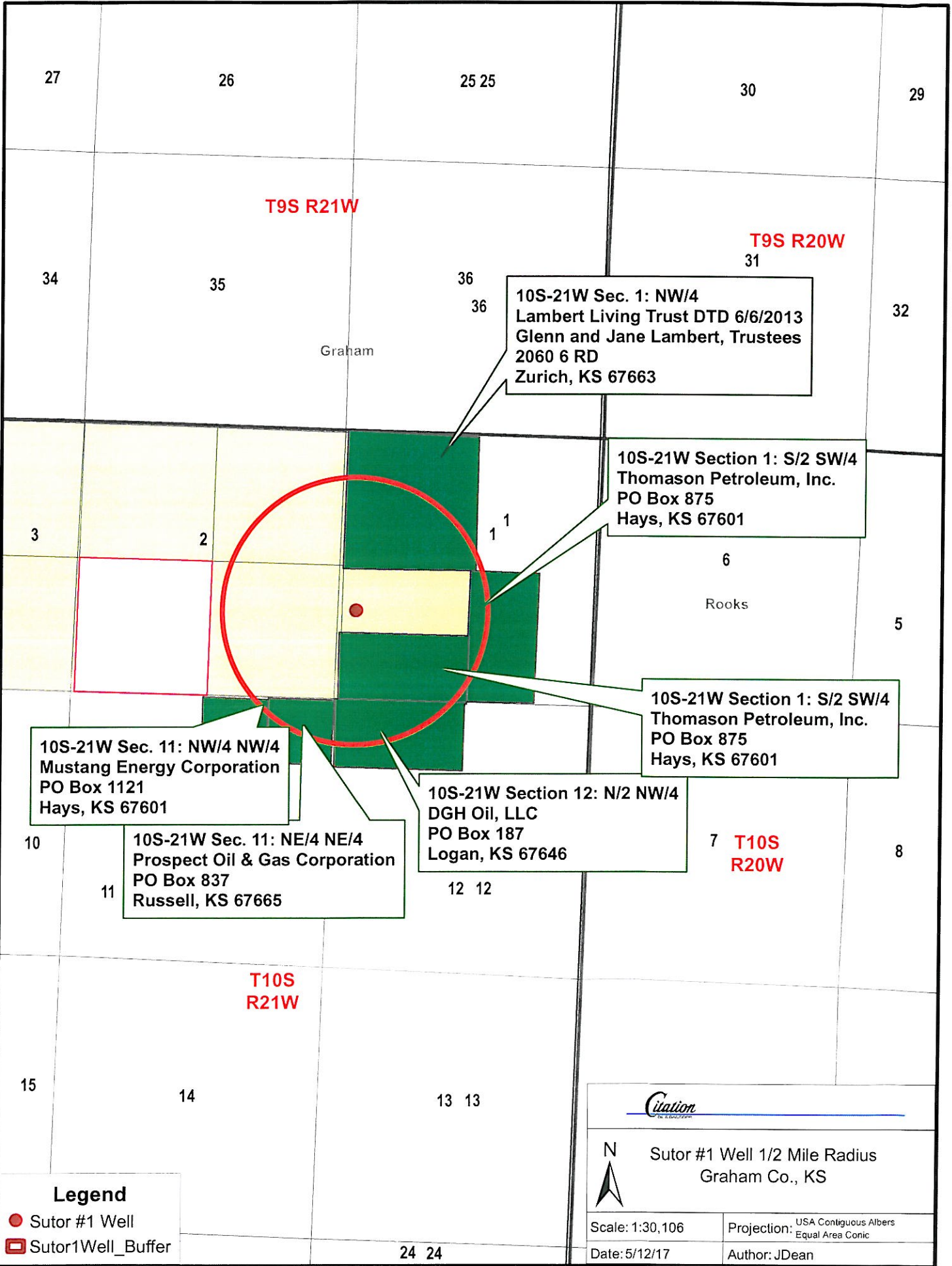

T9S R21W

T9S R20W
31

10S-21W Sec. 1: NW/4
Lambert Living Trust DTD 6/6/2013
Glenn and Jane Lambert, Trustees
2060 6 RD
Zurich, KS 67663

10S-21W Section 1: S/2 SW/4
Thomason Petroleum, Inc.
PO Box 875
Hays, KS 67601

10S-21W Section 1: S/2 SW/4
Thomason Petroleum, Inc.
PO Box 875
Hays, KS 67601

10S-21W Sec. 11: NW/4 NW/4
Mustang Energy Corporation
PO Box 1121
Hays, KS 67601

10S-21W Sec. 11: NE/4 NE/4
Prospect Oil & Gas Corporation
PO Box 837
Russell, KS 67665

10S-21W Section 12: N/2 NW/4
DGH Oil, LLC
PO Box 187
Logan, KS 67646

7 T10S
R20W

T10S
R21W

Legend

- Sutor #1 Well
- Sutor1Well_Buffer

Citation

N
Sutor #1 Well 1/2 Mile Radius
Graham Co., KS

Scale: 1:30,106	Projection: USA Contiguous Albers Equal Area Conic
Date: 5/12/17	Author: JDean

Public Notices

First Published In The Hill City Times,
Wednesday, May 17, 2017:

**BEFORE THE STATE CORPORATION
COMMISSION OF THE
STATE OF KANSAS
NOTICE OF FILING APPLICATION**

RE: Citation Oil & Gas Corp. -
Application for a permit to authorize the
downhole commingling of the LKC and
Arbuckle zones in the Sutor 1 well
located in Graham County, Kansas.

TO: All Oil and Gas Producers,
Unleased Mineral Interest Owners,
Landowners, and all persons whomever
concerned.

You, and each of you, are hereby
notified that Citation Oil & Gas Corp.
has filed an application to commence
the downhole commingling of the LKC
and Arbuckle Formations in the Sutor 1
well, located in the NE SW NW SW of
Section 1, Township 10 South, Range
21 West, Graham County, Kansas.

Any persons who object to or protest
this application shall be required to file
their objections or protests with the
Conservation Division of the State
Corporation Commission of the State of
Kansas within fifteen (15) days from the
date of this publication. These protests
shall be filed pursuant to Commission
regulations and must state specific
reasons why the grant of the application
may cause waste, violate correlative
rights or pollute the natural resources of
the state of Kansas.

All persons interested or concerned
shall take notice of the foregoing and
shall govern themselves accordingly.

Citation Oil & Gas Corp.
P.O. Box 690688
Houston, Texas 77269
Phone: 281-891-1000

AFFIDAVIT OF PUBLICATION State of Kansas, County of Graham, ss:

JIM LOGBACK, of lawful age, being duly sworn, upon oath states
that he is publisher of THE HILL CITY TIMES;

THAT said newspaper has been published weekly at least fifty (50)
times a year and has been published at least five (5) years in Graham County,
Kansas prior to the first publication of the attached notice;

THAT said newspaper has a general PAID circulation in GRAHAM
COUNTY, KANSAS, and is NOT a trade, religious or fraternal publication.

THAT said newspaper is PRINTED IN KANSAS and PUBLISHED
in GRAHAM COUNTY, KANSAS, and entered as second class mail matter
at the post office of its publication in HILL CITY, KANSAS;

THAT, a notice of which the attached is a true and correct copy,
was published in a regular issue of said newspaper for 1 consecutive
weeks commencing with the issue of May 17, 2017.

Jim Logback

Publication Fee \$ 28.00
____ Affidavits @ 75¢ . . \$ _____
____ Extra Copies @ 50¢ \$ _____
TOTAL LEGAL FEE \$ 28.00

SUBSCRIBED and sworn
to before me this _____
day of _____,
_____.

My commission expires _____ Notary Public



LEGAL PROOF OF PUBLICATION

Account #	Ad Number	Identification	PO	Amount	Cols	Lines
516230	0003073953	BEFORE THE STATE CORPORATION COMMISS		\$304.17	1	51

Attention:
 CITATION OIL & GAS CORP.
 PO BOX 690688
 HOUSTON, TX 772690688

BEFORE THE STATE CORPORATION COMMISSION OF THE STATE OF KANSAS NOTICE OF FILING APPLICATION

RE: Citation Oil & Gas Corp. -- Application for a permit to authorize the downhole commingling of the LKC and Arbuckle zones in the Sutor 1 well located in Graham, Kansas.

TO: All Oil and Gas Producers, Unleased Mineral Interest Owners, Landowners, and all persons whomsoever concerned.

You, and each of you, are hereby notified that Citation Oil & Gas Corp. has filed an application to commence the downhole commingling of the LKC and Arbuckle Formations in the Sutor 1 well, located in the NE SW NW SW of Section 1, Township 10 South, Range 21 West, Graham County, Kansas.

Any persons who object to or protest this application shall be required to file their objections or protests with the Conservation Division of the State Corporation Commission of the State of Kansas within fifteen (15) days from the date of this publication. These protests shall be filed pursuant to Commission regulations and must state specific reasons why the grant of the application may cause waste, violate correlative rights or pollute the natural resources of the state of Kansas.

All persons interested or concerned shall take notice of the foregoing and shall govern themselves accordingly.

Citation Oil & Gas Corp.
 P.O. Box 690688
 Houston, Texas 77269
 Phone: 281-891-1000

In The STATE OF KANSAS
 In and for the County of Sedgwick
 AFFIDAVIT OF PUBLICATION

1 Insertions

Beginning issue of: 05/12/2017

Ending issue of: 05/12/2017

STATE OF KANSAS)
 .SS
 County of Sedgwick)

Dale Seiwert, of lawful age, being first duly sworn, deposeth and saith: That he is Record Clerk of The Wichita Eagle, a daily newspaper published in the City of Wichita, County of Sedgwick, State of Kansas, and having a general paid circulation on a daily basis in said County, which said newspaper has been continuously and uninterruptedly published in said County for more than one year prior to the first publication of the notice hereinafter mentioned, and which said newspaper has been entered as second class mail matter at the United States Post Office in Wichita, Kansas, and which said newspaper is not a trade, religious or fraternal publication and that a notice of a true copy is hereto attached was published in the regular and entire Morning issue of said The Wichita Eagle from 5/12/2017 to 05/12/2017.

I certify (or declare) under the penalty of perjury that the foregoing is true and correct.

Dale Seiwert

(Signature of Principal Clerk)
 DATED: 5/12/2017

Jennifer Rae Bailey
 Notary Public Sedgwick County, Kansas

JENNIFER RAE BAILEY
 Notary Public - State of Kansas
 My Appl Expires 6/15/2017

Offset Operators with in a 1/2 mile radius

Name:
Citation Oil & Gas Corp. (operator lease holder)
Lambert Living Trust DTD Glenn and Jane Lambert, Trustees
Thomason Petroleum, Inc.
DGH Oil, LLC
Prospect Oil & Gas Corporation
Mustang Energy Corporation

Legal Description of Leasehold:
NE SW NW SW of Section 1, T10S-R21W, Graham County, KS
NW/4 of Section 1, T10SR21W, Graham County, KS
S/2 SW/4 of Section 1, T10S-R21W, Graham County, KS
N/2 NW/4 of Section 12, T10S-R21W, Graham County, KS
NE/4 NE/4 of Section 11, T10S-R21W, Graham County, KS
NW/4 NW/4 of Section 11, T10S-R21W, Graham County, KS

I hereby certify that the statements made herein are true and correct to the best of my knowledge and belief.

Applicant or Duly Authorized Agent

Subscribed and sworn before me this 22 day of June, 2017

Notary Public

My Commission Expires: _____

Instructions:

1. Fully complete application, including page 4 (*plat map*) showing subject well and all known oil, gas and input wells, including wells being drilled, inactive wells, or dry holes, within one-half mile. Show lease names and operators or unleased mineral rights owners of all lands within one-half mile. Show well numbers and elevations of producing formation tops.
2. Attach some type of log (*drillers log, electric log, etc.*).
3. Attach some type of verification of cementing for surface casing, longstring, D.V. tool, perforations, etc. (*Cement ticket and job log, bond log, etc.*)
4. Attach Affidavit of Notice.
5. Fill in schematic drawing of subsurface facilities including: size, setting depth, amount of cement, measured or calculated tops of cement for each of surface, intermediate (*if any*) and production casing; size and setting depth of tubing and packer; geological zone of injection showing top and bottom of injection interval.
6. The original and one copy of the application and all attachments shall be mailed to the State Corporation Commission, Conservation Division.
7. Deliver or mail one (*1*) copy of the application to the landowner on whose land the injection well is located and to each operator or lessee of record and each unleased mineral rights owner within one-half mile of the applicant well.
8. Approval of this application, if granted, is valid only as long as there are no substantial changes in operation set forth in the application. A substantial change requires the approval of a new application. **No injection well may be used without prior written authorization.**
9. All application fees must accompany the application.

Offset Operators with in a 1/2 mile radius

Name:
 Citation Oil & Gas Corp. (operator lease holder)
 Lambert Living Trust DTD Glenn and Jane Lambert, Trustees
 Thomason Petroleum, Inc.
 DGH Oil, LLC
 Prospect Oil & Gas Corporation
 Mustang Energy Corporation

Legal Description of Leasehold:
 NE SW NW SW of Section 1, T10S-R21W, Graham County, KS
 NW/4 of Section 1, T10SR21W, Graham County, KS
 S/2 SW/4 of Section 1, T10S-R21W, Graham County, KS
 N/2 NW/4 of Section 12, T10S-R21W, Graham County, KS
 NE/4 NE/4 of Section 11, T10S-R21W, Graham County, KS
 NW/4 NW/4 of Section 11, T10S-R21W, Graham County, KS

I hereby certify that the statements made herein are true and correct to the best of my knowledge and belief.

 Applicant or Duly Authorized Agent

Subscribed and sworn before me this 22 day of June, 2017

Notary Public

My Commission Expires:

Instructions:

1. Fully complete application, including page 4 (plat map) showing subject well and all known oil, gas and input wells, including wells being drilled, inactive wells, or dry holes, within one-half mile. Show lease names and operators or unleased mineral rights owners of all lands within one-half mile. Show well numbers and elevations of producing formation tops.
2. Attach some type of log (drillers log, electric log, etc.).
3. Attach some type of verification of cementing for surface casing, longstring, D.V. tool, perforations, etc. (Cement ticket and job log, bond log, etc.)
4. Attach Affidavit of Notice.
5. Fill in schematic drawing of subsurface facilities including: size, setting depth, amount of cement, measured or calculated tops of cement for each of surface, intermediate (if any) and production casing; size and setting depth of tubing and packer; geological zone of injection showing top and bottom of injection interval.
6. The original and one copy of the application and all attachments shall be mailed to the State Corporation Commission, Conservation Division.
7. Deliver or mail one (1) copy of the application to the landowner on whose land the injection well is located and to each operator or lessee of record and each unleased mineral rights owner within one-half mile of the applicant well.
8. Approval of this application, if granted, is valid only as long as there are no substantial changes in operation set forth in the application. A substantial change requires the approval of a new application. **No injection well may be used without prior written authorization.**
9. All application fees must accompany the application.

Conservation Division
266 N. Main St., Ste. 220
Wichita, KS 67202-1513



Phone: 316-337-6200
Fax: 316-337-6211
<http://kcc.ks.gov/>

Pat Apple, Chairman
Shari Feist Albrecht, Commissioner
Jay Scott Emler, Commissioner

Sam Brownback, Governor

July 10, 2017

Sandra Goncalves
Citation Oil & Gas Corp
14077 Cutten Rd
Houston, TX 77269-0688

RE: Approved Commingling CO061702
Sutor 1
API No. 15-065-01167-00-01

Dear Ms. Goncalves:

Your Application for Commingling (ACO-4) for the above described well has been reviewed and approved by the Kansas Corporation Commission (KCC) per K.A.R. 82-3-123. Notice was examined and found to be proper per K.A.R. 82-3-135a. No protest had been filed within the 15-day protest period.

Based upon the depth of the Arbuckle formation perforations, total oil production shall not exceed 100 BOPD and total gas production shall not exceed 50% of the absolute open flow (AOF).

File form ACO-1 upon completion of the well to commingle.

Sincerely,

Rick Hestermann
Production Department